

**GOVINDPURAM HOUSING SCHEME ( गोविन्दपुरम आवासीय योजना)** at Village Mangupura khasra Nos. 642, 647, 648मि0, 649मि0, 650/1, 650/2, 651, 652, 653अ, 653ब, 654, 655, 656मि0, 658, 659, 669मि0, 669मि0, 672मि0, 672, 673, 674, 675, 676, 677, 678क, 678स, 679, 680क, 680ग, 681, 682, 683, 684, 685, 686, 687, 688, 689, 690, 691, 692, 693, 694, 696, 697ख, 697, 697मि0, 698, 699, 700, 701, 702, 703, 643, 644 and Village Manoharpur khasra Nos. 123, 124, 125, 127, 128, 149, 150, 151, 162, 168, 175, 176, 177, 178, 179, 180, 181, 182, 183, 184, 191, 192, 195, 196, 231, 234, 235, 236, 237, 238, 240, 241, 242, 243, 244, 245, 248, 259, 260, 261, 262, 263, 280, 282, 283, 287, 288, 197क, 197ख, 197ग, 197घ, 197च, 197ड, 290क, 290ख, 290ग, 290घ, 290च, 290छ, 290ड, 259/1303, 281, 126, 165, 239, 264

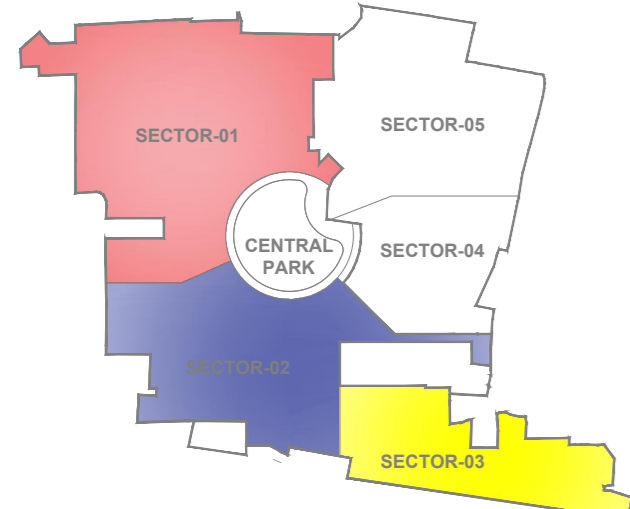
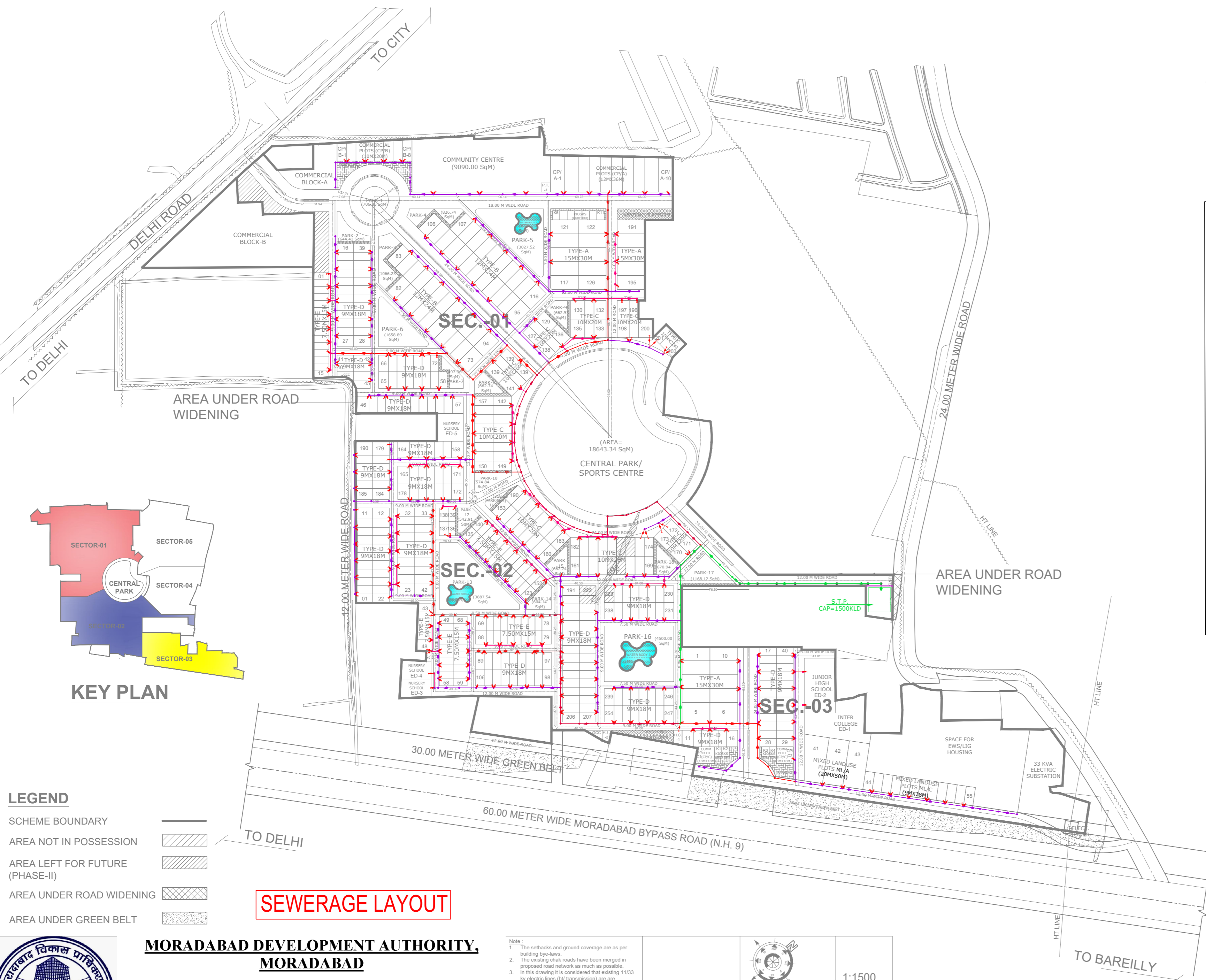

**KEY PLAN**

**LEGEND**

SCHEME BOUNDARY	
AREA NOT IN POSSESSION	
AREA LEFT FOR FUTURE (PHASE-II)	
AREA UNDER ROAD WIDENING	
AREA UNDER GREEN BELT	

**SEWERAGE LAYOUT**

**EXTERNAL SEWERAGE LEGEND:-**

	200Ø NP2 RCC SEWERAGE PIPE, SLOPE=1:250
	200Ø NP2 RCC SEWERAGE PIPE, SLOPE=1:250
	250Ø NP2 RCC SEWERAGE PIPE, SLOPE=1:300
	300Ø NP2 RCCSEWERAGE PIPE, SLOPE=1:600
	450Ø NP2 RCCSEWERAGE PIPE, SLOPE=1:700
	900X800MM SEWERAGE MANHOLE FOR 200Ø NP2 RCC SEWERAGE PIPE.
	900MM DIA SEWERAGE MANHOLE FOR 200Ø TO 250Ø NP2 RCC SEWERAGE PIPE.
	1200MM DIA SEWERAGE MANHOLE FOR 250Ø TO 300Ø NP2 RCC SEWERAGE PIPE.
	1500MM DIA SEWERAGE MANHOLE FOR 450Ø NP2 RCC SEWERAGE PIPE.
G.L	GROUND LEVEL
I.L	INVERT LEVEL
C.L	CONNECTION LEVEL



**MORADABAD DEVELOPMENT AUTHORITY, MORADABAD**  
**LAYOUT OF GOVINDPURAM HOUSING SCHEME (गोविन्दपुरम आवासीय योजना) PHASE-1 AT VILLAGE MANGUPURA & MANOHARPUR, MORADABAD (U.P.)**

**Note:**  
 1. The setbacks and ground coverage are as per building bye-laws.  
 2. The existing chak roads have been merged in proposed road network as much as possible.  
 3. In this drawing it is considered that existing 11/33 kv electric lines (H/ transmission) are relocated or laid underground.  
 4. The minimum requirement of social infra as per by-laws has been planned considering total land acquisition.  
 5. Plot sizes mentioned in drawings are standard sizes except corner plots, which will be measured as per site.  
 6. In execution the area/ dimensions may deviate at site.  
 7. The services of this scheme are to be linked/ incorporated with the existing/ proposed services of the surrounding area.

Ar. Sumit Agarwal CA/1999/24025		1:1500 SCALE
<b>ARCON</b> Shri KAILASHAM, 714, JANAKPURI, Bareilly 243122 Mob: 9837095138 email: sumit.architects@gmail.com sumit.architects@yahoo.com	<b>DIRECTION</b>	27.11.2025 DATE