

UPAVF
ARCHITECTURE AND PLANNING UNIT - 1
OFFICE COMPLEX, SECTOR-9
BANDHA, MUGAP, MEERUT

DWG NO
NOTES
1. ACCORDING TO THE POINT SECTION TAKEN IN THE MEETING DATED 17.11.18 HELD AT MASTER EDUCATIONAL PLOT WAS PLANNED IN SECTOR 3. WHICH HAS NOW BEING PROPOSED IN SECTOR 1 AFTER CONSULTATION OF ARCHITECT PLANNER WITH AYAS AJUNT.

REVISION OF SECTOR-3 (PHASE-1) AT SECTOR-4, T.V. (EXT.) MEERUT.
(CO. NO. 13/EE/ED-3/2018-19)

INDEX

S.No.	PARTICULARS	SYMBOL
1	Double Pole Structure SP-55, 11 Mtr. Long S.T. Tubular Pole	—●—
2	Steel Tubular Pole 11 Mtr. Long SP-55	●
3	Existing Double Pole Structure	●
4	L.T. Sub-Station with 250 KVA Transformer LT ACB & Distribution Pillar	—●—
5	H.T. Line, H.T. with ACSR Dog Conductor	—●—
6	PCC Pole 8.5 Mtr. Long	—●—
7	L.T. Line with ABC Cable of Size 3x95+1x70+1x16 Sqmm	—●—
8	H.T. Cable 300 Sqmm 3 Core	—●—
9	L.T. Cable 240 Sqmm 3.5 Core	—●—

निर्माण कार्य प्रमाणित
राजस्थान नियोजाक
इकाई प्रथम, मेरठ

ORG. NO.: 178/01/00/05

SCHEME: JAGRITI BHAR YOUNA NO. 11, MEERUT

PROJECT TITLE: LAYOUT PLAN FOR SECTOR - 3 SHOWING EDUCATIONAL PLOT

PROJECT: MASTER PLANNING OF JAGRITI BHAR YOUNA SCHEME NO. - 11 (EXTENSION I), MEERUT

SCALE:

DATE: 23/11/19

ASST ARCHITECT PLANNER: SD

ARCHITECT PLANNER: SD

CHIEF ARCHITECT PLANNER: MD

APPROVAL: SD

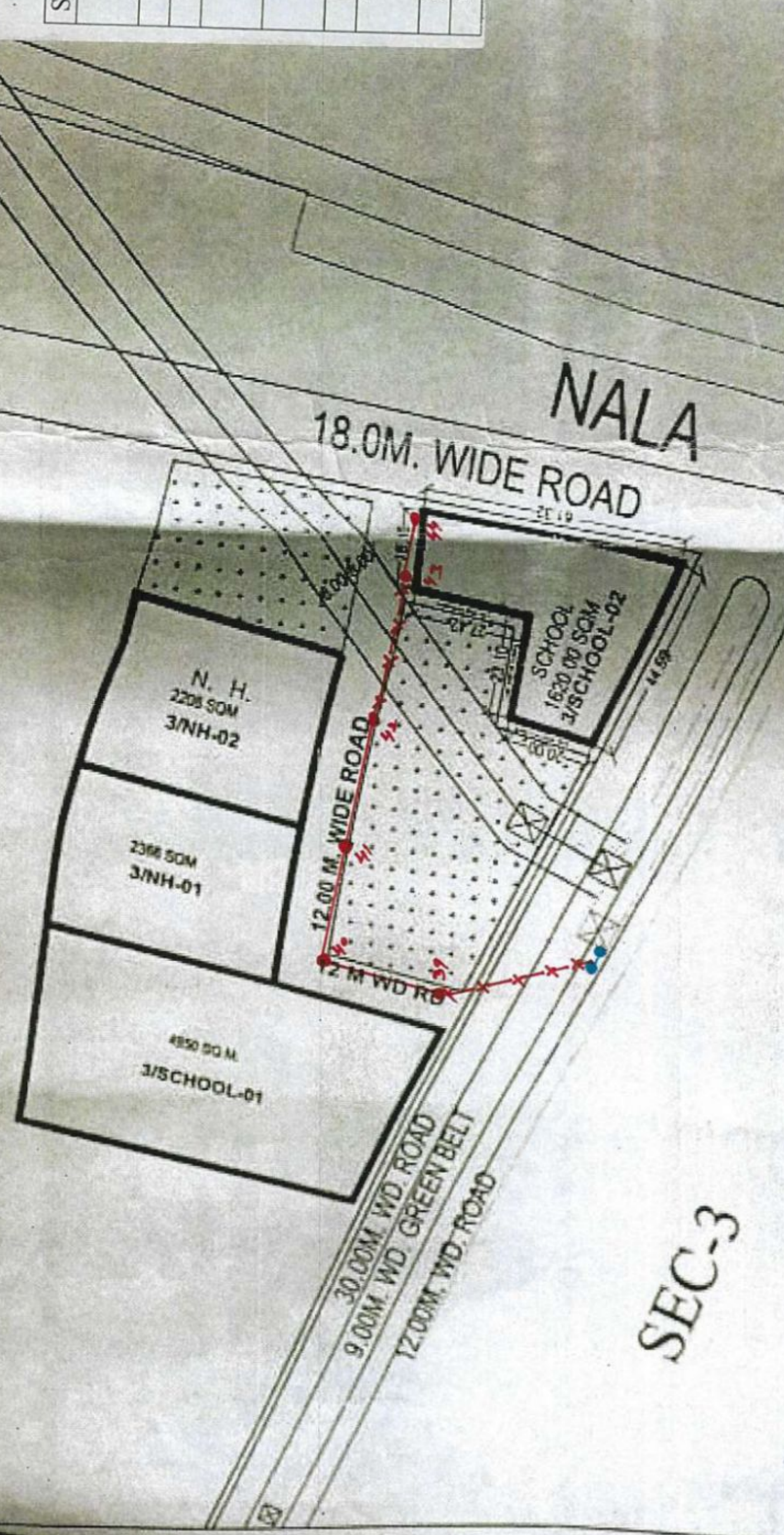

16/11/19	SI. YADAV	ARCHITECT PLANNER
16/11/19	SI. YADAV	ASST ARCHITECT PLANNER
16/11/19	SI. YADAV	ARCHITECT PLANNER

HANDED OVER

NOTE
1 ALL DIMENSIONS ARE IN METER
2 AS PER REQUIREMENT OF ENR (C&E) VICE REG LETTER NO.3/2000-02 HAS BEEN MARKED

UPHDS, K.A. [Signature]
अधिसासी अभियन्ता
विद्युत खण्ड-तृतीय
सहसंचालक एवं विकास अधिकारी
कानपुर

TAKEN OVER
S.D.O. Executive Engineer
Sub-Divisional Office, Urban Dist. Division-II
Elect. Div. Sub-Div. Meerut

Name of work: External Electrification of Sector-3 (Part) of Scheme no-11, J.V. (Ext), Meerut.



UPHDB
U.P. HOUSING & DEVELOPMENT BOARD
NEELGIRI COMPLEX, INDIRA
NAGAR, LUCKNOW

I.S.- 15700 :2005

E-MAIL ID. - ap5@upavp.com

FILE NO.-UPHDB/U.V.M.Y.-11/APDA/JN-8/24/285

DRG. NO.-

1. THIS LAY OUT PLAN HAS BEEN PREPARED ON THE BASIS OF INFORMATION RECEIVED BY S.E. OIR-2 WIDE HIS LETTER NO. 1834/SE/MEERUT/17/2004 ON DATED 08.12.2020.

LOAD CALCULATION OF SECTOR-3 (PART) JAGRATI VIHAR (EXT.) SCHEME NO.-11, MEERUT

S. NO.	PLOT AREA IN SQ. METER	NO. OF PLOT	Total Area (in Sq. Meter)	F.A.R.	AREA WITH F.A.R.	Load Per Sq. Meter As per D.Code (E.W.)	TOTAL LOAD (KW)	
1	127.50	101	12877.50	1.50	19316.25	0.05	955.81	
2	200.00	20	4000.00	1.50	6000.00	0.05	300.00	
3	STREET LIGHTING & WATER SUPPLY						0.05	30.00
TOTAL							1295.81 KW	
LOAD IN KVA CONSIDERING P.F. 0.90							1429.78 KVA	
AFTER TAKING DIVERSITY FACTOR AS PER U.P. ELECTRICITY SUPPLY CODE 2005 AS AMENDED 50%							719.89 KVA	
CONSIDERING MAXIMUM LOADING 80%							899.86 KVA	
HENCE REQUIRED TRANSFORMER-							2 NO 400 KVA & 1 NO 100 KVA Capacity	



INDEX

S.No	PARTICULARS	SYMBOL
1	Existing H.T. Line	
2	11 KV H.T. Cable 240 Sqmm 3 Core in Double Length	
3	Steel Tubular Pole SP-55, 11 Mtr. Long	
4	Double Pole Structure SP-55 11 M. Long S.T. Pole	
5	Distribution Transformer 100 KVA Capacity P/Mounted	
6	Distribution Transformer 400 KVA Capacity	
7	L.T. Cable 240 Sqmm 3.5 Core in Double Length	
8	Aerial Bunch Conductor 3x120+1x95+1x16 Sq.mm	
9	EXISTING 33/11KV SUB-STN	

S.NO.	DESCRIPTION	SIZE	AREA (SQ. METER)	NOS.
1.	PLOTS	8.80X18.00	127.50	101
2.	PLOTS	18.00X20.00	200.00	20
3.	PLOTS	8.00X18.00	144.00	80
4.	PLOTS	12.00X28.00	300.00	20
5.	PLOTS	11.80X23.00	264.80	12
6.	PLOTS	8.00X17.00	136	18
7.	HOUSE TYPE (B1/42)	7.90X18.00	162.00	68
8.	DUPLAX HOUSES 8.00x18.00		312.80	80
TOTAL PLOTS				368

AREA CALCULATION

TOTAL SCHEME AREA (A)	245515.94		
MASTER PLAN COMMERCIAL AREA (B)	39654.00		
GROUP HOUSING AREA (C)	22930.03		
ARJAN MUKT LAND (D)	6403.83		
NET SCHEME AREA=A-(B+C+D)	176528.08		
S.NO.	TYPES	AREA	PERCENTAGE
1.	RESIDENTIAL	60202.50	34.10
2.	COMMERCIAL	2620.99	1.48
3.	SCHOOL	18770.97	10.63
4.	CSC	2038.50	1.15
5.	OHT	2129.97	3.92
6.	COMMUNITY CENTRE	6916.25	3.92
7.	NURSING HOME	6108.54	3.46
8.	FACILITY PLOT	8807.58	4.99
9.	GREEN	17952.41	10.17
	ROAD	50980.37	28.88
	TOTAL	176528.08	100.00

1. अर्जन मुक्त भूमि
U.P. AVAS EVAM VIKAS PARISHAD, LUCKNOW
ARCHITECTURE AND PLANNING UNIT - 5
COMBINED AND CONTROL LAYOUT PLAN OF JAGRATI VIHAR, EXTENSION, YOJNA NO.-11 SECTOR-3 MEERUT.
DATE - 18-01-2021

KRISHNA KANT DIP. ARCH. ARCH. ASSTT.	S.D. - 18-01-2021
AMITA SRIVASTAVA DIP. ARCH. ASSTT. ARCHITECT PLANNER	S.D. - 18-01-2021
ARVIND DEO BARCH, A.I.A., M.E.A. (PUBLICATIONS) ARCHITECT ARCHITECT PLANNER	S.D. - 18-01-2021
S.J. YADAV SENIOR ARCHITECT PLANNER	S.D. - 21-01-2021
DINESH KUMAR CHIEF ARCHITECT PLANNER	S.D. - 21-01-2021
AJAY CHAUHAN IAS AVAS AYUKT	S.D. - 22-01-2021



UPHDB KANPUR
29.7.2021
29.7.2021

Sub-Divisional Officer
City Urban Dist. Sub-Division - DK
Meerut

अधिकारी अभियंता
विद्युत नगरपालिका
मेरठ