

Project

Proposed Affordable Housing Project on Arazi No 282, 276Mi, 276, 276/3Mi,275/2 , and ARAZI No 283, 282, 276 Mi, 276/3Mi, 275/2Mi, 275/2 situated at VILLAGE- MAHEBA PURAB PATTI, UPARHAR, PARGANA-ARAIL, TEHSIL - KARCHHANA, PRAYAGRAJ OF SHER AFGAN S/O SHRI SHER ALI & Smt. SHAH BANO w/o SHRI ALI SHER

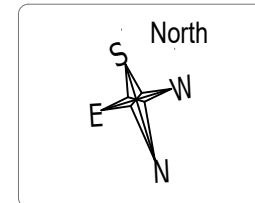

Ayansh Credit Services LLP
Authorized Signatory

PROPERTY OF
MR. SHER ALI FATHER OF MR. SHER AFGAN &
MR. ALI SHER HUSBAND OF MRS. SHAH BANO

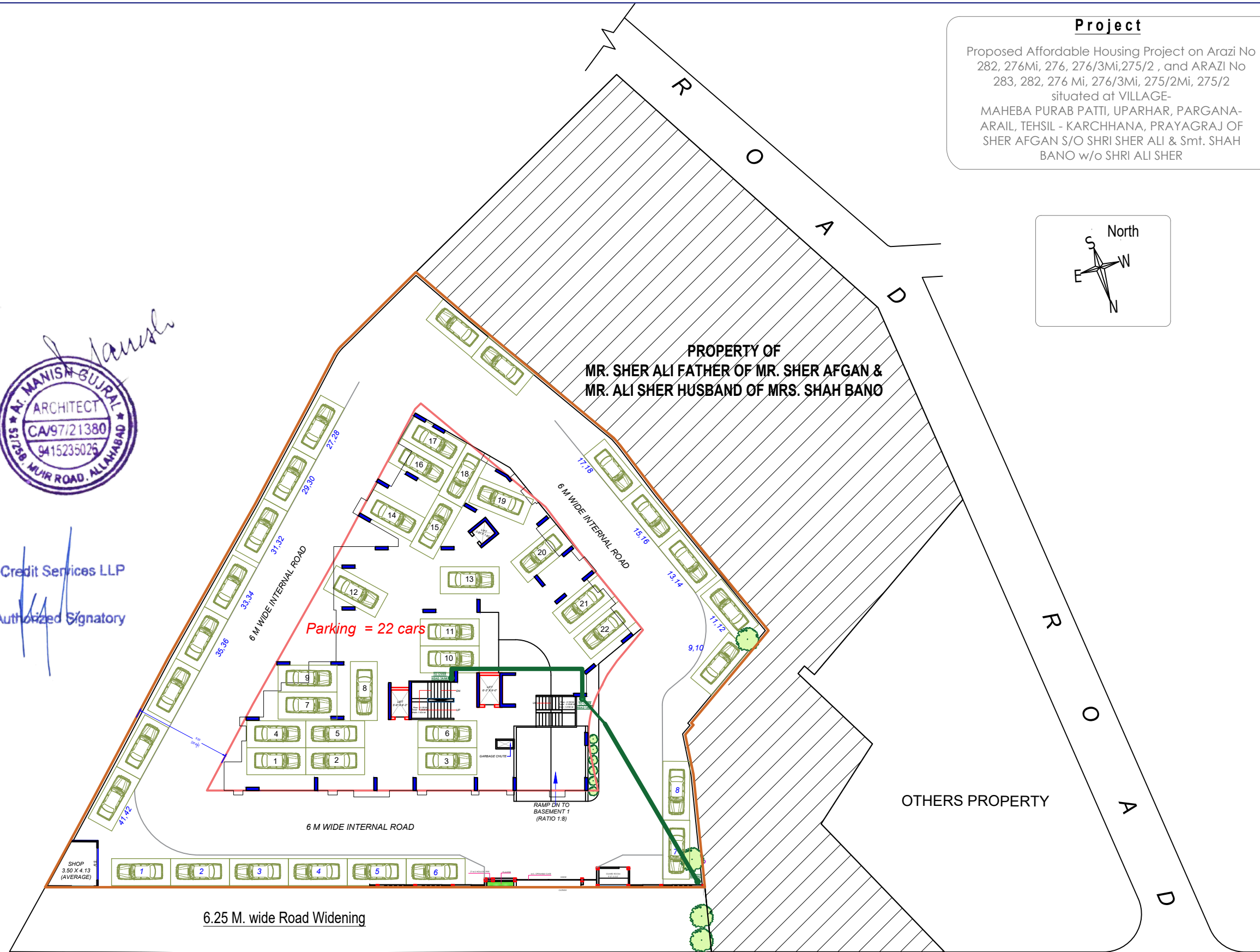

OTHERS PROPERTY

TO NAINI STATION

14.00 to 17.50 METER WIDE INDALPUR ROAD

TO MAHEWA REWA

WATER SUPPLY PLAN