



LEGEND	DESCRIPTION	MT HEIGHT (MM)
	6A RAK POWER SOCKET WITH SWITCH	230 MM
	20A RAK POWER SOCKET WITH SWITCH	230 MM
	EXHAUST FAN	2100 MM
	6/18A RAK POWER SOCKET WITH SWITCH OUTLET	230 MM
	6/18A RAK POWER SOCKET WITH SWITCH OUTLET ABOVE WORKING SLAB	230 MM
	6/16A RAK POWER SOCKET FOR DEVICE	AS PER DETAIL
	10A RAK POWER SOCKET FOR LIFT	AS PER DETAIL
	20A SOCKET WITH 20A 3P MCB FOR AC	1800 MM
	TV POINT	600 MM
	TELEPHONE OUTLET	230 MM
	DISTRIBUTION BOARD	1800 MM TOP

LEGEND	DESCRIPTION	MT HEIGHT (MM)
	ONE WAY SWITCH BOARD	1200 MM
	10W MIRROR LIGHT	1800 MM
	10W SURFACE LIGHT	ON CEILING
	10W WALL MOUNTED LIGHT	2100 MM
	10W CEILING MOUNTED LIGHT	ON CEILING
	10W CEILING MOUNTED LIGHT (EMERGENCY CONTROL)	ON CEILING
	10W WALL BRACKET LIGHT	2100 MM
	6W BULK HEAD LIGHT FOR LIFT	AS PER DETAIL
	200MM CEILING FAN	ON CEILING
	100MM CEILING FAN	ON CEILING
	EXHAUST FAN	2100 MM
	DISTRIBUTION BOARD	1800 MM TOP

PROJECT -- Housing at Bulandshahr				LDB-4 (8 WAY) IN LOCATION - STILT FLOOR			
QTY NO.	MCB RATING IN AMPS	CABLE SIZE IN MM <sup>2</sup>	NOS OF POINTS	LOCATION	LOAD IN WATTS		
A1	10A	2.5	06	PARKING	120		
A2	10A	2.5	08	PARKING	160		
A3	10A	2.5	05	PARKING	100		
A4	10A	2.5	05	PARKING	100		
A5	10A	2.5	05	PARKING	100		180
A6	10A	2.5	07	RAMP			120
A7	10A	2.5	05	PARKING	100		
A8	10A	4.0	01	PARKING	500		
A9	10A	4.0	01	PARKING	500		
A10	10A	4.0	01	PARKING	500		
A11	10A	4.0	01	SPARE			
A12	10A			SPARE			
TOTAL LOAD					860	1200	340
RECOMMENDATION: 40A 3P MCB WITH 3NCS 40A/20HA 3P RCCB					TOTAL CL. = 1.78M		

PROJECT -- Housing at Bulandshahr				LDB-5 (8 WAY) IN LOCATION - STILT FLOOR			
QTY NO.	MCB RATING IN AMPS	CABLE SIZE IN MM <sup>2</sup>	NOS OF POINTS	LOCATION	LOAD IN WATTS		
A1	10A	2.5	12	FIRST FLOOR	160		
A2	10A	2.5	12	SECOND FLOOR	160		
A3	10A	2.5	13	THIRD FLOOR	180		
A4	10A	2.5	13	FOURTH FLOOR	180		
A5	10A	2.5	13	FIFTH FLOOR			190
A6	10A	2.5	13	SIXTH FLOOR			190
A7	10A	2.5	13	SEVENTH FLOOR	180		
A8	10A	4.0	08	STAIR CASE	135		
A9	10A	4.0	08	STAIR CASE	135		
A10	10A	4.0	08	STAIR CASE	135		
A11	10A	4.0	08	STAIR CASE	135		
A12	10A			SPARE			
TOTAL LOAD					720	860	390
RECOMMENDATION: 40A 3P MCB WITH 3NCS 40A/20HA 3P RCCB					TOTAL CL. = 1.84M		

PROJECT -- Housing at Bulandshahr				LDB-6 (8 WAY) IN LOCATION - STILT FLOOR			
QTY NO.	MCB RATING IN AMPS	CABLE SIZE IN MM <sup>2</sup>	NOS OF POINTS	LOCATION	LOAD IN WATTS		
E1	10A	2.5	8	1ST & 2ND FLOOR	120		
E2	10A	2.5	8	3RD & 4TH FLOOR	120		
E3	10A	2.5	8	5TH & 6TH FLOOR	120		
E4	10A	2.5	4	7TH FLOOR	60		
E5	10A	2.5	8	STAIR CASE	135		
E6	10A	2.5	8	STAIR CASE	135		
E7	10A	2.5	8	STAIR CASE	135		
E8	10A	2.5	8	STAIR CASE	135		
TOTAL LOAD					825		
RECOMMENDATION: 40A 3P MCB WITH 40A / 100HA 3P RCCB					TOTAL CL. = 0.85M		

PROJECT -- Housing at Bulandshahr				LDB-8 (8 WAY) IN LOCATION - STILT FLOOR			
QTY NO.	MCB RATING IN AMPS	CABLE SIZE IN MM <sup>2</sup>	NOS OF POINTS	LOCATION	LOAD IN WATTS		
B1	10A	2.5	06	PARKING	120		
B2	10A	2.5	08	PARKING	160		
B3	10A	2.5	08	PARKING	120		
B4	10A	2.5	08	PARKING	120		
B5	10A	2.5	05	PARKING	100		180
B6	10A	4.0	06	PARKING	500		120
B7	10A	4.0	01	PARKING	500		
B8	10A	4.0	01	PARKING	500		
B9	10A	4.0	01	SPARE			
B10	10A	4.0	01	SPARE			
B11	10A	4.0	01	SPARE			
B12	10A			SPARE			
TOTAL LOAD					1280	240	320
RECOMMENDATION: 40A 3P MCB WITH 3NCS 40A/20HA 3P RCCB					TOTAL CL. = 1.78M		

PROJECT -- Housing at Bulandshahr				LDB-10 (8 WAY) IN LOCATION - STILT FLOOR			
QTY NO.	MCB RATING IN AMPS	CABLE SIZE IN MM <sup>2</sup>	NOS OF POINTS	LOCATION	LOAD IN WATTS		
E1	10A	2.5	8	PARKING	160		
E2	10A	2.5	3	RAMP	40		
E3	10A	2.5	3	RAMP	60		
E4	10A	2.5	4	PARKING	120		
E5	10A			SPARE			
E6	10A			SPARE			
E7	10A			SPARE			
E8	10A			SPARE			
TOTAL LOAD					340		
RECOMMENDATION: 40A 3P MCB WITH 40A / 100HA 3P RCCB					TOTAL CL. = 0.46M		

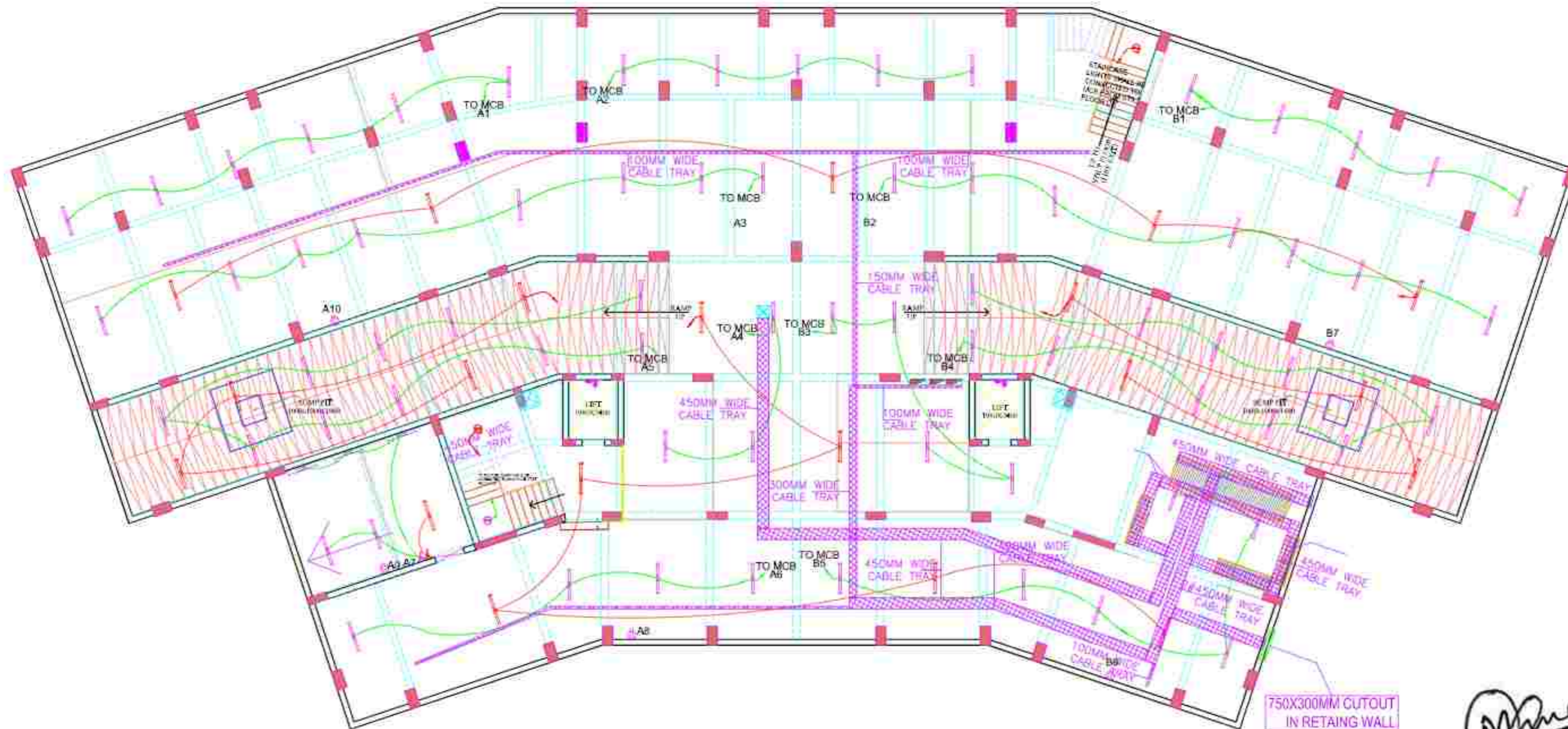

BASEMENT FLOOR (ELECTRICAL PLAN)

LEGEND:			
S.No.	SYMBOL	DESCRIPTION	POSITION

NOTES:

**SAMEEP GARG**  
 CA-020-02210  
 H.M. Complex, Near Jain Hall,  
 Park Road, Aligarh

REV. NO.	DATE	REVISION

Project: **GROUP HOUSING AT KALINDI VIHAR, KHURJA, DISTT. BULANDSHAHR**

File: **BASEMENT FLOOR PLAN**

Subfile: **BASEMENT ELECTRICAL PLAN**

Drawing released for:

TENDER       SUBMISSION

ADVANCE COPY       CONSTRUCTION

Proj. No.: **BL/HRD/01**      Drawn by: **SOROUT**

Scale: **1:100**      Designed by: **SAHEEP**

Date: **OCT. 2024**      Checked by: **SAHEEP**

Architects: **BASELINE ARCHITECTS**  
 Architects & Interior Design Consultants  
 M/10, Sector 14, Gurgaon, Haryana  
 Phone: +91-9899-921-121, Email: baseline.arch@gmail.com















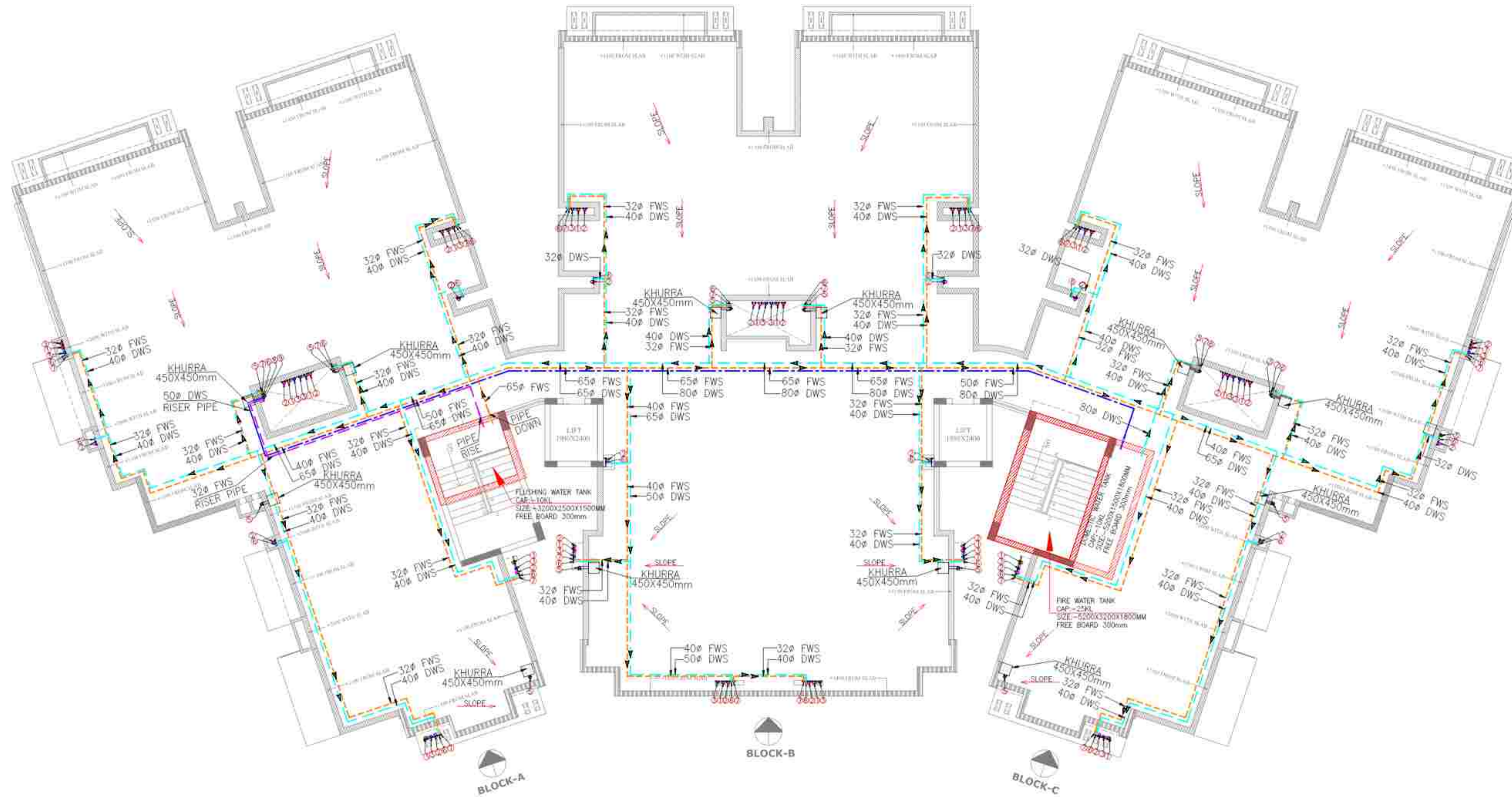

## TERRACE FLOOR WORKING PLAN

LEGEND:-		
S.NO.	DESCRIPTION	SYMBOL
1.	KHURRA 450X450mm	
2.	DOMESTIC WATER RISER PIPE LINE	
3.	FLUSHING WATER RISER PIPE LINE	
4.	FLUSHING WATER SUPPLY PIPE LINE	
5.	DOMESTIC WATER SUPPLY PIPE LINE	
6.	BALL VALVE	
7.	FLOW DIRECTION	

DETAIL OF PIPE CONNECTIONS	
FROM WC TO STACK.....	100Ø CI SOIL PIPE
FROM FT TO STACK.....	100Ø CI WASTE PIPE
FROM FD TO FT.....	50Ø G.I WASTE PIPE
FROM WB WASTE TO FT.....	32Ø G.I WASTE PIPE

LEGEND :-	
①	100Ø CI HUBLESS SOIL PIPE
②	100Ø CI HUBLESS WASTE PIPE
③	75Ø CI ANTISYPHONAGE PIPE
④	75 OD uPVC BALCONY RAIN WATER PIPE
⑤	110 OD uPVC RAIN WATER PIPE FROM TERRACE
⑥	DOMESTIC WATER SUPPLY DOWN TAKE PIPE
⑦	FLUSHING WATER SUPPLY DOWN TAKE PIPE
⑧	DOM. WATER RISER FROM PLANT ROOM TO O.H.T.
⑨	FLU. WATER RISER FROM S.T.P TO O.H.T
⊙	FLOOR TRAP CUTOUT 150mm DIA
⊙	FLOOR TRAP CUTOUT 100mm DIA
⊙	WATER CLOSET CUTOUT 150mm DIA
⊙	FLOOR DRAIN (100X50)mm
—	SOIL PIPE LINE
—	WASTE PIPE LINE

LEGEND :			
S.No	SYMBOL	DESCRIPTION	POSITION

**NOTES :**

SAMEER GARG
   
 CH-3020-30209
   
 H.M. Complex, New Pata Daria
   
 Ramchand Road, Jaganp

rev. no.	date	revision
R2	24.09.2024	PLUMBING DRAWING
R1	30.07.2024	PLUMBING DRAWING
R0	08.09.2023	TENDER DRAWING

project

title **PLUMBING DRAWING**

subtitle **PLUMBING LAYOUT**  
TERRACE PLAN

drawing released for

TENDER  SUBMISSION

ADVANCE COPY  CONSTRUCTION

drg. no. EMPS/395/PL/05 drawn by DHIRAJ

scale 1:100@A1 designed by CHANDARPAL

date SEP 2024 checked by CHANDARPAL

architects

LEGEND	DESCRIPTION	MT. HEIGHT (MM)
	6A RAW POWER SOCKET WITH SWITCH	230 MM
	230V RAW POWER SOCKET WITH SWITCH	230 MM
	DOWNST FAN	2100 MM
	6/16A RAW POWER SOCKET WITH SWITCH	230 MM
	6/16A RAW POWER SOCKET WITH SWITCH OUTLET ABOVE WORKING PLANE	230 MM
	6/16A RAW POWER SOCKET FOR CEILING	AS PER DETAIL
	16A RAW POWER SOCKET FOR LIFT	AS PER DETAIL
	230V SOCKET WITH 25A 5P MCB FOR AC	1800 MM
	TV POINT	800 MM
	TELEPHONE OUTLET	230 MM
	DISTRIBUTION BOARD	1800 MM TOP

LEGEND	DESCRIPTION	MT. HEIGHT (MM)
	ONE WAY SWITCH BOARD	1200 MM
	10W MIRROR LIGHT	1800 MM
	10W SURFACE LIGHT	ON CEILING
	10W SURFACE LIGHT (EMERGENCY CONTROL)	ON CEILING
	100W WALL MOUNTED LIGHT	2100 MM
	100W CEILING MOUNTED LIGHT	ON CEILING
	100W CEILING MOUNTED LIGHT (EMERGENCY CONTROL)	ON CEILING
	100W WALLBRACKET LIGHT	2100 MM
	6W BULK READ LIGHT FOR LIFT	AS PER DETAIL
	100WMM CEILING FAN	ON CEILING
	DOWNST FAN	2100 MM
	DISTRIBUTION BOARD	1800 MM TOP

PROJECT :- Housing of Bulandshahr				LIFE-4 IN WATER TOWER- STILB FLOOR	
QTY	MCB RATING	CABLE SIZE IN MM <sup>2</sup>	NO. OF POINTS	LOCATION	LOAD IN WATTS
A1	10A	2.5	04	PARKING	120
A2	10A	2.5	08	PARKING	160
A3	10A	2.5	08	PARKING	100
A4	10A	2.5	08	PARKING	100
A5	10A	2.5	08	PARKING	100
A6	10A	2.5	08	RAMP	80
A7	10A	2.5	08	PARKING	100
A8	10A	2.5	08	PARKING	100
A9	10A	4.0	08	PARKING	300
A10	10A	4.0	08	PARKING	300
A11	10A	4.0	08	PARKING	300
A12	10A	4.0	08	PARKING	300
TOTAL LOAD					840
RECOMMEND :- 40A 7P MCB WITH 2500 KA/30KA IP RCCB					TOTAL CL :- 1.15M

PROJECT :- Housing of Bulandshahr				COMMON LIFE-4 IN WATER TOWER- STILB FLOOR	
QTY	MCB RATING	CABLE SIZE IN MM <sup>2</sup>	NO. OF POINTS	LOCATION	LOAD IN WATTS
B1	15A	2.5	12	FIRST FLOOR	195
A2	15A	2.5	12	SECOND FLOOR	195
A3	15A	2.5	12	THIRD FLOOR	195
A4	15A	2.5	12	FIFTH FLOOR	195
A5	15A	2.5	12	FIFTH FLOOR	195
A6	15A	2.5	12	SOUTH FLOOR	195
A7	15A	2.5	12	SEVENTH FLOOR	195
A8	15A	4.0	08	STAIR CASE	135
A9	15A	4.0	08	STAIR CASE	135
A10	15A	4.0	08	STAIR CASE	135
A11	15A	4.0	08	STAIR CASE	135
A12	15A	4.0	08	STAIR CASE	135
TOTAL LOAD					1725
RECOMMEND :- 40A 7P MCB WITH 2500 KA/30KA IP RCCB					TOTAL CL :- 1.15M

PROJECT :- Housing of Bulandshahr				COMMON LIFE-4 IN WATER TOWER- STILB FLOOR	
QTY	MCB RATING	CABLE SIZE IN MM <sup>2</sup>	NO. OF POINTS	LOCATION	LOAD IN WATTS
E1	10A	2.5	8	1ST & 2ND FLOOR	120
E2	10A	2.5	8	3RD & 4TH FLOOR	120
E3	10A	2.5	8	5TH & 6TH FLOOR	120
E4	10A	2.5	8	7TH FLOOR	60
E5	10A	2.5	8	STAIR CASE	120
E6	10A	2.5	8	STAIR CASE	120
E7	10A	2.5	8	STAIR CASE	120
E8	10A	2.5	8	STAIR CASE	120
TOTAL LOAD					840
RECOMMEND :- 40A 7P MCB WITH 2500 KA/30KA IP RCCB					TOTAL CL :- 1.15M

PROJECT :- Housing of Bulandshahr				LIFE-4 IN WATER TOWER- STILB FLOOR	
QTY	MCB RATING	CABLE SIZE IN MM <sup>2</sup>	NO. OF POINTS	LOCATION	LOAD IN WATTS
B1	10A	2.5	04	PARKING	120
B2	10A	2.5	08	PARKING	160
B3	10A	2.5	08	PARKING	120
B4	10A	2.5	04	RAMP	80
B5	10A	2.5	08	PARKING	100
B6	10A	2.5	08	PARKING	100
B7	10A	4.0	08	PARKING	300
B8	10A	4.0	08	PARKING	300
B9	10A	4.0	08	PARKING	300
B10	10A	4.0	08	PARKING	300
B11	10A	4.0	08	PARKING	300
B12	10A	4.0	08	PARKING	300
TOTAL LOAD					1180
RECOMMEND :- 40A 7P MCB WITH 2500 KA/30KA IP RCCB					TOTAL CL :- 1.15M

PROJECT :- Housing of Bulandshahr				LIFE-4 IN WATER TOWER- STILB FLOOR	
QTY	MCB RATING	CABLE SIZE IN MM <sup>2</sup>	NO. OF POINTS	LOCATION	LOAD IN WATTS
E1	10A	2.5	8	PARKING	160
E2	10A	2.5	8	RAMP	80
E3	10A	2.5	8	RAMP	80
E4	10A	2.5	8	PARKING	120
E5	10A	2.5	8	PARKING	120
E6	10A	2.5	8	PARKING	120
E7	10A	2.5	8	PARKING	120
E8	10A	2.5	8	PARKING	120
TOTAL LOAD					880
RECOMMEND :- 40A 7P MCB WITH 2500 KA/30KA IP RCCB					TOTAL CL :- 1.15M



TYPICAL FLOOR ELECTRICAL LAYOUT PLAN

LEGEND:			
S.No	SYMBOL	DESCRIPTION	POSITION

NOTES:

*Sameep Garg*  
**SAMEEP GARG**  
 CA-0202020  
 H.M. Complex, Near Jain Temple,  
 Patanjali Road, Aligarh

REV. NO.	DATE	REVISION

Project: **GROUP HOUSING AT PLOT NO. 02, KALANDI KUNJ AWASIYA YOJNA, KHURJA, DISTT. BULANDSHAHR.**

File: **TYPICAL FLOOR PLAN**

Subfile: **TYPICAL FLOOR ELECTRICAL PLAN**

Drawing released for:

TENDER       SUBMISSION

ADVANCE COPY       CONSTRUCTION

DRG. NO.	EL-001	Drawn by	SOBOUT
DATE	12/08/24	Designed by	SAWEEP
DATE	OCT. 2024	Checked by	SAWEEP

Architects: **BASELINE ARCHITECTS**  
 Architects & Interior Design Consultants  
 M/100, EX. H.P.T. ROAD, 1ST FLOOR, ALIGARH  
 U.P. INDIA - 202002  
 TEL: +91-8262912212, E-MAIL: baseline.arch@gmail.com

*Signature*



