

Activity ID	Activity Name	Start	Finish	2021					2022				2023		
				Q4	Q1	Q2	Q3	Q4	Q1	Q2	Q3	Q4	Q1		
P2		01-Oct-20	31-Dec-22	[Summary Bar]											01-Dec-22, P
	Demarcation of Plots	01-Oct-20	31-Dec-22	[Summary Bar]											01-Dec-22, D
A1000	New Activity	01-Oct-20	31-Dec-22	[Remaining Work Bar]											New Activity
	Road work	01-Oct-20	31-Dec-22	[Summary Bar]											01-Dec-22, R
A1010	New Activity	01-Oct-20	31-Dec-22	[Critical Remaining Work Bar]											New Activity
	Footpath	01-Oct-20	31-Dec-22	[Summary Bar]											01-Dec-22, F
A1020	New Activity	01-Oct-20	31-Dec-22	[Critical Remaining Work Bar]											New Activity
	Water Supply Including Drinking Water Facilit	01-Oct-20	31-Dec-22	[Summary Bar]											01-Dec-22, W
A1030	New Activity	01-Oct-20	31-Dec-22	[Critical Remaining Work Bar]											New Activity
	Sewer System	01-Oct-20	31-Dec-22	[Summary Bar]											01-Dec-22, S
A1040	New Activity	01-Oct-20	31-Dec-22	[Critical Remaining Work Bar]											New Activity
	Drain	01-Oct-20	31-Dec-22	[Summary Bar]											01-Dec-22, D
A1050	New Activity	01-Oct-20	31-Dec-22	[Critical Remaining Work Bar]											New Activity
	Park	01-Oct-20	31-Dec-22	[Summary Bar]											01-Dec-22, P
A1060	New Activity	01-Oct-20	31-Dec-22	[Critical Remaining Work Bar]											New Activity
	Tree planting	01-Oct-20	31-Dec-22	[Summary Bar]											01-Dec-22, T
A1070	New Activity	01-Oct-20	31-Dec-22	[Critical Remaining Work Bar]											New Activity
	Design For Electric Supply Including Street L	01-Oct-20	31-Dec-22	[Summary Bar]											01-Dec-22, D
A1080	New Activity	01-Oct-20	31-Dec-22	[Critical Remaining Work Bar]											New Activity
	Commnity building	01-Oct-20	31-Dec-22	[Summary Bar]											01-Dec-22, C
A1090	New Activity	01-Oct-20	31-Dec-22	[Critical Remaining Work Bar]											New Activity
	Treatment and Disposal System of Sewage ar	01-Oct-20	31-Dec-22	[Summary Bar]											01-Dec-22, T
A1100	New Activity	01-Oct-20	31-Dec-22	[Critical Remaining Work Bar]											New Activity
	Solid Waste Management And Disposal Syste	01-Oct-20	31-Dec-22	[Summary Bar]											01-Dec-22, S
A1110	New Activity	01-Oct-20	31-Dec-22	[Critical Remaining Work Bar]											New Activity

█ Actual Work
 █ Critical Remaining Work
 ▼ Summary
█ Remaining Work
 ◆ Milestone

Activity ID	Activity Name	Start	Finish	2021					2022				2023	
				Q4	Q1	Q2	Q3	Q4	Q1	Q2	Q3	Q4	Q1	
Water Conservation System		01-Oct-20	31-Dec-22											
A1120	New Activity	01-Oct-20	31-Dec-22											
Energy Management System Including Use of		01-Oct-20	31-Dec-22											
A1130	New Activity	01-Oct-20	31-Dec-22											
Fire Protection And Fire Safety System		01-Oct-20	31-Dec-22											
A1140	New Activity	01-Oct-20	31-Dec-22											
Social Infrastructure And Other Public Ameniti		01-Oct-20	31-Dec-22											
A1150	New Activity	01-Oct-20	31-Dec-22											
Emergency Evacuation Services		01-Oct-20	31-Dec-22											
A1160	New Activity	01-Oct-20	31-Dec-22											
Other Miscellaneous Work		01-Oct-20	31-Dec-22											
A1170	New Activity	01-Oct-20	31-Dec-22											

█ Actual Work
 █ Critical Remaining Work
 ▼ Summary
 █ Remaining Work
 ◆ Milestone

PERMISSIBLE NORMS OF DEVELOPMENT OF PLOT AREA = 408545.00 SQ.MT.			
DESCRIPTION	PERCENTAGE(%)	AREA(SQ.MT.)	AREA(SQ.MT.)
A) RESIDENTIAL(PLOTTED/FLATTED)	MAX. 55%	224699.75	
B) COMMERCIAL	MAX. 5%	20427.25	
C) INSTITUTIONAL & FACILITIES	MIN. 5%	20427.25	
D) ROADS, PARK AND OPEN SPACES	MIN. 35%	142990.75	
TOTAL SITE AREA	100%	408545.000	

PROPOSED LANDUSE DISTRIBUTION			
DESCRIPTION	AREA(SQ.MT.)	PERCENTAGE(%)	
A) RESIDENTIAL(PLOTTED/FLATTED)			
PLOTTED	95,361.329		
GROUP HOUSING-01	58,651.226	2,09,810.368	
GROUP HOUSING-02	55,797.813		51.36%
B) COMMERCIAL-01	17,354.50		
COMMERCIAL-02	1,000.00	20,354.50	
COMMERCIAL-03	1,000.00		4.98%
COMMERCIAL-04	1,000.00		
C) INSTITUTIONAL & FACILITIES	22,500.00		5.51%
D) ROADS, PARK AND OPEN SPACES	1,55,880.13		38.15%
LANDSCAPE	61,290.000		15.00%
ROADS & OPEN	94,590.132		23.15%
TOTAL SITE AREA (A+B+C+D)	4,08,545.00		100.0%

PROPOSED DEVELOPMENT			
DESCRIPTION	AREA(SQ.MT.)	TOTAL AREA(SQ.MT.)	PERCENTAGE(%)
A) RESIDENTIAL(PLOTTED/FLATTED)		2,09,810.368	
PLOTTED	95,361.329		51.36%
FLATTED GROUP HOUSING-01	58,651.226		
FLATTED GROUP HOUSING-02	55,797.813		
B) COMMERCIAL-01	17,354.50	20,354.50	4.98%
COMMERCIAL-02	1,000.00		
COMMERCIAL-03	1,000.00		
COMMERCIAL-04	1,000.00		
C) INSTITUTIONAL & FACILITIES	22,500.00	22,500.00	5.51%
INST.-01	1 SR. SECONDARY, 2 PRIMARY, 2 NURSERY SCHOOL & 1 CRECHE	15,000.00	
INST.-02	DISPENSARY	2,000.00	
INST.-03	MILK & VEGETABLE BOOTH	400.00	
INST.-04	ELECTRIC SUBSTATION	600.00	
INST.-05	AUTO TAXI STAND	500.00	
INST.-06	NURSING HOME	3,000.00	
INST.-07	1 NURSERY SCHOOL	1,000.00	
D) ROADS, PARK AND OPEN SPACES	1,55,880.13	1,55,880.13	38.15%
LANDSCAPE	61,290.00	61,290.00	15.00%
ROADS & OPEN	94,590.132	94,590.132	23.15%
TOTAL AREA	4,08,545.00	4,08,545.00	100.00%

SOCIAL AND PHYSICAL INFRASTRUCTURE BASED ON RESIDENTIAL POPULATION						24000	PERSON
S.NO.	USE PREMISES	SERVICE POPULATION PER UNIT	UNIT PLOT AREA (SQ.MT.)	REQUIREMENT	PROPOSED FACILITIES		NOTE
A)	EDUCATION						
	CRECHE/DAY CARE	5000-7500	1000	0.90	1	1000	PROVIDED IN INSTITUTIONAL FACILITY-01
	NURSERY SCHOOL	5000-7500	1000	3.20	3	3000	2 NOS PROVIDED IN INSTITUTIONAL FACILITY-06
	PRIMARY SCHOOL	7500-15000	2000	1.60	2	4000	1 NOS PROVIDED IN INSTITUTIONAL FACILITY-01
	SENIOR SECONDARY SCHOOL	15000-25000	8000	0.36	1	8000	2 NOS PROVIDED IN INSTITUTIONAL FACILITY-01
B)	HEALTH						
	DISPENSARY	7500-15000	1000	1.60	2	2000	PROVIDED IN INSTITUTIONAL FACILITY-02
	NURSING HOME	5000-7500	1000	3.20	3	3000	PROVIDED IN INSTITUTIONAL FACILITY-05
C)	SHOPPING						
	CONVENIENT SHOPPING CENTRE	7500-15000	5000	1.60	2	10000	PROVIDED IN COMMERCIALS
D)	OTHER COMMUNITY FACILITIES						
	COMMUNITY CENTRE	7500-15000	4000	1.60	1,600	6400	PROVIDED IN GROUP HOUSING-01 & 02
	MILK & VEGETABLE BOOTH	5000-7500	200	3.20	3	600	2 No.s PROVIDED IN INSTITUTIONAL FACILITY-03, 1 No.s PROVIDED IN COMMERCIAL-1.
E)	UTILITIES						
	ELECTRICAL SUB-STATION	AS PER REQUIREMENT	600	1	600	600	PROVIDED IN INSTITUTIONAL FACILITY-01
	AUTO CLIM TAXI STAND	AS PER REQUIREMENT	500	1	500	500	PROVIDED IN INSTITUTIONAL FACILITY-01

DENSITY CALCULATION								
	TYPE	SIZE (SQ.MT.)	EXISTING NO.S	PROPOSED NO.S	TOTAL NO.S	OCCUPANCY	PLOT AREA (SQ.MT.)	POPULATION
	PLOTTED	100	83.624	208	181	389	32529.736	3501
	PLOTTED	150	125.413	55	126	181	22699.753	1629
	PLOTTED	200	167.216	28	210	238	39797.408	2142
	PLOTTED	400	334.432	0	1	1	334.432	9
TOTAL				291	518	809	95361.329	7281 PERSONS
	GROUP HOUSING-01					3498	58651.226	DENSITY AS/LEASE DEED
	GROUP HOUSING-02					217	55797.813	DENSITY AS/LEASE DEED
TOTAL							209810.368	

PLOTTED DEVELOPMENT									
PLOT TYPE	PLOT NOS.	PLOT SIZE (SQ.MT.)	PERMISSIBLE F.A.R. AREA OF EACH PLOT @ 1.8 (SQ.MT.)	PERMISSIBLE GROUND COVERAGE OF EACH PLOT @ 75% (SQ.MT.)	DWELLING UNITS	NO. OF PLOTS	TOTAL PLOT AREA (SQ.MT.)	TOTAL DWELLING UNITS	POPULATION
100	B-01 TO B-174, B-176 TO B-209, E-69 TO E-165 & F-01 TO F-84	83.624	150.52	62.72	2	389	32529.736	778	3501
150	A-01 TO A-55, E-01 TO E-68 & F-85 TO F-142	125.413	225.74	94.06	2	181	22699.753	362	1629
200	D-109 TO D-122, D-125 TO D-138, G-01 TO G-179, H-01 TO H-32	167.216	300.99	125.41	2	238	39797.408	476	2142
400	G-14	334.432	601.98	250.82	2	1	334.432	2	9
TOTAL						809	95,361.329	1618	7281 PERSONS

PROPOSED FACILITIES AREA DETAIL IN GROUP HOUSING PLOT (GH-01 & GH-02)					
S. NO.	PARTICULARS	PERMISSIBLE FAR	PLOT AREA AS PER REQUIREMENT	REQUIREMENT	PERMISSIBLE FAR AREA
1	COMMUNITY CENTRE	150	4000	1.6	6400
	TOTAL				9600

S.NO.	PLOT DESCRIPTION
01	TYPE- 100 SIZE - 83.624 SQ.MT. (100 SQ.YDS.)
02	TYPE- 150 SIZE - 125.413 SQ.MT. (150 SQ.YDS.)
03	TYPE- 200 SIZE - 167.216 SQ.MT. (200.00 SQ.YDS.)
04	TYPE- 400 SIZE - 334.432 SQ.MT. (400 SQ.YDS.)

NOTES-

1-For all types of plots setback, ground coverage, building height and F.A.R. as per Yamuna Express Way prevailing byelaws.

2-On 18.0 meter and 24.0 meter wide road, alternate variety of everLANDSCAPE and ornamental trees shall be planted @ 7.5 meter center to center.

3-On road upto 12 meter ornamental trees will be planted @ 5 meter center to center of single variety in each pocket.

LANDUSE DISTRIBUTION			
PLOT AREA(SQ.MTS.)	AREA(SQ.MTS.)	%AGE	4,08,545,000
RESIDENTIAL			
PLOTTED	95,361.329		
GROUP HOUSING-01	58,651.226	2,09,810.368	51.36%
GROUP HOUSING-02	55,797.813		
COMMERCIAL	20,354.500		4.98%
INSTITUTIONAL	22,500.000		5.51%
ROADS, PARK & OPEN SPACES			
LANDSCAPE	61290.000	1,55,880.132	15.00%
ROADS & OPEN	94590.132		23.15%

LEGEND	DESCRIPTION
	MUNICIPAL LINE
	WATER SUPPLY LINE
	DOMESTIC WATER SUPPLY LINE PLOTTED
	FLUSHING WATER SUPPLY LINE PLOTTED
	WATER TREATMENT PLANT
	SEWAGE TREATMENT PLANT

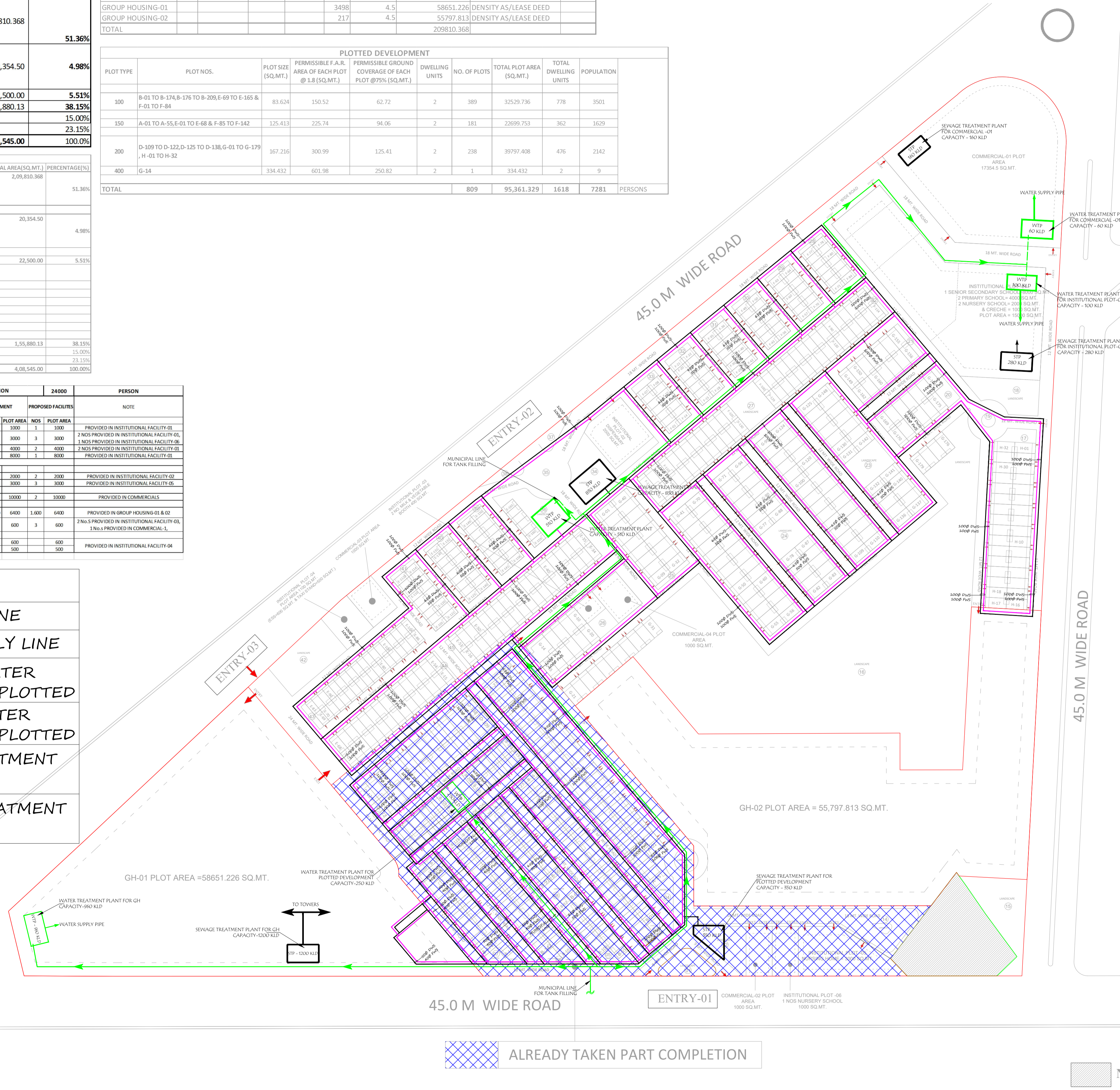

ALREADY TAKEN PART COMPLETION

NON POSSESSION LAND

PROJECT :- " GOLF COUNTRY "
AT PLOT NO. TS-05, SECT-22(D), AT YAMUNA EXPRESS WAY.

BUILDERS & PROMOTER :-
M/s SUPERTech TOWNSHIP PROJECT LTD.
Off. :- B-28,29, SECTOR-58, NOIDA (U.P.)

DRAWING TITLE :-
SITE PLAN - WATER SUPPLY LAYOUT

ARCHITECTS :-
Space Designers International
 B - 34, SECTOR-67, NOIDA
 PH : +91 9711633717, 18,19 & 20
 Mob: 9811070399, 9811336231
 e-mail : spacedsi@gmail.com, www.spacedsi.com

SERVICES CONSULTANTS
Proion Consultants Pvt. Ltd.
 Building Services - MEP Consulting
 82, Sukhdev Vihar,
 New Delhi 110 025, India.
 Phone: 011.2632.4400, www.proion.net

DRAWN BY :- SANJAY **CHECKED BY :-** VISHAL **SCALE** 1 : 2000 **DATED :-**

OWNER SIGNATURE **ARCHITECT'S SIGN.** DRG.NO.-PC-WS-04