

TOTAL LAND AREA IN DEED = 8960.00 SQ.MT.
 TOTAL LAND AREA ON SITE = 8959.83 SQ.MT.
 ROAD WIDENING AREA = 629.63 SQ.MT.
 NET LAND AREA ON SITE = 8330.20 SQ.MT.

REQ. GREEN 15% = 1249.53 SQ.MT.
 PROVIDED GREEN = 1338.41 SQ.MT.
 REQ. COMMERCIAL 5% = 354.91 SQ.MT.
 PROVIDED COMMERCIAL = 302.41 SQ.MT.
 BAZAR STREET PLOT'S AREA (B-1 TO B-11) = 1231.85 SQ.MT.
 PLOTTED AREA = 3636.42 SQ.MT.
 ROAD AREA = 1821.11 SQ.MT.

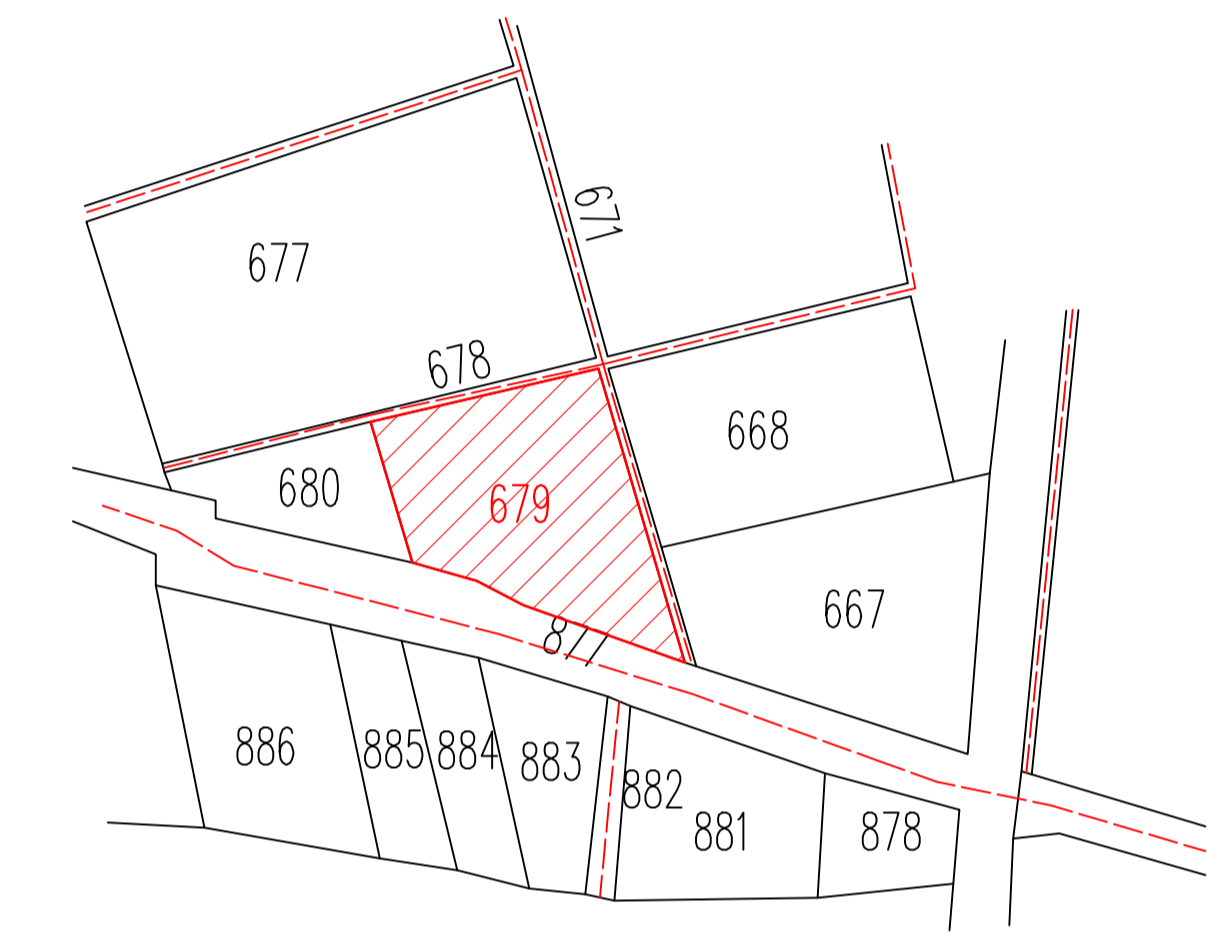

PART OF SAZRA PLAN

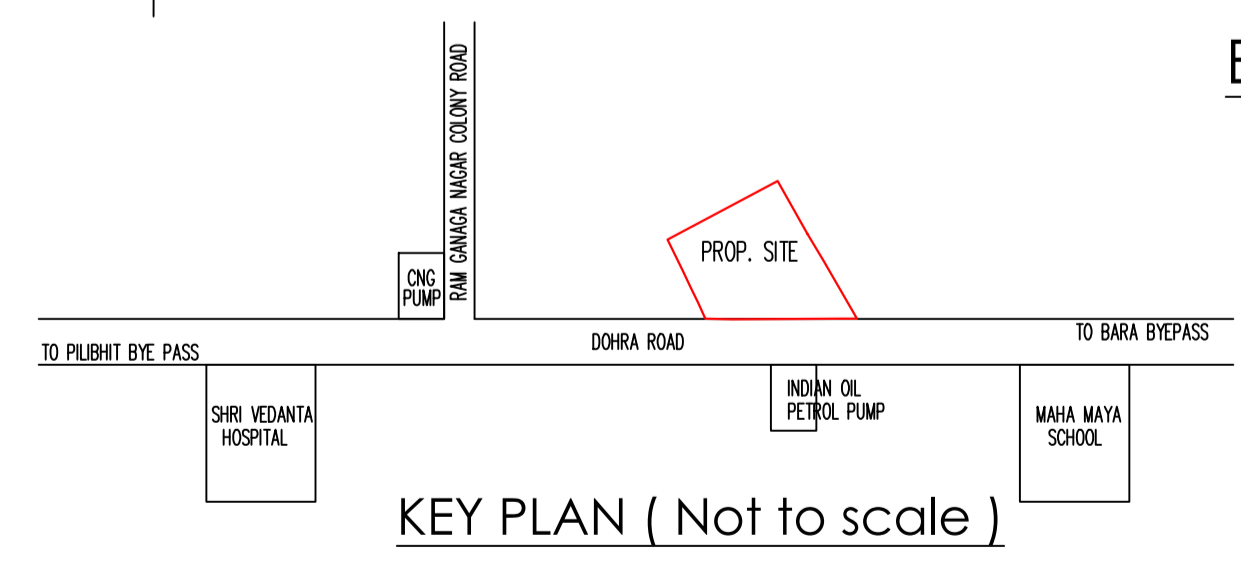

ELECTRICITY SUPPLY PLAN (1:100)

SERVICES:--	LEGEND:--
<p>LEGEND:</p> <p>PROPOSED ELECTRIC LINE</p> <p>PROPOSED ELECTRIC POLE</p>	<p>PROP. WORK</p>

LAYOUT PLAN OF (ROYAL RESIDENCY) UNDER AFFORDABLE SCHEME AS PER GOVERNMENT ORDER NO. 63/2021/1093/8- 1-21-34 SITTING/2014 T.C. DATED 23 SEPTEMBER 2021, FOR AKASH BUILDTECH PVT. LTD. AKASHPURAM BAREILLY THROUGH ITS DIRECTOR SHRI SHYAM SINGH RATHORE S/O SHRI STYADEV RATHORE OFFICE - 5, AKASH TOWER, PILIBHIT BYE PASS, BAREILLY. SITE AT KHELT NO. 679, VILLAGE CHANDPUR BICHPURI, PARGANA, TEHSIL AND DISTT. BAREILLY.

NORTH/ SCALE:--

AS SHOWN

APP. SIGN.:--

ARCHITECT:--

PAWAN BHATT
 M.Arch.
 P-6-7 BEHIND B.B.L. SCHOOL
 D.D. PURAM BAREILLY.
 9837059454 (M)