

SITE PLAN

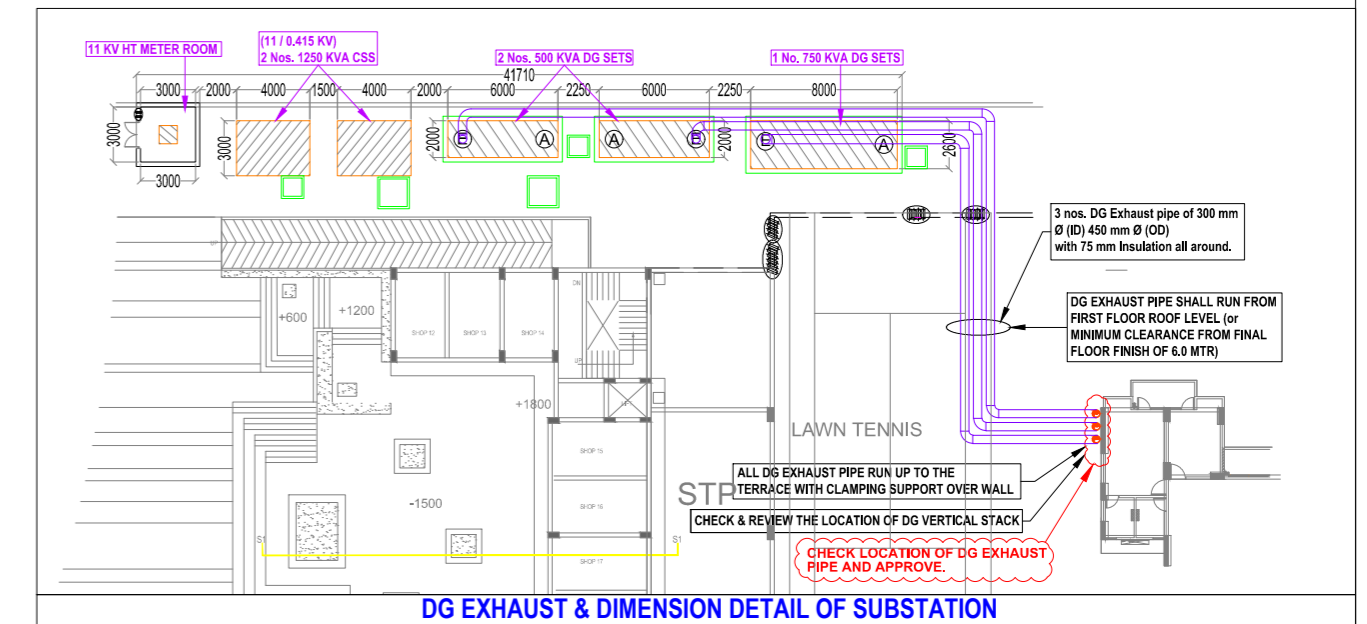
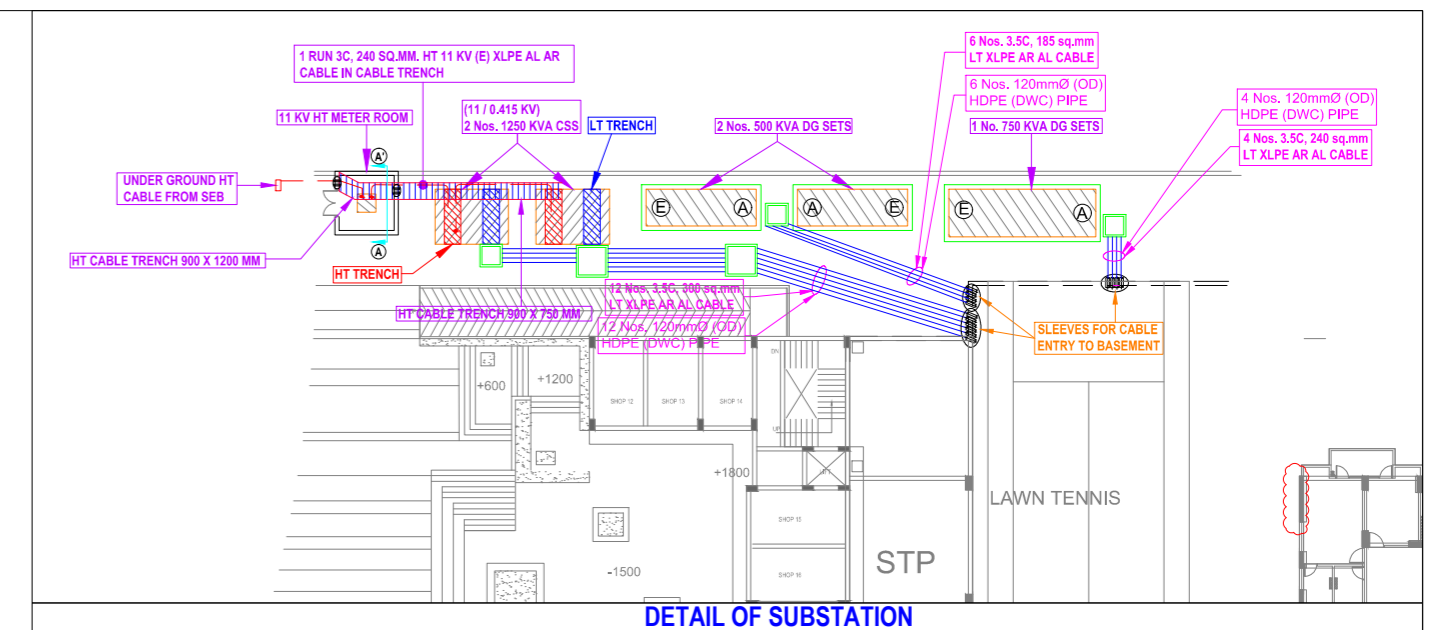

NOTE:- TRENCH WILL BE FINALIZED BY THE SEB AUTHORITY PERSON

NOTE :- CLEAR HEIGHT OF ROLLING SHUTTER = 3000 MM (MIN) FROM FFL.

IMPORTANT NOTES :

1. CSS / TRANSFORMER & DG SETS FOUNDATION SHALL BE GIVEN BY VENDOR.
2. VCB PANEL SIZE SHALL BE GOT APPROVED FROM CONSULTANT BEFORE PLACEMENT OF ORDER.
3. EXACT LOCATION OF CABLE TRENCH SHALL BE FINALIZE AFTER GETTING THE DETAIL OF GLAND PLATE IN HT PANEL.

NOTES :

- 1) Clear height of 11 Kv Meter room shall be minimum 3.6 mtr. below clear beam.
- 2) Plinth Level of Meter room & VCB room shall be 450 mm above final finished ground level.
- 3) Trench detail shall be finalized after receiving foundation detail of HT Meter Panel & 11 KV VCB Panel.
- 4) Ventilation is to be planned as per architecture surrounding level.

REV. NO.	DATE	REVISION
R5.	30.12.2016	SUBSTATION LOCATION REVISED
R4.	15.12.2016	SUBSTATION LOCATION REVISED AS PER CLIENT.
R3.	08.12.2016	SUBSTATION LOCATION REVISED AS PER CLIENT.
R2.	27.05.2016	REVISION DUE TO FAR REVISED.
R1.	26.05.2016	11 KV METER ROOM REVISED.
R0.	19.05.2016	GFC ISSUED.

project  
**PANCHSHEEL PRATISHTHA**  
(AT SECTOR-75)

title  
**ELECTRICAL DRAWING**

subtitle  
**SETTING-OUT LAYOUT**  
(SITE PLAN)

drawing released for  
 APPROVAL     SUBMISSION  
 ADVANCE COPY     CONSTRUCTION

drg. no. PPR/ELEC/EXT.-01    drawn by Girish  
 scale 1:400 @ A1    designed by Ateeq Ur Rehman  
 date December, 2016    checked by Anand Havelia

architects  
**OASIS DESIGNS INCORPORATED**  
 3172, SEC-A, PKT-B, VASANT KUNJ, NEW DELHI-70  
 PH: 26122440, 26122044 FAX: 26122325 EMAIL: design.oasis@gmail.com

services consultant  
**Consummate Engineering Services (P) Ltd.**  
 Noida Office : B - 67, Sector - 67, Noida - 201 301  
 Tel : (0120) 6943500 ( 24 Lines )  
 Lko Office : R 006, Rohitas Plumeria, Condit Nagar, Lucknow  
 e mail : mail@cespl.in, website : www.cespl.in

