

Note: G.O. no. 4384/8-3-11-181 vividh /2008 dated 27/09/2011 , para(v) (क) के अनुसार विकासकर्ता को इन्स्टिट्व

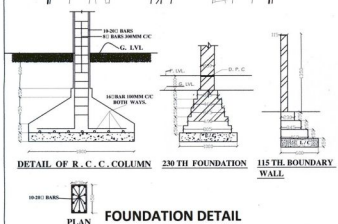

SERVICES AND LANDSCAPE PLAN  
SCALE:1:500

LEGEND	
	DRAINAGE LINE
	HARVESTING WELL
	SEWER LINE
	WATER SUPPLY LINE
	MANHOLE

RAIN WATER HARVESTING

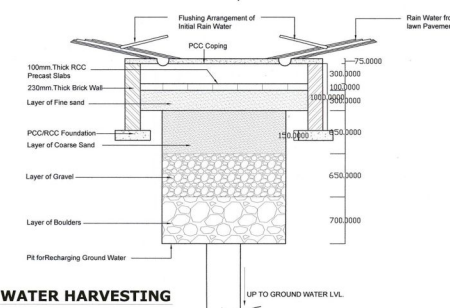

This drawing is a "COPYRIGHT" contents of this drawing or part thereof may not be used or reproduced without the permission of the Architect

**LEGEND**

PUBLIC & SEMI-PUBLIC

RESIDENTIAL

**LOCATION IN MASTER PLAN**

**NOTE:**

Required additional units of EWS and LIG of proposed Group Housing -2 on kh.No.397sa & 399 Village Ardaunamau, Tehsil - Sadar, Lucknow, Distt. Lucknow.

to be provided in Group Housing on Kh.No.182p,183p,184p in village Ardanamau & Kh.No 18,19,20,21,22p,23,24p,25p,44p & 45p in Village Ahimamau at Gomti Nagar Extension Lucknow.

यह मानचित्र लखनऊ महायोजना 2021 तथा भवन उपविधि 2008 तथा सम्यक शासनादेशों के अनुरूप तैयार किया गया है।

**PROJECT**

PROPOSED GROUP HOUSING AT KHASRA NO. 182P, 183P, 184P IN VILLAGE ARDAUNAMAU & KHASRA NO. 18P, 19, 20, 21, 22P, 23, 24P, 25P, 44P & 45P IN VILLAGE AHIMAMAU AT GOMTINAGAR EXTENSION - LUCKNOW

**DRAWING TITLE**

SUBMISSION DRAWING  
LANDSCAPE & SERVICES PLAN

DEALT BY GEETA	ARCHITECT RAJENDRA	REVISION
SCALE 1:500	CHECKED BY VIRESH KUMAR	DATE JULY 2015

OWNER'S NAME:  
PAARTH Infrabuild Pvt.Ltd. and Other's

**ARCHITECT**

**RAD**  
RUDRABHISHEK ARCHITECTS  
AND DESIGNERS  
A-6, Sector 58, Noida

**ARCHITECT**  
RUDRABHISHEK ENTERPRISES PVT. LTD.  
TOWN & COUNTRY PLANNERS,  
ARCHITECTS & INTERIOR DESIGNERS,  
SURVEY CIVIC, SERVICES DESIGNERS,  
GROUND FLOOR, YUVA BHAWAN, YMCA COMPLEX, 13 RANA PRATAP MARG LUCKNOW. CALL - (0522) 2206165

PROJECT DEVELOPED BY:-  
M/s PAARTH INFRABUILD PVT. LTD.

For:   
VIRESH KUMAR  
Architect  
Regd. No. : CA200905401

Authorised Signatory

**DRAWING NUMBER**  
PAARTH/SUB-2/11

**KH NO. 43**

**KH NO. 26**

**KH NO. 27**

**KH NO. 25**

**KH NO. 18**

**KH NO. 19**

**KH NO. 20**

**KH NO. 22**

**KH NO. 44**

**KH NO. 45**