

INDEX:-
 SEWERAGE PLAN

Scheme Boundary

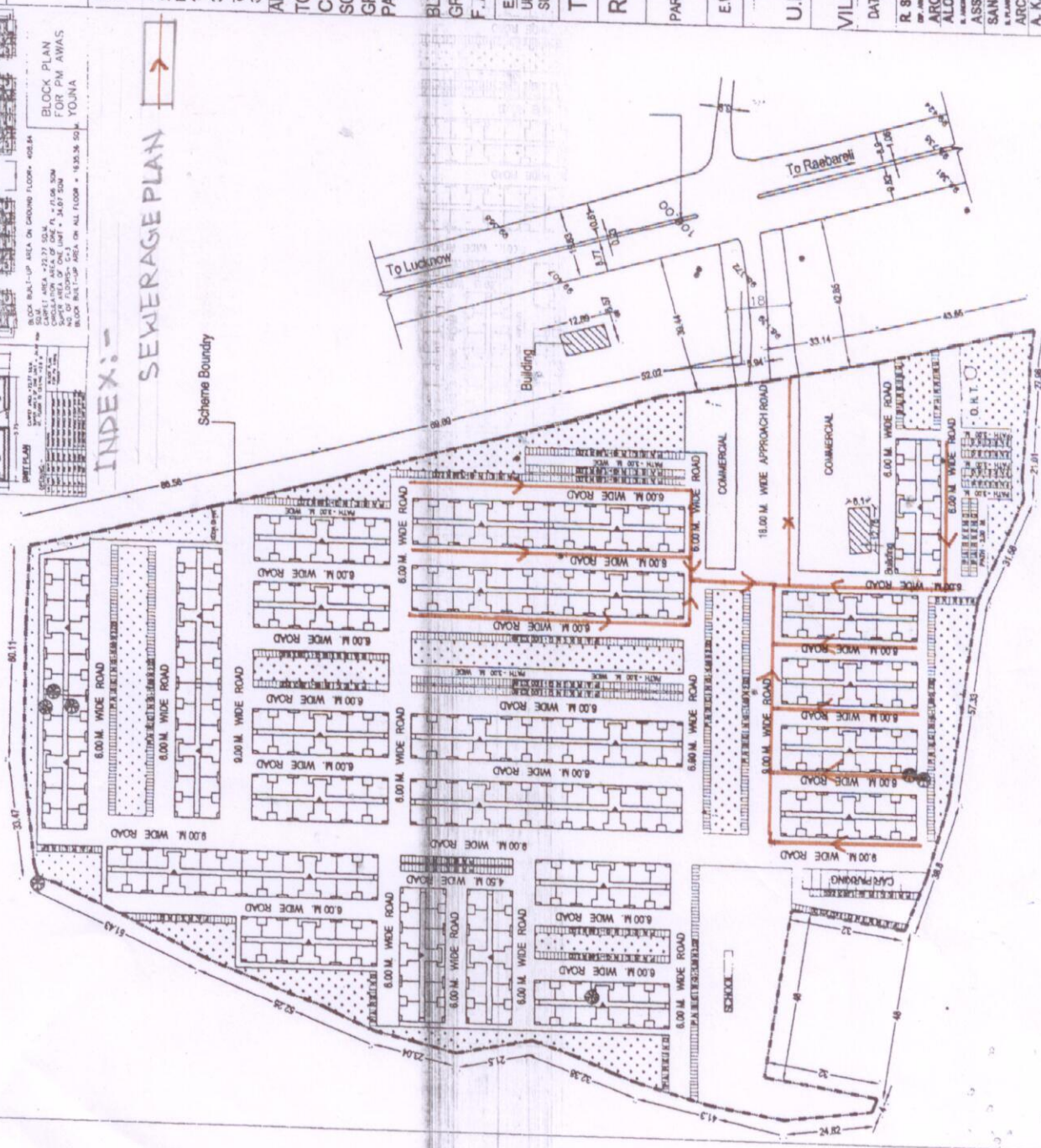

UPAVP

ARCHITECTURE AND PLANNING SECTION
 NEELGIRI COMPLEX, INDIRA NAGAR
 LUCKNOW - 2260116
 Email : upavp@sancharnet.in

ISO-9001:2000

LAYOUT PLAN PAMY

SHEET NO.

UPHDB/APD/UN-4/Pmay/C.D-II/
 KANKAHA/109/2018

DRG.NO.

NOTE :-

1. THIS LAYOUT PLAN HAS BEEN PREPARED ON THE BASIS OF INFORMATION RECEIVED FROM EX. EN. C.D.-11 VIDE HIS LETTER NO. 1935AM/724 DATED 24.08.2018.
2. THIS LAYOUT PLAN HAS BEEN FINALIZED ON THE BASIS OF FEASIBILITY RECEIVED FROM EX. EN. C.D.-11 VIDE HIS LETTER NO. 1982M/716 DATED - 28.08.2018.
3. प्रधानमंत्री आवास योजना के अन्तर्गत परिषद को दिये गये निर्धारित लक्ष्य के सापेक्ष उक्त योजना में भवनों का निर्माण डिग्राउण्ड सर्वे के आधार पर कराया जाना है।

AREA STATEMENT:-

- TOTAL LAND AREA - 42120.95 SQ.M (4.2 Hect.)
- COMMERCIAL AREA - 1839.62 SQ.M (4.32%)
- SCHOOL AREA - 1789.00 SQ.M (4.25%)
- GREEN AREA - 6391.78 SQ.M (15.17%)
- PARKING - 1352 NO. (2704.0 sq.m)

- BLOCK AREA - @2sq.m /flat as per norms
- GROUND COVERAGE - 408.84 Sqm
- F.A.R - 11.447.52 Sqm. 27.17%

E.W.S. TYPE DESIGN
 UNIT CARPET AREA - 22.27 SQ.MT.
 SUPER AREA OF ONE FLAT - 34.07 SQ.MT. 3676.00 Sqm

TOTAL LAND AREA - 42120.95 SQ.MT.

RESIDENTIAL:- TOTAL UNITS - 1344 432

PARTICULAR	NO. OF BLOCK	NO. OF UNIT IN EACH BLOCK	NO. OF FLOOR	TOTAL UNITS	UNIT AREA (SQ.MT.)	SUPER AREA OF UNIT (SQ.MT.)
E.W.S.	9	48	G + 3	1344	22.77	34.07

ARCHITECTURE & PLANNING UNIT - 4

U.P. AVAS EVAM VIKAS PARISHAD LUCKNOW

LAY-OUT PLAN OF P.MAY

VILL. - KANKAHA, MOHAN LAL GANJ, LUCKNOW.

DATE : 31-08-2018

R. S. MAURYA

ARCH. ASSTT.

ALOK KUMAR VERMA

ASSTT. ARCH. PLANNER

SANJEEV KASHYAP

ARCHITECT PLANNER

A. K. SHUKLA

CHIEF ARCHITECT PLANNER

AJAY CHAUHAN

I. A. S.

AVAS AYUKT