

TOTAL LAND AREA IN DEED = 8960.00 SQ.MT.
 TOTAL LAND AREA ON SITE = 8959.83 SQ.MT.
 ROAD WIDENING AREA = 629.63 SQ.MT.
 NET LAND AREA ON SITE = 8330.20 SQ.MT.

REQ. GREEN 15% = 1249.53 SQ.MT.
 PROVIDED GREEN = 1338.41 SQ.MT.
 REQ. COMMERCIAL 5% = 354.91 SQ.MT.
 PROVIDED COMMERCIAL = 302.41 SQ.MT.
 BAZAR STREET PLOT'S AREA (B-1 TO B-11) = 1231.85 SQ.MT.
 PLOTTED AREA = 3636.42 SQ.MT.
 ROAD AREA = 1821.11 SQ.MT.

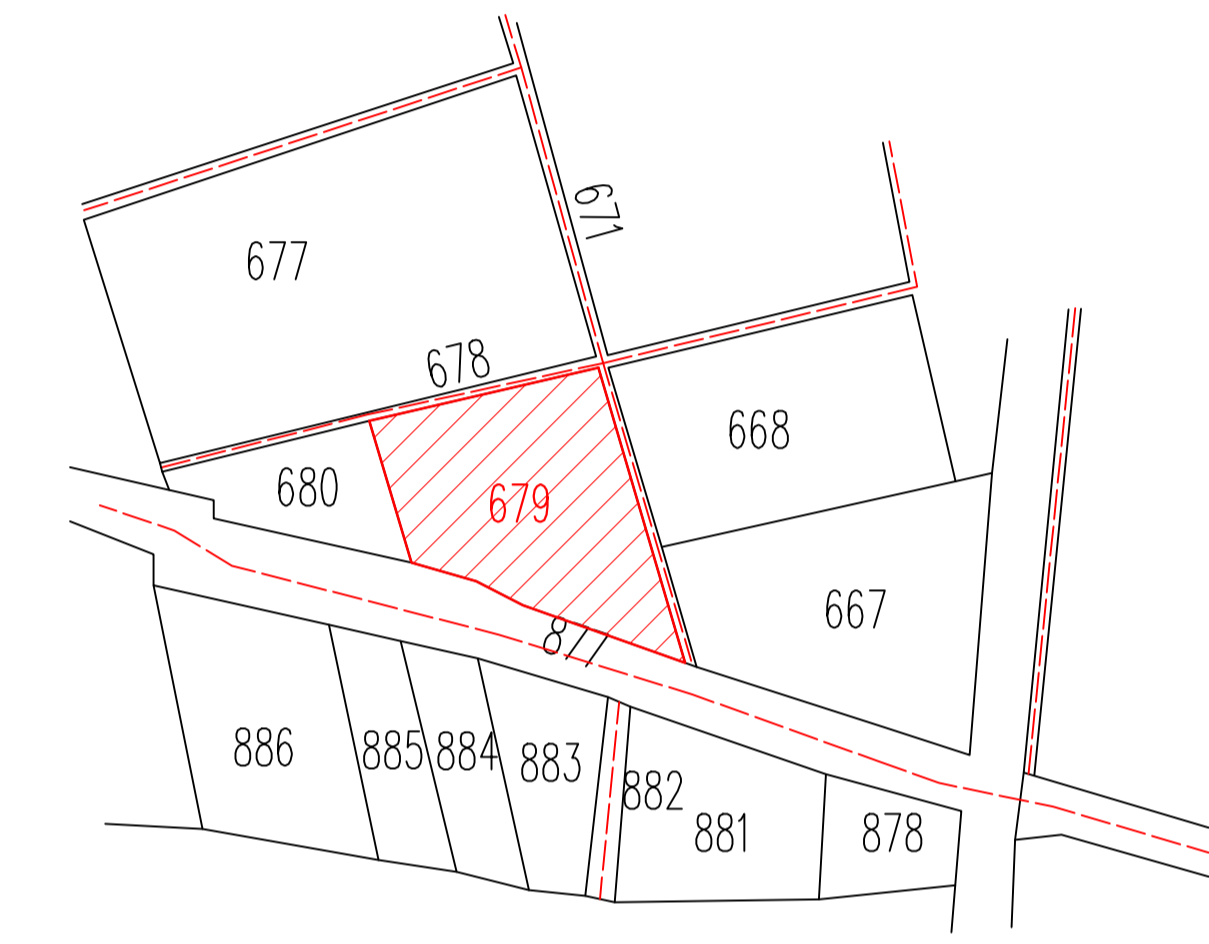

PART OF SAZRA PLAN

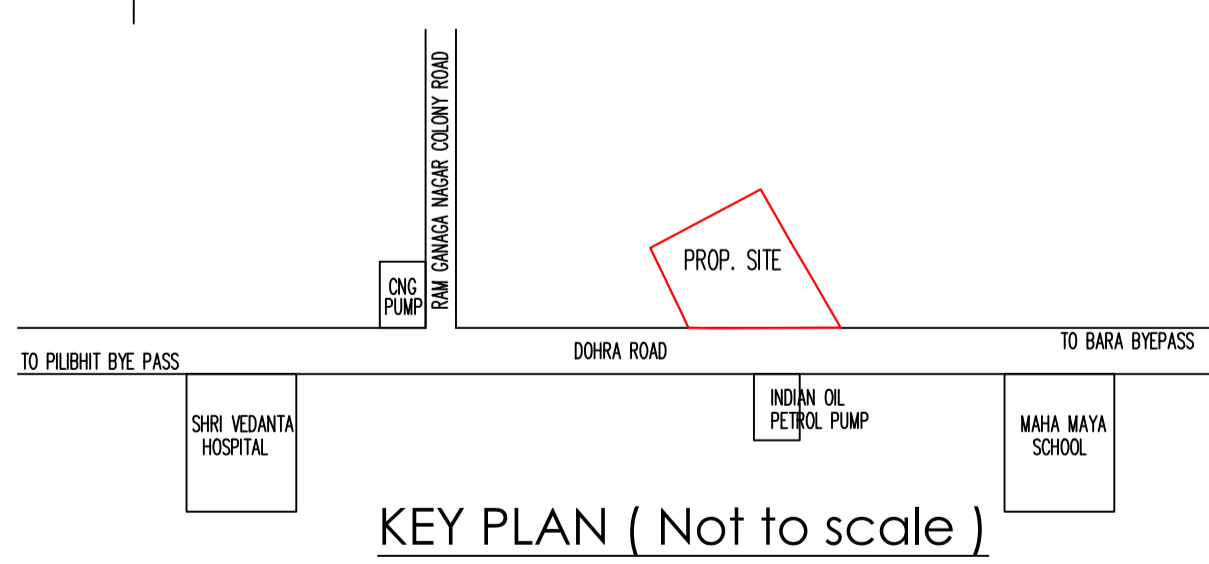

KEY PLAN (Not to scale)

DRAIN & SEWERAGE SUPPLY PLAN (1:100)

SERVICES:--	LEGEND:--					
		<table border="1"> <thead> <tr> <th>SIZE OF MH.</th> <th>DEPTH OF MH.</th> </tr> </thead> <tbody> <tr> <td>900X900MM</td> <td>600MM TO 900MM</td> </tr> <tr> <td>910MM#</td> <td>910MM TO 1670MM</td> </tr> </tbody> </table>	SIZE OF MH.	DEPTH OF MH.	900X900MM	600MM TO 900MM
SIZE OF MH.	DEPTH OF MH.					
900X900MM	600MM TO 900MM					
910MM#	910MM TO 1670MM					

LAYOUT PLAN OF (ROYAL RESIDENCY) UNDER AFFORDABLE SCHEME AS PER GOVERNMENT ORDER NO. 63/2021/1093/8- 1-21-34 SITTING/2014 T.C. DATED 23 SEPTEMBER 2021, FOR AKASH BUILDTECH PVT. LTD. AKASHPURAM BAREILLY THROUGH ITS DIRECTOR SHRI SHYAM SINGH RATHORE S/O SHRI STYADEV RATHORE OFFICE - 5, AKASH TOWER, PILIBHIT BYE PASS, BAREILLY. SITE AT KHET NO. 679, VILLAGE CHANDPUR BICHPURI, PARGANA, TEHSIL AND DISTT. BAREILLY.

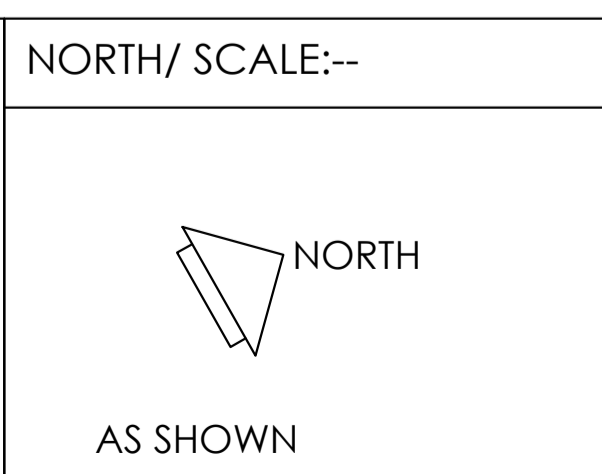

APP. SIGN.:--

ARCHITECT:--

PAWAN BHATT
 M.Arch.
 P6-7 BEHIND B.B.L. SCHOOL
 D.D. PURAM BAREILLY.
 9837059454 (M)