

**UPAVP**  
 ARCHITECTURAL AND PLANNING SECTION  
 NEELGIRI COMPLEX, INDIRA NAGAR  
 LUCKNOW-226016  
 Email : uphb@sancharnet.in

DRG. NO. PROPOSED/PART L.O.P./PMAY/BHINGA MARG/BAHRAICH/2017/..64  
 FILE NO. APD/UNIT-6/PRADHAN MANTRI AVAS YOJNA (PMAY)/BHINGA MARG/BAHRAICH/OI(PART-2)  
 PROCESS NAME/NO. UPHDB/PM/APD/03

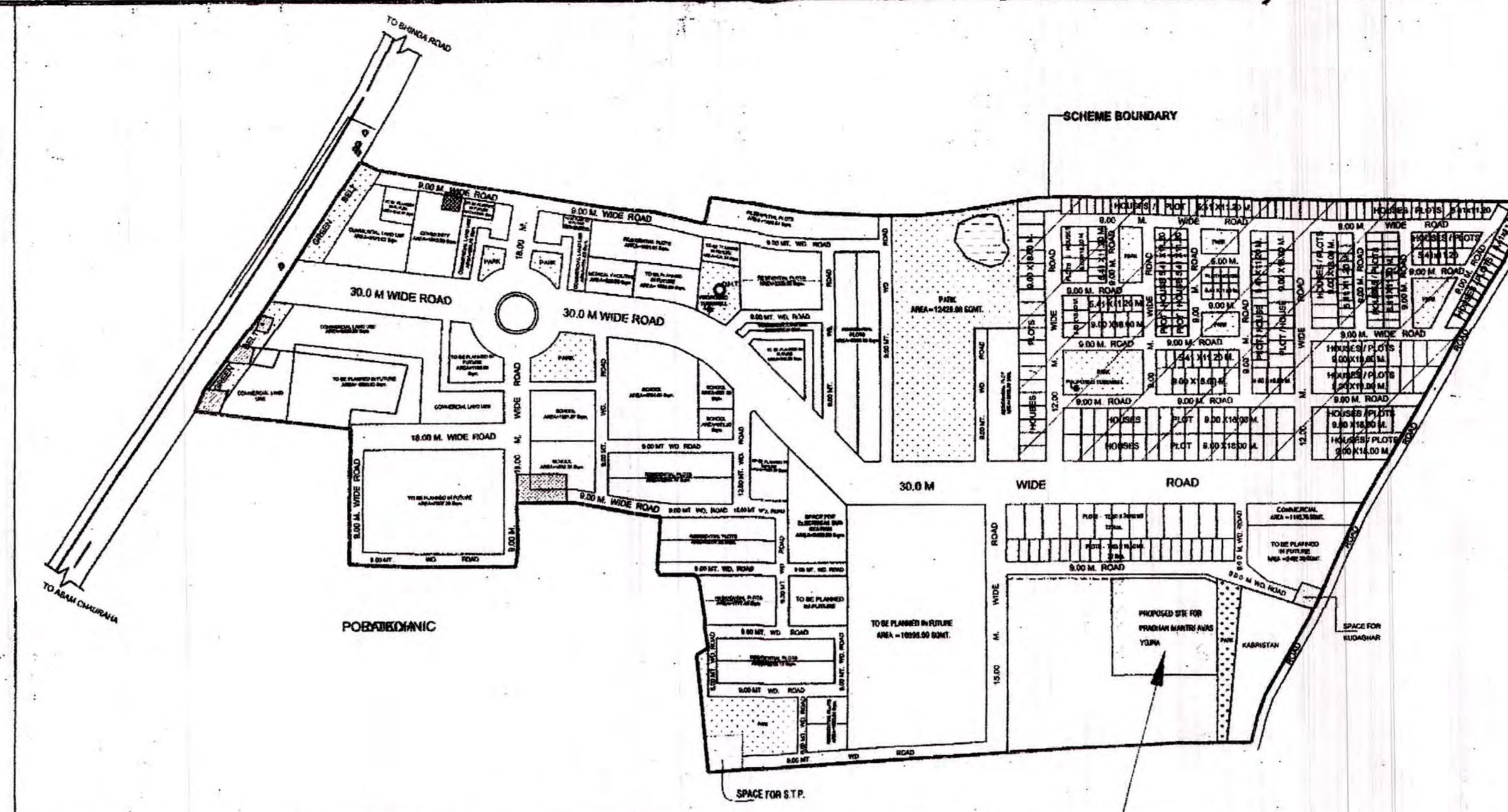

PREVIOUSLY PLANNED 9.00 MT. WIDE ROAD REVISED TO 12.00 MT. WIDE ROAD.

PREVIOUSLY SANCTIONED L.O.P. DTD.07.06.2017

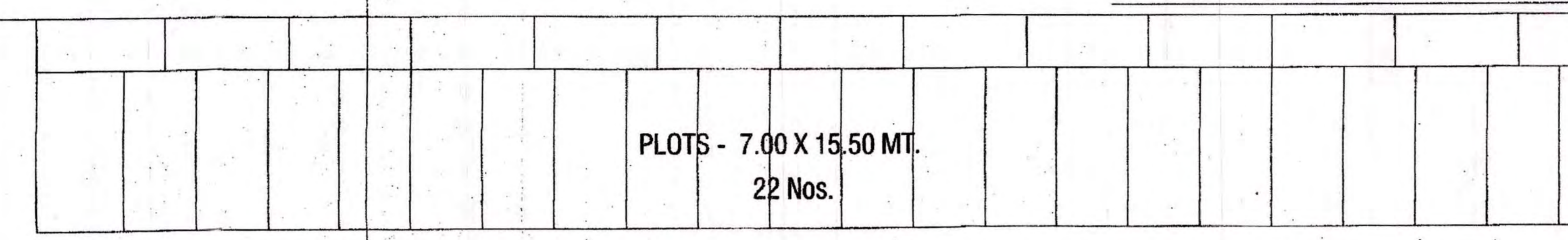

12.00 MT. WIDE ROAD

15.00 M. WIDE ROAD

TO BE PLANNED IN FUTURE  
 AREA = 16098.00 SQMT.

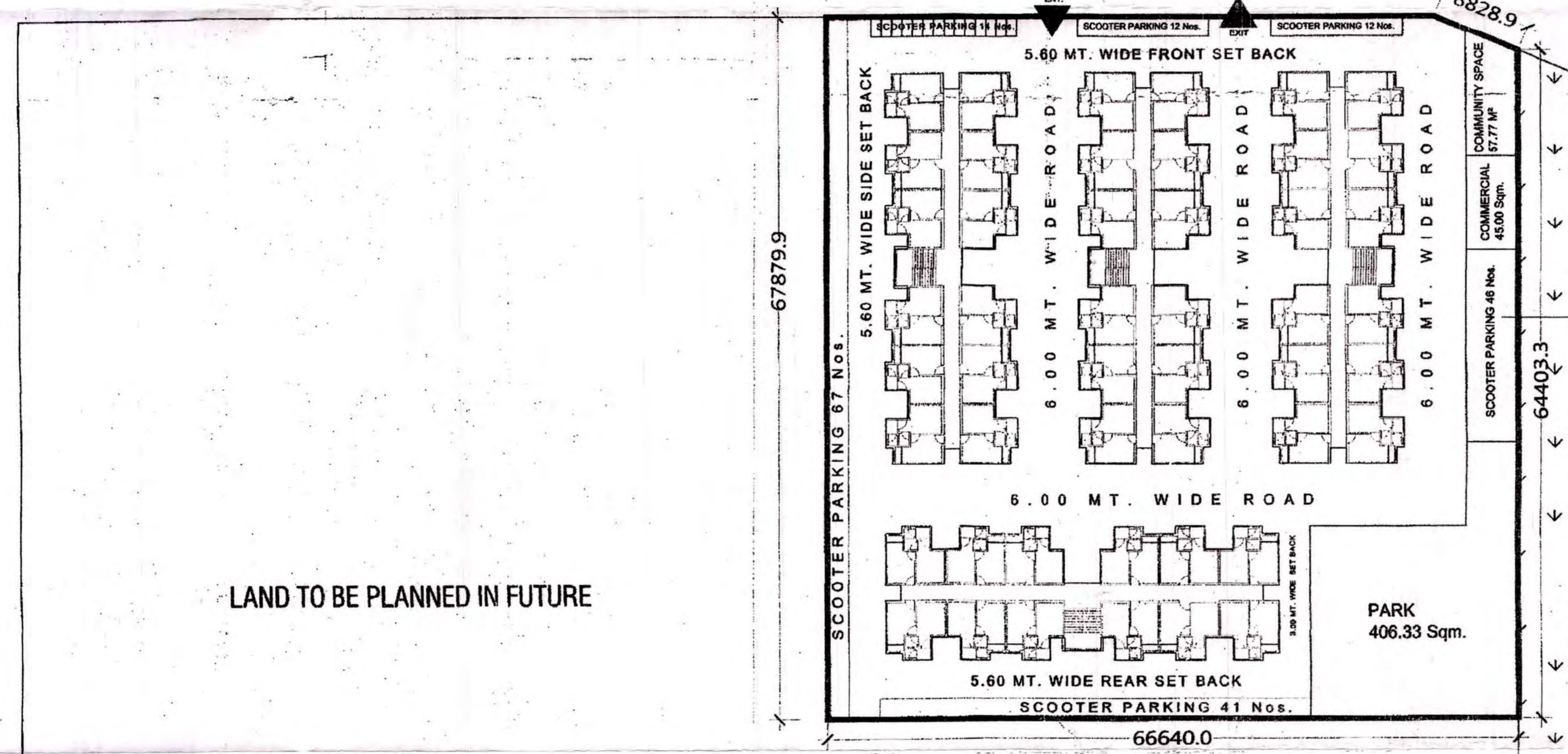

LAND TO BE PLANNED IN FUTURE

निर्माण हेतु प्रमाणित  
 21/12/2017

PLOT AREA 4509.41 M<sup>2</sup>  
 F.A.R. PROPOSED 1.45 (6541.44 M<sup>2</sup>)  
 GROUND COVERAGE 36.00% (1635.36 M<sup>2</sup>)  
 TOTAL NO. OF FLOORS G+3  
 TOTAL NO. OF UNITS (E.W.S.) = 192 NOS.  
 DENSITY = 427 Unit/HECT.  
 TOTAL POPULATION = NO OF UNITS X 5 PERSONS  
 192 X 5 = 960 PERSONS

**REQUIRED SPACE FOR COMMUNITY CENTER**  
 FOR 25000 PERSONS 1500.00 M<sup>2</sup>  
 FOR 960 PERSONS  $\frac{1500 \times 960}{25000} = 57.60$  M<sup>2</sup>  
 PROP. SPACE FOR COMMUNITY CENTER = 57.77 M<sup>2</sup>

**REQUIREMENT OF CONVENIENT SHOPS**  
 FOR 400 PERSONS 01 SHOP @ 15.00 M<sup>2</sup>  
 FOR 960 PERSONS  $\frac{960}{400} = 2.4$  SAY 3 Shops  
 REQUIRED AREA = 15X3=45.00 M<sup>2</sup>  
 PROP. SPACE FOR CONVENIENT SHOPS = 45.00 M<sup>2</sup>

PROP. SPACE FOR GREEN /PARK = 406.33 M<sup>2</sup> OR 9.01%  
 PROP. SCOOTER PARKING = 192 Nos.

DRG. TITLE LAY OUT PLAN FOR PRADHAN MANTRI AVAS YOJNA

PROJECT BHINGA MARG YOJNA, BAHRAICH.

DATE : 21-12-2017

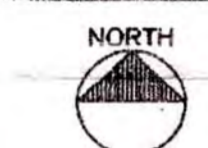

SCALE:

VIBHA SRIVASTAVA A.I.I.A. ARCH. ASSTT.	<i>[Signature]</i>
PRABHAVATI SURI A.I.I.A. ASSTT. ARCH. PLANNER	
JYOTI KATIYAR B. ARCH. ARCHITECT PLANNER	<i>[Signature]</i> 21/12/2017
MAHENDRA KUMAR CHIEF ARCHITECT PLANNER	<i>[Signature]</i> 21/12/17
DHEERAJ SAHU I. A. S. HOUSING COMMISSIONER	<i>[Signature]</i> 21/12/17

**NOTE**  
 1-AS THIS LAY OUT IS PREPARED WITHOUT PRIOR INFORMATION ABOUT ACTUAL DEMAND OF HOUSES UNDER PRADHAN-MANTRI AVAS YOJNA THEREFORE THE IMPLEMENTATION AND THE EXECUTION OF THE LAY OUT ON THE SITE SHALL BE MADE AS PER ACTUAL DEMAND IN THE BAHRAICH CITY.  
 2-THIS LAY OUT IS SUBJECT TO REVISION AS PER ACTUAL DEMAND OF HOUSES UNDER PRADHAN-MANTRI AVAS YOJNA .