

REVISED & EXTENSION RESIDENTIAL LAYOUT PLAN OF "SWASTIK CITY" SITUATED AT KHASRA NO- 490(PART), 491(PART), 503 (PART), 504(PART) 493, 496 (PART), 489 & 466 ,465 , 467 MOUZA-BUDHA, JHANSI.

OWNER :-
 SWASTIK INFRA DEVELOPERS, JHANSI
 (1) Mr. RAKESH SINGH S/O LATE SHRI CHANDRA SHEKHAR SINGH
 (2) Mr. NIKHIL CHHABRA S/O LATE SHRI KISHAN CHHABRA
 (3) Mr. MAYUR AGRAWAL S/O RAJESH AGRAWAL
 (4) Mr. RAJESH AGRAWAL S/O JAGDAMBA AGRAWAL
 (5) Mr. POORAN S/O SHRI GHANSHYAM
 (6) Mr. ANKIT CHHABRA S/O LATE SHRI KISHAN CHHABRA
 (7) Mr. AMIT SINGH S/O LATE SHRI CHANDRA SHEKHAR SINGH
 (8) M/S S.R.K DEVELOPERS

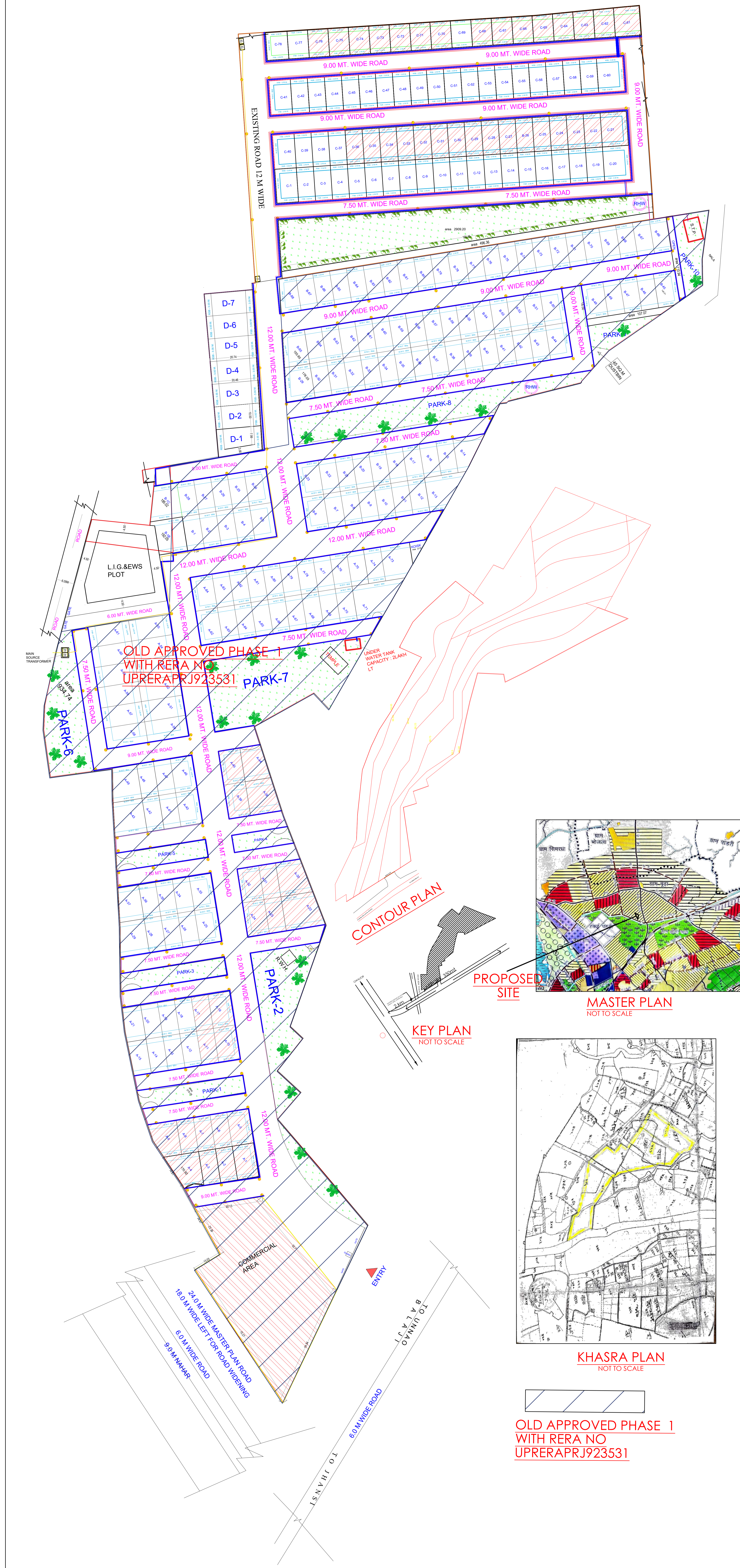

OLD APPROVED PHASE 1 WITH RERA NO UPRERAPRJ923531

CONTOUR PLAN

KEY PLAN NOT TO SCALE

PROPOSED SITE

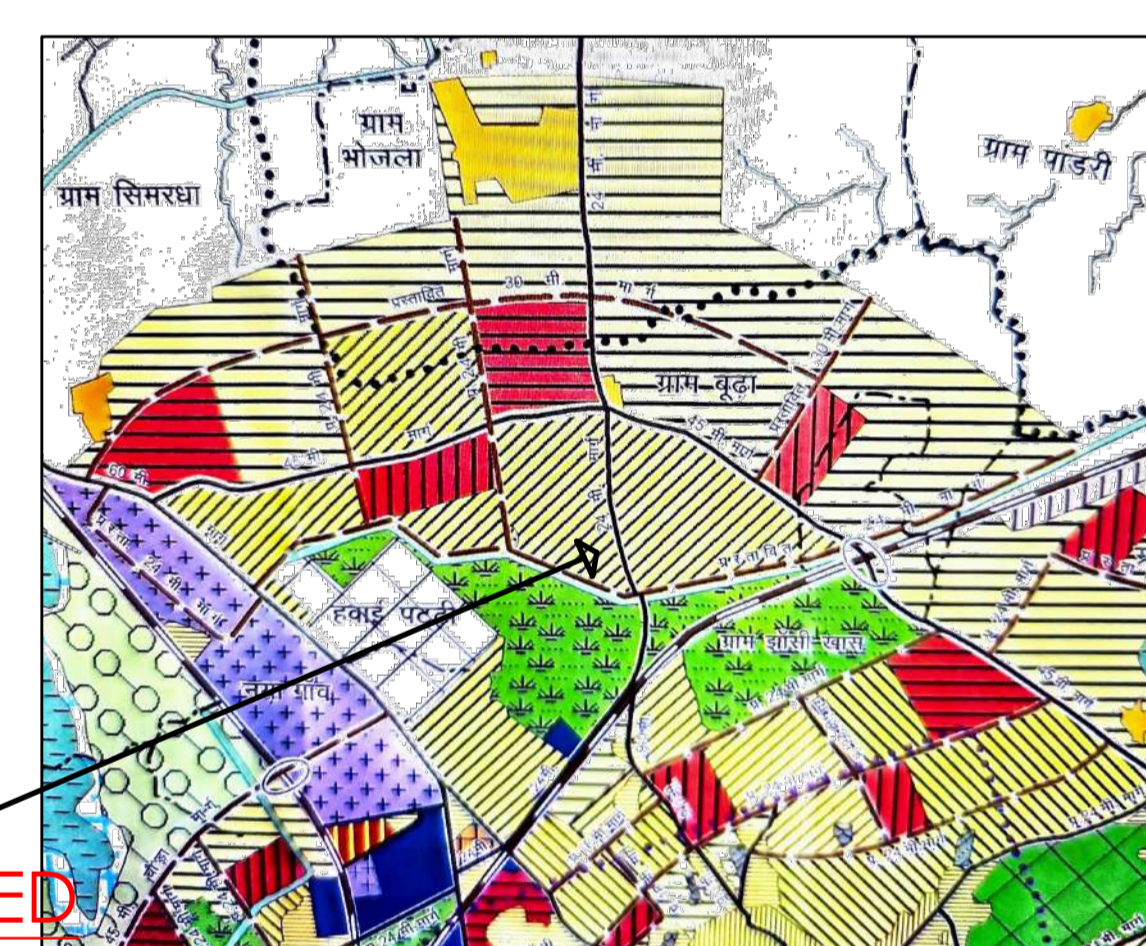

MASTER PLAN NOT TO SCALE

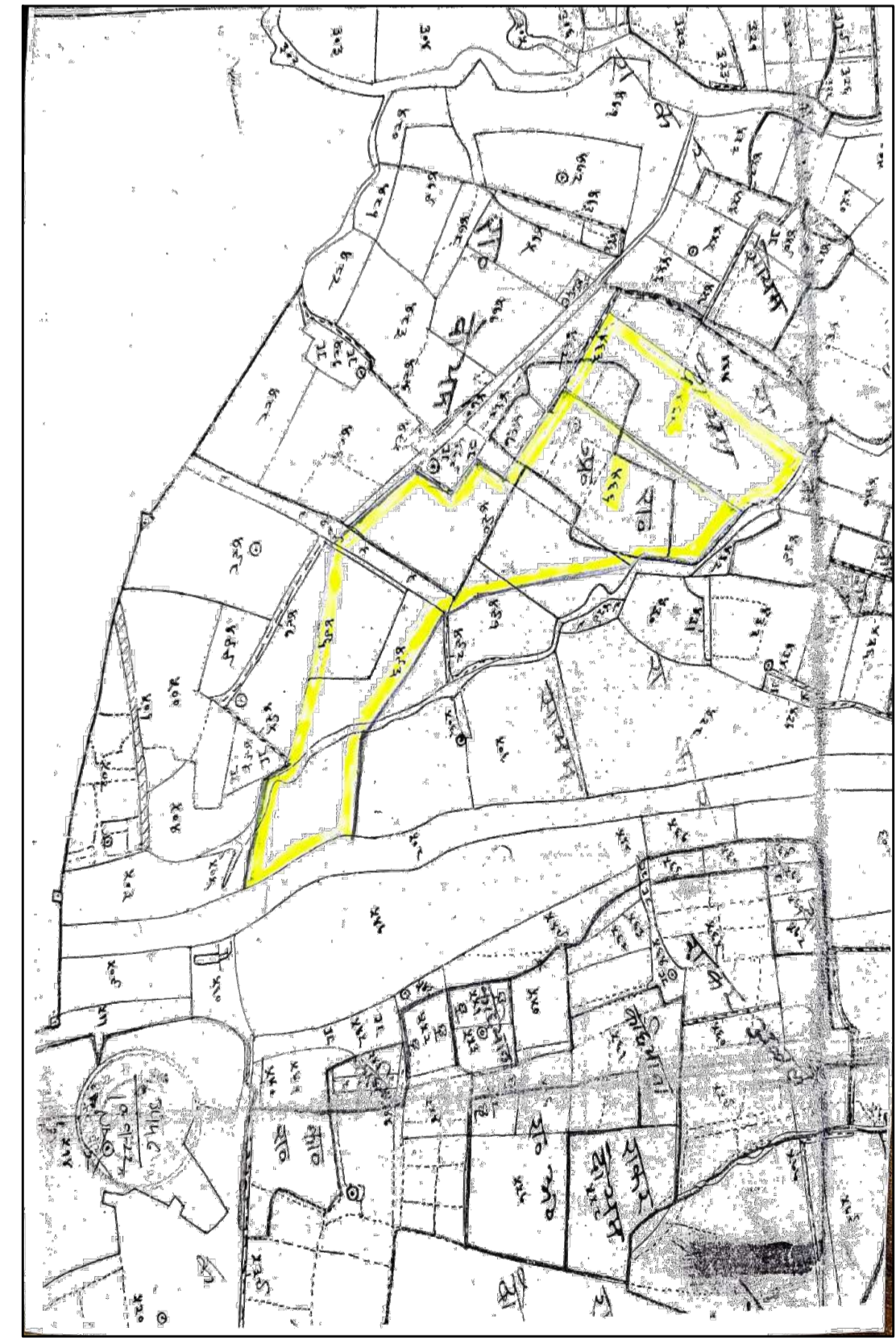

KHASRA PLAN NOT TO SCALE

OLD APPROVED PHASE 1 WITH RERA NO UPRERAPRJ923531

LEGEND	
1. TREES	
2. SET BACK LINE	
3. WATER SUPPLY LINE	
4. ELECTRICITY POLE	
5. GARBAGE BIN	
6. TRANSFORMER	
7. RAIN WATER HARVESTING	
8. SEWAGE LINE	
9. DRAIN	

NOTE :-
 1- SEPARATE SEPTIC TANKS ARRANGED BY SELF INDIVIDUAL PLOT/HOUSE HOLDERS
 2- THE DRAINAGE OF THE COLONY WILL BE DISCHARGE IN THE EXISTING STORM WATER DRAIN NEAR BY.
 3- TREES WILL BE PLANTED ALONG ROAD SIDE AT A DISTANCE OF 10 METER C/C
 4- FOR INDIVIDUAL UNIT WE HAVE PROVIDED UNDERGROUND ELECTRICITY WIRING

	C BLOCK
	D BLOCK
	EXISTING APPROVED BLOCK (A+B)
	EXTRA AREA FOR EWS & LIG & PLOT NO B-1B&1C
	COMMERCIAL AREA

OWNER'S SIGN:-	ARCHITECT'S SIGN:-
 SCALE DATE 17/03/2024	Shubh Architects ARCHITECTURE, INTERIORS, ENGINEERS, VALUERS & SURVEYORS 1st Floor, Shubham Complex, Near Tibet market, Ester Chouraha, Jhansi 9426262600, 7007620446 Mail: shubharchitects18@gmail.com