

- NOTES:-**
1. ALL DIMENSIONS ARE IN MM.
  2. ALL DIMENSIONS ARE TO BE READ AND NOT MEASURED.
  3. ANY DISCREPANCIES MUST BE BROUGHT TO THE NOTICE OF THE CONSULTANT BEFORE EXECUTION OF WORK AT SITE.
  4. THIS DRAWING MUST BE READ IN CONJUNCTION WITH ALL RELEVANT ARCHITECTURAL, STRUCTURAL, PLUMBING, FIRE FIGHTING AND ELECTRICAL DRAWINGS.
  5. THIS DRAWING IS THE SOLE PROPERTY OF MODARCHINDIA. IT SHOULD NOT BE USED, COPIED OR REPRODUCED IN ANY MANNER WITHOUT THE PRIOR PERMISSION OF MODARCHINDIA.
  6. ARCHITECTURAL DRAWINGS SHOULD BE FOLLOWED FOR ALL DIMENSIONS & LEVELS.

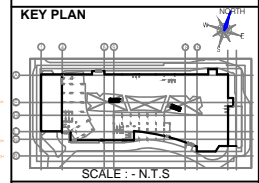

**DRAWING STATUS:-**  
FOR INFORMATION ONLY

No.	Date	Revision



STRUCTURAL CONSULTANT

**OPTIMIZATION CONSULTANTS**  
PROJECT COST OPTIMIZATION • STRUCTURAL ENGINEERING • PROJECT MANAGEMENT  
202-203, HIGHLAND HOUSE, KANARAPURA COMMERCIAL COMPLEX,  
NEW DELHI-110016, INDIA  
Email: optpre34@optoo.com

MEP Consultant

**V** B-50, Basement, Soami Nagar  
New Delhi-110017  
Tel No:011-49848197,49849205  
Consulting Email: info@vcosulting.co.in

PROJECT  
BOULEVARD WALK MALL AT PLOT NO-C - 02,  
SECTOR - 04, GREATER NOIDA (U.P.)

OWNER  
M/S BOULEVARD WALK INFRA TECH PVT.LTD.  
N-5, OPP. AXIS BANK, SECTOR - 18,  
NOIDA (U.P.)

ARCHITECT

**modarchindia**  
architecture, interior, environmental  
Plot no:- B-99 First Floor, sec-63 Noida  
PHONE NO: 01204205253

Drawing Title

**SITE PLAN**  
**ELECTRICAL SUPPLY LAYOUT**

Checked by	Approved by	Date	Drawn by
P.K. JHA		10.06.2019	SONIA
Scale	1:6000(A1)		
Drawing No.	MI-BW-EL-04		Revisions
			R0

