





FLOOR WISE FAR AREA STATEMENT RESIDENTIAL TOWER (THE ORCHARDS B-11)			
	TOWER TYPE - A	TOWER TYPE - B	TOTAL
NUMBER OF TOWER	6	5	11
GROUND COVER	4519.43	3750.69	8270.13
STILT FLOOR AREA	700.46	727.76	1428.22
UPPER GROUND FLOOR AREA	971.82	309.63	1281.45
F.A.R AREA ON 1st FLOOR	3337.44	3028.08	6365.52
F.A.R AREA ON 2nd FLOOR	3337.44	3028.08	6365.52
F.A.R AREA ON 3rd FLOOR	3754.00	3028.08	6782.08
F.A.R AREA ON 4th FLOOR	3754.00	3028.08	6782.08
F.A.R AREA ON 5th FLOOR	3754.00	3028.08	6782.08
F.A.R AREA ON 6th FLOOR	3754.00	3028.08	6782.08
F.A.R AREA ON 7th FLOOR	3404.07	3028.08	6432.15
F.A.R AREA ON 8th FLOOR	3432.01	3028.08	6460.09
F.A.R AREA ON 9th FLOOR	3754.00	3028.08	6782.08
F.A.R AREA ON 10th FLOOR	3754.00	3028.08	6782.08
F.A.R AREA ON 11th FLOOR	3754.00	3028.08	6782.08
F.A.R AREA ON 12th FLOOR	3754.00	3028.08	6782.08
F.A.R AREA ON 13th FLOOR	3754.00	3028.08	6782.08
F.A.R AREA ON 14th FLOOR	3754.00	3028.08	6782.08
F.A.R AREA ON 15th FLOOR	3404.07	3028.08	6432.15
F.A.R AREA ON 16th FLOOR	3432.01	3028.08	6460.09
F.A.R AREA ON 17th FLOOR	3754.00	3028.08	6782.08
F.A.R AREA ON 18th FLOOR	3754.00	3028.08	6782.08
F.A.R AREA ON 19th FLOOR	3754.00	3028.08	6782.08
F.A.R AREA ON 20th FLOOR	3754.00	3028.08	6782.08
F.A.R AREA ON 21st FLOOR	3404.07	3028.08	6432.15
F.A.R AREA ON 22nd FLOOR	3432.01	3028.08	6460.09
F.A.R AREA ON 23rd FLOOR	3754.00	3028.08	6782.08
F.A.R AREA ON 24th FLOOR	3754.00	3028.08	6782.08
F.A.R AREA ON 25th FLOOR	3754.00	3028.08	6782.08
F.A.R AREA ON 26th FLOOR	3754.00	3028.08	6782.08
F.A.R AREA ON 27th FLOOR	3404.07	3028.08	6432.15
F.A.R AREA ON 28th FLOOR	3432.01	3028.08	6460.09
F.A.R AREA ON 29th FLOOR	3754.00	3028.08	6782.08
F.A.R AREA ON 30th FLOOR	3754.00	3028.08	6782.08
F.A.R AREA ON 31st FLOOR	3754.00	3028.08	6782.08
F.A.R AREA ON 32nd FLOOR	3754.00	3028.08	6782.08
F.A.R AREA ON 33rd FLOOR	3378.14	3028.08	6406.22
F.A.R AREA ON 34th FLOOR	3264.08	3038.46	6302.54
F.A.R AREA ON 35th FLOOR	0	2601.01	2601.01
F.A.R AREA ON 36th FLOOR	0	1220.29	1220.29
F.A.R AREA ON 37th FLOOR	0	1220.29	1220.29
F.A.R AREA ON 38th FLOOR	0	1157.08	1157.08
F.A.R AREA ON 39th FLOOR	0	756.68	756.68
F.A.R AREA ON TERRACE	0	0	0
TOTAL FAR OF ALL TOWERS	121167.72	107929.76	229097.47

FLOOR WISE 15% OF FAR (COMMON AREA STATEMENT) RESIDENTIAL TOWER (THE ORCHARDS B-11)			
	TOWER TYPE - A	TOWER TYPE - B	TOTAL
NUMBER OF TOWER	6	5	11
STILT FLOOR AREA	194.75	52.45	247.19
UPPER GROUND FLOOR AREA	525.45	425.33	950.79
AREA ON 1st FLOOR	446.50	383.15	829.65
AREA ON 2nd FLOOR	446.50	383.15	829.65
AREA ON 3rd FLOOR	444.77	383.15	827.92
AREA ON 4th FLOOR	444.77	383.15	827.92
AREA ON 5th FLOOR	444.77	383.15	827.92
AREA ON 6th FLOOR	444.77	383.15	827.92
AREA ON 7th FLOOR	444.77	383.15	827.92
AREA ON 8th FLOOR	444.77	383.15	827.92
AREA ON 9th FLOOR	444.77	383.15	827.92
AREA ON 10th FLOOR	444.77	383.15	827.92
AREA ON 11th FLOOR	444.77	383.15	827.92
AREA ON 12th FLOOR	444.77	383.15	827.92
AREA ON 13th FLOOR	444.77	383.15	827.92
AREA ON 14th FLOOR	444.77	383.15	827.92
AREA ON 15th FLOOR	444.77	383.15	827.92
AREA ON 16th FLOOR	444.77	383.15	827.92
AREA ON 17th FLOOR	444.77	383.15	827.92
AREA ON 18th FLOOR	444.77	383.15	827.92
AREA ON 19th FLOOR	444.77	383.15	827.92
AREA ON 20th FLOOR	444.77	383.15	827.92
AREA ON 21st FLOOR	444.77	383.15	827.92
AREA ON 22nd FLOOR	444.77	383.15	827.92
AREA ON 23rd FLOOR	444.77	383.15	827.92
AREA ON 24th FLOOR	444.77	383.15	827.92
AREA ON 25th FLOOR	444.77	383.15	827.92
AREA ON 26th FLOOR	444.77	383.15	827.92
AREA ON 27th FLOOR	444.77	383.15	827.92
AREA ON 28th FLOOR	444.77	383.15	827.92
AREA ON 29th FLOOR	444.77	383.15	827.92
AREA ON 30th FLOOR	444.77	383.15	827.92
AREA ON 31st FLOOR	444.77	383.15	827.92
AREA ON 32nd FLOOR	444.77	383.15	827.92
AREA ON 33rd FLOOR	444.77	383.15	827.92
AREA ON 34th FLOOR	347.76	372.77	720.53
AREA ON 35th FLOOR	0	359.29	359.29
AREA ON 36th FLOOR	0	333.50	333.50
AREA ON 37th FLOOR	0	333.50	333.50
AREA ON 38th FLOOR	0	323.70	323.70
AREA ON 39th FLOOR	0	258.61	258.61
TERRACE FLOOR LVL	648.47	372.80	1021.26
WATER TANK & MACHINE ROOM	553.21	222.62	775.83
TOTAL 15% OF FAR AREA	16505.74	15315.28	31821.03

AREA STATEMENT FOR (THE ORCHARDS) B-11 RESIDENTIAL TOWER							
BUILDING	NO.OF TOWER	TOWER F.A.R.	15% OF FAR AREA	G. COVER	NO. OF DU.	DENSITY 4.5 PER	NO. OF FLOOR HEIGHT OF TOWER ROAD TO TOP LVL.
TOWER TYPE - A	6	121167.72	16505.74	4519.43	750	3375	G + 34 109.600 MTR.
TOWER TYPE - B	5	107929.76	15315.28	3750.69	500	2250	G + 39 125.150 MTR.
CLUB	1	2647.68	139.30	1297.81			G + 2
DRIVER'S ROOM	2		176.10				G
WATCHMEN ROOM	2		53.51	53.51			G
TOTAL		231745.15	32189.93	9621.45	1250.00	5625.00	

AREA STATEMENT FOR (THE ORCHARDS) B-11 BUILT-UP AREA					
BUILDING	NO.OF UNIT	TOTAL FAR	TOTAL 15% OF FAR	TOTAL NON FAR	TOTAL BUILT-UP
THE ORCHARDS TOWER	11	229097.47	31821.03	NIL	
BASEMENT	1	NIL	NIL	67449.19	
CLUB AREA	1	2647.68	139.30	NIL	
DRIVER'S ROOM	2	NIL	176.10	NIL	
WATCHMEN ROOM	1	NIL	53.51	NIL	
STILT FLOOR	1	NIL	NIL	26585.71	
TOTAL		231745.15	32189.93	94034.90	357969.99

FAR AREA STATEMENT (THE ORCHARDS) B-11		TOTAL
PROPOSED FAR AREA FOR (THE ORCHARDS)		231745.15
TOTAL		231745.15
NON FAR AREA STATEMENT (THE ORCHARDS) B-11		TOTAL
BASEMENT NON FAR AREA (THE ORCHARDS)		67449.19
STILT NON FAR AREA (THE ORCHARDS)		26585.71
TOTAL		94034.90
15% OF FAR AREA STATEMENT (THE ORCHARDS) B-11		TOTAL
TOWER 15% OF FAR AREA FOR (THE ORCHARDS)		31821.03
CLUB 15% OF FAR AREA FOR (THE ORCHARDS)		139.30
DRIVER'S ROOM 15% OF FAR AREA (THE ORCHARDS)		176.10
WATCHMEN ROOM 15% OF FAR AREA (THE ORCHARDS)		53.51
TOTAL		32189.93
G.COVER AREA STATEMENT (THE ORCHARDS) B-11		TOTAL
TOWER G.COVER AREA FOR TOWER = A,B (THE ORCHARDS)		8270.13
CLUB & WATCHMEN ROOM G.COVER AREA FOR (THE ORCHARDS)		1351.32
TOTAL		9621.45
BUILT-UP AREA STATEMENT (THE ORCHARDS) B-11		TOTAL
TOTAL FAR AREA FOR (THE ORCHARDS)		231745.15
TOTAL 15% OF FAR AREA FOR (THE ORCHARDS)		32189.93
TOTAL STILT & BASEMENT NON FAR AREA (THE ORCHARDS)		94034.90
TOTAL		357969.99
BASEMENT AREA STATEMENT (B-11)		
PROPOSED AREA AT UPPER BASEMENT (A)		33898.66
PROPOSED AREA AT LOWER BASEMENT (B)		33650.53
TOTAL PROPOSED AREA BOTH BASEMENT (A+B=C)		67449.19

REQUIRED PARKING STATEMENT (B-11)			
TOWER TYPE	FAR AREA	ECS/UNIT	ECS/BLOCK
TOWER TYPE - A	121167.72	1ECS/80 SQ.MT	1514.60
TOWER TYPE - B	107929.76	1ECS/80 SQ.MT	1349.12
CLUB	2647.68		33.10
TOTAL	231745.15		2897
REQUIRED PARKING AREA			
4 WHEELER PARKING @ 30 SQ.M = 2897 X 30 =			86904.43
TOTAL PARKING AREA =			86904.43

PROPOSED PARKING STATEMENT IN BASEMENT (B-11)			
COV. AREA IN UPPER BASEMENT (A)			33550.53
COV. AREA IN LOWER BASEMENT (B)			33898.66
TOTAL COV. AREA IN BASEMENT (A+B=C)			67449.19
SERVICES AREA UPPER BASEMENT			4899.74
SERVICES AREA LOWER BASEMENT			4028.82
BASEMENT AREA USED FOR SERVICES (D)			8928.56
AREA PROVIDED FOR PARKING = (C-D)			58520.63
TOTAL PARKING REQUIRED @ 1ECS PER 80SQ.MT			2897
REQUIRED 4 WHEELER PARKING @ 30 SQ.M = 2897 X 30 =			86904.43
AVAILABLE AREA IN BASEMENT & STILT (B-11)			58520.63
AREA PROVIDED FOR 4WHEELER PARKING IN BASEMENT			26585.71
AREA PROVIDED FOR 4WHEELER PARKING ON STILT			85108.34
TOTAL PROVIDED AREA FOR 4WHEELER PARKING			2836.88
TOTAL NO OF 4WHEELER CARS PARKING PROVIDED IN BASEMENT & STILT @ 30SQ.MT/ECS			2837
BALANCE PARKING AVAILABLE ON SURFACE			66
TOTAL PARKING BASEMENT, STILT & SURFACE / AVAILABLE IS			2903

GREEN AREA STATEMENT (THE ORCHARDS) B-11			
TOTAL PLOT AREA OF (THE ORCHARDS)	(A)		50000
TOTAL G COVERED AREA OF (THE ORCHARDS)	(B)		9621.45
TOTAL OPEN AREA OF (THE ORCHARDS)	(A-B)=C		49438.55
REQUIRED GREEN AREA = 50% OF OPEN AREA			24719.28
TOTAL PROPOSED GREEN AREA	50.56%		24000
ONE TREE PER 100 SQUARE METER OF OPEN SPACE			494.39
TOTAL REQUIRED TREE			500.00
TOTAL PROPOSED TREE			500.00
50% TO BE IN CATEGORY OF EVERGREEN TREE			

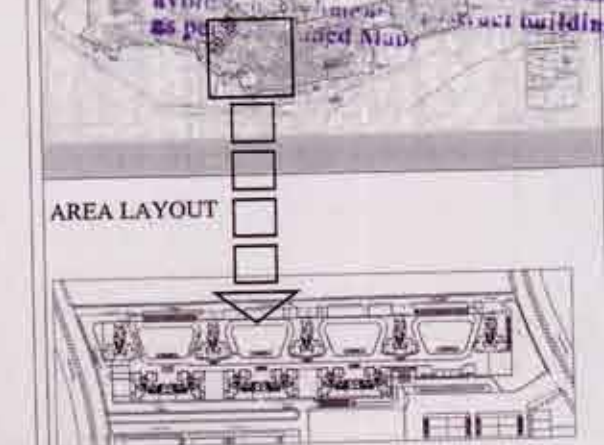

NOTE :-

- NOTE :-  
[1] ALL AREA IN SQ.MTR.  
[2] 13TH FLOOR IS MISSED IN THE SCHEME.

Owner  
**JAYPEE INFRATECH LTD.**

Owners' Signature  
Sanjay Singh, Architect  
Council of Architecture  
Registration No.: CA/1993/15645

Architect's Signature  
For Jaypee Infratech Limited  
Authorized Signatory

Architects & Town Planners  
ARCOP ASSOCIATES Pvt. Ltd.  
E-106, G.K. ENCLAVE Part-I  
New Delhi-110 049  
Ph.: 011-26242050 Fax : 011-26238035

Drawing Title  
**THE ORCHARDS  
(POCKET - B11) THE ORCHARDS  
JAYPEE GREENS, SECTOR 131,  
NOIDA, U.P.**

Job Title  
**BUILDING SUBMISSION FOR  
(POCKET - B11) THE ORCHARDS  
JAYPEE GREENS, SECTOR 131,  
NOIDA, U.P.**

Job No.  
Date  
Drawing No.  
JPG/SB/B11/D-01

Dealt by  
Checked by  
Revision No.

NOIDA AUTHORITY:

Associate Architect  
Architect  
Chief Architect

ध्यान प्रकट  
नोट :-  
1. मानचित्र स्विकृति की दिनांक से अधिक  
तम 5 वर्षों के अन्तर पर एक बार दोहराया जाना चाहिए  
का पट्टे के अधिकार उपलब्ध हो जायें।  
पुनर्जांचित न होने की दशा में मानचित्र की वैधता  
पट्टे की वैधता तब तक ही मर्यादित रहेगी।

(2) आर्चिटेक्ट को अधिसूचना प्रमाण पत्र हेतु आवेदन  
करने समय विकास प्रबंधक (आवास) से निम्न  
अनुसार समस्त सुविधाएं प्राप्त कर प्रस्तुत करना होगा