

S.NO.	DESCRIPTION	SIZE	AREA (SQM)	NOS.
1	PLOTS	ALREADY APPROVED LOTS		104
2	PLOTS	10.00X20.00	200.00	188
3	COMMERCIAL PLOT	40.00X50.00	2000.00	10
4	COMMERCIAL PLOT	20.00X40.00	800.00	20
5	COMMERCIAL PLOT		7165.76	01
6	INSTITUTIONAL	40.00X50.00	2000.00	05
7	MULTI PLEX		12023.84	01
8	FACILITIES PLOT			06
9	GROUP HOUSING PLOT			04
	<b>TOTAL PLOTS</b>			<b>378</b>

TOTAL SCHEME AREA (SqM.)		288625.67		
COMMERCIAL		478007		
RESIDENTIAL (GROUP HOUSING)		99172.9207		
<b>NET SCHEME AREA (SqM.)</b>		<b>181648.78</b>		
SR.NO.	LANDUSE	AREA (Sq.m)	PERCENTAGE	NUMBER
1	RESIDENTIAL (PLOTTED DEVELOPMENT)	62674.23	34.5	329
2	FACILITY PLOT	16207.96	8.9	5
3	SHOPS	325.38	0.2	16
4	PARK/OPEN SPACE	21973.20	12.1	1
5	INSTITUTIONAL PLOT	12917.99	7.1	7
6	MULTI PLEX	11991.57	6.6	1
7	COMMERCIAL	8248.70	4.5	11
8	ROAD	46630.10	25.7	-
<b>TOTAL</b>		<b>181648.70</b>	<b>100.0</b>	-

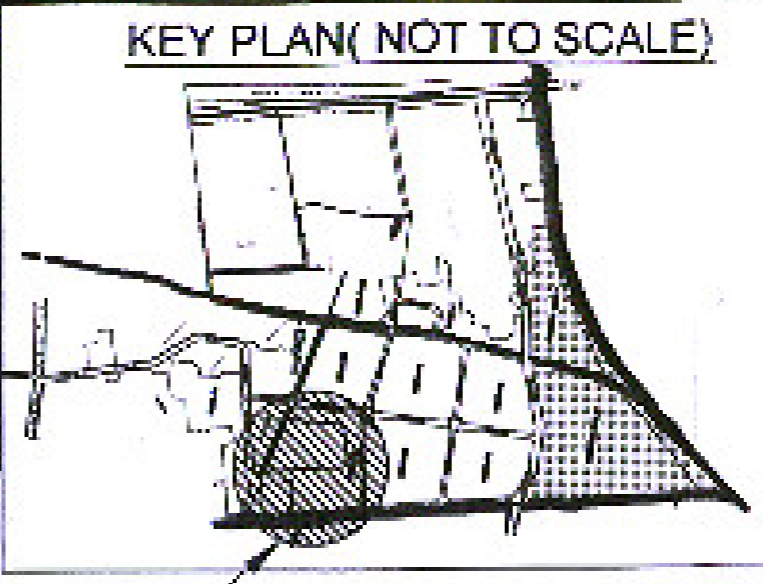

**UPHDB**  
 UTTAR PRADESH DEVELOPMENT BOARD  
 PLOT NO. 11, SECTOR-2, MEERUT  
 U.P. INDIA

I.S- 15700 :2005

E-MAIL ID - ap5@upavp.com  
 DRG. NO - UPHDB/ADD UNIT/5/20-01/5-6  
 MEERUT/JVEVT/2021-2/HC/23/1/2024/02

1. THIS LAY OUT PLAN HAS BEEN PREPARED ON THE BASIS OF INFORMATION RECEIVED BY S.D. CHAVDE HIS LETTER NO. 196092-0NEEDUTY-86297 ON DATED 08.12.2020.
2. THIS LAY OUT PLAN HAS BEEN PREPARED ON THE BASIS OF INFORMATION RECEIVED BY S.D. CHAVDE HIS LETTER NO. 196092-0NEEDUTY-86297 ON DATED 21.08.2022 AND DISCUSSION OF HIGH LEVEL COMMITTEE MEETING ON DATED: 18.08.2022.
3. THIS LAY OUT PLAN HAS BEEN PREPARED ON THE BASIS OF FEASIBILITY RECEIVED BY S.D. CHAVDE HIS LETTER NO. 196092-0NEEDUTY-86297 ON DATED 25.08.2022.
4. THIS LAY OUT PLAN HAS BEEN FINALIZED ON THE BASIS OF FEASIBILITY RECEIVED BY C.D. MEERUT VIDE HIS LETTER NO. 212500-0MEERUT-017-1703 ON DATED 08.12.2023.
5. THIS LAYOUT PLAN IS FINALLY APPROVED IN HIGH LEVEL COMMITTEE ON DATED 01.01.2024.

**APPROVED BY HC**  
**26.01.2016 AND 18/11/2019**

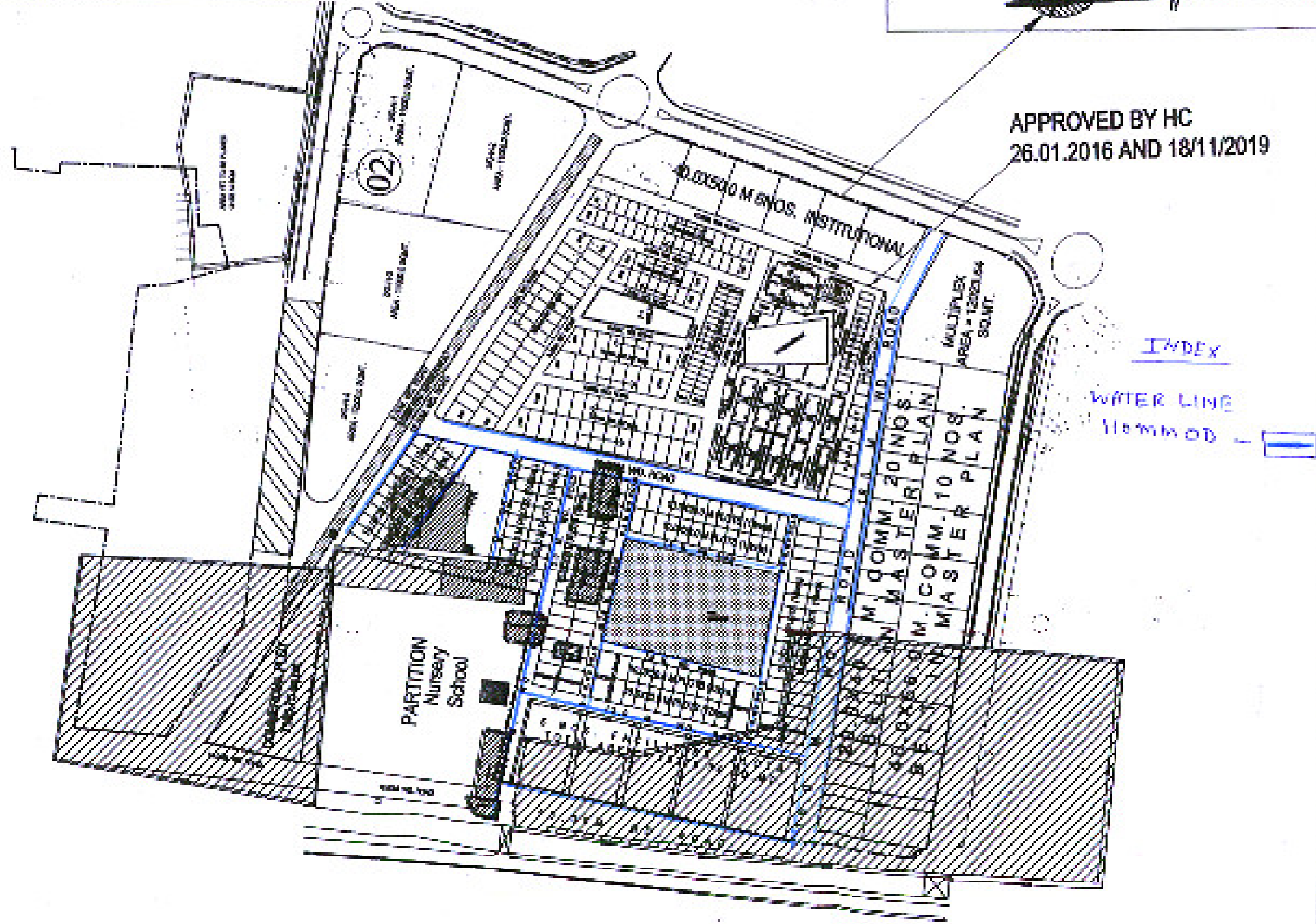

विक्रम कुमार प्रमाणित  
 वास्तुविद्, मेरठ (उ.प्र.)

U.P AVAS EVAM VIKAS PARISHAD, LUCKNOW  
 ARCHITECTURE AND PLANNING UNIT - 5

COMBINED AND CONTROL LAYOUT PLAN OF JAGRITI VEHUL  
 EXTENSION, YOLJA NO-11 SECTOR-2 MEERUT.

DATE: 19/01/2021	
KRISHNA KANT ARCH. ASSTT.	<i>Krishna Kant</i> 19/01/21
AMITA SRIVASTAVA ASSTT. ARCHITECT PLANNER	<i>Amita Srivastava</i> 18/01/2021
ANVIND DEO ARCHITECT PLANNER	<i>Anvind Deo</i> 18/01/2021
S.J.YADAV SENIOR ARCHITECT PLANNER	<i>S.J. Yadav</i> 21/11/21
DINESH KUMAR CHIEF ARCHITECT PLANNER	<i>Dinesh Kumar</i> 21-11-2021
ALAY CHAUHAN ASSTT. ARCHITECT	<i>Alay Chauhan</i> 21/11/21

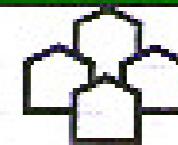

**UPHDB**  
 U.P. HOUSING & DEVELOPMENT BOARD  
 194-198 COMPTON ROAD  
 LUCKNOW

1.6-15700-2005

E-MAIL ID - ap5@uphdb.com  
 ORG. NO - UPHDB/APDUNIT5/CP-01/20-  
 1880/2005/13501-3/HC/2021/2021  
 03/2021

1. THIS LAY OUT PLAN HAS BEEN PREPARED ON THE BASIS OF INFORMATION RECEIVED BY S.C. CIR-2 VIDE HIS LETTER NO. 1880/2005/13501/3/HC/2021/2021 DATED 08.12.2020.
2. THIS LAY OUT PLAN HAS BEEN PREPARED ON THE BASIS OF INFORMATION RECEIVED BY S.C. CIR-2 VIDE HIS LETTER NO. 1880/2005/13501/3/HC/2021/2021 DATED 21.03.2021 AND DISCUSSION OF HIGH LEVEL COMMITTEE MEETING ON DATED 04.09.2021.
3. THIS LAY OUT PLAN HAS BEEN PREPARED ON THE BASIS OF FEASIBILITY RECEIVED BY S.C. CIR-2 VIDE HIS LETTER NO. 1880/2005/13501/3/HC/2021/2021 DATED 25.08.2021.
4. THIS LAY OUT PLAN HAS BEEN FINALIZED ON THE BASIS OF FEASIBILITY RECEIVED BY S.C. CIR-2 VIDE HIS LETTER NO. 21200/2005/13501/3/HC/2021/2021 DATED 30.12.2021.
5. THIS LAY OUT PLAN IS FINALLY APPROVED IN HIGH LEVEL COMMITTEE ON DATED 01.01.2021.

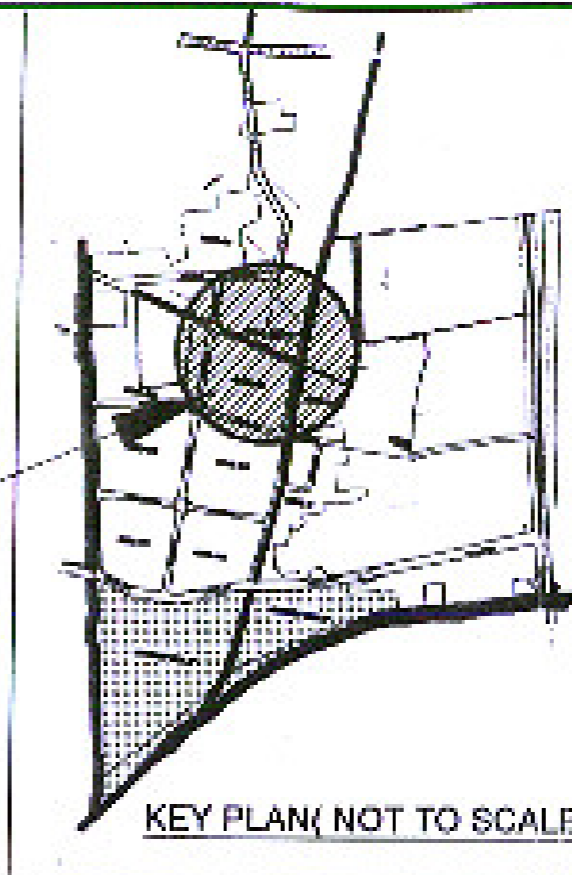

KEY PLAN (NOT TO SCALE)

INDEX  
 WATER LINE  
 110 MM OD

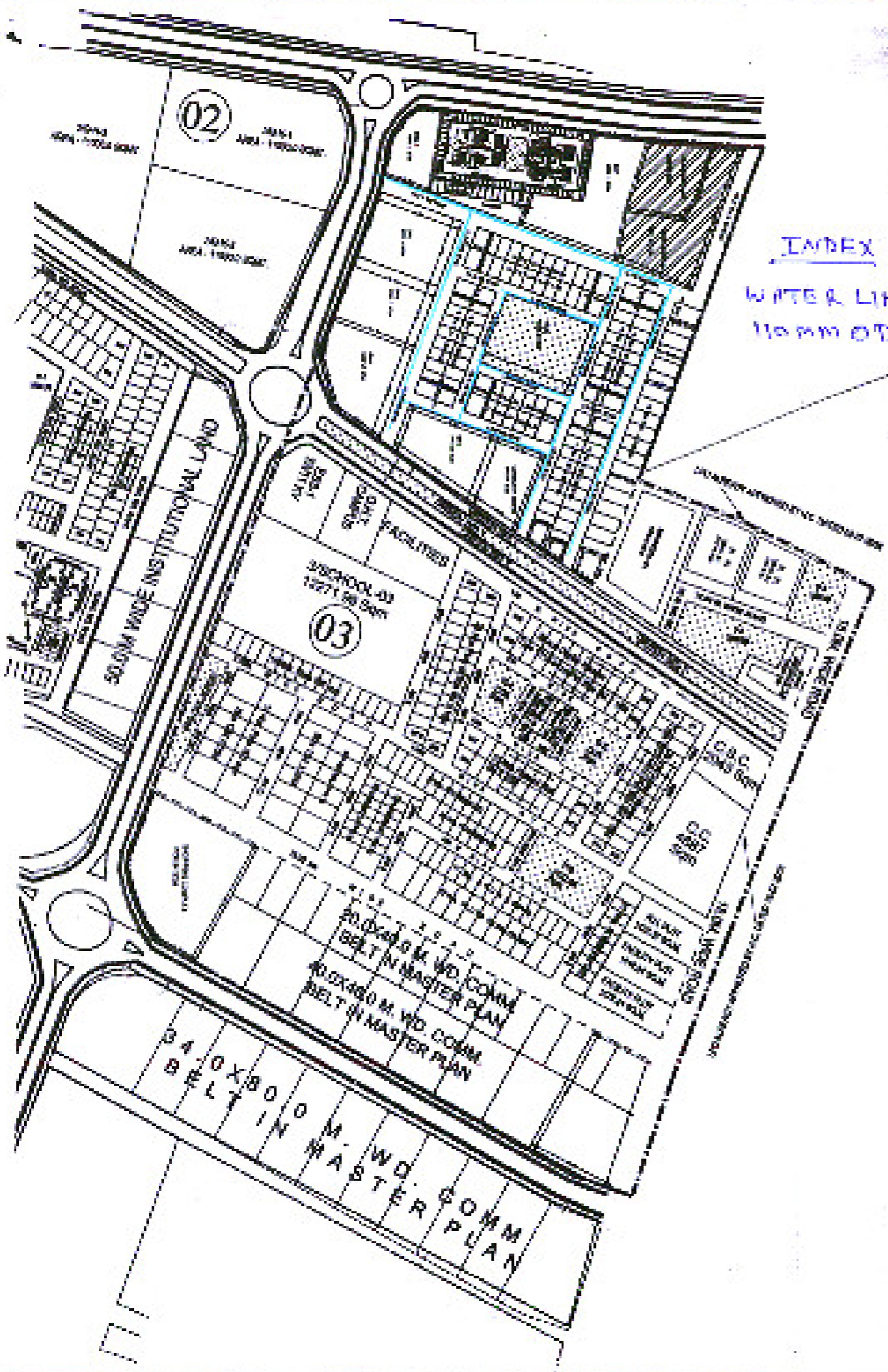

निर्माण हेतु प्रमाणित  
 कानूनी विचारों पर ध्यान दें

S.NO.	DESCRIPTION	SIZE	AREA (SQ.M)	NOS.
1.	PLOTS	3.50X16.00	127.50	104
2.	PLOTS	10.00X20.00	350.00	20
3.	PLOTS	9.00X18.00	162.00	50
4.	PLOTS	12.00X25.00	300.00	28
5.	PLOTS	11.50X23.00	264.50	12
6.	PLOTS	8.00X17.50	140.00	18
7.	HOUSE TYPE 18X142	7.80X18.00	140.40	50
8.	DUPLEX HOUSES	9.00X18.00	312.00	50
9.	COMMERCIAL PLOT	20.00X40.00	800.00	10
10.	COMMERCIAL PLOT	40.00X40.00	1600.00	08
TOTAL PLOTS				380

AREA CALCULATION

TOTAL SCHEME AREA (A)	245515.94		
MASTER PLAN COMMERCIAL AREA (B)	30654.00		
GROUP HOUSING AREA (C)	22530.03		
ARIAN MUKT LAND (D)	6403.88		
NET SCHEME AREA - A - (B+C+D)	176528.08		
S. NO.	TYPES	AREA	PERCENTAGE
1	RESIDENTIAL	60202.50	34.10
2	COMMERCIAL	2620.99	1.48
3	SCHOOL	18770.97	10.63
4	CSC	2038.50	1.15
5	OHT	2129.97	1.20
6	COMMUNITY CENTRE	6016.25	3.40
7	NURSING HOME	6108.54	3.46
8	FACILITY PLOT	8827.58	4.99
9	GREEN	17562.41	9.95
10	ROAD	50980.37	28.89
TOTAL		176528.08	100.00

1. अंतिम मुद्रा पूर्ण	
UP AVAS EVAM VIKAS PARISHAD, LUCKNOW ARCHITECTURE AND PLANNING UNIT - 5	
CONTROL AND CONTROL LAYOUT PLAN OF JAGRITI NHAAR EXTENSION, YOUNA NO. 11 SECTION 3 MEEBUT.	
DATE - 18.01.2021	
DR. RAJ KANT CH. ARCH. ARCH. ASSTT	
ANITA SHIVASTAVA CH. ARCH. ARCHT. ARCHITECT PLANNER	
ARVIND DEO CH. ARCH. ARCHITECT PLANNER	
S. J. YADAV SENIOR ARCHITECT PLANNER	
U. P. K. KUMAR CHIEF ARCHITECT PLANNER	
ALAY CHAKRABARTY CH. ARCH.	