

FIRST FLOOR PLAN
TYPICAL FOR 2nd TO 33rd FLOOR

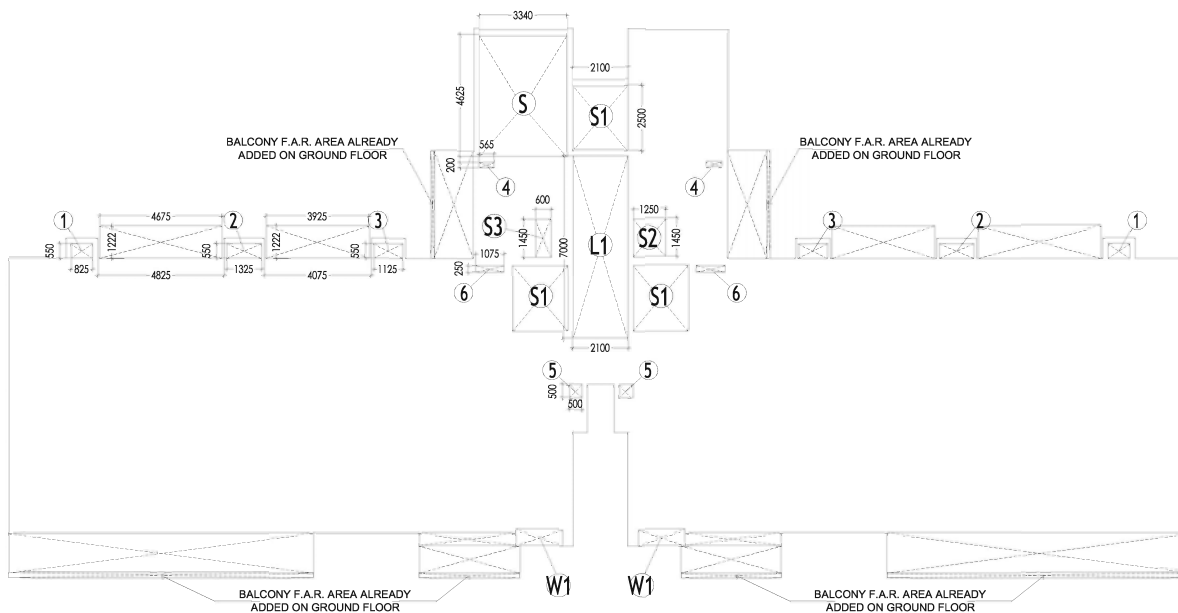

FIRST FLOOR PLAN
TYPICAL FOR 2nd TO 33rd FLOOR &
ENVELOPE PLAN

AREA STATEMENT TYPICAL FLOOR				
TOWER (T-A-1.2&3) G+33				
1st To 33rd FLOOR				
ADDITION AREA (A)				
Sr.No.	Coff./No.	Breadth mm.	Length mm.	Area Sq.mtr.
TOTAL F.A.R. AREA ON GROUND FLOOR				516.51
TOTAL ADDITION AREA (A)				516.51

AREA STATEMENT TYPICAL FLOOR				
TOWER (T-A-1.2&3) G+33				
1st To 33rd FLOOR				
DEDUCTION AREA (B)				
Sr.No.	Coff./No.	Breadth mm.	Length mm.	Area Sq.mtr.
S1	3	2100	2500	15.75
S2	1	1250	1450	1.81
S3	1	600	1450	0.87
1	2	825	550	0.91
2	2	1325	550	1.46
3	2	1125	550	1.24
4	2	565	200	0.23
5	2	500	500	0.50
6	2	1075	250	0.54
TOTAL DEDUCTION AREA (B)				23.30
TOTAL AREA (A - B = C)				493.21
NO. OF FLOORS				33
				16275.87

15% OF FAR AREA TYPICAL FLOOR				
TOWER (T-A-1.2&3) G+33				
1st To 33rd FLOOR				
AREA (A)				
Sr.No.	Coff./No.	Breadth mm.	Length mm.	Area Sq.mtr.
S	1	3340	4625	15.45
W1	2	1800	600	2.16
S2	1	1250	1450	1.81
S3	1	600	1450	0.87
L1	1	2100	7000	14.70
(A)				34.99
NO. OF FLOORS				33
				1154.67

KEY PLAN



AREA LAYOUT

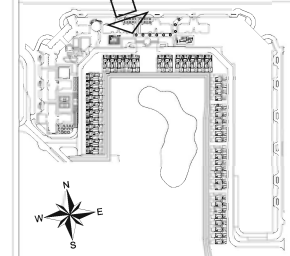

NOTE :-

1. The Dimensions/ Area statements shown in the drawings has been checked & verified by architect and owner.
2. Owner shall be responsible / liable for any change in the dimensions / area statement.

Owners' Signature

Architect's Signature

Architects & Town Planners
ARCOP ASSOCIATES Pvt. Ltd.
A-15, PAMPOSH ENCLAVE, G.K.-1
New Delhi-110 048
Ph.: 011-26242050 Fax : 011-26238035

Owner
JAYPEE INFRATECH LTD.

Drawing Title
**TOWER [A1,A2 & A3]
FIRST & TYPICAL FOR 2nd TO 33rd
FLOOR PLAN
& ENVELOPE PLAN**

Job Title
**BUILDING SUBMISSION FOR
POCKET B-9,[CLUSTER B-9]
JAYPEE GREENS, SECTOR 128,
NOIDA , U.P.**

Scale
1:100

Date
NOV. 2014

Dealt by
FAROOQ

Checked by
GIAN

Revision No.

NOIDA AUTHORITY:

Associate Architect

Architect

Chief Architect