





ELECTRICAL LEGENDS

- SYMBOL**
-  300 MM DIA RCC HUME PIPE FOR HT CABLE AT 1200 MM DEEP FROM G.L
 -  300 /200/150 MM DIA DWC PIPE FOR LV CABLE AT 750 MM DEEP FROM G.L
 -  450X450X500 MM DEEP MAIN HOLE CHAMBER FOR LV CABLE
 -  750X750X800 MM DEEP MAIN HOLE CHAMBER FOR LT CABLE
 -  900X900X1200 MM DEEP MAIN HOLE CHAMBER FOR HT CABLE

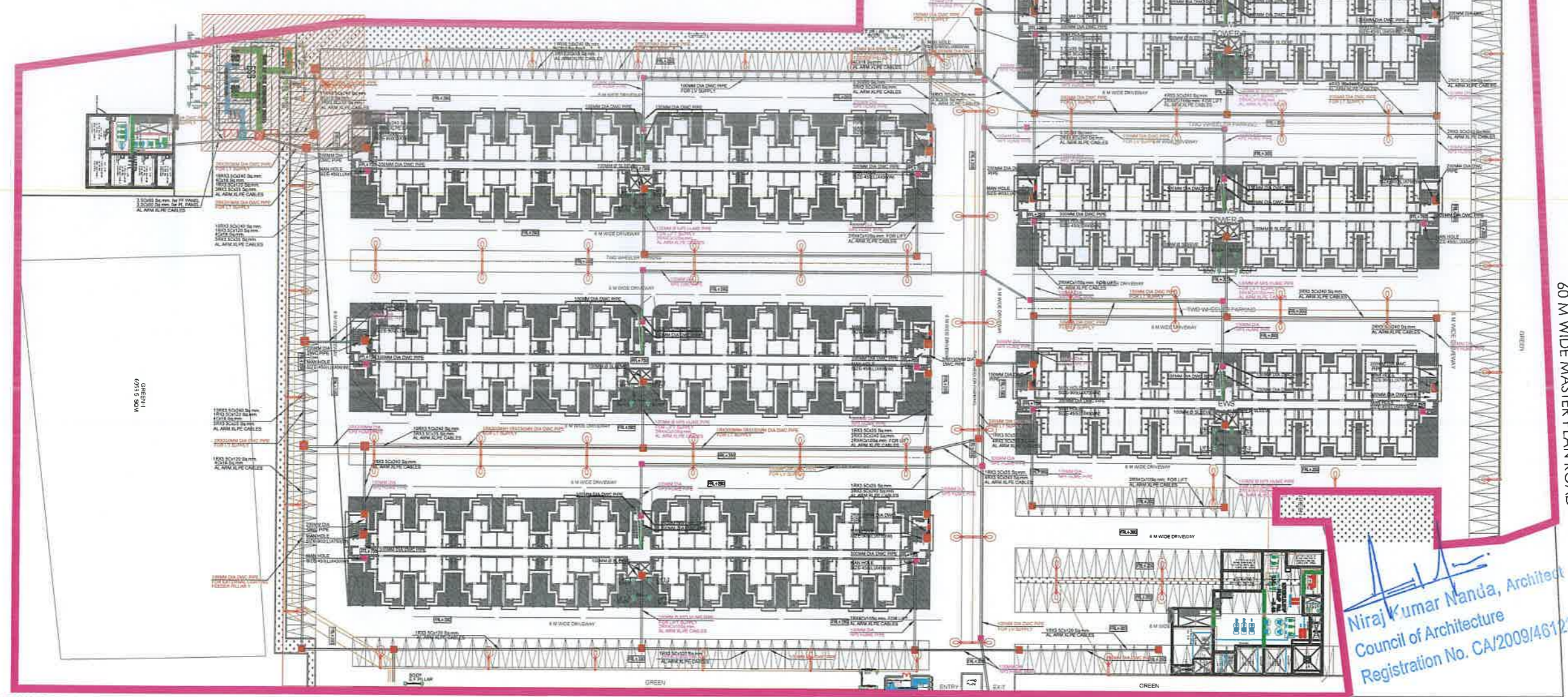

Architect :
 Wave Infratech Pvt. Ltd.
 C-1, Sector-3
 Noida, U.P. 201301
 TEL: +91 120 4180500

Structure Consultant

 E MAIL: sssocabb@gmail.com
 TEL : - 011-41631766

MEP Consultant

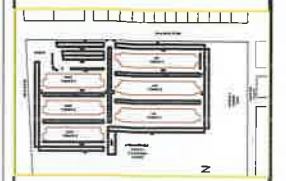
KEY PLAN- EWS LIG WAVE CITY PH-04

For Uppal Chadha Hi-Tech Developers Pvt. Ltd.

Authorized Signatory

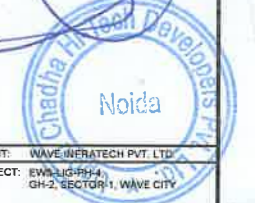
 CLIENT: WAVE INFRA TECH PVT. LTD.
 PROJECT: EWS-LIG-PH-04,
 GH-2, SECTOR-1, WAVE CITY

DRAWN: REMYA RAJESH
 CHECKED: SRINIVASAN
 DATE: 21-10-2024

- General Notes:**
1. DO NOT SCALE FROM THE DRAWING.
 2. ALL DIMENSIONS ARE IN MILLIMETERS AND LEVELS ARE IN METERS UNLESS NOTED OTHERWISE. ALL DIMENSIONS TO BE VERIFIED ON SITE AS APPROVED BY THE ENGINEER.
 3. ALL DRAWINGS SHOULD BE READ IN CONJUNCTION WITH OTHER RELEVANT ARCHITECTURAL, STRUCTURAL, MECHANICAL AND ELECTRICAL DRAWINGS. ALL RELEVANT SECTION OF THE SPECIFICATION AND DISCREPANCIES ARE TO BE BROUGHT TO THE ATTENTION OF THE ARCHITECT AND RESOLVED BEFORE COMMENCEMENT OF ANY WORK.
 4. ALL NEW WORKS TO BE READ IN CONJUNCTION WITH THE EXISTING WORK DRAWINGS.
 5. ALL BLOCK WORKS TO BE PROVIDED WITH APPROPRIATE DPC AND HEIGHT TO BE INTRODUCED WITH APPROPRIATE INTERMEDIATE BRICKS IN BRICKWORK STRUCTURES DETAILINGS AS PER STRUCTURE.

Rev.	Description	Date

DRAWING TITLE
 EWS & LIG TOWER
 SITE PLAN
 ELECTRICAL LAYOUT PLAN

DWG. NO.
 EL-EWS-LIG-PH04-10001

Niraj Kumar Mandia, Architect
 Council of Architecture
 Registration No. CA/2009/46122

01 SEWER & S.W.DRAIN LINE
 SCALE: 1:275@A0

24 M WIDE ROAD

60 M WIDE MASTER PLAN ROAD

This drawing is subject to copyright and may not be copied, used or reproduced in any way without the express permission of WAVE Infratech. This document should not be relied on or used in circumstances other than those for which it was originally prepared and for which WAVE Infratech was commissioned. WAVE Infratech accepts no responsibility for this document to any other party other than the person by whom it was commissioned.