

PROPOSED SITE

SAZRA PLAN
NOT TO SCALE

PROPOSED SITE

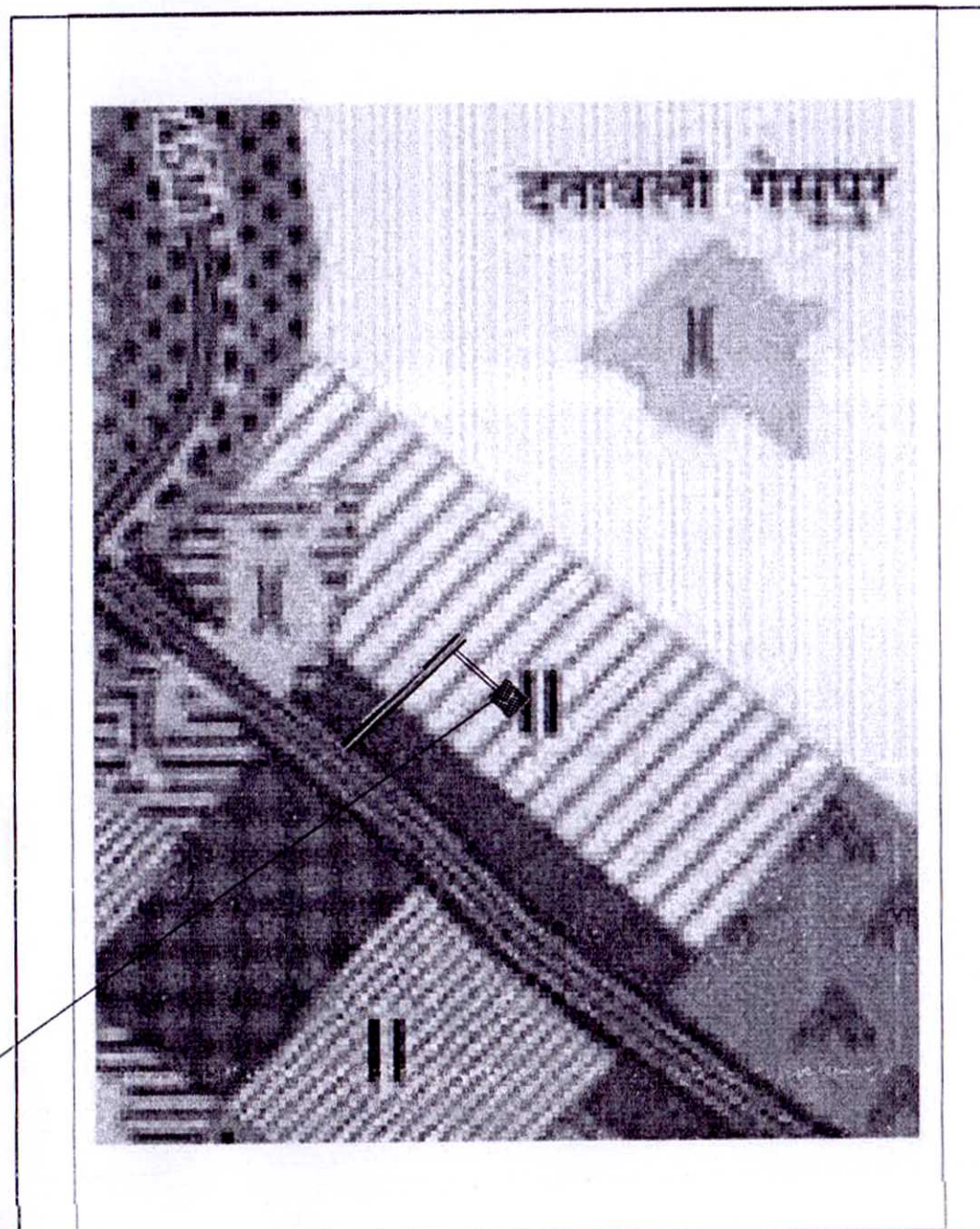

LOCATION PLAN OF MASTER PLAN
NOT TO SCALE

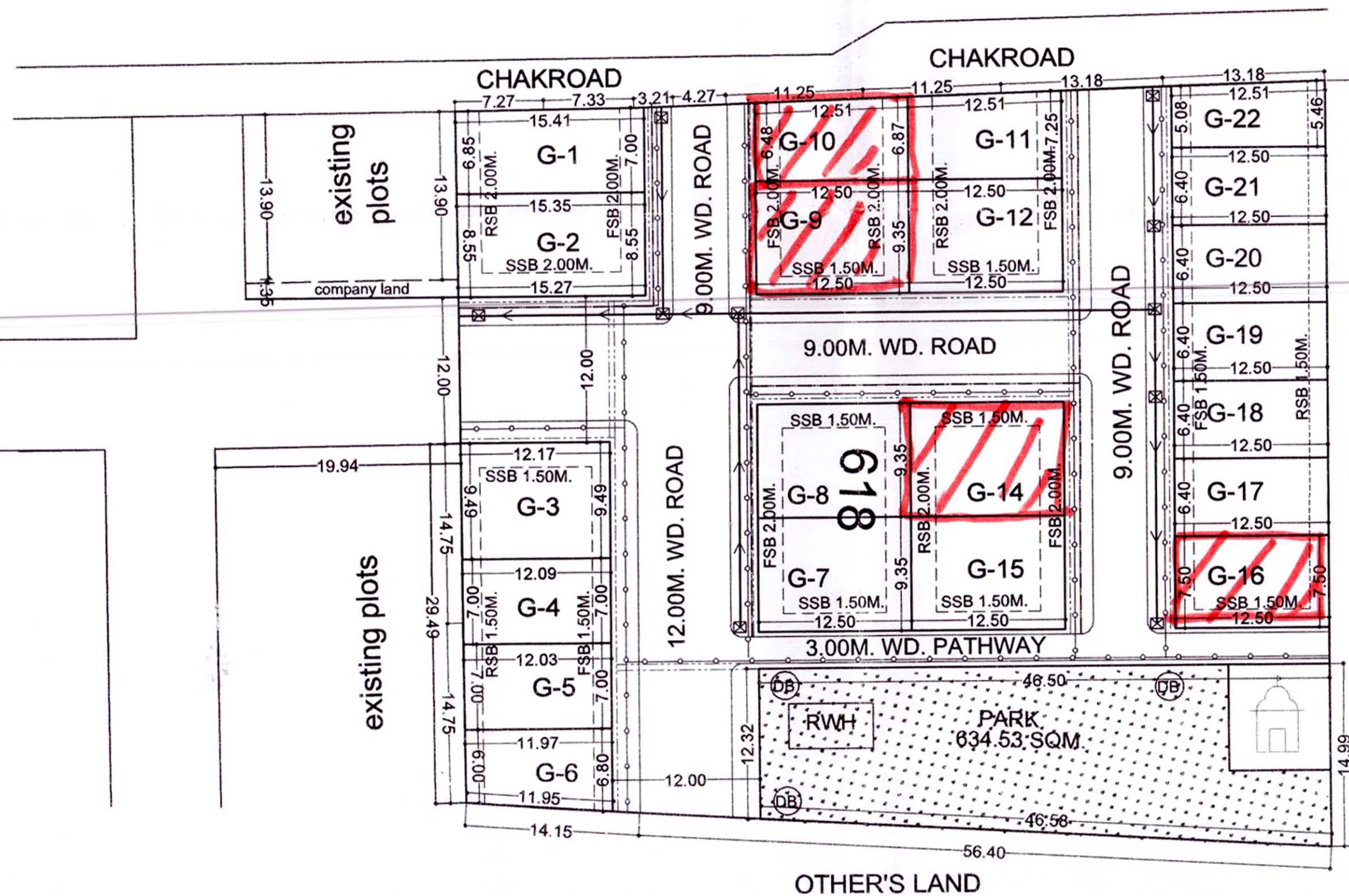

LAYOUT / SERVICE PLAN

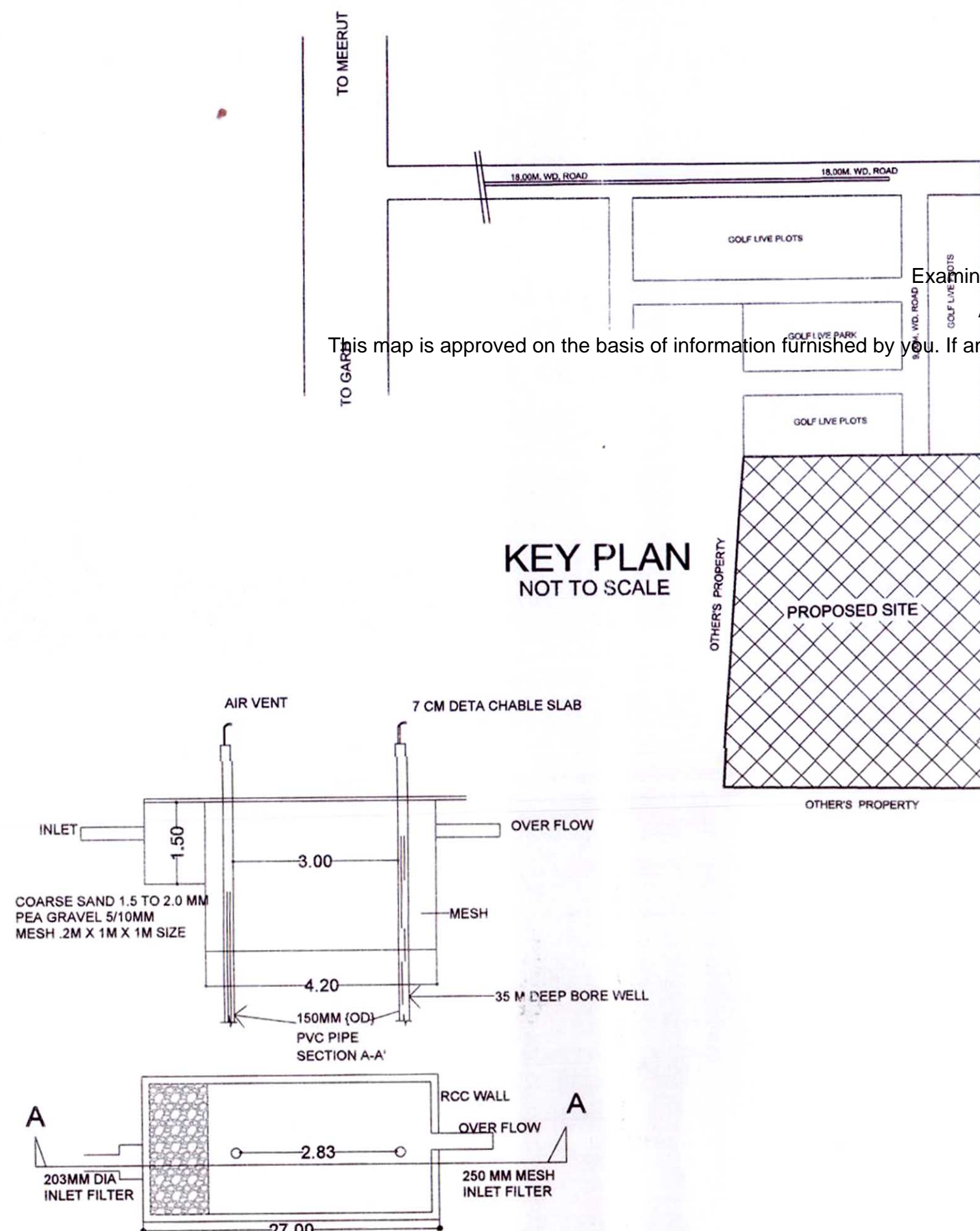

PLAN OF RAIN WATER HARVESTING

BREAKUP OF PROPERTIES					
S.NO.	TYPE	SIZE MT.	NOS.	PLOTS AREA SQM.	TOTAL AREA SQM.
1.	PLOT NO. 01	6.925X15.38(avg)	1	106.51	106.51
2.	PLOT NO. 02	8.55X15.31(avg)	1	130.90	130.90
3.	PLOT NO. 03	9.49X12.13(avg)	1	115.11	115.11
4.	PLOT NO. 04	7.00X12.06(avg)	1	84.42	84.42
5.	PLOT NO. 05	7.00X12.005(avg)	1	84.03	84.03
6.	PLOT NO. 06	6.40X11.96(avg)	1	76.54	76.54
7.	PLOT NO. 07 to 09	9.35X12.50	3	116.87	350.61
8.	PLOT NO. 10	6.675X12.505(avg)	1	83.47	83.47
9.	PLOT NO. 11	7.06X12.505(avg)	1	88.28	88.28
10.	PLOT NO. 12,14,15	9.35X12.50	3	116.87	350.61
11.	PLOT NO. 16	7.50X12.50	1	93.75	93.75
12.	PLOT NO. 17 to 21	6.40X12.50	5	80.00	400.00
13.	PLOT NO. 22	5.27X12.505(avg)	1	65.90	65.90
TOTAL PLOTS OF NOS.			21		2030.13

श्री-महेश्वर विकास नगर के ४५
मकानों में २०३३ का विकास

G-9
G-10
G-14
G-16

MDA



Building Plan Application No. MAP20181031075752333
Approved On 07 Dec 2019
Valid Till 06 Dec 2024
Approved By Rajesh Pandey(Vice Chairman)
Examined By Gorky (A T P),Pravina (Secretary),Rakesh Pawar (Junior Engineer)
Approval certificate issued separately is integral part of this approved plan
This map is approved on the basis of information furnished by you. If any information is found incorrect then this approval will stand as cancelled.

"GOLF GREEN"
PROPOSED LAYOUT PLAN FOR RESIDENTIAL
COLONY ON KHASRA NO. 618 PART 619 PART
AT VILLAGE- DATAWALI GESUPUR, GARH ROAD,
MEERUT

AREA CHART:-

PERTICULARS	%	IN SQM
1. SITE AREA		4228.30
2. AREA UNDER RESI. PLOTS	48.01	2030.13
3. AREA UNDER PARK	15.01	634.53
4. AREA UNDER ROAD	36.98	1563.64

1- TOTAL NO. OF RESI. PLOTS - 21
2- POPULATION- 21*5= 105
3- DENSITY- 105/0.423=248.23
Say 248

SET BACK SCHEDULE

SN	PLOT SIZE	FSB1.50	RSB1.50
1-	PLOT AREA- 50 TO 100 SQM	FSB1.50	RSB1.50
2-	PLOT AREA- 101 TO 150 SQM	FSB2.00	RSB2.00

LEGEND:-

- 1- SITE BOUNDARY
- 2- DRAINS
- 3- WATER MAIN
- 4- SEWER LINE
- 5- ELECTRIC LINE
- 6- TREES
- 7- DUSTBIN

OWNER:-

GATEWAY GLOBAL BUILDWELL PVT. LTD.
THROUGH MANAGING DIRECTOR
SH. DAVINDRA DHINGRA

GATEWAY GLOBAL BUILDWELL (P) LTD.

Signature of Managing Director

SIGNATURE

ARCHITECT:-

NORTH:-

Mohit Bhatnagar
ARCHITECT
MOHIT BHATNAGAR
B-ARCH Regd. Architect (C.O.A.)
Regn. No.- CA/99/2003
15/F/138 G-10, Sector 10, Noida

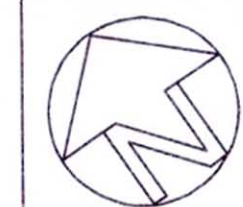

SCALE:- 1:500