

12/11/19

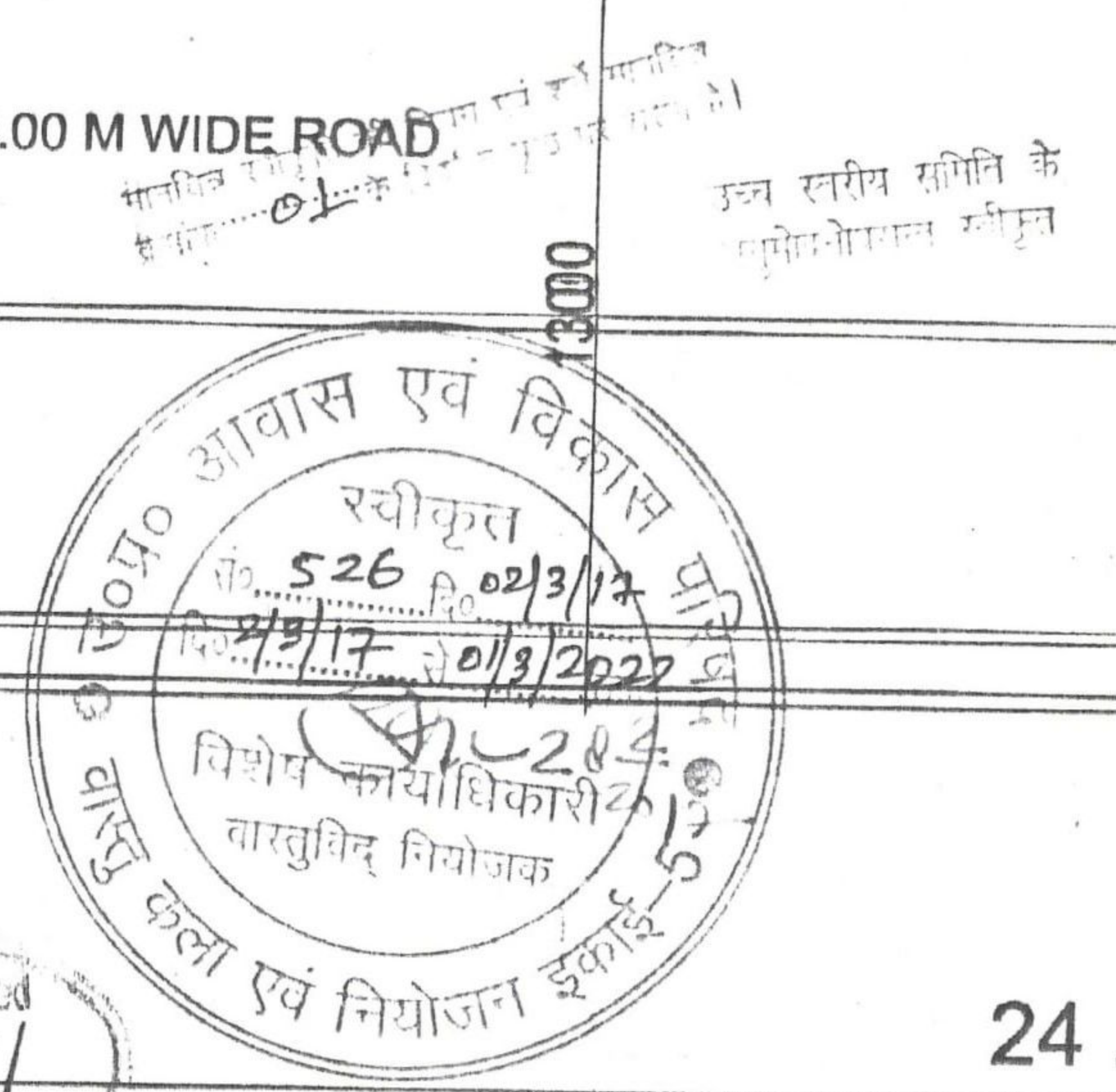
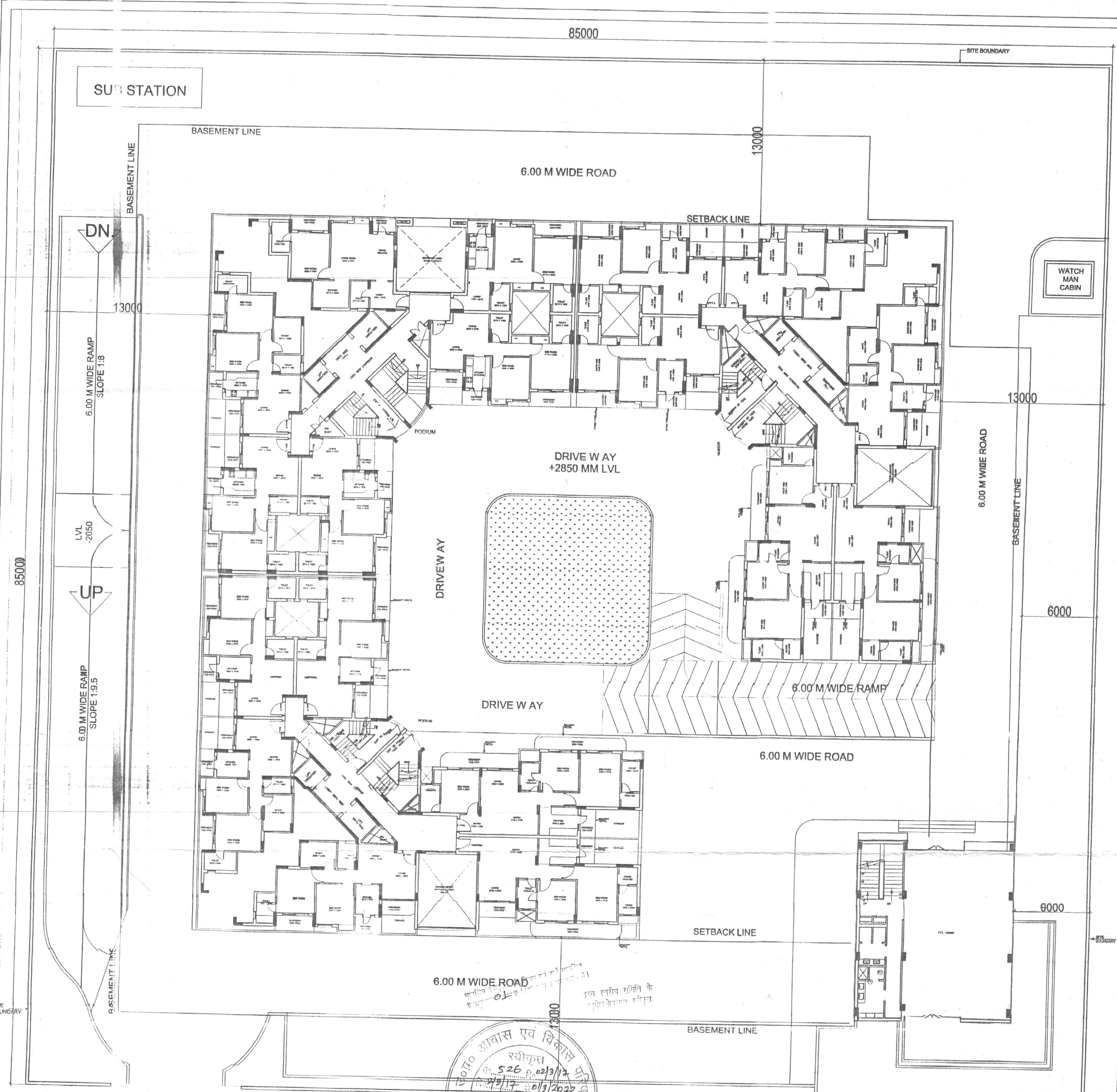

Checked & Submitted For Approval

PODIUM LEVEL

| AREA SUMMARY | | |
|--------------|--|----------------|
| | | Area in sqm |
| 1 | TOTAL PLOT AREA | 0.7225 Hectare |
| | | 7225.000 SQM |
| 2 | PERMISSIBLE GROUND COVERAGE @ 35% OF PLOT AREA | 2528.750 SQM |
| | PROPOSED GROUND COVERAGE @ 26.83 | 1938.124 SQM |
| 3 | PROPOSED FAR @ 99.1% OF PLOT AREA | 21609.740 SQM |
| 4 | PROPOSED DENSITY | 252.000 DUs |
| 5 | PERMISSIBLE COMMERCIAL @ 0.5% OF PERMISSIBLE FAR | 90.313 SQM |
| | PROPOSED COMMERCIAL | 90.042 SQM |
| 6 | TOTAL PARKING REQUIRED | 333 ECS |
| 7 | PROPOSED STILT AND PODIUM PARKING AREA | 4779.903 SQM |
| | PARKING PROVIDED @ 28 SQ.MT./ECS | 113 ECS |
| | CARS PROVIDED IN PODIUM | 144 ECS |
| 8 | PROPOSED OPEN PARKING AREA | 2188.000 SQM |
| | PARKING PROVIDED @ 23 SQ.MT./ECS | 95 ECS |
| | CARS PROVIDED ON SURFACE | 99 ECS |
| 9 | TOTAL PARKING PROVIDED | 344 ECS |

| FAR SUMMARY | | | | | | |
|-------------|---------------------|-----------------|---------------------|-----------------|---------------------|-----------------------|
| FLOOR | TOWER A | | TOWER B | | TOWER C | |
| | As per construction | As per proposed | As per construction | As per proposed | As per construction | As per proposed |
| S | 0.000 | --- | 0.000 | --- | 0.000 | --- |
| 1 | 560.007 | --- | 487.098 | --- | 500.007 | --- |
| 2 | 551.647 | --- | 478.738 | --- | --- | 524.853 |
| 3 | 551.647 | --- | 478.738 | --- | --- | 524.853 |
| 4 | 551.647 | --- | 478.738 | --- | --- | 524.853 |
| 5 | 551.647 | --- | --- | 457.190 | --- | 524.853 |
| 6 | 551.647 | --- | --- | 457.190 | --- | 524.853 |
| 7 | 551.647 | --- | --- | 457.190 | --- | 524.853 |
| 8 | 551.647 | --- | --- | 457.190 | --- | 524.853 |
| 9 | 551.647 | --- | --- | 457.190 | --- | 524.853 |
| 10 | 551.647 | --- | --- | 457.190 | --- | 524.853 |
| 11 | 551.647 | --- | --- | 457.190 | --- | 524.853 |
| 12 | 551.647 | --- | --- | 457.190 | --- | 524.853 |
| 13 | 551.647 | --- | --- | 457.190 | --- | 524.853 |
| 14 | 551.647 | --- | --- | 457.190 | --- | 524.853 |
| | 7731.424 | --- | 1923.312 | 4571.903 | 560.007 | 6823.094 |
| | | | | | | TOTAL FAR = 21609.740 |

| GROUND COVERAGE CALCULATION | | | | | |
|-----------------------------|---------|---------|---------|------------|-----------|
| | (SQM) | (SQM) | (SQM) | (SQM) | (SQM) |
| CLUSTERS | TOWER A | TOWER B | TOWER C | COMMERCIAL | COMMUNITY |
| GR. COVERAGE | 577.293 | 504.559 | 577.293 | 90.042 | 188.938 |
| TOTAL | | | | | 1938.124 |

| DENSITY CALCULATION | | |
|--|---------|---------------|
| PLOT AREA | = | 7225.00 SQM |
| | = | 0.723 Hectare |
| Density permissible @ 330 du's per hectare + 50% purchasable | = | 357.638 DUs |
| CLUSTERS | TOWER A | TOWER B |
| STILT Floor | 0 | 0 |
| 1st Floor | 6 | 6 |
| 2nd Floor | 6 | 6 |
| 3rd Floor | 6 | 6 |
| 4th Floor | 6 | 6 |
| 5th Floor | 6 | 6 |
| 6th Floor | 6 | 6 |
| 7th Floor | 6 | 6 |
| 8th Floor | 6 | 6 |
| 9th Floor | 6 | 6 |
| 10th Floor | 6 | 6 |
| 11th Floor | 6 | 6 |
| 12th Floor | 6 | 6 |
| 13th Floor | 6 | 6 |
| 14th Floor | 6 | 6 |
| TOTAL | 84 | 84 |
| TOTAL DENSITIES PROVIDED | | 84 |

OWNER: RADHEY KRISHNA TECHNO BUILD PVT. LTD.
 PROJECT: PROPOSED GROUP HOUSING AT PLOT NO. 17/GH-09, SECTOR-17, VRINDAVAN YOUNG IND. ZONE, LUCKNOW
 TITLE: SITE PLAN
 ARCHITECTS: GIAN P. MATIUR AND ASSOCIATES (P) LTD. C-35, East of Kailash, New Delhi-110065
 STRUCTURE CONSULTANT: DENPAB ENGINEERS PVT. LTD. A-202, SARVAPALLY ENCLAVE, NEW DELHI-110029
 DRG. NO.: GHLCK-01 SCALE: 1:100 DATE: NOV/18
 ARCHITECT'S SIGN: [Signature] OWNER'S SIGN: [Signature] STRUCTURE CONSULTANT'S SIGN: [Signature]