

STILT FLOOR PLAN

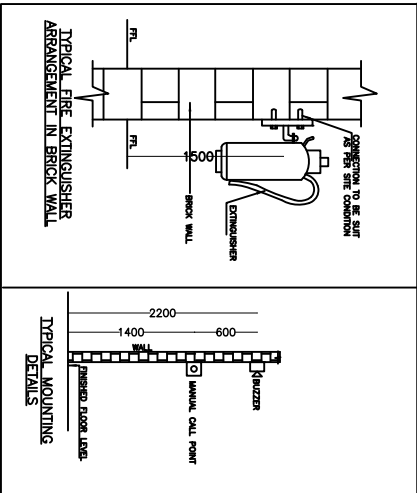

- GENERAL NOTES:-**
1. FIRE ALARM CONTROL CABLE SHALL BE 20X1.5 SQ.MM UNARMORED FRLS OUTER SHEATHED, PVC INSULATED COPPER CONDUCTOR CABLE LAID IN CONCEALED MEDIUM CLASS PVC CONDUIT.
 2. PUBLIC ADDRESS CONTROL CABLE SHALL BE 20X1.0 SQ.MM UNARMORED FRLS OUTER SHEATHED, PVC INSULATED COPPER CONDUCTOR CABLE LAID IN CONCEALED MEDIUM CLASS PVC CONDUIT.
 3. 20MM Ø MEDIUM CLASS PVC CONDUIT SHALL BE CONCEALED IN SLAB/WALL, FOR FIRE ALARM & PA CABLING IN CONCEALED CONDUIT TYPE. PVC CONDUIT SHALL BE USED WHERE IN FIRE SHAFT VERTICAL RISER AND EXPOSED BELOW CEILING.
 4. THE FIRE ALARM SYSTEM DESIGNED AS PER IS: 2189-1999.

ELECTRICAL LEGEND :-		ELECTRICAL LEGEND :-		ELECTRICAL LEGEND :-	
1	DISTRIBUTION BOARD	22	EXHAUST FAN	MCB	MANUAL CALL POINT
2	RECESS MOUNTED LIGHT	23	TWO WAY SWITCH	B	BUZZER
3	SURFACE MOUNTED LIGHT	24	ONE WAY SWITCH	EM	PRE PAID ENERGY METER
4	RECESS MOUNTED LIGHT	25	6AMP. SOCKET OUTLET	DIS	DISP. AT UNIT
5	MIRROR LIGHT	26	20AMP. A.C SOCKET OUTLET	FAS	T.V/T.P JUNCTION BOX
6	BULK HEAD	27	16AMP. SOCKET OUTLET	FAS	FIRE ALARM SYSTEM
7	WALL MOUNTED LIGHT	28	16AMP. SOCKET FOR GEYSER		
8	CEILING MOUNTED LIGHT	29	6AMP. SOCKET		
9	WALL BRACKET LIGHT	30	T.V OUTLET WITH 2 NOS. 6AMP. SOCKET		
10	CEILING FAN	31	MULTIPLE SOCKET OUTLET (3 NOS. 6AMP. SOCKET & NOS. 16AMP. SWITCH)		
11	WALL FAN	32	TELEPHONE SOCKET OUTLET		
		33	DATA SOCKET OUTLET		

QTY NO.	WIRE	DESCRIPTION	NO. OF POINTS	LOAD IN WATTS
S1	2x1.5-1X1.5 sqmm	STAIR	4	---
R1	10 2x1.5-1X1.5 sqmm	CORRIDOR GROUND FLOOR	3	---
R2	10 2x1.5-1X1.5 sqmm	PARKING	8	---
R3	10 2x1.5-1X1.5 sqmm	CORRIDOR 2ND FLOOR	8	---
R4	10 2x1.5-1X1.5 sqmm	CORRIDOR 3TH & 4TH FLOOR	8	---
R5	10 2x1.5-1X1.5 sqmm	CORRIDOR 1TH FLOOR	8	---
R	16 2x4-1X4 sqmm	CORRIDOR	1	1000
S2	10 2x1.5-1X1.5 sqmm	ELECTRICAL ROOM	4	---
Y1	10 2x1.5-1X1.5 sqmm	CORRIDOR GROUND FLOOR	3	---
Y2	10 2x1.5-1X1.5 sqmm	PARKING	8	---
Y3	10 2x1.5-1X1.5 sqmm	CORRIDOR 3RD FLOOR	8	---
Y4	10 2x1.5-1X1.5 sqmm	CORRIDOR 6TH FLOOR	8	---
Y5	10 2x1.5-1X1.5 sqmm	CORRIDOR 7TH FLOOR	8	---
P2	16 2x4-1X4 sqmm	CORRIDOR STAIR CASE	1	1000
Y	---	SPACE	---	---
B1	10 2x1.5-1X1.5 sqmm	LOBBY	4	---
B2	10 2x1.5-1X1.5 sqmm	CORRIDOR 5TH FLOOR	8	---
B3	10 2x1.5-1X1.5 sqmm	CORRIDOR 4TH FLOOR	8	---
B4	10 2x1.5-1X1.5 sqmm	CORRIDOR 7TH FLOOR	8	---
B5	10 2x1.5-1X1.5 sqmm	CORRIDOR 10TH FLOOR	8	---
P3	16 2x4-1X4 sqmm	ELECTRICAL ROOM	1	1000
B	---	SPACE	---	---
B	---	SPACE	---	---
				8 PHASE 400V 50HZ 32AMP 4P. MCB
				4CX10sq.mm wire
				2CX6sq.mm earth wire
				TOTAL LOAD=---

PROPOSED GROUP HOUSING- OMEGA PRESIDENCY FOR OMEGA DEVELOPER AND BUILDERS AT KHASRA NUMBER 165 & 185 AT VILLAGE UTAR DHAUNA, DISTRICT AND TEHSIL LUCKNOW.

GENERAL NOTES:

1. ALL SWITCH BOARD SHALL BE FIXED AT +1200mm (BOTTOM OF BOX) FROM FINISHED FLOOR LEVEL & 200mm FROM WALL EDGE.
2. ALL 6/16 Amp. SWITCH SOCKET SHALL BE FIXED AT +500mm (BOTTOM OF BOX) FROM FINISHED FLOOR LEVEL.
3. ALL DISTRIBUTION BOARD SHALL BE FIXED AT +1400mm (BOTTOM OF BOX) FROM FINISHED FLOOR LEVEL AND CONCEALED IN 230mm THICK BRICK WALL.
4. ALL BRACKET/WALL MOUNTED FIXTURE SHALL BE FIXED AT +2100mm/ ABOVE DOOR, FROM FINISHED FLOOR LEVEL.
5. ALL T.V. TELEPHONE SOCKETS SHALL BE FIXED AT +300mm (BOTTOM OF BOX) FROM FINISHED FLOOR LEVEL.
6. TELEPHONE TAG BLOCK SHALL BE FIXED AT +300mm (BOTTOM OF BOX) FROM FINISHED FLOOR LEVEL.
7. ALL EX-FAN POINT IN TOILET SHALL BE FIXED AT +2250mm (BOTTOM OF BOX) FROM FINISHED FLOOR LEVEL.
8. ALL LIGHTING POWER CONDUIT SHALL BE OF 25mm Ø PVC WITH 2mm WALL THICKNESS (FRLS) TO BE USED IN WALL AND SLAB.
9. ALL T.V./TELEPHONE CONDUIT SHALL BE OF 25mm Ø PVC WITH 2mm WALL THICKNESS (FRLS) TO BE USED IN WALL AND SLAB.
10. ALL SUB MAIN CONDUIT SHALL BE OF 32/40mm Ø PVC WITH 2mm WALL THICKNESS (FRLS) TO BE USED IN WALL AND SLAB.

BUILDING MEP CONSULTANT
TRIVENI CONSULTING ENGINEERS
FLAT NO.-D, GF, AVON RESIDENCY
AT/8, SEC-H, ALIGANJ,
LUCKNOW
EMAIL: triveniconsultants_lko@gmail.com
PH: 5224108651, 09794991799

SERVICES DRAWING
ELECTRICAL SUPPLY
STILT FLOOR ELECTRICAL AND FIRE ALARM LAYOUT

REFERENCE NO.: G-108
SHEET NO.: 1
SCALE: 1:100
DATE: DEC'16
DRAWN BY: MOHIT JAIN/SVA

ORIENTATION

architects savita-rohit ARCHITECT
interior decorators & muralists
sector - a, Lucknow
alignj scheme, 2321590, 2320715
no.

Copyright © Muralige 2015. All rights reserved.

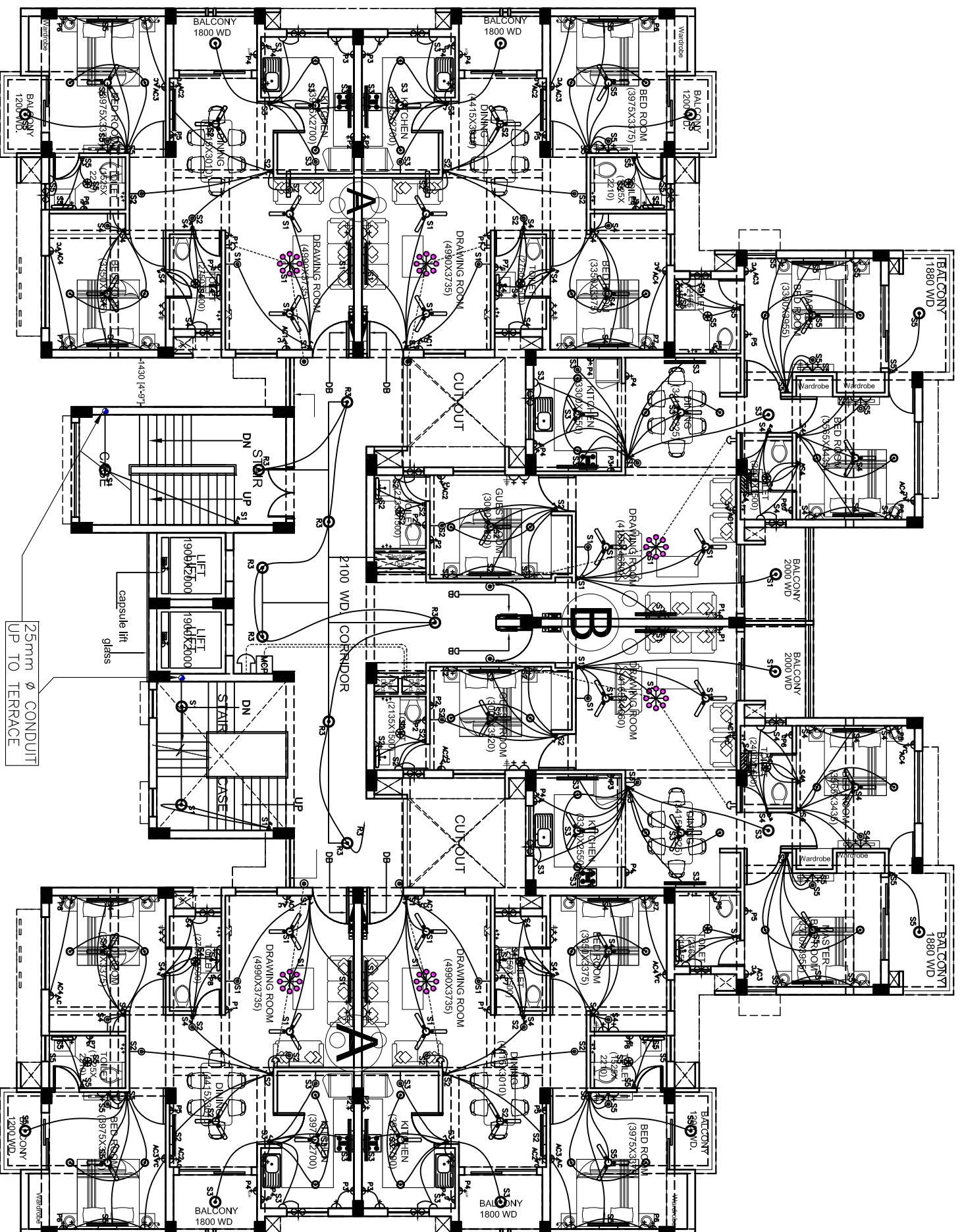

TYPICAL FLOOR PLAN (2nd to 10th Floor)

GENERAL NOTES:

1. ALL SWITCH BOARD SHALL BE FIXED AT +1200mm (BOTTOM OF BOX) FROM FINISHED FLOOR LEVEL & 200mm FROM WALL EDGE.
2. ALL 6/16 Amp. SWITCH SOCKET SHALL BE FIXED AT +300mm (BOTTOM OF BOX) FROM FINISHED FLOOR LEVEL.
3. ALL DISTRIBUTION BOARD SHALL BE FIXED AT +1400mm (BOTTOM OF BOX) FROM FINISHED FLOOR LEVEL AND CONCEALED IN 230mm THICK BRICK WALL.
4. ALL BRACKET/WALL MOUNTED FIXTURE SHALL BE FIXED AT +2100mm/ ABOVE DOOR, FROM FINISHED FLOOR LEVEL.
5. ALL T.V, TELEPHONE SOCKETS SHALL BE FIXED AT +300mm (BOTTOM OF BOX) FROM FINISHED FLOOR LEVEL.
6. TELEPHONE TAG BLOCK SHALL BE FIXED AT +300mm (BOTTOM OF BOX) FROM FINISHED FLOOR LEVEL.
7. ALL EX-FAN POINT IN TOILET SHALL BE FIXED AT +2250mm (BOTTOM OF BOX) FROM FINISHED FLOOR LEVEL.
8. ALL LIGHTING POWER CONDUIT SHALL BE OF 25mm ϕ PVC WITH 2mm WALL THICKNESS (FRLS) TO BE USED IN WALL AND SLAB.
9. ALL T.V/TELEPHONE CONDUIT SHALL BE OF 25mm ϕ PVC WITH 2mm WALL THICKNESS (FRLS) TO BE USED IN WALL AND SLAB.
10. ALL SUB MAIN CONDUIT SHALL BE OF 32/40mm ϕ PVC WITH 2mm WALL THICKNESS (FRLS) TO BE USED IN WALL AND SLAB.

GENERAL NOTES:-

1. FIRE ALARM CONTROL CABLE SHALL BE 2CX1.5 SQ.MM UNARMORED FRLS OUTER SHEATHED, PVC INSULATED COPPER CONDUCTOR CABLE LAID IN CONCEALED MEDIUM CLASS PVC CONDUIT.
2. PUBLIC ADDRESS CONTROL CABLE SHALL BE 2CX1.0 SQ.MM UNARMORED FRLS OUTER SHEATHED, PVC INSULATED COPPER CONDUCTOR CABLE LAID IN CONCEALED MEDIUM CLASS PVC CONDUIT.
3. 20MM ϕ MEDIUM CLASS PVC CONDUIT SHALL BE CONCEALED IN SLAB/WALL, FOR FIRE ALARM & PA CABLING IN CONCEALED CONDUIT TYPE. PVC CONDUIT SHALL BE USED WHERE IN FIRE SHAFT VERTICAL RISER AND EXPOSED BELOW CEILING.
4. THE FIRE ALARM SYSTEM DESIGNED AS PER IS: 2189-1999.

ELECTRICAL LEGEND:-

S.NO.	SYMBOL	DESCRIPTION	S.NO.	SYMBOL	DESCRIPTION
1		ONE WAY SWITCH	10		16 A POWER SWITCH SOCKET
2		TWO WAY SWITCH	11		TELEPHONE OUTLET
3		BRACKET LIGHT	12		DISTRIBUTION BOARD (DB)
4		TV POINT WITH DA SPIN 2 SOCKET (SWITCH SEPARATE)	13		TV/P JUNCTION BOX
5		CEILING LIGHT	14		CEILING LIGHT
6		CEILING FAN (1200MM DIA IN GENERAL AREAS 1050 MM DIA IN KITCHEN)	15		CALL BELL PUSH
7		6x3 PIN SWITCH SOCKET	16		CALL BELL BUZZER
8		EX-FAN WITH 6x5 PIN SOCKET (SWITCH SEPARATE)	17		AC POINT
9		PRE PAID METER HOME DISPLAY UNIT	18		MANUAL CALL POINT
			19		BUZZER

Copyright © Murahage 2015. All rights reserved!

PROPOSED GROUP HOUSING-
OMEGA PRESIDENCY FOR
OMEGA DEVELOPER AND
BUILDERS AT KHASRA
NUMBER
165 & 185 AT VILLAGE UTTAR
DHAUNA, DISTRICT AND
TEHSIL LUCKNOW.

THIS DRAWING AND THE INFORMATION CONTAINED HEREIN SHALL NOT BE DISCLOSED, REPRODUCED OR USED FOR ANY PURPOSE BY ANY PERSON WITHOUT THE EXPRESS WRITTEN CONSENT OF M/S MURAHAGE. THIS DRAWING IS PROTECTED UNDER COPYRIGHT LAW AND ANY COPYING OR REPRODUCTION HEREOF IS PROHIBITED. UNAUTHORISED PERSONS FOUND COPYING THIS DRAWING OR ANY PART OF THIS DOCUMENT OR USING THE SAME FOR ANY PURPOSE SHALL BE SUBJECT TO LEGAL ACTION.

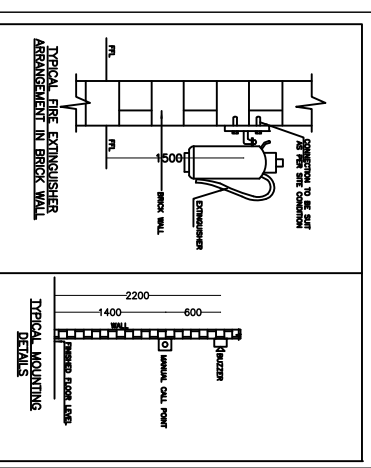

BUILDING MEP CONSULTANT

TRIVENI CONSULTING ENGINEERS
FLAT NO.-D, GF, AVON RESIDENCY
A1/8, SEC-H, ALIGANJ,
LUCKNOW
EMAIL: triveniconsultants.lko@gmail.com
PH: 5224108651, 09794991199

SERVICES DRAWING ELECTRICAL SUPPLY TYPICAL FLOOR ELECTRICAL AND POWER LAYOUT (2ND TO 10TH FLOOR)

REFERENCE NO.:	G-108
SHEET NO.:	2
SCALE:	1:100
DATE:	DEC-16
DRAWN BY:	MOHIT JAIN/SWAL

ORIENTATION	
architects	savita-rohit
interior decorators & muralists	architects
sector - a, alligani scheme, lucknow	interior decorators & muralists
no.:	2321590
phone	2320715

ARCHITECT
savita-rohit
interior decorators & muralists
architects
sector - a, alligani scheme, lucknow
no. : 2321590
phone 2320715