

SERVICE PLAN

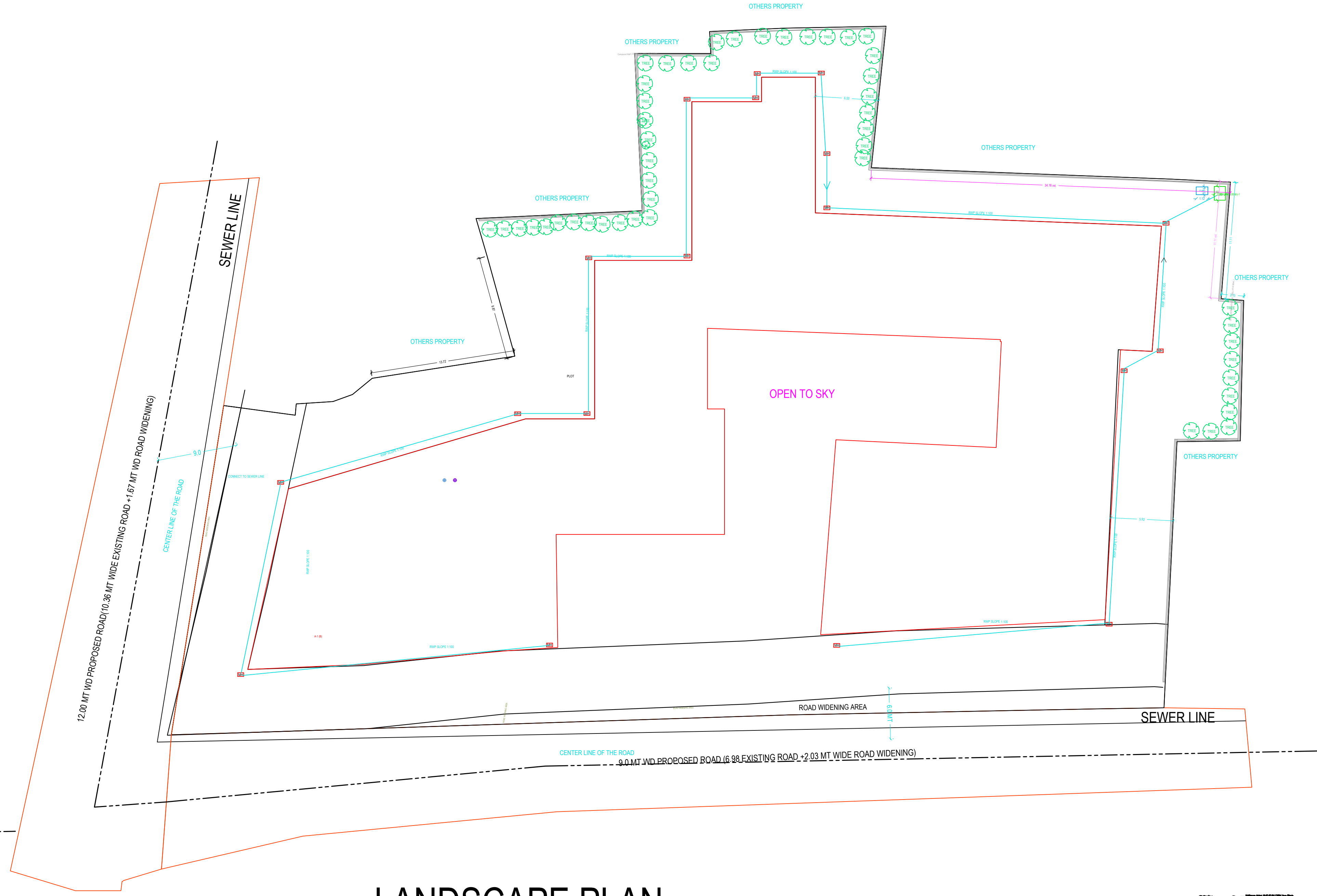

LANDSCAPE PLAN

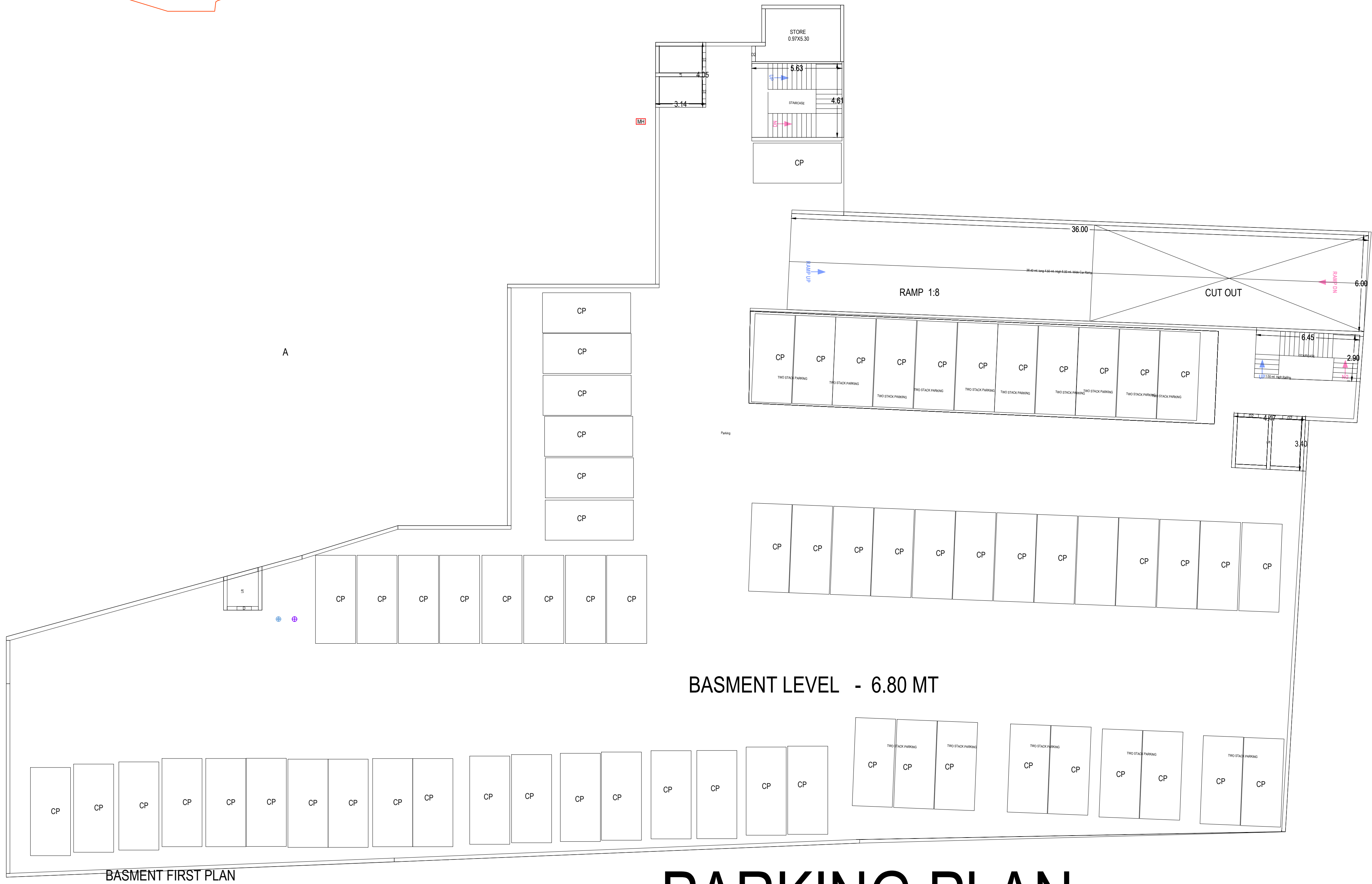
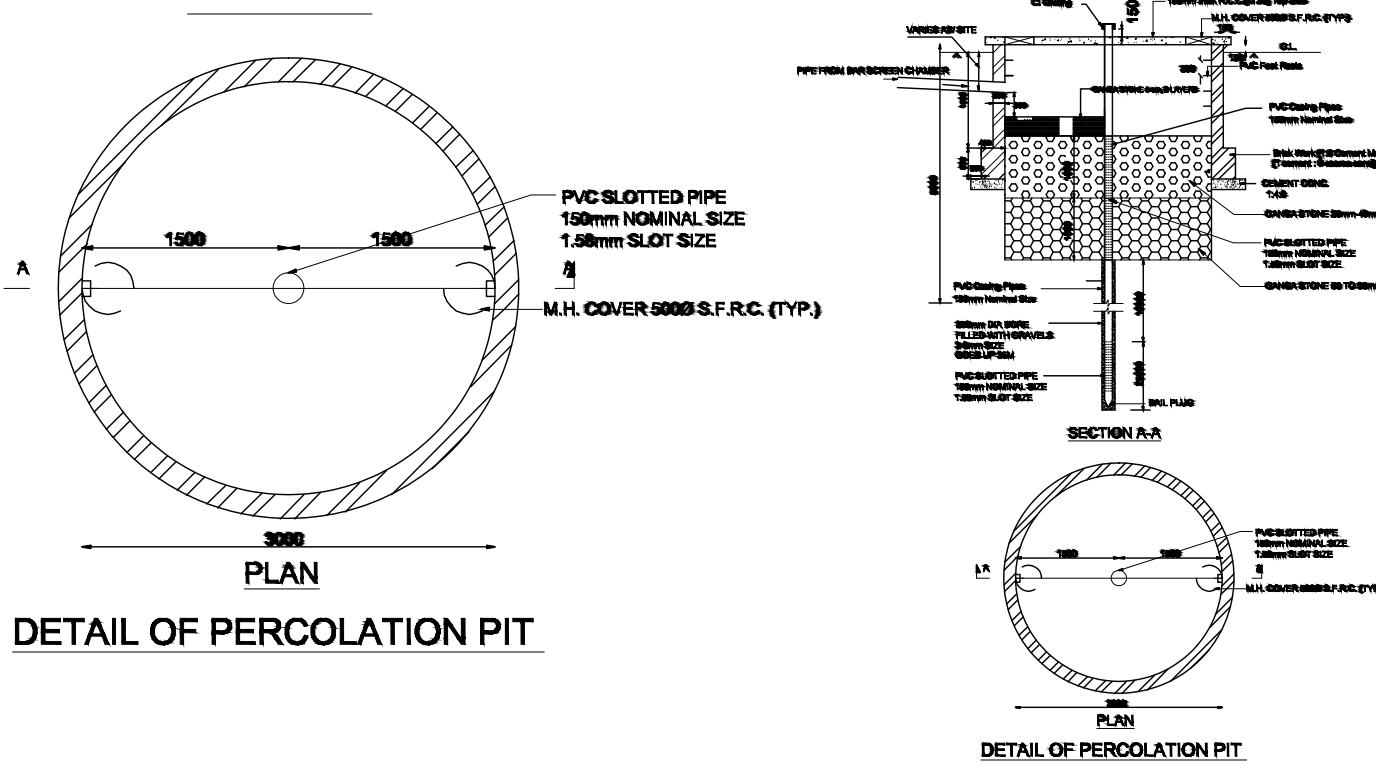

PARKING PLAN



TO BE DEMOLISHED GROUND FLOOR PLAN

Note: - 1) This drawing is prepared as per the current prevailing Building Bye Laws.
2) If Map sanctioned is used for purpose anything other than stated in application will lead to rejection of Map.

OWNER'S NAME AND SIGNATURE
KRIDHA EARTH DEVELOPERS LLP PARTNER PARTNER AND SIGN
RAKESH KOHLI AND KRISHNA BHOO VIKAS LLP THROUGH
PARTNER VINOD AGARWAL, rakesh.kohli07@gmail.com,
9319105376

ARCHITECT'S NAME AND SIGNATURE
Arvind Kumar Upadhyay
AM13885504042019

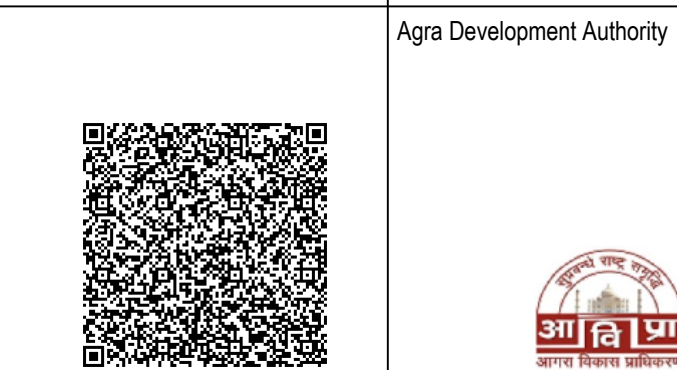

Building Plan Application Number

ADA/BP/24-25/0232

Sanctioned On

02 Jan 2025

Valid Till

09 Jan 2030

Approved By

M. ARUNMOZH (Vice Chairman)

Examined By

Raj Kapoor (JE)

Satish Chand Rajput (Assistant Engineer)

Raj Kapoor (JE)

Satish Chand Rajput (Assistant Engineer)

Raj Kapoor (JE)

Satish Chand Rajput (Assistant Engineer)