

DRG NO.-CD,BUNDELKHAND-01/4WS/112021

NOTE:-

- THIS REVISED LAY-OUT PLAN WITH PROPERTIES DIMENSIONS HAS BEEN PREPARED ON THE BASIS OF FEASIBILITY OF NUMBERING WITH ACTUAL PROPERTIES DIMENSIONS SEND ON PREVIOUS APPROVED LAYOUT PLAN DT. 16.08.2019 BY E.E., NIRMAN KHAND - BUNDELKHAND - 01 VIDE HIS LETTER NO. - 233Y/3/36 DATED - 02.03.2021.
- REVISION HAS BEEN MADE IN SECTOR - A AND SECTOR - B IN ACCORDANCE WITH HIGH LEVEL COMMITTEE'S DECISION DATED 18.06.2021.
- IN SECTOR-C, DUE TO EXISTING 12.0 M WIDE KACCHA ROAD ADJOINING SCHEME BOUNDARY HAS BEEN CONNECTED WITH OUR SCHEME AS PER EX.EN. RECOMMEND VIDE HIS LETTER NO. - 664Y/3/100 DATED-08.07.2021 AND HIGH LEVEL COMMITTEE'S DECISION TAKEN ON DATED - 09.7.2021.
- OVER HAND TANK (O.H.T.) AND PUMP ROOM SHIFTED FROM SECTOR - A PARK TO SECTOR - D PARK AND ALSO PROPOSED C.W.R. IN SECTOR-D PARK AS PER RECOMMENDATION RECEIVED FROM S.E., BUNDELKHAND VIDE HIS LETTER NO. 22Y/1/07 DATED-25.11.2020 AND PROJECT MANAGER NIRMAN KHAND - JHANSI VIDE HIS LETTER NO. 323Y/3/46 DATED-16.03.2020 AND E.E. NIRMAN KHAND - BUNDELKHAND - 01 VIDE HIS LETTER NO. - 1498Y/3 /155 DATED-22.12.2020 AND FEASIBILITY RECEIVED FROM E.E. NIRMAN KHAND - BUNDELKHAND - 01 VIDE HIS LETTER NO. - 261 / N.K.-BUNDELKHAND - 01 / Y - 3 DATED-06.03.2021.
- THIS REVISED LAY-OUT PLAN WITH NUMBERING OF HAS BEEN FINALIZED ON THE BASIS OF THIS REVISED LAY-OUT PLAN WITH NUMBERING OF HAS BEEN FINALIZED ON THE BASIS OF EX. EN. NIRMAN KHAND - BUNDELKHAND - 01 FOR SECTOR - A VIDE HIS LETTER NO. - 664Y/3/100 DATED-08.07.2021. FOR SECTOR - B AND SECTOR-C VIDE HIS LETTER NO. - 720Y/3/127 DATED -23.07.2021 AND FOR SECTOR-D VIDE HIS LETTER NO.- 711Y/3/126 DATED-20.07.2021.
- THIS REVISED LAY-OUT PLAN WITH NUMBERING OF HAS BEEN FINALIZED ON THE BASIS OF THIS REVISED LAY-OUT PLAN WITH NUMBERING OF HAS BEEN FINALIZED ON THE BASIS OF ARCHITECT & PLANNING OFFICE,UNIT-7 VIDE HIS LETTER NO.-1828V.N.-7 DATED-10.08.2021.
- THIS LAY-OUT PLAN WITH NUMBERING OF HAS BEEN FINALIZED FISIBILITY DRAWING OF O.H.T., C.W.R. AND RISING MAIN ON BASIS OF EX. EN. C.D., BUNDELKHAND-01 VIDE HIS LETTER NO.-1058 /Y-3 / 193 DATED 13/10/2021.
- THIS LAY-OUT PLAN WITH NUMBERING OF HAS BEEN FINALIZED FISIBILITY OF O.H.T., C.W.R. AND RISING MAIN APPROVED BY CHIEF ENGINEER ON BASIS OF DIRECTOR,Q.C. & D. C. LUCKNOW VIDE HIS LETTER NO. - 420 / D.R.-2 / 42 DATED 18/11/2021.

LAY OUT PLAN OF BHOOMI VIKAS EVAM GRIHSTHAN YOJANA NO.-3, JHANSI.

DESIGN OF INTERNAL WATER SUPPLY

DATE : 25 . 11. 2021

NORTH

SCALE : 20 10 0 20 50 M

INDEX-

	300 mm Dia DI PIPE
	250 mm Dia AC PIPE
	200 mm Dia AC PIPE
	150 mm Dia PVC PIPE
	100 mm Dia PVC PIPE

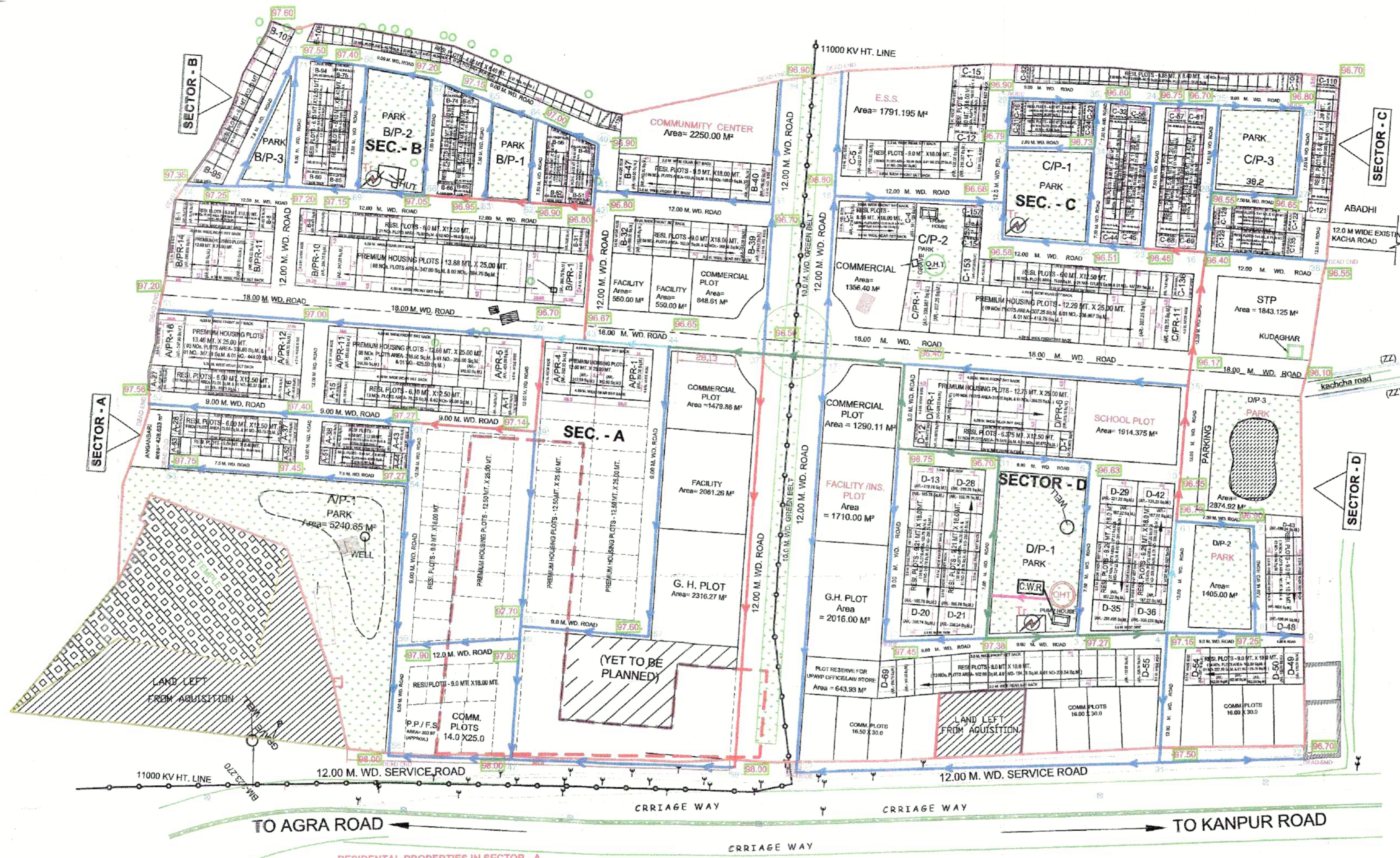

AREA CALCULATION

TOTAL SCHEME AREA	178707.94		
LAND OF WHICH AWARD NOT YET DECLARED	15686.06		
NET SCHEME AREA	163021.88		
S.N.	TYPE	AREA (SQ.M.)	PERCENTAGE
1	RESIDENTIAL	58221.38	35.71
2	COMMERCIAL	10965.57	6.73
3	SCHOOL	1914.38	1.17
4	GROUP HOUSING	4332.27	2.66
5	UPAVP OFF./LAB/STORE	643.93	0.39
6	PETROL PUMP / F.S.	393.97	0.24
7	FACILITY / INS.	4871.26	2.99
8	ELECTRIC SUB STATION	1791.20	1.10
9	AANGANBARI	428.63	0.26
10	GREEN	25958.46	15.92
11	S.T.P.	1843.13	1.13
12	COMMUNITY CENTRE	2250.00	1.38
13	ROAD	49407.72	30.31
TOTAL		163021.88	100.00

RESIDENTIAL PROPERTIES IN SECTOR - A

PLOTS ROW WITH NUMBERING	PLOT TYPE	NOS. OF PLOTS	CORNER PLOTS
APR-1 TO APR-4	PREMIUM HOUSING PLOTS - 12.50 MT X 25.00 MT.	4	A-1 & A-4
APR-5 TO APR-11	PREMIUM HOUSING PLOTS - 12.50 MT X 25.00 MT.	7	A-5 & A-11
APR-12 TO APR-18	PREMIUM HOUSING PLOTS - 12.50 MT X 25.00 MT.	7	A-12 & A-18
A-1 TO A-16	RESI. PLOTS - 6.00 MT X 12.50 MT.	15	A-1 & A-15
A-17 TO A-27	RESI. PLOTS - 6.00 MT X 12.50 MT.	12	A-17 & A-27
A-28 TO A-37	RESI. PLOTS - 6.00 MT X 12.50 MT.	10	A-28 & A-37
A-38 TO A-43	RESI. PLOTS - 6.50 MT X 12.50 MT.	6	A-38 & A-43
A-44 TO A-51	RESI. PLOTS - 6.50 MT X 12.50 MT.	8	A-44 & A-51
A-52 TO A-63	RESI. PLOTS - 6.50 MT X 12.50 MT.	12	A-52 & A-63
TOTAL PLOTS		79	

RESIDENTIAL PROPERTIES IN SECTOR - B

PLOTS ROW WITH NUMBERING	PLOT TYPE	NOS. OF PLOTS	CORNER PLOTS
BPR-1 TO BPR-10	PREMIUM HOUSING PLOTS - 13.88 MT X 25.00 MT.	10	B-1 & B-10
B-1 TO B-8	RESI. PLOTS - 6.00 MT X 12.50 MT.	8	B-1 & B-8
B-9 TO B-31	RESI. PLOTS - 6.00 MT X 12.50 MT.	23	B-9 & B-31
B-32 TO B-39	RESI. PLOTS - 6.00 MT X 12.50 MT.	8	B-32 & B-39
B-40 TO B-47	RESI. PLOTS - 6.00 MT X 12.50 MT.	8	B-40 & B-47
B-48 TO B-51	RESI. PLOTS - 6.00 MT X 12.50 MT.	4	B-48 & B-51
B-52 TO B-55	RESI. PLOTS - 6.00 MT X 12.50 MT.	4	B-52 & B-55
B-56 TO B-65	RESI. PLOTS - 6.00 MT X 12.50 MT.	10	B-56 & B-65
B-66 TO B-74	RESI. PLOTS - 6.00 MT X 12.50 MT.	9	B-66 & B-74
B-75 TO B-85	RESI. PLOTS - 6.00 MT X 12.50 MT.	11	B-75 & B-85
B-86 TO B-94	RESI. PLOTS - 6.00 MT X 12.50 MT.	9	B-86 & B-94
B-95 TO B-107	RESI. PLOTS - 6.00 MT X 12.50 MT.	13	B-95 & B-107
B-108 TO B-138	RESI. PLOTS - 6.00 MT X 12.50 MT.	32	B-108 & B-138
TOTAL PLOTS		153	

RESIDENTIAL PROPERTIES IN SECTOR - C

PLOTS ROW WITH NUMBERING	PLOT TYPE	NOS. OF PLOTS	CORNER PLOTS
C-1 TO C-4	PREMIUM HOUSING PLOTS - 12.29 MT X 25.00 MT.	4	C-1 & C-4
C-5 TO C-11	RESI. PLOTS - 6.00 MT X 18.00 MT.	7	C-5 & C-11
C-12 TO C-15	RESI. PLOTS - 6.00 MT X 18.00 MT.	4	C-12 & C-15
C-16 TO C-23	RESI. PLOTS - 6.00 MT X 18.00 MT.	8	C-16 & C-23
C-24 TO C-31	RESI. PLOTS - 6.00 MT X 18.00 MT.	8	C-24 & C-31
C-32 TO C-44	RESI. PLOTS - 6.00 MT X 18.00 MT.	13	C-32 & C-44
C-45 TO C-56	RESI. PLOTS - 6.00 MT X 18.00 MT.	12	C-45 & C-56
C-57 TO C-65	RESI. PLOTS - 6.00 MT X 18.00 MT.	9	C-57 & C-65
C-66 TO C-81	RESI. PLOTS - 6.00 MT X 18.00 MT.	16	C-66 & C-81
C-82 TO C-100	RESI. PLOTS - 6.00 MT X 18.00 MT.	19	C-82 & C-100
C-101 TO C-121	RESI. PLOTS - 6.00 MT X 18.00 MT.	21	C-101 & C-121
C-122 TO C-128	RESI. PLOTS - 6.00 MT X 18.00 MT.	7	C-122 & C-128
C-129 TO C-135	RESI. PLOTS - 6.00 MT X 18.00 MT.	7	C-129 & C-135
C-136 TO C-150	RESI. PLOTS - 6.00 MT X 18.00 MT.	15	C-136 & C-150
C-151 TO C-157	RESI. PLOTS - 6.00 MT X 18.00 MT.	7	C-151 & C-157
TOTAL PLOTS		158	

RESIDENTIAL PROPERTIES IN SECTOR - D

PLOTS ROW WITH NUMBERING	PLOT TYPE	NOS. OF PLOTS	CORNER PLOTS
D-1 TO D-6	PREMIUM HOUSING PLOTS - 12.75 MT X 25.00 MT.	6	D-1 & D-6
D-7 TO D-20	RESI. PLOTS - 6.00 MT X 18.00 MT.	14	D-7 & D-20
D-21 TO D-28	RESI. PLOTS - 6.00 MT X 18.00 MT.	8	D-21 & D-28
D-29 TO D-35	RESI. PLOTS - 6.00 MT X 18.00 MT.	7	D-29 & D-35
D-36 TO D-42	RESI. PLOTS - 6.00 MT X 18.00 MT.	7	D-36 & D-42
D-43 TO D-48	RESI. PLOTS - 6.00 MT X 18.00 MT.	6	D-43 & D-48
D-49 TO D-54	RESI. PLOTS - 6.00 MT X 18.00 MT.	6	D-49 & D-54
D-55 TO D-60	RESI. PLOTS - 6.00 MT X 18.00 MT.	6	D-55 & D-60
TOTAL PLOTS		75	

DRAWN BY	PREPARED BY	REVIEWED BY
<i>[Signature]</i>	<i>[Signature]</i>	<i>[Signature]</i>
D/M	JE	ASIST.DIRECTOR
Q.C. & D.D.-4 KANPUR	Q.C. & D.D.-4 KANPUR	Q.C. & D.D.-4 KANPUR
FISIBILITY CHECKED BY	RECOMMENDED BY	APPROVED BY
<i>[Signature]</i>	<i>[Signature]</i>	<i>[Signature]</i>
JE	AE	EE
C.D., BUND.-1 (JHANSI)	C.D., BUND.-1 (JHANSI)	C.D., BUND.-1 (JHANSI)
	SE	CHIEF ENGINEER
	BUND.CIRCLE (JHANSI)	LUCKNOW

निर्माण खण्ड सुदूरकेन्द्र-1
 30.00 आवास एवं विकास परिचय
 डॉ.बी।