

LEGEND : (Plumbing)

S. No.	SYMBOL	DESCRIPTION
1.	(S)	1100 UPVC SOIL AND VENT PIPE
2.	(W)	1100 UPVC WASTE AND VENT PIPE
3.	(B)	750 UPVC F.H.C. / CORRIDOR WASTE PIPE
4.	---	SOIL & WASTE PIPE HEADER FOR TYPICAL FLOORS PIPES

NOTES :

- Position of cutout shown on drawing is measured from center of column to cutout center.
- Soil & waste pipe slope
Minimum slope of 1100 UPVC pipe = 1:100
Minimum slope of 1600 UPVC pipe = 1:125
- The position of cutout mentioned on the drawing is indicative. the contractor is advised to prepare shop drawing before start of work.
- Soil / waste pipe material :-(Suspended from basement ceiling)
UPVC Pipe (As per IS 4985, 6 Kg / Sq cm rating suitable for solvent cement joints with necessary fitting as per IS 7834)
- All lowest floor sanitary fixtures (below which the vertical Soil / Waste pipe is turning horizontally) can only be connected into vertical / horizontal Soil / Waste Pipe only after min. 2.5 M. distance.
- It is highly recommended that the basement ceiling level soil / waste pipes should be installed before installing of any other service, because soil / waste pipe run under gravity and can not be changed / deviated, whereas, all other services may be re-aligned.
- Hierarchy of laying of services in basement ceiling :-
 - Soil / waste pipes
 - Main header of fire hydrant, sprinklers, water supply domestic & recycle mains
 - Ventilation duct
 - Cable tray
 - Sprinklers (As per ventilation zoning)
 - Lighting
 - Sub Soil drain piping
- The spacing of fire / water supply pipe supports for sprinkler / clevis hanger shall not be more than that specified below:-

Nominal pipes diameter (mm)	Spacing between supports (meter)	Support / Hanger rod diameter (mm)
Up to 25	2.00	8
32 to 50	2.50	8
65 to 80	2.50	10
100	2.50	12

NOTE :- 1) Extra supports shall be provided at the bends and at heavy fittings like valves to avoid undue stress on the pipes.

9. The spacing between supports of soil / waste pipe :-
UPVC Pipe (IS : 4985) : 1.4 m. / Joint

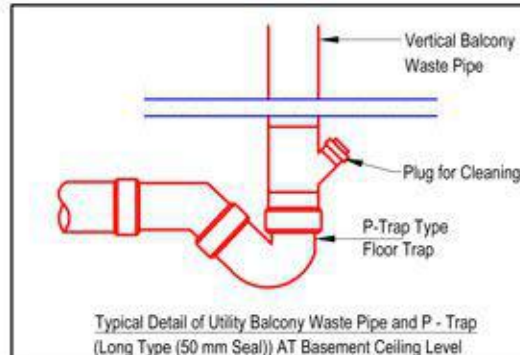
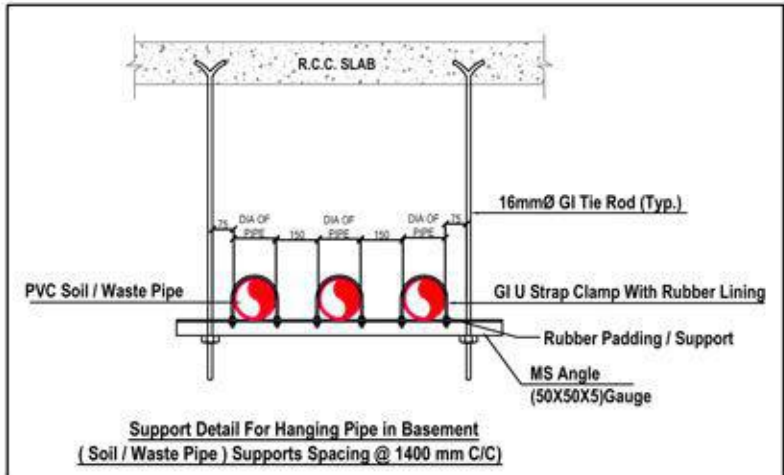
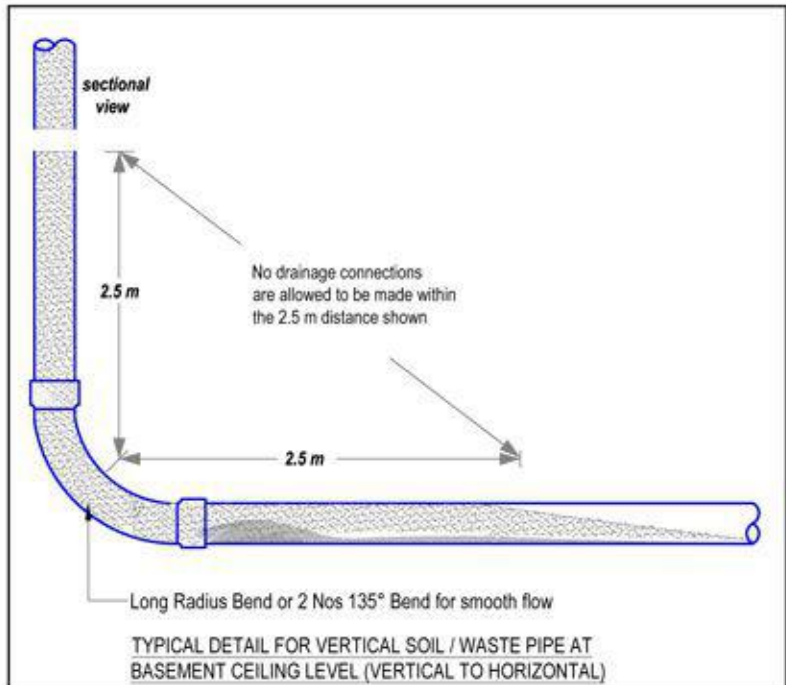
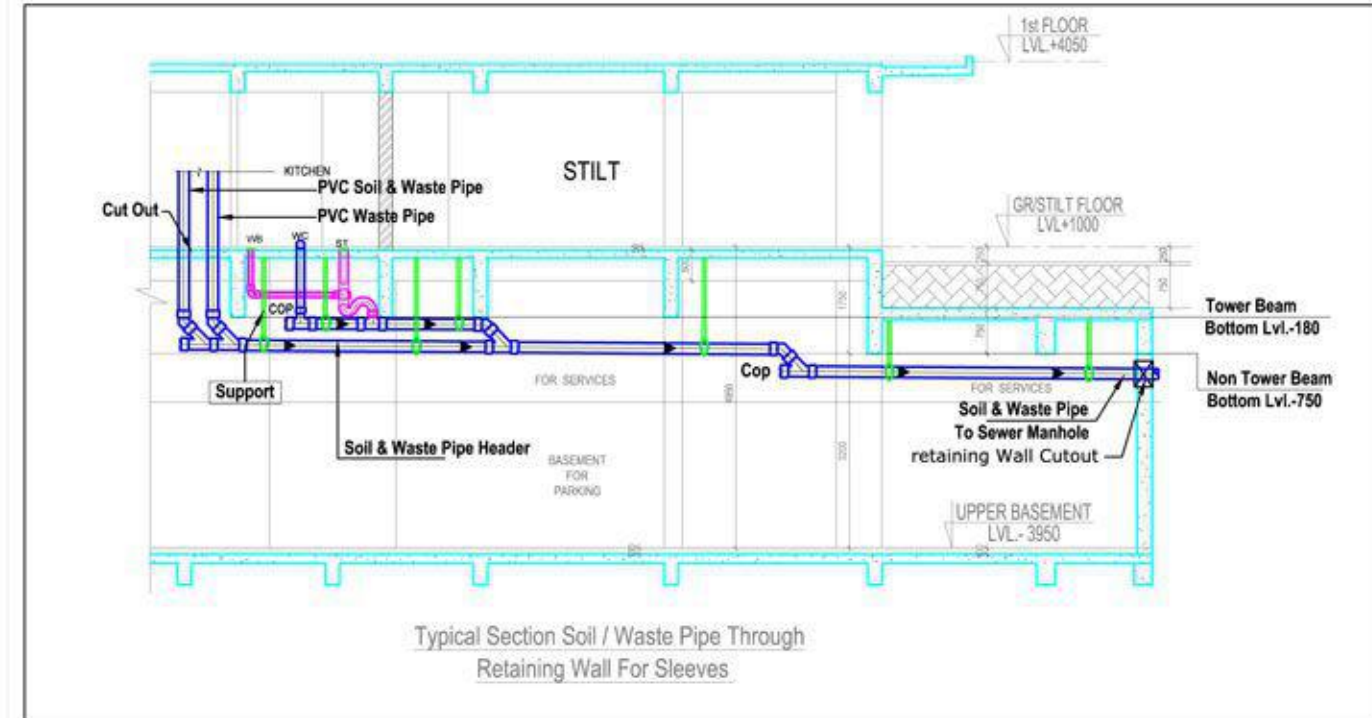

R - 1

22/09/2017

ISSUED GFC.

rev. no.	date	revision
----------	------	----------

project

ARIHANT AMBER
AT NOIDA EXTN., INDIA

title

PLUMBING DRAWING (TOWER - A & B)

subtitle

UPPER BASEMENT SOIL / WASTE PIPE DISPOSAL SYSTEM

drawing released for

☐ APPROVAL ☐ SUBMISSION
☐ ADVANCE COPY ☒ CONSTRUCTION

drg. no.

ARIHANT AMBA/UB / SW / P - 01

drawn by

Baldev

scale

1 : 140

designed by

Sanjay Goel

date

July 2017

checked by

Anand Havelia

architects

DEEPAK MEHTA & ASSOCIATES
ARCHITECTS, PLANNERS, VALUERS, LANDSCAPE & INTERIORS
PLOT NO. 16 ABHISHEK PLAZA L.S.C. MAYUR VIHAR PH II DELHI 91
PK 6527180 TELEFAX: 22779180

services consultant

Consummate Engineering Services (P) Ltd.
Noida Office : B - 67, Sector - 67, Noida - 201 301
Tel : (0120) 6943560 / (24 Lines)
Lko. Office : R 006, Rohtas Plumeria, Gomti Nagar, Lucknow
e mail : mail@cespln, website : www.cespln

