

RIVER

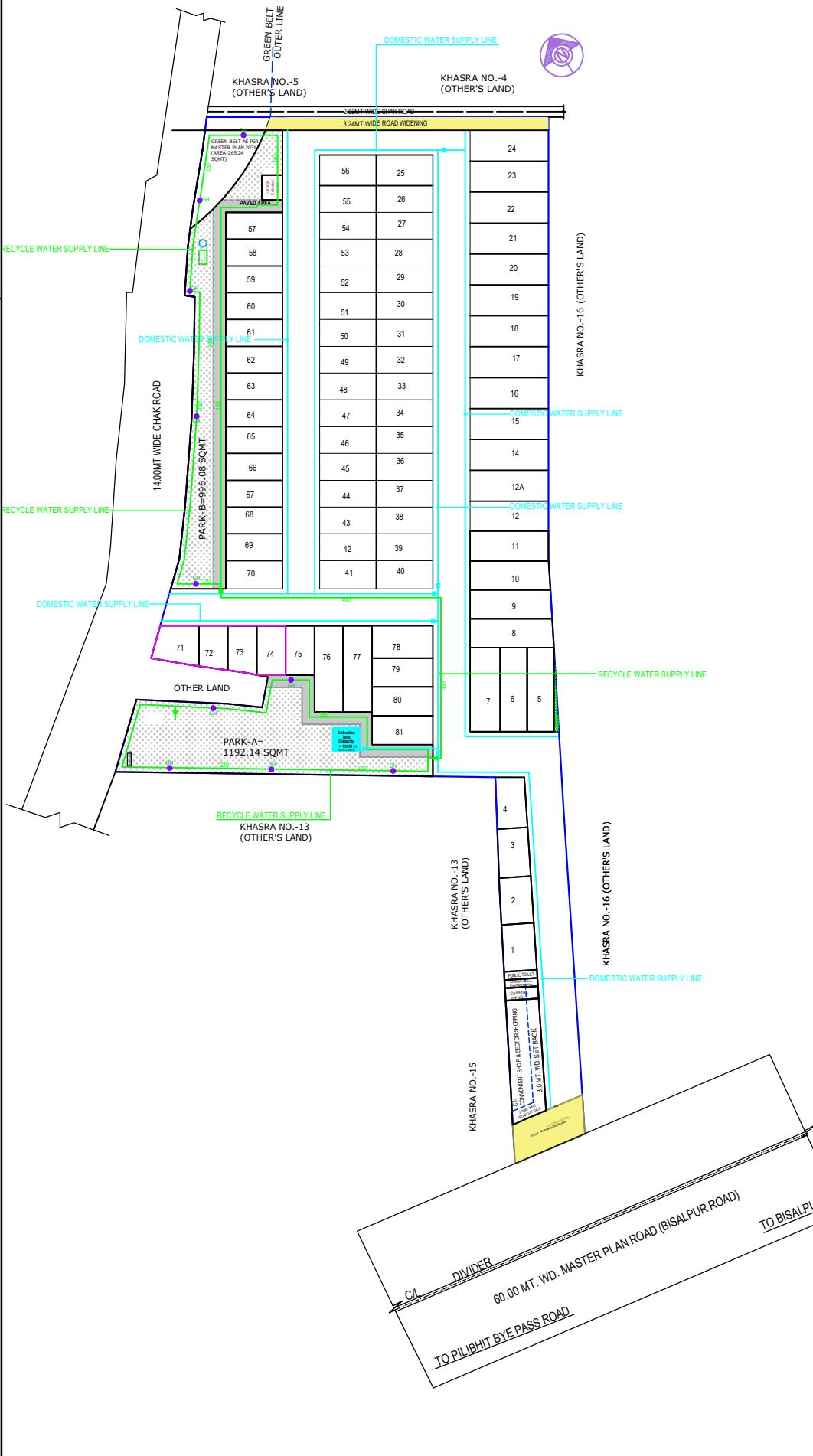

- NOTES : WATER SUPPLY**
1. The depth of domestic water supply main shall be - 1500 mm
  2. The depth of recycle water supply shall be - 1100 mm
  3. The depth of rising main line shall be - 1200 mm
  4. Pipe material for external Domestic water supply, tube well rising main & recycle water supply line shall be : UPVC (IS: 4973)

**LEGEND :**

| S.No. | SYMBOL | DESCRIPTION                                    |
|-------|--------|--|
| 1.    |        | COLD WATER SUPPLY LINE                         |
| 2.    |        | RECYCLE WATER SUPPLY LINE                      |
| 3.    |        | RISING MAINS FROM TUBEWELL (RPM)               |
| 4.    |        | ISOLATING VALVE FOR RECYCLE WATER SUPPLY LINE  |
| 5.    |        | ISOLATING VALVE FOR DOMESTIC WATER SUPPLY LINE |
| 6.    |        | GARDEN HYDRANT                                 |
| 7.    |        |  |
| 8.    |        |  |

|   |   |          |
|---|---|----------|
| Rev. No.  | Date  | Revision |
|   |   |          |
| Project : <b>KING'S PALM PARADISE AT BAREILLY</b> |   |          |
| Title : <b>MEP DRAWING</b>                        |   |          |
| Subtitle : <b>EXTERNAL WATER SUPPLY</b>           |   |          |
| Drawing Released For :                            |   |          |
| <input type="checkbox"/> APPROVAL                 | <input type="checkbox"/> SUBMISSION   |          |
| <input type="checkbox"/> ADVANCE COPY             | <input type="checkbox"/> CONSTRUCTION   |          |
| Drg. No. : <input type="text"/>                   |   |          |
| Scale : <input type="text"/>                      |   |          |
| Date : <input type="text"/>                       |   |          |
| Ckd By : <input type="text"/>                     |   |          |
| CLIENT'S SIGNATURE :                              | ARCHITECT'S SIGNATURE   |          |
|   |   |          |
|   | <b>MOHIT SINGH</b><br>B.ARCH SPA BHOPAL<br>CA/2018/92317  |          |
| Architect :                                       | <b>STUDIO DESIGN VIEWS</b>  |          |
|   | First Floor, Design Complex, Piloth Road, Bareilly<br>MB. (051-2540554, +91-896615714)<br>WEBSITE : www.studiodesignviews.com |          |
| Services Consultant :                             | <b>graft studio</b>   |          |
|   | Shop no. 09, Shri Jagdamba Market<br>Rithala, Rohini, Delhi, 110085   |          |

