

**ELECTRICAL LAYOUT(Lower ground floor)**

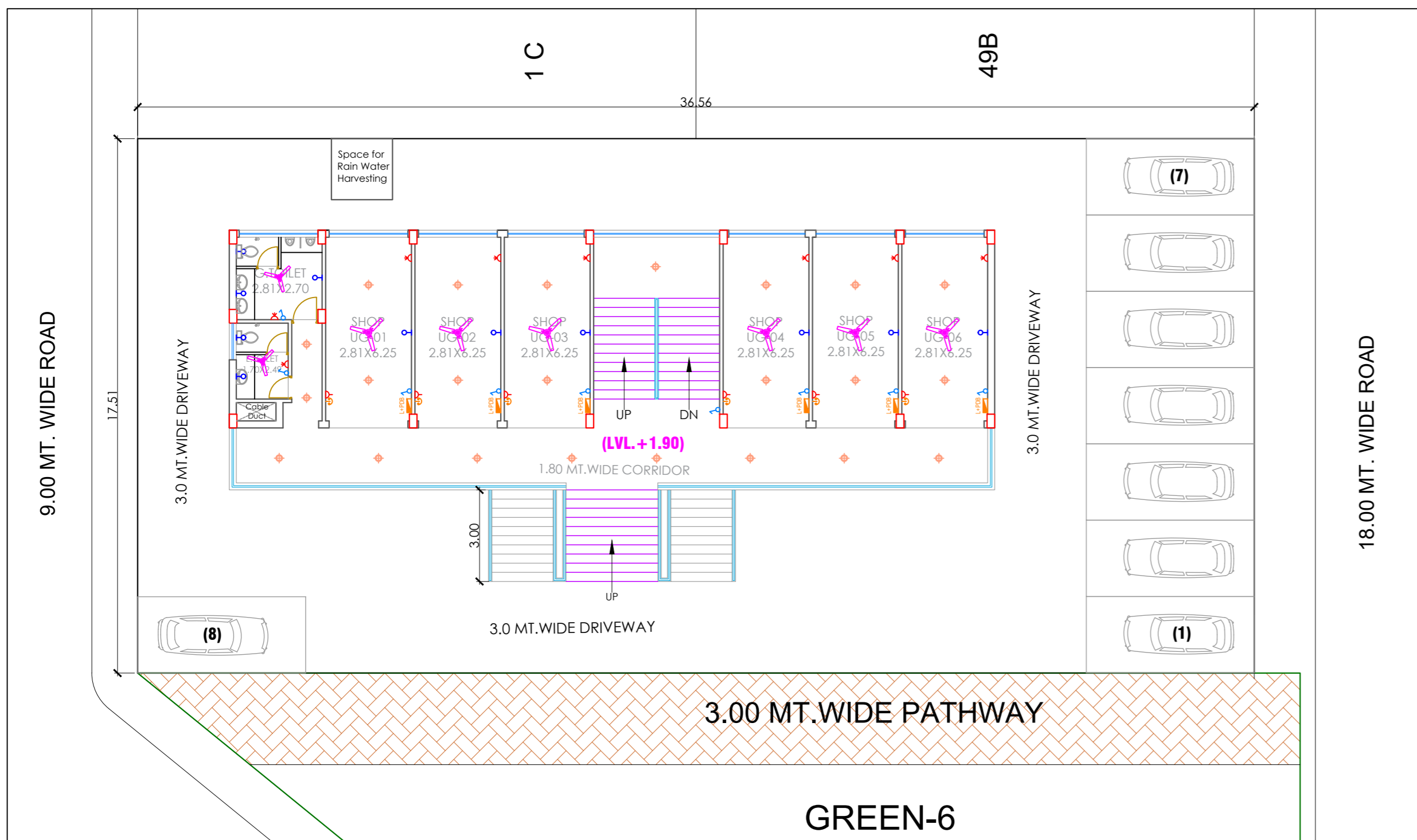

**ELECTRICAL LAYOUT(Upper ground floor)**

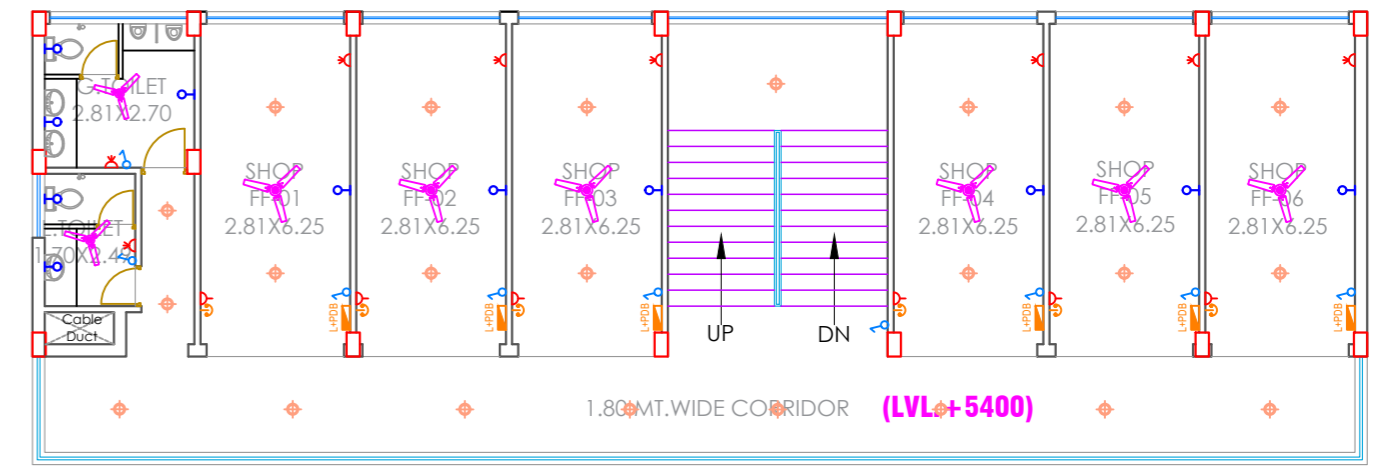

**ELECTRICAL LAYOUT(First floor)**

**LEGEND :**

SYMBOL	DESCRIPTION	MOUNTING HEIGHT ABOVE FL. LVL.
	8 Way SPN DB	1100
	LIGHT POINT	2100
	5A\15A POWER	300
	15A POWER	300
	CEILING FAN	-
	CEILING LIGHT	-

**FOR RERA SUBMISSION ONLY**

<p><b>PROJECT:-</b>  <b>LOCAL SHOPPING-04, ELDECO CITY ARCADE</b>          FOR THE TOWNSHIP AT KHASRA NOS.-476P,477P,          501P,502,503P,504,505,506,507,509 512P &amp; 513P          OF VILLAGE BILWA AT KHASRA NOS.- PART OF          438, PART OF 439,440 &amp; 441 OF VILLAGE DOHNA          PRITAM RAI AT KHASRA NO.- 898 OF VILLAGE          PIPERIA(GHANGHORA)</p>	<p><b>PROMOTER:-</b>          FOR ELDECO INFRABUILD LTD.          REGD.OFFICE -201-212,          SPLENDOR FORUM, 1<sup>ST</sup> FLOOR,          JASOLA DISTRICT CENTRE,          JASOLA, NEW DELHI-110025</p>	<p><b>DEVELOPER:-</b></p>	<p><b>ARCHITECT:-</b>    <b>Ar. Sanjay Kumar Gupta</b>          108.F. Floor, Corporate Chamber-1,          Vishnu Khand, Ganti Nagar,          Lucknow-226010          Ph.No 4065956, 9415114589          email-espaces.arch@gmail.com</p>
<p><b>PERMIT NO.:-</b>          Building Plan Application No. MAP20180928114059417          Approved On 24 May 2019          Valid Till 23 May 2024</p>	<p>DATED:27.10.2021 Drg.no.-services/04</p>		