

PART LAYOUT PLAN OF EKIA VIHAR SOUTH YOJNA RAMPUR ROAD MORADABAD

TOTAL PLAN AREA (A+B) = 30928.51 SQM

A- PROPOSED PLOTS AREA DETAILS

AREA UNDER PLANNING = 16259.52 SQM
 AREA UNDER ROAD = 3761.67 SQM
 AREA UNDER PARK = 1826.09 SQM
 AREA UNDER PLOT = 10570.76 SQM

PLOT DETAILS

75'X15.0' = 112.50 SQM (17-37) - 21 NOS
 50'X12.0' = 600.00 SQM (38-123) - 86 NOS
 40'X10.0' = 400.00 SQM (124-192) - 69 NOS
TOTAL NOS = 176

B- EXISTING HOUSES PLOT AREA DETAILS
 TOTAL 4TH/5 HOUSE NO-209

AREA UNDER SAMAJWADI & EXISTING ROAD
 = 9386.68 SQM

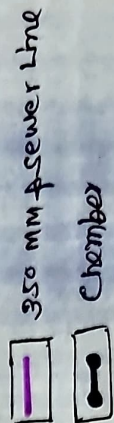
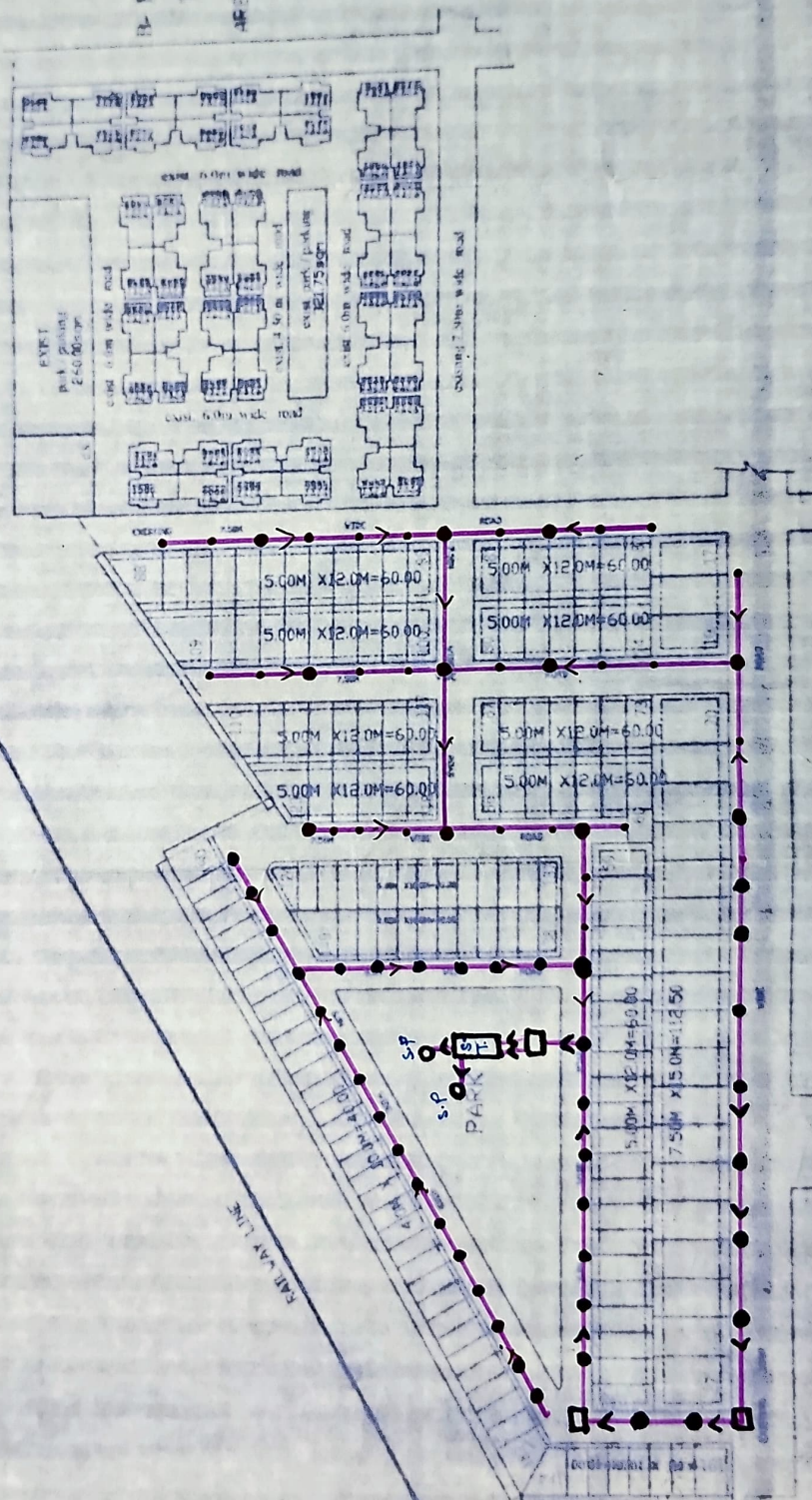

TOWN PLANNER
 SECRETARY
 VICE CHAIRMAN

J.E.
 E.E.