

REVISED DESIGN OF INTERNAL WATER SUPPLY OF VRINDAVAN YOJNA NO. 4 SECTOR-13 LUCKNOW

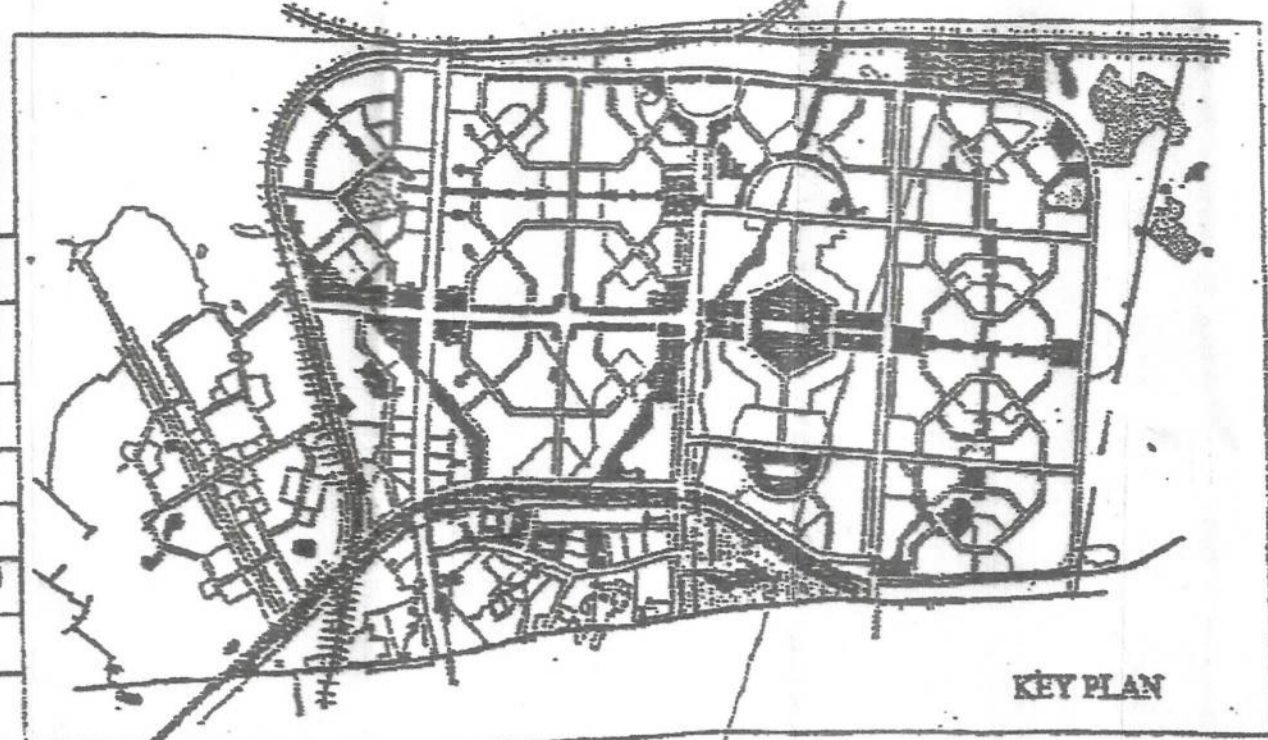
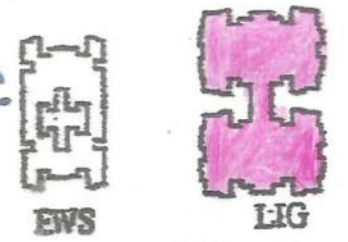

LAND USE			
1	RESIDENTIAL AREA	25440.00 M ²	26.36 %
2	OPEN/GREEN AREA	37553.10 M ²	38.92 %
3	SCHOOL PLOT	1196.50 M ²	1.24 %
4	COMMERCIAL-1	3507.00 M ²	3.63 %
5	COMMUNITY CENTER	2531.00 M ²	2.62 %
6	AANGAN BARI KENDRA	697.00 M ²	0.72 %
7	ROADS AREA	25572.00 M ²	26.50 %
TOTAL		96496.60 M ²	100.00 %

PROPERTY DETAIL										
LAND AREA		96496.60 M ²								
S.N.	PARTICULAR	FLOOR BLOCK	NO. OF UNIT EACH BLOCK	NO. OF FLOOR	TOTAL UNITS	LAND AREA (SQ.M)	CURBED AREA (SQ.M)	COVERED AREA (SQ.M)	AREA UNDER COVER (SQ.M)	AREA (SQ.M)
(A)	E.W.S.	30	08	G+3	960	40.00	27.00	1280	9600	38400
(B)	L.I.G.	33	08	G+3	1056	60.00	40.00	1920	15840	63360
TOTAL					63			3200	25440	101760
F.A.R. ACHIEVED										1.054
GROUND COVERAGE (%)										26.36%

INDEX:-

- 1. 300 mm. Ø PIPE (C.I.)
- 2. 250 mm. Ø PIPE (C.I.)
- 3. 200 mm. Ø PIPE (PVC)
- 4. 150 mm. Ø PIPE (PVC)
- 5. 125 mm. Ø PIPE (PVC)
- 6. 100 mm. Ø PIPE (PVC)
- 7. PATRI LEVEL

INDEX:-

- Proposed LIG Houses (576 Nos)

FEASIBILITY CHECKED AND FOUND FEASIBLE AT SITE
 J.E. A.E. E.E. S.E.
 C.D.-3 LKO C.D.-3 LKO. C.D.-3 LKO. VRINDAVAN CIRCLE LKO

Approved
 A.D. D.D. DIRECTOR
 Q.C. & D.D. Q.C. & D.D. Q.C. & D.D.
 LKO LKO LKO

Proposed Crown Level
 Level of 45.00 m. Road (Crown Level)
 45.00-00
 45.00-00

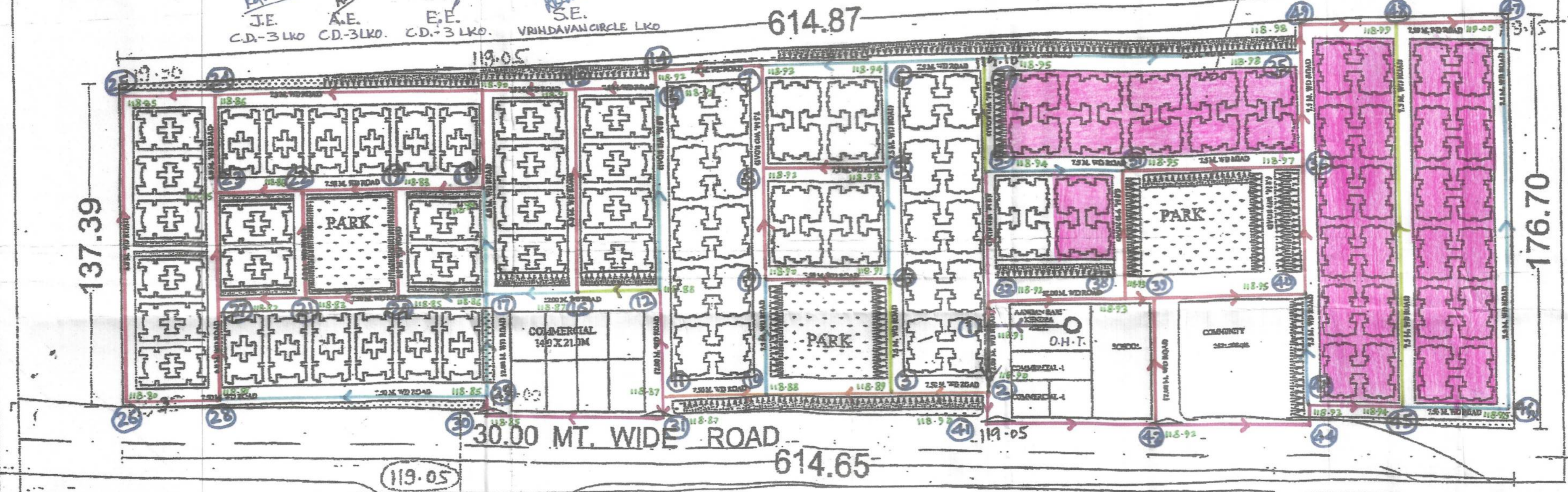

UPAVP
 ARCHITECTURE AND PLANNING UNIT-5
 NEELGIRI COMPLEX,
 INDIRA NAGAR LUCKNOW
 Email: uphavp@sachamati.in

NOTE :-
 THIS PART LAYOUT PLAN HAS BEEN PREPARED ON THE BASIS OF DEMAND RECEIVED FROM S.E., VRINDAVAN CIRCLE, VIDE HIS LETTER NO. 2412/M-14/233 DATED 05.10.2016 AND E.E. NK-3 LETTER NO. 1495 / 2016 DT. 07.10.2016

ARCHITECTURE & PLANNING UNIT-5
 U.P. AVAS EVAM VIKAS PARISHAD, LUCKNOW
 REVISED LAY OUT PLAN OF EWS AND LIG FLATS AT SECTOR-13, VRINDAVAN YOJNA, LUCKNOW, UP.
 SCALE: 1:500
 NORTH

MUKESH KUMAR RUHELA
 B.Arch, M.P.Lanning (HOUSING), A.I.T.P.
 ASSTT. ARCH. PLANNER
 SANJEEV KASHYAP
 B.Arch, M.P.Lanning (HOUSING), A.I.T.P.
 ARCHITECT PLANNER

FILE NO.:-
 DRG. NO.:-
 Date: 22/10/2016

JE AE EE

APPROVED
 SHASHI KRISHNA KANT
 ARCH. ASSTT.

CHIEF ARCHITECT PLANNER:
 RUDRA FRATAP SINGH
 I.A.S
 AVAS AYUKT

JE R.K. VERMA A.E. EE