

390430

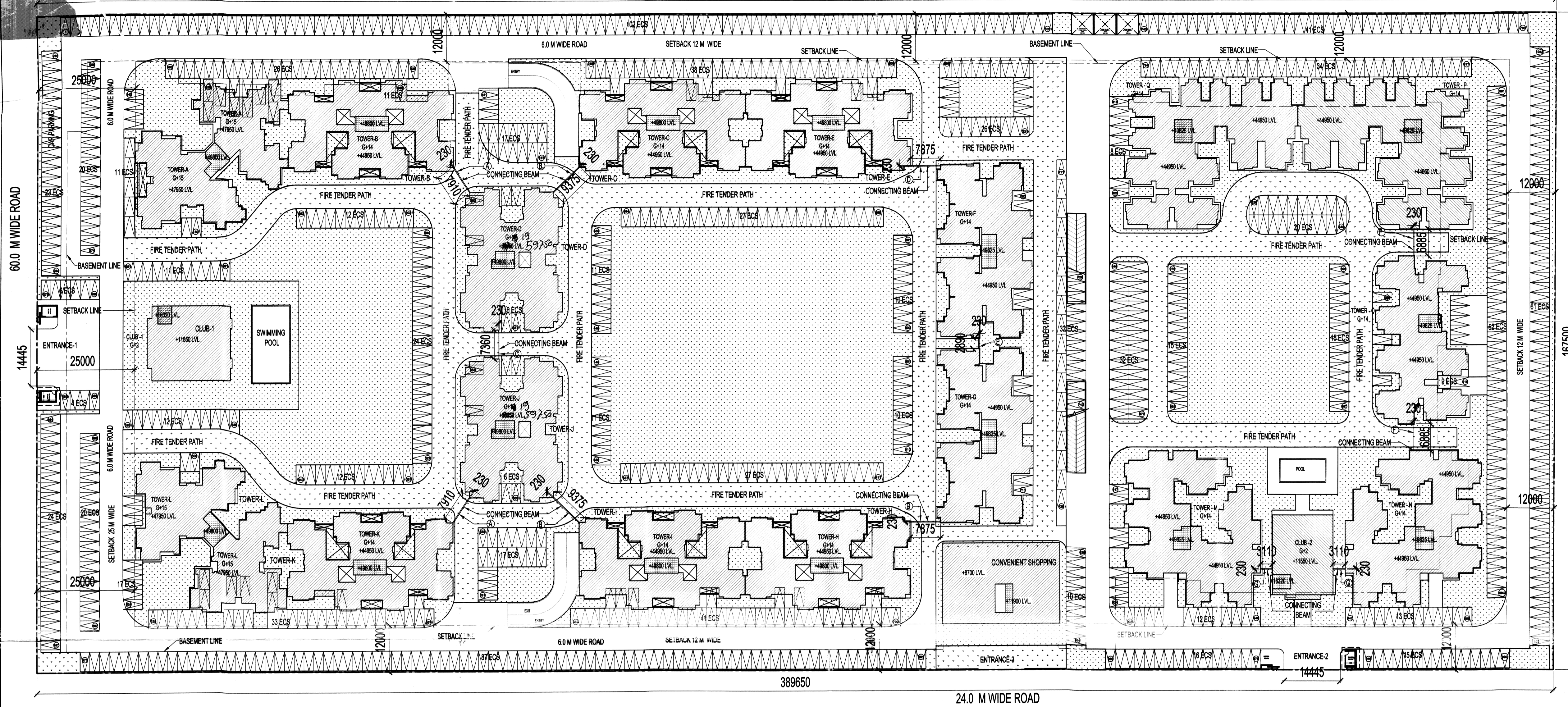

NORTH POINT
This drawing is a "COPYRIGHT" contents of this drawing or part thereof may not be used or reproduced without the permission of the Architect

NO. OF PRINTS	DATE	ISSUED TO	REMARKS
		APPROVED	
		30/08/2011	6/4/20
REVISION	DATE	DESCRIPTION	

Drawing Checked & Verified By
16/08/11
60 M WIDE ROAD
24 M WIDE ROAD

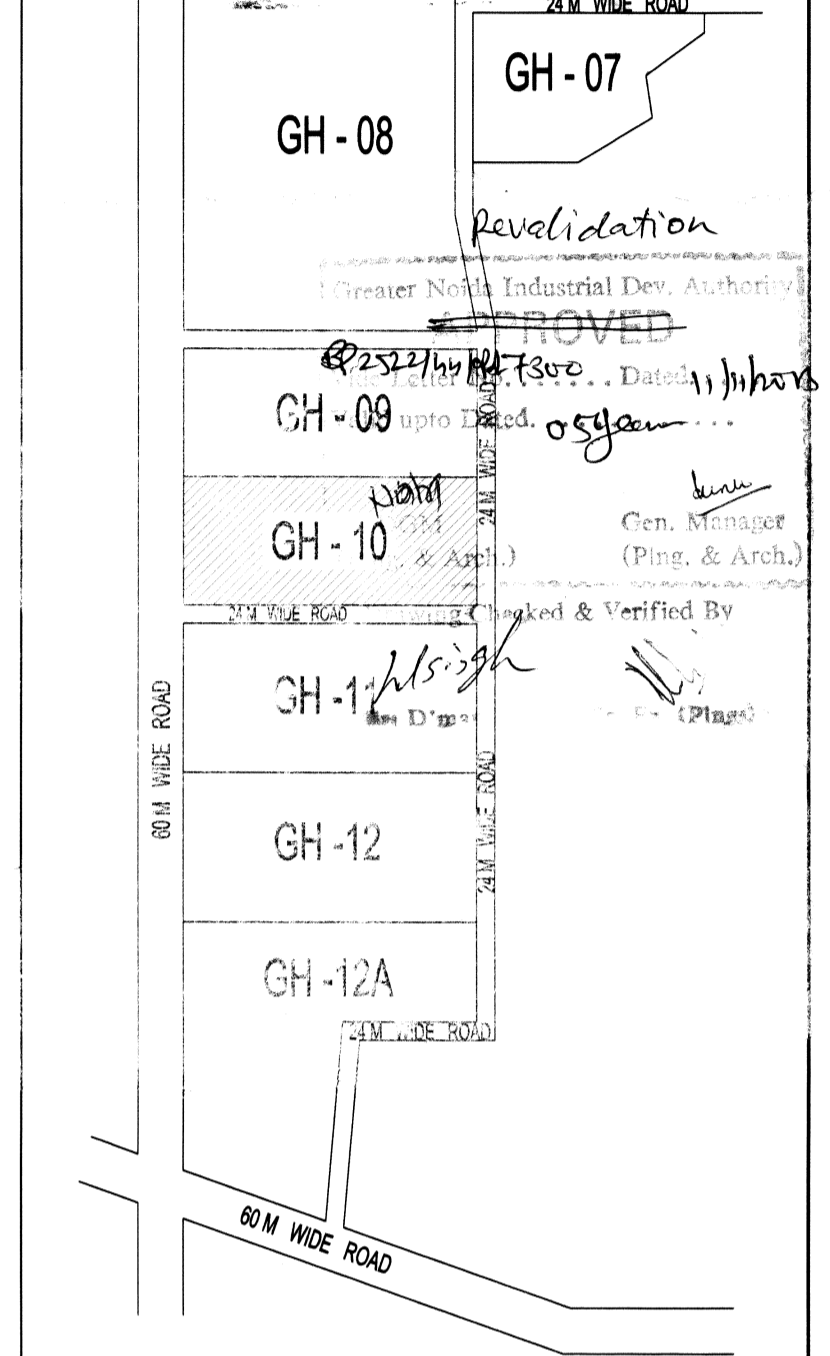

KEY PLAN

OWNER SIGN
ARCHITECT SIGN
VISHAL SHARMA
ARCHITECT
CA-8823261
9310164856
NEW DELHI

OWNER
M/S EARTHCON UNIVERSAL INFRATECH PVT.LTD

SUBMISSION DRAWING
PROJECT
PROPOSED GROUP HOUSING FOR M/S EARTHCON UNIVERSAL INFRATECH PVT. LTD AT PLOT NO. GH - 10, SECTOR -1, GREATER NOIDA, UP.

DATE 10 FEB.2011	PROJECT INCH. DEVESH SHAKYA	CHECKED BY DEVESH SHAKYA
SCALE 1:500	DEALT BY SANJAY	APPROVED BY VISHAL SHARMA

DRAWING TITLE
MASTER PLAN-1

ARCHITECTS:-
Confluence Consultancy Services
E-406, LOWER GROUND, G.K. II, NEW DELHI
PH: +91-11-29216006, FAX NO. 011-2916006
E-MAIL: ccs@confluence.com, confluenceindia@gmail.com
Web site: www.inconfluence.com
ISO 9001: 2000

DRAWING NO.	REVISION
-------------	----------

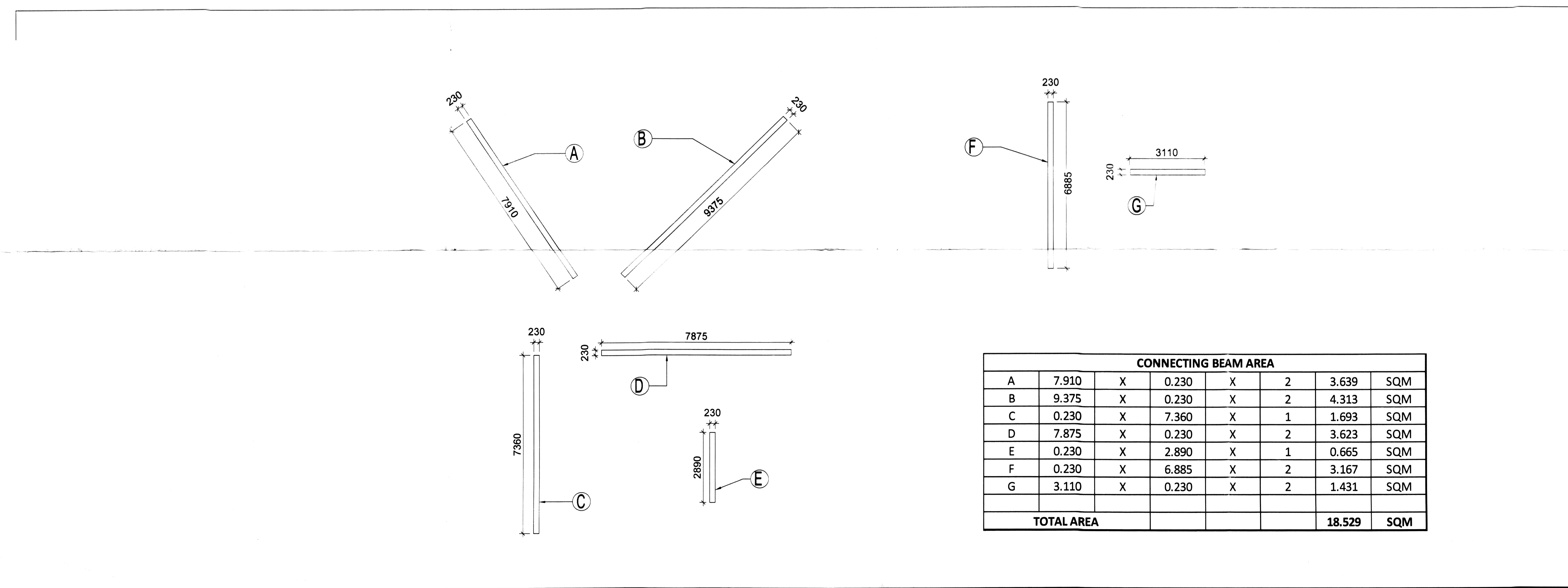

CONNECTING BEAM AREA							
A	7.910	X	0.230	X	2	3.639	SQM
B	9.375	X	0.230	X	2	4.313	SQM
C	0.230	X	7.360	X	1	1.693	SQM
D	7.875	X	0.230	X	2	3.623	SQM
E	0.230	X	2.890	X	1	0.665	SQM
F	0.230	X	6.885	X	2	3.167	SQM
G	3.110	X	0.230	X	2	1.431	SQM
TOTAL AREA						18.529	SQM