



**UPAVP**  
ARCHITECTURAL AND PLANNING SECTION  
NEELGIRI COMPLEX, INDIRA NAGAR  
LUCKNOW - 226016  
Email: upavp@sancharnet.in

DRG. NO. PROPOSED/PART L.O.P./PRADHAN MANTRI AVAS YOJNA/ BHINGA MARG/BAHRAICHA/2017/54  
PROCESS NAME/NO. UP/001/PM/03

NOTE DTD. 13.10.2017

1-THESE PART LAY OUT PLAN OF E.W.S. FLATS FOR PRADHAN MANTRI AVAS YOJNA HAS BEEN PREPARED ON THE BASIS OF INFORMATION FROM PRAMUKH SACHIV VIDE HIS SHASNADESH NO. 1855/8-1-17-80 VIVIDH / 2010 DTD.05.09.2017.  
2-IN THIS PART LAY OUT PLAN PREVIOUSLY PLANNED 9.00 MT. WIDE ROAD HAS BEEN REVISED TO 12.00 MT. WIDE ROAD.

NOTE DTD. 21.12.2017

1-THESE PART LAY OUT PLAN OF E.W.S. FLATS FOR PRADHAN MANTRI AVAS YOJNA HAS BEEN FINALIZED ON THE BASIS OF FEASIBILITY RECEIVED FROM E.E. C.D.-4 VIDE HIS LETTER NO-15/19N-783 DTD.21.12.2017.

PLOT AREA 4509.41 M<sup>2</sup>  
F.A.R. PROPOSED 1.45 (6541.44 M<sup>2</sup>)  
GROUND COVERAGE 36.00% (1635.36 M<sup>2</sup>)  
TOTAL NO. OF FLOORS G+3  
TOTAL NO. OF UNITS (E.W.S.) = 192 NOS.  
DENSITY =427 Unit/HECT.  
TOTAL POPULATION =NO OF UNITS X 5 PERSONS  
192 X 5 = 960 PERSONS

REQUIRED SPACE FOR COMMUNITY CENTER FOR 25000 PERSONS 1500.00 M<sup>2</sup>  
FOR 960 PERSONS 190.00 M<sup>2</sup> = 57.60 M<sup>2</sup>  
PROP. SPACE FOR COMMUNITY CENTER = 57.77 M<sup>2</sup>

REQUIREMENT OF CONVENIENT SHOPS FOR 400 PERSONS 01 SHOP @ 15.00 M<sup>2</sup>  
FOR 960 PERSONS 2.4 SAY 3 Shops = 15X3=45.00 M<sup>2</sup>  
REQUIRED AREA = 45.00 M<sup>2</sup>  
PROP. SPACE FOR CONVENIENT SHOPS = 45.00 M<sup>2</sup>  
PROP. SPACE FOR GREEN /PARK = 408.33 M<sup>2</sup> OR 9.01%  
PROP. SCOOTER PARKING= 192 Nos.

DRG. TITLE LAY OUT PLAN FOR PRADHAN MANTRI AVAS YOJNA  
PROJECT BHINGA MARG YOJNA, BAHRAICHA.

DATE : 21-12-2017

SCALE:

VIBHA SRIVASTAVA

ARCH. ASSTT.

PRABHAVATI SURI

ASSTT.ARCH. PLANNER

JYOTI KATIYAR

ARCHITECT PLANNER

MAHENDRA KUMAR

CHIEF ARCHITECT PLANNER

DHEERAJ SAHU

HOUSING COMMISSIONER

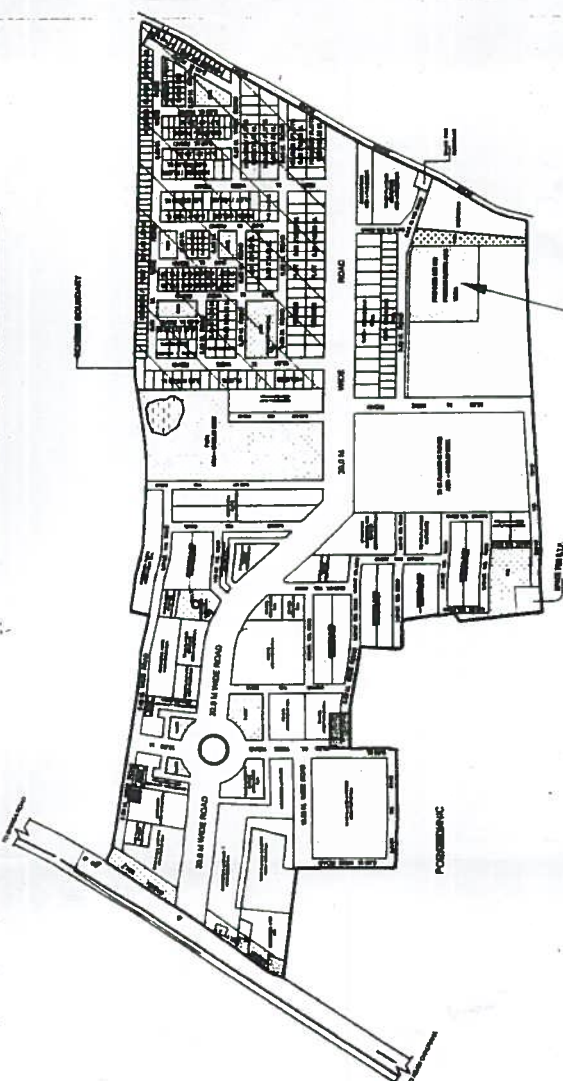

PREVIOUSLY SANCTIONED L.O.P. DTD.07.06.2017

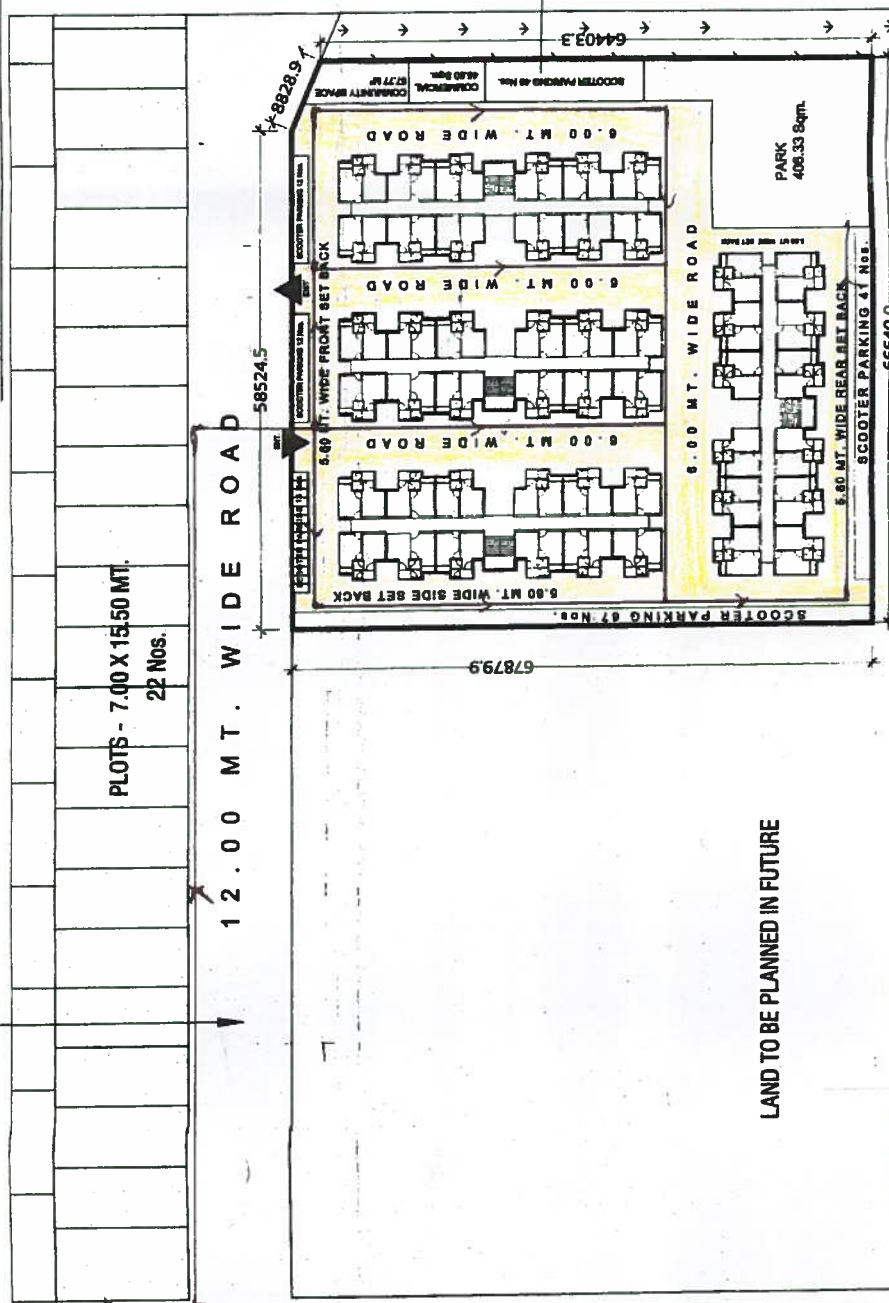

Water Supply Plan

PREVIOUSLY PLANNED 9.00 MT. WIDE ROAD REVISED TO 12.00 MT. WIDE ROAD.

PLOTS - 7.00 X 15.50 MT.  
22 Nos.

12.00 M T. WIDE ROAD

LAND TO BE PLANNED IN FUTURE

Index:-

1.) Water Supply line diagram

Note :- Water supply through the O.H.T. which is constructed in Parishad Scheme.

NOTE

1-AS THIS LAY OUT IS PREPARED WITHOUT PRIOR INFORMATION ABOUT ACTUAL DEMAND OF HOUSES UNDER PRADHAN-MANTRI AVAS YOJNA THEREFORE THE IMPLEMENTATION AND THE EXECUTION OF THE LAY OUT ON THE SITE SHALL BE MADE AS PER ACTUAL DEMAND IN THE BAHRAICHA CITY.

2-THESE LAY OUT IS SUBJECT TO REVISION AS PER ACTUAL DEMAND OF HOUSES UNDER PRADHAN-MANTRI AVAS YOJNA.

TO BE PLANNED IN FUTURE  
AREA = 16098.00 SQMT.

ROAD WIDE M. 15.00