

NOTES:

- ? PLOT BOUNDARY TO BE CONFIRMED AT SITE & DIMENSION AS PER SUBMITTED SANCTION PLAN / SURVEY PLAN TO BE CONFIRMED AT SITE BEFORE EXECUTION.
- ? THIS DRAWING IS THE PROPERTY OF M/s. DES ARC AND SHALL NOT BE COPIED OR USED IN ANYWAY WITHOUT THEIR PRIOR PERMISSION. ALL DIMENSIONS ARE IN MILLIMETERS AND AND LEVELS IN METRE UNLESS OTHERWISE MENTIONED. DRAWING NOT TO BE SCALED. WRITTEN DIMENSIONS TO BE FOLLOWED.
- ? ALL DISCREPANCIES TO BE BROUGHT TO THE NOTICE OF THE ARCHITECT BEFORE EXECUTION AND HIS DECISION TO BE FINAL.
- ? THIS DRAWING TO BE READ IN CONJUNCTION WITH DETAILS, LARGE SCALE DRAWINGS, STRUCTURAL SERVICES AND OTHER RELEVANT DRAWINGS.

REVISION	DATE	DESCRIPTION	NO. OF PRINTS	ISSUED TO	REMARKS

CLIENT :

M/S. SHREE SAI BABA INFRA PROJECTS PVT. LTD.

PROJECT :

PROPOSED AFFORDABLE HOUSING " SAI GAON " UNDER "SAMAJWADI AWASTIYA YOJNA" AT VILLAGE: KAZI SARAI , BABATPUR ROAD , VARANASI , U.P

SHEET TITLE :

SITE PLAN

ARCHITECT:

DES ARC

ARCHITECTS, INTERIORS, PLANNING

UGSR - 1A, ANSAL PLAZA, SECTOR - 1, VAISHALI, GZB
PH: 0120 - 4253114 M: 0-9818711273
EMAIL- desarc14@gmail.com

NORTH : APPROVED BY :

CHECKED BY :

SCALE -	DATE	27.5.20
DEALT -		

DRG. NO. AR001

REVISION R-0

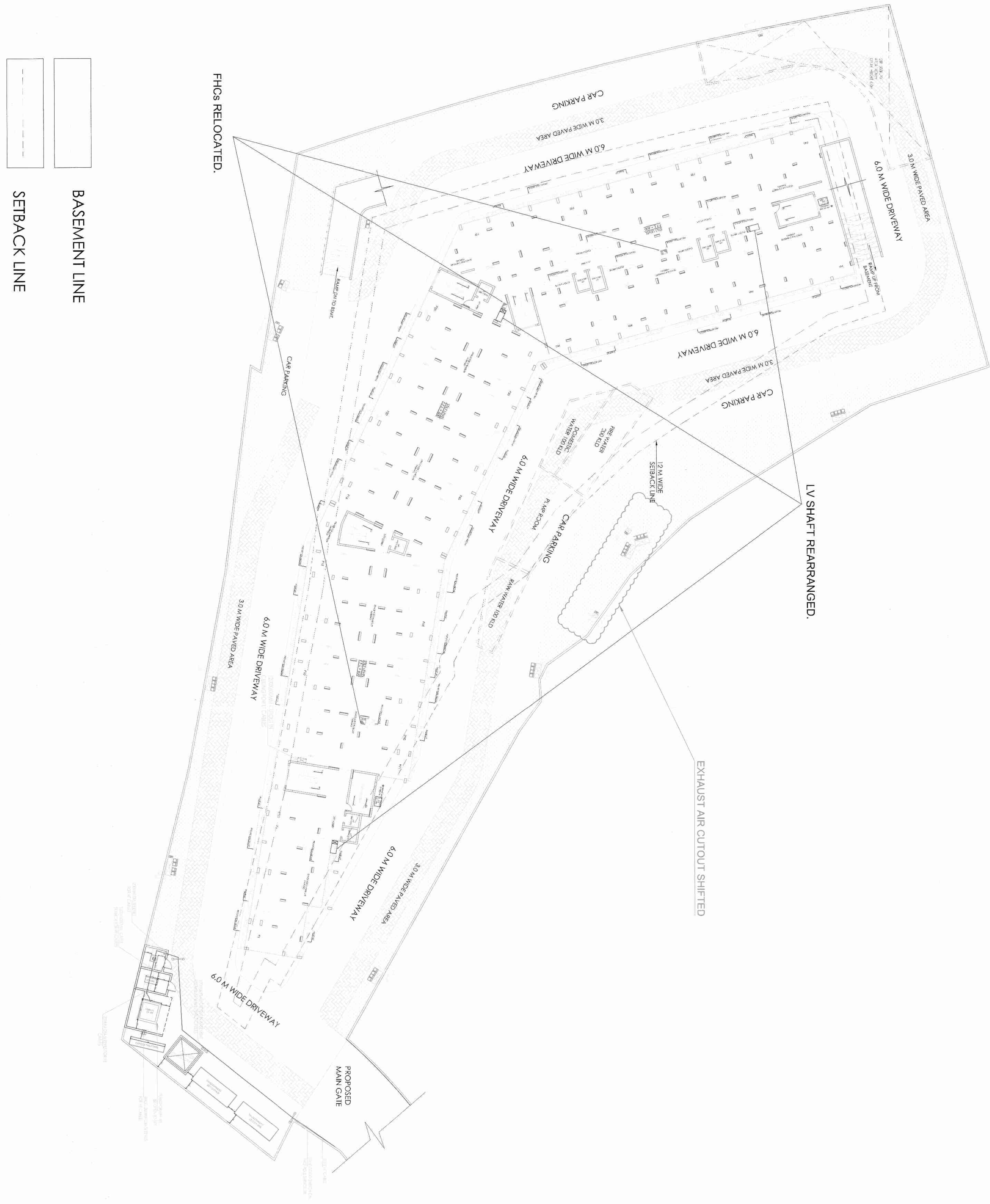

BASEMENT LINE

SETBACK LINE

S.P