

160011

# Design of Sewerage in the Pocket of LIG & EWS (G+3) Houses at Lohsamau Youna, Sultanpur.

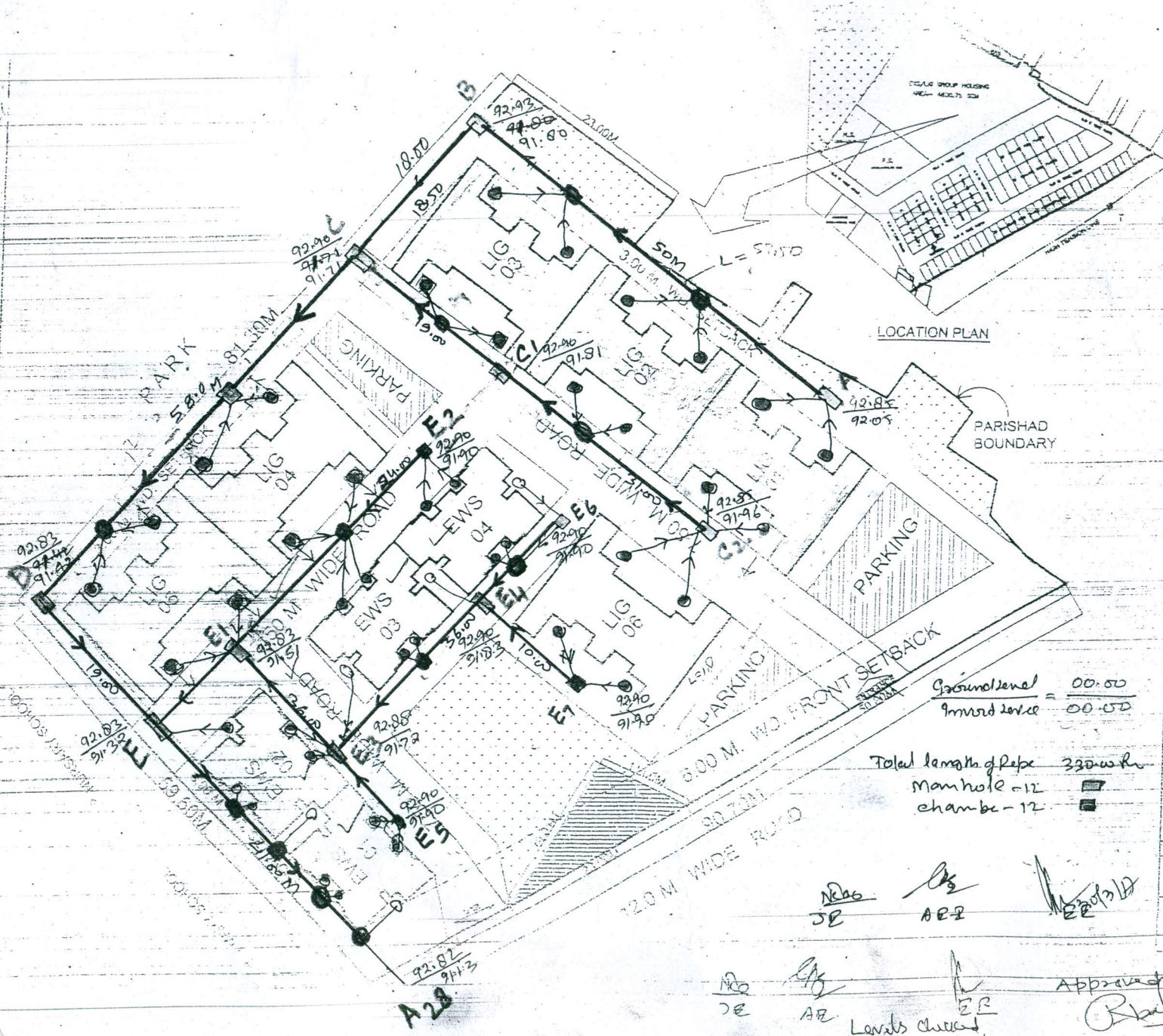

SHEET NO.

THIS LAYOUT PLAN FOR GROUP HOUSING (EWS/LIG TYPE) HAS BEEN PREPARED AS PER RECOMMENDATION RECEIVED BY S.E. (CIRCLE-I) VIDE HIS LETTER NO. 1117 DATED 09.09.2015.

THE FEASIBILITY REPORT SENT TO E.E.O. (31) VIDE LETTER NO. 1114 DATED 09.11.2015.

THIS LAYOUT PLAN HAS BEEN PREPARED AS PER FEASIBILITY RECEIVED BY E.E.O. (31) VIDE HIS LETTER NO. 1117 DATED 07.12.2015.

THE LAYOUT PLAN HAS BEEN FINALIZED ON THE BASIS OF FEASIBILITY RECEIVED BY E.E.O. (31) VIDE HIS LETTER NO. 1133P-32156 DATED 07.12.2015.

PLOT AREA FOR EWS/LIG G.H. PLOT	=	6113.00 SQ.M.
GROUND COVERAGE	=	27.54%
POPULATION	=	0.82
DENSITY ALLOWED @ 1000PPH	=	311 PERSONS
TOTAL UNIT ALLOWED (611/5)	=	122.20 SAY 123

**DETAILS OF PROPOSED PROPERTIES:**

PARTICULAR								
LAND AREA		6113.00 SQ.M.						
RESIDENTIAL								
S.NO.	PARTICULAR	FLOOR	NO. OF FLATS	TOTAL UNITS	UNIT AREA (SQ.M.)	PLACED AREA (SQ.M.)	AREA TOWARDS COVLD (SQ.M.)	GROUND COVERAGE (%)
1.	EWS	4	4	G+2	48	27.54	124.70	498.80
2.	LIG	5	4	G+2	72	43.18	197.50	1185.00
<b>TOTAL</b>		<b>10</b>	<b>8</b>	<b>120</b>			<b>322.20</b>	<b>27.54%</b>
<b>PER. ACHIEVED</b>		<b>0.82%</b>						

**DETAILS OF PARKING:**

S.NO.	PROPERTIES	TOTAL NO. OF UNITS	PARKING REQUIRED	PARKING PROPOSED
1.	EWS	48	23 SQ.M. PER UNIT	
2.	LIG	72	DISCOPPER UNIT	
<b>TOTAL</b>		<b>120</b>	<b>343.50 SQ.M.</b>	<b>353 SQ.M.</b>

PROPOSED LAY-OUT PLAN FOR EWS/LIG (G+2) HOUSES ON GROUP HOUSING PLOT AT LOHRAMAU YOUNA, SULTANPUR

DATE: 14-12-2015

SCALE: 1:200

VINAY KUMAR  
DRAWING CIVIL  
RAJESH KUMAR  
ASSTT ARCH. PLANNER  
HEMANT KUMAR  
ARCHITECT PLANNER

Ground level = 00.00  
Invert level = 00.00

Total length of Pipe = 3300 m  
Man hole = 12  
Chamber = 12

Approved  
S.E. 10/11/17  
Circle-I

Levels checked AS per design client