

LANDSCAPE AND SERVICES LAYOUT PLAN





LEGEND:

-  GREEN AREA
-  WATER TANK
-  ZONED AREA
-  RAIN HARVESTING TANK
-  STP 75 KLD
-  GARBAGE COLLECTION POINT
-  70W 9M.POLE LIGHT (NOS-71)

TREES:

| S.No. | Symbol | Botanical Name | Common Name | Size |
|-------|---|---------------------|-------------|-------------|
| 1. |  | Cassia fistula | | 4m(H)x6m(W) |
| 2. |  | Ficus Benjaminia | Weeping Fig | 4m(H)x4m(W) |
| 3. |  | Alstonia | | 3m(H)x4m(W) |
| 4. |  | Terminalia Maritima | | 3m(H)x3m(W) |
| 5. |  | Sarcoca Indica | | 3m(H)x3m(W) |

LEGENDS

| S. NO. | NAME | SYMBOLS |
|--------|-----------------------|---|
| 1. | ELECTRIC POLE |  |
| 2. | SEWER PIPE |  |
| 3. | RAIN WATER HARVESTING |  |
| 4. | MANHOLE |  |

PROJECT NAME:-
 PROPOSED LAYOUT OF VADIK VIHAR ON
 KHABARI NO:-
 413,414,415,417,418,424,425,427,428,
 645,646,648,649,651,651,652,654,655,
 657 658 659,661,662
 AT-VILL. DAKHENSERIPUR, PARGANA-MISORAN,
 TEHSIL-MOHANLALGANJ, DISTT. LUCKNOW

Land Analysis:-
 Land Area -> 43490 sq. m (10.74 acres) 100%

Area under Plots -> 23850 sqm (54.84%)
 Area Under Park/Green -> 7973 sqm (17.84%)
 Area Under Road Services -> 11967 sqm (27.31%)

| S.No. | PLOT TYPE | Plot Size | Plot No. |
|-------------|-----------|-------------|----------|
| 1. | A | 12.19x24.38 | 24 |
| 2. | B | 10.66x21.33 | 13 |
| 3. | C | 9.14x18.28 | 16 |
| 4. | D | 7.62x12.24 | 65 |
| 5. | E | 6.10x12.16 | 38 |
| 6. | CA | 4.57x9.14 | 40 |
| TOTAL PLOT- | | | 196 |

| S.No. | GREEN AREA | AREA |
|------------|---------------|-----------|
| 1. | GREEN AREA 1 | 498 sqm |
| 2. | GREEN AREA 2 | 40 sqm |
| 3. | GREEN AREA 3 | 945 sqm |
| 4. | GREEN AREA 4 | 325 sqm |
| 5. | GREEN AREA 5 | 50 sqm |
| 6. | GREEN AREA 6 | 50 sqm |
| 7. | GREEN AREA 7 | 70 sqm |
| 8. | GREEN AREA 8 | 55 sqm |
| 9. | GREEN AREA 9 | 85 sqm |
| 10. | GREEN AREA 10 | 355 sqm |
| 11. | GREEN AREA 11 | 330 sqm |
| 12. | GREEN AREA 12 | 1235 sqm |
| 13. | GREEN AREA 13 | 295 sqm |
| 14. | GREEN AREA 14 | 555 sqm |
| 15. | GREEN AREA 15 | 2658 sqm |
| 16. | GREEN AREA 16 | 31.89 sqm |
| 17. | GREEN AREA 17 | 63.84 sqm |
| 18. | GREEN AREA 18 | 76.89 sqm |
| TOTAL AREA | | 7673 sqm |

DEVELOPER NAME :-
 SHINE CITY INFRA PROJECT PVT.LTD.
 SUBMISSION DRAWING

DATE: 15/03/2018

OWNER SIGN
 ARCHITECT

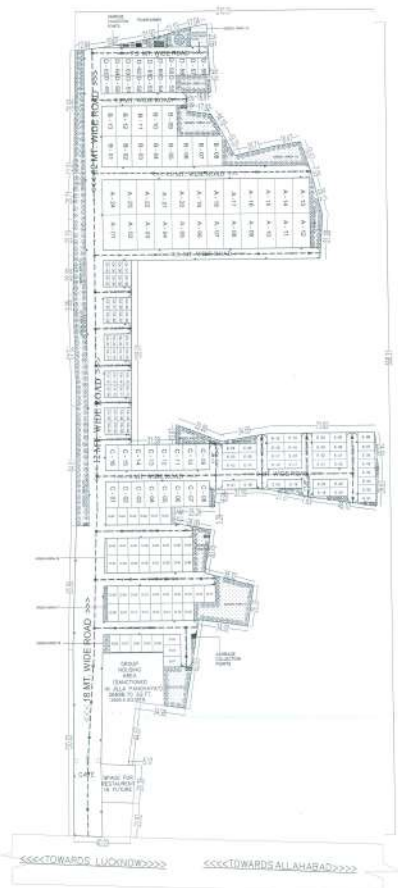

SEWERAGE LAYOUT PLAN

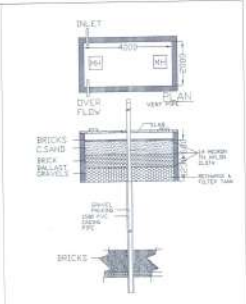

**X-SECTION
DETAIL OF R.W.H.PIT & WELL
(INTS)**

| LEGEND | |
|--------|--|
| | DRAINAGE MANHOLE |
| | DRAINAGE MANHOLE WITH PERFORATED COVER |
| | SEWERAGE MANHOLE |
| | STONEWARE PIPE |
| | MANHOLE |
| | GROUND LEVEL |
| | DRAINAGE BRANCH MANHOLE WITH PERFORATED COVER |
| | R.W.H. (RAIN WATER HARVESTING) (Size = 3 X 3 X 2.30 M.) |
| | INVERT LEVEL |
| | CONNECTION LEVEL |
| | METRE |
| | LENGTH |

PLUMBING NOTES:-
 * ALL BRANCH MANHOLES SHALL BE 900mm SIZE AND 750mm DEEP UNLESS OTHERWISE MENTIONED
 * ALL BRANCH DRAINAGE LINES SHALL BE 100 R.C.C. MP3 CLASS PIPES (SLOPE 1:80)
 * ALL DRAINAGE PIPES UNDER NORMAL CONDITION SHALL BE R.C.C. MP3 CLASS PIPES
 * ALL DRAINAGE PIPES UNDER ROAD CROSSING AREA SHALL BE R.C.C. MP3 CLASS PIPES
 * ALL DRAINAGE PIPES UNDER ROAD CROSSING AREA SHALL BE ALL ROUND CAST CONCRETE (1:3:6)
 * ALL DRAINAGE PIPES UNDER NORMAL CONDITION SHALL BE 1:4 TO 1:4 MANHOLE CEMENT CONCRETE (1:4:8)

MANHOLES DISCRPTION -
 (W) 600MM MANHOLE DEPTH 75 TO 85 CM
 (M) 600MM DIA MANHOLE DEPTH 8 TO 10 CM
 (S) 1200 DIA MANHOLE DEPTH 18 TO 20 CM
 (L) 1500 DIA MANHOLE DEPTH 230mm (800)

| S.NO. | NAME | SYMBOLS |
|-------|--------------------------|---------|
| 1. | ELECTRIC POLE | |
| 2. | RAIN WATER HARVESTING | |
| 3. | MANHOLE | |
| 4. | GREEN AREA | |
| 5. | GARBAGE COLLECTION POINT | |
| 6. | SEWERAGE TREATMENT PLAN | |

PROJECT NAME:-
 PROPOSED LAYOUT OF VAIDIK VHAR ON
 KHARBARA RD:-
 412,414,415,417,418,424,425,427,428,
 645,646,648,649,650,651,652,654,655,
 657 658 659,661,669
 AT VILL -DARHENA SEKTOR, PARGANA-NAGDHAN,
 TEHSIL -MOHANLALGANJ, DISTT. LUCKNOW

Land Analysis:-
 Land Area :- 43460 sq.m (10.74 acres) 100%
 Area under Plots :- 23830 sqm (54.84%)
 Area Under Park/Green :- 7673 sqm (17.64%)
 Area Under Road/Service :- 11967 sqm (27.51%)

| S.No. | PLOT TYPE | Plot Size | Plot No. |
|-------|-----------|-------------|--------------|
| 1. | A | 12.19x24.38 | 24 |
| 2. | B | 18.66x21.23 | 13 |
| 3. | C | 9.15x18.28 | 16 |
| 4. | D | 7.62x12.24 | 65 |
| 5. | E | 6.10x12.16 | 38 |
| 6. | CA | 4.57x9.14 | 40 |
| | | | TOTAL PLOT:- |
| | | | 196 |

| S.No. | GREEN AREA | AREA |
|-------|---------------|------------|
| 1 | GREEN AREA 1 | 400 sqm |
| 2 | GREEN AREA 2 | 40 sqm |
| 3 | GREEN AREA 3 | 945 sqm |
| 4 | GREEN AREA 4 | 325 sqm |
| 5 | GREEN AREA 5 | 30 sqm |
| 6 | GREEN AREA 6 | 50 sqm |
| 7 | GREEN AREA 7 | 70 sqm |
| 8 | GREEN AREA 8 | 55 sqm |
| 9 | GREEN AREA 9 | 85 sqm |
| 10 | GREEN AREA 10 | 335 sqm |
| 11 | GREEN AREA 11 | 330 sqm |
| 12 | GREEN AREA 12 | 1255 sqm |
| 13 | GREEN AREA 13 | 295 sqm |
| 14 | GREEN AREA 14 | 555 sqm |
| 15 | GREEN AREA 15 | 2658 sqm |
| 16 | GREEN AREA 16 | 31.89 sqm |
| 17 | GREEN AREA 17 | 63.84 sqm |
| 18 | GREEN AREA 18 | 78.89 sqm |
| | | TOTAL AREA |
| | | 7673 sqm |

DEVELOPER NAME :-
 SHINE CITY INFRA PROJECT PVT.LTD
 SUBMISSION DRAWING

DATE: 13/03/2018
SHEET NO. (D) (SCALE) 1:100
DATE: 13/03/2018

OWNER SIGN:
 SHINE CITY INFRA PROJECT PVT.LTD

ARCHITECT:
 SHINE CITY INFRA PROJECT PVT.LTD