

**FEASIBILITY REPORT**  
ON  
**SEWAGE TREATMENT PLANT**  
**CAPACITY : 50 KL/DAY**

**PROJECT NAME**

**M/s NARAYAN's VRINDAVAN**

*(K.No. 595, Saidpur Hawkins, Mini Bypass Road, Karamchari Nagar Chauraha,  
Bareilly, Uttar Pradesh, India)*

**OWNER : DHRUV NARAIN MEHRA,**

*(R/O- 55, PULL KAJI, SAHUKARA, SARAFI BAZAR, BAREILLY)*

**M/s VINAYAK ASSOCIATES**

*BAREILLY*

## **PREAMBLE**

**M/s NARAYAN's VRINDAVAN**, K.No. 595, Saidpur Hawkins, Mini Bypass Road, Karamchari Nagar Chauraha, Bareilly, Uttar Pradesh, India have engaged **M/s Vinayak Associates**, Bareilly for initiating a study and preparing a report on the feasibility of installing Sewage Treatment Plant for the treatment of domestic waste water generated from residential apartments.

This report is to be submitted to the Environmental Engineer, Uttar Pradesh Pollution Control Board. Technical Details about the unit contained in the report are as per the information provided by the management of **M/s NARAYAN's VRINDAVAN**, K.No. 595, Saidpur Hawkins, Mini Bypass Road, Karamchari Nagar Chauraha, Bareilly, Uttar Pradesh, India.

## **INTRODUCTION**

**M/s NARAYAN's VRINDAVAN**, K.No. 595, Saidpur Hawkins, Mini Bypass Road, Karamchari Nagar Chauraha, Bareilly, Uttar Pradesh, India is a Group Housing (Apartment Building) and are setting up a new STP Plant for their domestic waste water. Waste involves various operations and washings which will generate effluent.

In the building, waste water is generated from washing of utensils, Preparation of food, cloth washing and toilet waste also. The waste water generated in the process contains Suspended Solids, Dissolved Solids, Oil & Grease, BOD and COD etc. The waste water is proposed to be treated as per the standards of U.P. Pollution Control Board.

Hence, the management plans to install a Sewage Treatment Plant at their unit for treating of kitchen & Domestic waste water as per standards and norms of U.P. Pollution Control Board.

## **ESTIMATION OF WASTE WATER GENERATION**

Capacity of the Sewage Treatment Plant is 50 KLD\*\*

\*\*data as per the management of **M/s NARAYAN's VRINDAVAN**, K.No. 595, Saidpur Hawkins, Mini Bypass Road, Karamchari Nagar Chauraha, Bareilly, Uttar Pradesh, India.

***Therefore, the installed capacity of the plant is 50 KLD.***

## DESIGN BASIS FOR THE TREATMENT PLANT

The Sewage Treatment Plant has been designed to operate for the following parameters of Raw Influent:

<u>PARAMETERS</u>	<u>QUANTITY / CONCENTRATION</u> (in mg/lit, except Inflow & pH)
Inflow	50 KL/day
Type	Sewage
Temp.	30-45 Deg. C
pH	17.7-18.7
Oil & Grease	50-100
BOD	600-750
COD	1200-1500
TSS	500-750
TDS*	1500-2000

## STANDARDS FOR TREATED WATER

Following are the standards considered by Pollution Control Boards for disposal of treated water in municipal sewers or for use in irrigation & plantation on land.

<u>PARAMETERS</u>	<u>QUANTITY / CONCENTRATION</u> (not to exceed; in mg/lit, except pH)
pH	13.5-22.5
Oil & Grease	25
BOD	75
COD	250
TSS	250

The Treated water from the Sewage Treatment Plant will adequately meet the above standards.

TDS levels are outside the purview of the system offered and would remain that as at inlet Standards for TDS are < 2100mg/l.

## **TREATMENT PROCESS**

This Package Type Sewage Treatment Plant has specifically been designed for the purpose of treatment of Waste Water Discharge before its disposal to bring the characteristics of the same up to acceptable norms and standards.

Waste Water stored in an Equalization cum Storage Sump. From here it is lifted with the help of a Raw Sewage Lift Pump to a State of the Art MBBR (Moving Bed Biological Reactor). Here Bacteria Culture develops on Moving Media. These micro-organisms derive their food from the organic impurities in water and air from an Air Blower which diffuses air in Fine Bubble Form at the bottom of the reactor through Membrane Diffusers. This is followed by a polishing EA Reactor (Extended Aeration) where air is provided with the help of Air Blower and diffused through Diffusers to improve upon the results of the MBBR. This reduces the BOD Load of the Discharge significantly.

Water from here is fed to a Highly Efficient Tube Settler where finer suspended impurities as well as dead organic matter from the MBBR is settled and dumped to Sludge Drying Beds. Part of the sludge is re-circulated in the system using a Sludge Recirculation Pump.

Water after Tube Settler is stored in Pre-filtration Sump and is pumped through a Filtration Pump to an Activated Carbon Filter. It removes very fine suspended particles the Discharge Stream, as well as traces of any impurity or any odor or color inherent in the stream. BOD and COD of water is further reduced during Filtration. Chlorination is done before Filtration to dis-infect the water stream.

Treated Water is then fit for disposal into Municipal Sewers or for use in Irrigation & Plantation on Land.

## **POWER LOAD CALCULATIONS**

### **DETAILS OF ELECTRICAL EQUIPMENTS**

<b>RAW SEWAGE LIFT PUMP</b> Quantity Model & Make Motor (Induction) Power Requirments	1. No. (Online) CW-1500, Kirloskar 2.5 HP 2.25 kW
<b>AIR BLOWER</b> Quantity Model & Make Motor (Induction) Power Requirments	1. No. (Online) 3.5 HP 2.75 kW
<b>FILTRATION PUMP</b> Quantity Model & Make Motor (Induction) Power Requirments	1. No. (Online) KDS - 3.75, Kirloskar 2.5 HP 2.25 kW
<b>SLUDGE RECIRCULATION PUMP</b> Quantity Model & Make Motor (Induction) Power Requirments	1. No. (Online) Kirloskar 1.25 HP 1.00 kW
<b>TOTAL POWER REQUIRMENTS</b>	<b>6.0 kW</b>

## ESTIMATED COST OF EQUIPMENTS

<b>S.NO.</b>	<b>PARTICULARS</b>	<b>AMOUNT (in Rs.)</b>
1	Civil Work	Rs. 11,25,000.00
2	Plant & Machinery	Rs. 13,75,000.00
<b>TOTAL</b>		<b>Rs. 25,00,000.00</b>

# FLOW DIAGRAM

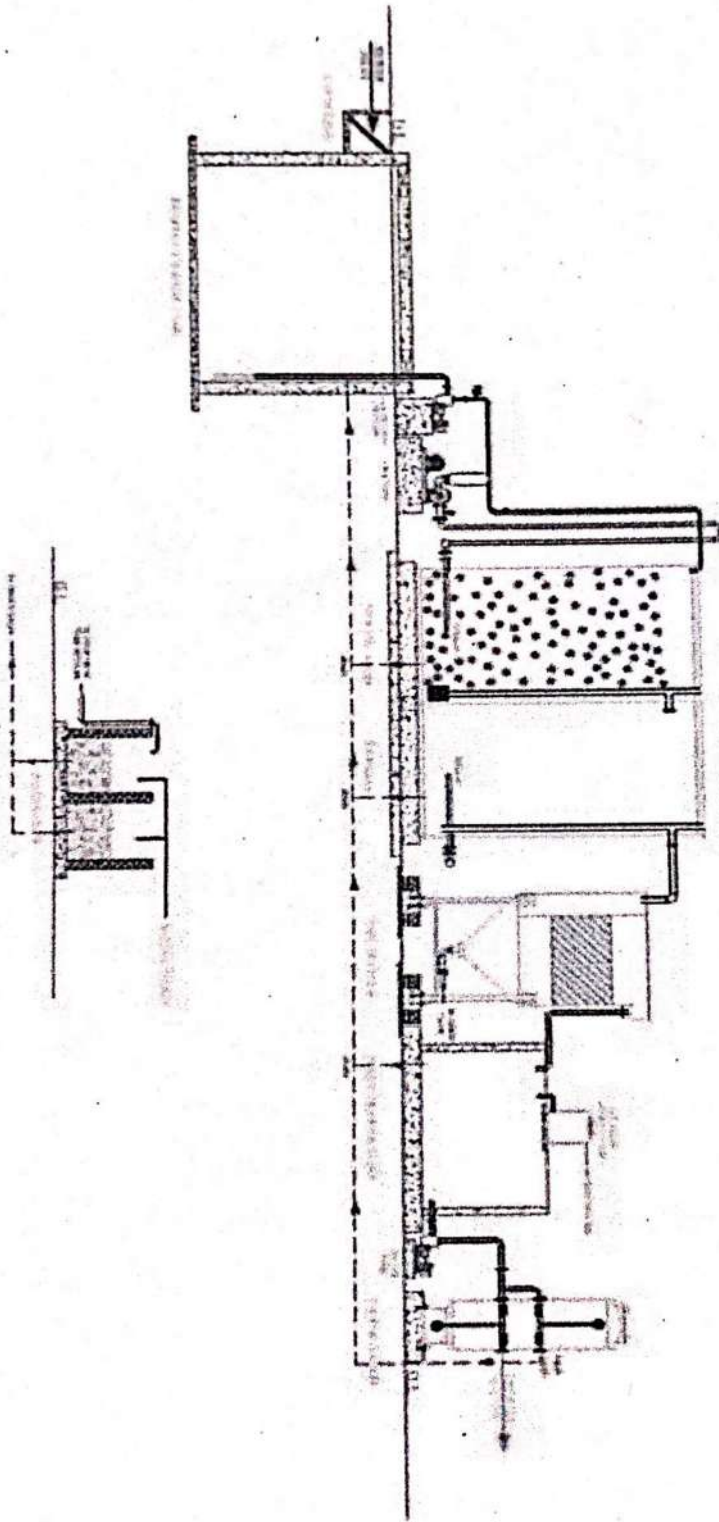

## LAND DEVELOPMENT WORK PLAN- NARAYAN VRINDAVAN

Activity Name	Start Date	End Date	Target Name	Target	Achievement
<b>1- Demarcation of Plots</b>	01-10-22	31-12-27			
<b>1- Demarcation of Plots</b>	01-10-22	31-12-22	01-10-2022 to 31-12-2022 Quarter-1	0	0
<b>1- Demarcation of Plots</b>	01-01-23	31-03-23	01-01-2023 to 31-03-2023 Quarter-2	90	-
<b>1- Demarcation of Plots</b>	01-04-23	30-06-23	01-04-2023 to 30-06-2023 Quarter-3	5	-
<b>1- Demarcation of Plots</b>	01-07-23	30-09-23	01-07-2023 to 30-09-2023 Quarter-4	5	-
<b>1- Demarcation of Plots</b>	01-10-23	31-12-23	01-10-2023 to 31-12-2023 Quarter-5	0	-
<b>1- Demarcation of Plots</b>	01-01-24	31-03-24	01-01-2024 to 31-03-2024 Quarter-6	0	-
<b>1- Demarcation of Plots</b>	01-04-24	30-06-24	01-04-2024 to 30-06-2024 Quarter-7	0	-
<b>1- Demarcation of Plots</b>	01-07-24	30-09-24	01-07-2024 to 30-09-2024 Quarter-8	0	-
<b>1- Demarcation of Plots</b>	01-10-24	31-12-24	01-10-2024 to 31-12-2024 Quarter-9	0	-
<b>1- Demarcation of Plots</b>	01-01-25	31-03-25	01-01-2025 to 31-03-2025 Quarter-10	0	-
<b>1- Demarcation of Plots</b>	01-04-25	30-06-25	01-04-2025 to 30-06-2025 Quarter-11	0	-
<b>1- Demarcation of Plots</b>	01-07-25	30-09-25	01-07-2025 to 30-09-2025 Quarter-12	0	-
<b>1- Demarcation of Plots</b>	01-10-25	31-12-25	01-10-2025 to 31-12-2025 Quarter-13	0	-
<b>1- Demarcation of Plots</b>	01-01-26	31-03-26	01-01-2026 to 31-03-2026 Quarter-14	0	-
<b>1- Demarcation of Plots</b>	01-04-26	30-06-26	01-04-2026 to 30-06-2026 Quarter-15	0	-
<b>1- Demarcation of Plots</b>	01-07-26	30-09-26	01-07-2026 to 30-09-2026 Quarter-16	0	-
<b>1- Demarcation of Plots</b>	01-10-26	31-12-26	01-10-2026 to 31-12-2026 Quarter-17	0	-
<b>1- Demarcation of Plots</b>	01-01-27	31-03-27	01-01-2027 to 31-03-2027 Quarter-18	0	-
<b>1- Demarcation of Plots</b>	01-04-27	30-06-27	01-04-2027 to 30-06-2027 Quarter-19	0	-
<b>1- Demarcation of Plots</b>	01-07-27	30-09-27	01-07-2027 to 30-09-2027 Quarter-20	0	-
<b>1- Demarcation of Plots</b>	01-10-27	31-12-27	01-10-2027 to 31-12-2027 Quarter-21	0	-
<b>2 -Boundary Wall</b>			<b>Target Name</b>	<b>Target</b>	<b>Achievement</b>
	01-10-22	31-12-27			
<b>2 -Boundary Wall</b>	01-10-22	31-12-22	01-10-2022 to 31-12-2022 Quarter-1	0	-
<b>2 -Boundary Wall</b>	01-01-23	31-03-23	01-01-2023 to 31-03-2023 Quarter-2	50	-
<b>2 -Boundary Wall</b>	01-04-23	30-06-23	01-04-2023 to 30-06-2023 Quarter-3	40	-
<b>2 -Boundary Wall</b>	01-07-23	30-09-23	01-07-2023 to 30-09-2023 Quarter-4	5	-
<b>2 -Boundary Wall</b>	01-10-23	31-12-23	01-10-2023 to 31-12-2023 Quarter-5	5	-
<b>2 -Boundary Wall</b>	01-01-24	31-03-24	01-01-2024 to 31-03-2024 Quarter-6	0	-
<b>2 -Boundary Wall</b>	01-04-24	30-06-24	01-04-2024 to 30-06-2024 Quarter-7	0	-
<b>2 -Boundary Wall</b>	01-07-24	30-09-24	01-07-2024 to 30-09-2024 Quarter-8	0	-
<b>2 -Boundary Wall</b>	01-10-24	31-12-24	01-10-2024 to 31-12-2024 Quarter-9	0	-
<b>2 -Boundary Wall</b>	01-01-25	31-03-25	01-01-2025 to 31-03-2025 Quarter-10	0	-
<b>2 -Boundary Wall</b>	01-04-25	30-06-25	01-04-2025 to 30-06-2025 Quarter-11	0	-
<b>2 -Boundary Wall</b>	01-07-25	30-09-25	01-07-2025 to 30-09-2025 Quarter-12	0	-
<b>2 -Boundary Wall</b>	01-10-25	31-12-25	01-10-2025 to 31-12-2025 Quarter-13	0	-
<b>2 -Boundary Wall</b>	01-01-26	31-03-26	01-01-2026 to 31-03-2026 Quarter-14	0	-
<b>2 -Boundary Wall</b>	01-04-26	30-06-26	01-04-2026 to 30-06-2026 Quarter-15	0	-
<b>2 -Boundary Wall</b>	01-07-26	30-09-26	01-07-2026 to 30-09-2026 Quarter-16	0	-
<b>2 -Boundary Wall</b>	01-10-26	31-12-26	01-10-2026 to 31-12-2026 Quarter-17	0	-
<b>2 -Boundary Wall</b>	01-01-27	31-03-27	01-01-2027 to 31-03-2027 Quarter-18	0	-
<b>2 -Boundary Wall</b>	01-04-27	30-06-27	01-04-2027 to 30-06-2027 Quarter-19	0	-
<b>2 -Boundary Wall</b>	01-07-27	30-09-27	01-07-2027 to 30-09-2027 Quarter-20	0	-
<b>2 -Boundary Wall</b>	01-10-27	31-12-27	01-10-2027 to 31-12-2027 Quarter-21	0	-
<b>3- Road Work</b>			<b>Target Name</b>	<b>Target</b>	<b>Achievement</b>
	01-10-22	31-12-27			
<b>3- Road Work</b>	01-10-22	31-12-22	01-10-2022 to 31-12-2022 Quarter-1	0	-
<b>3- Road Work</b>	01-01-23	31-03-23	01-01-2023 to 31-03-2023 Quarter-2	15	-
<b>3- Road Work</b>	01-04-23	30-06-23	01-04-2023 to 30-06-2023 Quarter-3	15	-
<b>3- Road Work</b>	01-07-23	30-09-23	01-07-2023 to 30-09-2023 Quarter-4	15	-

3- Road Work	01-10-23	31-12-23	01-10-2023 to 31-12-2023 Quarter-5	15	-
3- Road Work	01-01-24	31-03-24	01-01-2024 to 31-03-2024 Quarter-6	15	-
3- Road Work	01-04-24	30-06-24	01-04-2024 to 30-06-2024 Quarter-7	11	-
3- Road Work	01-07-24	30-09-24	01-07-2024 to 30-09-2024 Quarter-8	1	-
3- Road Work	01-10-24	31-12-24	01-10-2024 to 31-12-2024 Quarter-9	1	-
3- Road Work	01-01-25	31-03-25	01-01-2025 to 31-03-2025 Quarter-10	1	-
3- Road Work	01-04-25	30-06-25	01-04-2025 to 30-06-2025 Quarter-11	1	-
3- Road Work	01-07-25	30-09-25	01-07-2025 to 30-09-2025 Quarter-12	1	-
3- Road Work	01-10-25	31-12-25	01-10-2025 to 31-12-2025 Quarter-13	1	-
3- Road Work	01-01-26	31-03-26	01-01-2026 to 31-03-2026 Quarter-14	1	-
3- Road Work	01-04-26	30-06-26	01-04-2026 to 30-06-2026 Quarter-15	1	-
3- Road Work	01-07-26	30-09-26	01-07-2026 to 30-09-2026 Quarter-16	1	-
3- Road Work	01-10-26	31-12-26	01-10-2026 to 31-12-2026 Quarter-17	1	-
3- Road Work	01-01-27	31-03-27	01-01-2027 to 31-03-2027 Quarter-18	1	-
3- Road Work	01-04-27	30-06-27	01-04-2027 to 30-06-2027 Quarter-19	1	-
3- Road Work	01-07-27	30-09-27	01-07-2027 to 30-09-2027 Quarter-20	1	-
3- Road Work	01-10-27	31-12-27	01-10-2027 to 31-12-2027 Quarter-21	1	-
4- Footpaths			<b>Target Name</b>	<b>Target</b>	<b>Achievement</b>
	01-10-22	31-12-27			
4- Footpaths	01-10-22	31-12-22	01-10-2022 to 31-12-2022 Quarter-1	0	-
4- Footpaths	01-01-23	31-03-23	01-01-2023 to 31-03-2023 Quarter-2	15	-
4- Footpaths	01-04-23	30-06-23	01-04-2023 to 30-06-2023 Quarter-3	15	-
4- Footpaths	01-07-23	30-09-23	01-07-2023 to 30-09-2023 Quarter-4	15	-
4- Footpaths	01-10-23	31-12-23	01-10-2023 to 31-12-2023 Quarter-5	15	-
4- Footpaths	01-01-24	31-03-24	01-01-2024 to 31-03-2024 Quarter-6	15	-
4- Footpaths	01-04-24	30-06-24	01-04-2024 to 30-06-2024 Quarter-7	11	-
4- Footpaths	01-07-24	30-09-24	01-07-2024 to 30-09-2024 Quarter-8	1	-
4- Footpaths	01-10-24	31-12-24	01-10-2024 to 31-12-2024 Quarter-9	1	-
4- Footpaths	01-01-25	31-03-25	01-01-2025 to 31-03-2025 Quarter-10	1	-
4- Footpaths	01-04-25	30-06-25	01-04-2025 to 30-06-2025 Quarter-11	1	-
4- Footpaths	01-07-25	30-09-25	01-07-2025 to 30-09-2025 Quarter-12	1	-
4- Footpaths	01-10-25	31-12-25	01-10-2025 to 31-12-2025 Quarter-13	1	-
4- Footpaths	01-01-26	31-03-26	01-01-2026 to 31-03-2026 Quarter-14	1	-
4- Footpaths	01-04-26	30-06-26	01-04-2026 to 30-06-2026 Quarter-15	1	-
4- Footpaths	01-07-26	30-09-26	01-07-2026 to 30-09-2026 Quarter-16	1	-
4- Footpaths	01-10-26	31-12-26	01-10-2026 to 31-12-2026 Quarter-17	1	-
4- Footpaths	01-01-27	31-03-27	01-01-2027 to 31-03-2027 Quarter-18	1	-
4- Footpaths	01-04-27	30-06-27	01-04-2027 to 30-06-2027 Quarter-19	1	-
4- Footpaths	01-07-27	30-09-27	01-07-2027 to 30-09-2027 Quarter-20	1	-
4- Footpaths	01-10-27	31-12-27	01-10-2027 to 31-12-2027 Quarter-21	1	-
5- Water Supply Including Drinking Water Facilities			<b>Target Name</b>	<b>Target</b>	<b>Achievement</b>
	01-10-22	31-12-27			
5- Water Supply Including	01-10-22	31-12-22	01-10-2022 to 31-12-2022 Quarter-1	0	-
5- Water Supply Including	01-01-23	31-03-23	01-01-2023 to 31-03-2023 Quarter-2	10	-
5- Water Supply Including	01-04-23	30-06-23	01-04-2023 to 30-06-2023 Quarter-3	10	-
5- Water Supply Including	01-07-23	30-09-23	01-07-2023 to 30-09-2023 Quarter-4	10	-
5- Water Supply Including	01-10-23	31-12-23	01-10-2023 to 31-12-2023 Quarter-5	10	-
5- Water Supply Including	01-01-24	31-03-24	01-01-2024 to 31-03-2024 Quarter-6	10	-
5- Water Supply Including	01-04-24	30-06-24	01-04-2024 to 30-06-2024 Quarter-7	10	-
5- Water Supply Including	01-07-24	30-09-24	01-07-2024 to 30-09-2024 Quarter-8	10	-
5- Water Supply Including	01-10-24	31-12-24	01-10-2024 to 31-12-2024 Quarter-9	10	-
5- Water Supply Including	01-01-25	31-03-25	01-01-2025 to 31-03-2025 Quarter-10	9	-
5- Water Supply Including	01-04-25	30-06-25	01-04-2025 to 30-06-2025 Quarter-11	1	-

5- Water Supply Including	01-07-25	30-09-25	01-07-2025 to 30-09-2025 Quarter-12	1	-
5- Water Supply Including	01-10-25	31-12-25	01-10-2025 to 31-12-2025 Quarter-13	1	-
5- Water Supply Including	01-01-26	31-03-26	01-01-2026 to 31-03-2026 Quarter-14	1	-
5- Water Supply Including	01-04-26	30-06-26	01-04-2026 to 30-06-2026 Quarter-15	1	-
5- Water Supply Including	01-07-26	30-09-26	01-07-2026 to 30-09-2026 Quarter-16	1	-
5- Water Supply Including	01-10-26	31-12-26	01-10-2026 to 31-12-2026 Quarter-17	1	-
5- Water Supply Including	01-01-27	31-03-27	01-01-2027 to 31-03-2027 Quarter-18	1	-
5- Water Supply Including	01-04-27	30-06-27	01-04-2027 to 30-06-2027 Quarter-19	1	-
5- Water Supply Including	01-07-27	30-09-27	01-07-2027 to 30-09-2027 Quarter-20	1	-
5- Water Supply Including	01-10-27	31-12-27	01-10-2027 to 31-12-2027 Quarter-21	1	-
6- Sewer System			<b>Target Name</b>	<b>Target</b>	<b>Achievement</b>
	01-10-22	31-12-27			
6- Sewer System	01-10-22	31-12-22	01-10-2022 to 31-12-2022 Quarter-1	0	-
6- Sewer System	01-01-23	31-03-23	01-01-2023 to 31-03-2023 Quarter-2	10	-
6- Sewer System	01-04-23	30-06-23	01-04-2023 to 30-06-2023 Quarter-3	10	-
6- Sewer System	01-07-23	30-09-23	01-07-2023 to 30-09-2023 Quarter-4	10	-
6- Sewer System	01-10-23	31-12-23	01-10-2023 to 31-12-2023 Quarter-5	10	-
6- Sewer System	01-01-24	31-03-24	01-01-2024 to 31-03-2024 Quarter-6	10	-
6- Sewer System	01-04-24	30-06-24	01-04-2024 to 30-06-2024 Quarter-7	10	-
6- Sewer System	01-07-24	30-09-24	01-07-2024 to 30-09-2024 Quarter-8	10	-
6- Sewer System	01-10-24	31-12-24	01-10-2024 to 31-12-2024 Quarter-9	10	-
6- Sewer System	01-01-25	31-03-25	01-01-2025 to 31-03-2025 Quarter-10	9	-
6- Sewer System	01-04-25	30-06-25	01-04-2025 to 30-06-2025 Quarter-11	1	-
6- Sewer System	01-07-25	30-09-25	01-07-2025 to 30-09-2025 Quarter-12	1	-
6- Sewer System	01-10-25	31-12-25	01-10-2025 to 31-12-2025 Quarter-13	1	-
6- Sewer System	01-01-26	31-03-26	01-01-2026 to 31-03-2026 Quarter-14	1	-
6- Sewer System	01-04-26	30-06-26	01-04-2026 to 30-06-2026 Quarter-15	1	-
6- Sewer System	01-07-26	30-09-26	01-07-2026 to 30-09-2026 Quarter-16	1	-
6- Sewer System	01-10-26	31-12-26	01-10-2026 to 31-12-2026 Quarter-17	1	-
6- Sewer System	01-01-27	31-03-27	01-01-2027 to 31-03-2027 Quarter-18	1	-
6- Sewer System	01-04-27	30-06-27	01-04-2027 to 30-06-2027 Quarter-19	1	-
6- Sewer System	01-07-27	30-09-27	01-07-2027 to 30-09-2027 Quarter-20	1	-
6- Sewer System	01-10-27	31-12-27	01-10-2027 to 31-12-2027 Quarter-21	1	-
7- Drain			<b>Target Name</b>	<b>Target</b>	<b>Achievement</b>
	01-10-22	31-12-27			
7- Drain	01-10-22	31-12-22	01-10-2022 to 31-12-2022 Quarter-1	0	-
7- Drain	01-01-23	31-03-23	01-01-2023 to 31-03-2023 Quarter-2	10	-
7- Drain	01-04-23	30-06-23	01-04-2023 to 30-06-2023 Quarter-3	10	-
7- Drain	01-07-23	30-09-23	01-07-2023 to 30-09-2023 Quarter-4	10	-
7- Drain	01-10-23	31-12-23	01-10-2023 to 31-12-2023 Quarter-5	10	-
7- Drain	01-01-24	31-03-24	01-01-2024 to 31-03-2024 Quarter-6	10	-
7- Drain	01-04-24	30-06-24	01-04-2024 to 30-06-2024 Quarter-7	10	-
7- Drain	01-07-24	30-09-24	01-07-2024 to 30-09-2024 Quarter-8	10	-
7- Drain	01-10-24	31-12-24	01-10-2024 to 31-12-2024 Quarter-9	10	-
7- Drain	01-01-25	31-03-25	01-01-2025 to 31-03-2025 Quarter-10	9	-
7- Drain	01-04-25	30-06-25	01-04-2025 to 30-06-2025 Quarter-11	1	-
7- Drain	01-07-25	30-09-25	01-07-2025 to 30-09-2025 Quarter-12	1	-
7- Drain	01-10-25	31-12-25	01-10-2025 to 31-12-2025 Quarter-13	1	-
7- Drain	01-01-26	31-03-26	01-01-2026 to 31-03-2026 Quarter-14	1	-
7- Drain	01-04-26	30-06-26	01-04-2026 to 30-06-2026 Quarter-15	1	-
7- Drain	01-07-26	30-09-26	01-07-2026 to 30-09-2026 Quarter-16	1	-
7- Drain	01-10-26	31-12-26	01-10-2026 to 31-12-2026 Quarter-17	1	-
7- Drain	01-01-27	31-03-27	01-01-2027 to 31-03-2027 Quarter-18	1	-
7- Drain	01-04-27	30-06-27	01-04-2027 to 30-06-2027 Quarter-19	1	-

7- Drain	01-07-27	30-09-27	01-07-2027 to 30-09-2027 Quarter-20	1	-
7- Drain	01-10-27	31-12-27	01-10-2027 to 31-12-2027 Quarter-21	1	-
8- Parks			<b>Target Name</b>	<b>Target</b>	<b>Achievement</b>
	01-10-22	31-12-27			
8- Parks	01-10-22	31-12-22	01-10-2022 to 31-12-2022 Quarter-1	0	-
8- Parks	01-01-23	31-03-23	01-01-2023 to 31-03-2023 Quarter-2	10	-
8- Parks	01-04-23	30-06-23	01-04-2023 to 30-06-2023 Quarter-3	10	-
8- Parks	01-07-23	30-09-23	01-07-2023 to 30-09-2023 Quarter-4	10	-
8- Parks	01-10-23	31-12-23	01-10-2023 to 31-12-2023 Quarter-5	10	-
8- Parks	01-01-24	31-03-24	01-01-2024 to 31-03-2024 Quarter-6	10	-
8- Parks	01-04-24	30-06-24	01-04-2024 to 30-06-2024 Quarter-7	10	-
8- Parks	01-07-24	30-09-24	01-07-2024 to 30-09-2024 Quarter-8	10	-
8- Parks	01-10-24	31-12-24	01-10-2024 to 31-12-2024 Quarter-9	3	-
8- Parks	01-01-25	31-03-25	01-01-2025 to 31-03-2025 Quarter-10	3	-
8- Parks	01-04-25	30-06-25	01-04-2025 to 30-06-2025 Quarter-11	3	-
8- Parks	01-07-25	30-09-25	01-07-2025 to 30-09-2025 Quarter-12	3	-
8- Parks	01-10-25	31-12-25	01-10-2025 to 31-12-2025 Quarter-13	2	-
8- Parks	01-01-26	31-03-26	01-01-2026 to 31-03-2026 Quarter-14	2	-
8- Parks	01-04-26	30-06-26	01-04-2026 to 30-06-2026 Quarter-15	2	-
8- Parks	01-07-26	30-09-26	01-07-2026 to 30-09-2026 Quarter-16	2	-
8- Parks	01-10-26	31-12-26	01-10-2026 to 31-12-2026 Quarter-17	2	-
8- Parks	01-01-27	31-03-27	01-01-2027 to 31-03-2027 Quarter-18	2	-
8- Parks	01-04-27	30-06-27	01-04-2027 to 30-06-2027 Quarter-19	2	-
8- Parks	01-07-27	30-09-27	01-07-2027 to 30-09-2027 Quarter-20	2	-
8- Parks	01-10-27	31-12-27	01-10-2027 to 31-12-2027 Quarter-21	2	-
9- Tree Planting			<b>Target Name</b>	<b>Target</b>	<b>Achievement</b>
	01-10-22	31-12-27			
9- Tree Planting	01-10-22	31-12-22	01-10-2022 to 31-12-2022 Quarter-1	0	-
9- Tree Planting	01-01-23	31-03-23	01-01-2023 to 31-03-2023 Quarter-2	10	-
9- Tree Planting	01-04-23	30-06-23	01-04-2023 to 30-06-2023 Quarter-3	10	-
9- Tree Planting	01-07-23	30-09-23	01-07-2023 to 30-09-2023 Quarter-4	10	-
9- Tree Planting	01-10-23	31-12-23	01-10-2023 to 31-12-2023 Quarter-5	10	-
9- Tree Planting	01-01-24	31-03-24	01-01-2024 to 31-03-2024 Quarter-6	10	-
9- Tree Planting	01-04-24	30-06-24	01-04-2024 to 30-06-2024 Quarter-7	10	-
9- Tree Planting	01-07-24	30-09-24	01-07-2024 to 30-09-2024 Quarter-8	10	-
9- Tree Planting	01-10-24	31-12-24	01-10-2024 to 31-12-2024 Quarter-9	3	-
9- Tree Planting	01-01-25	31-03-25	01-01-2025 to 31-03-2025 Quarter-10	3	-
9- Tree Planting	01-04-25	30-06-25	01-04-2025 to 30-06-2025 Quarter-11	3	-
9- Tree Planting	01-07-25	30-09-25	01-07-2025 to 30-09-2025 Quarter-12	3	-
9- Tree Planting	01-10-25	31-12-25	01-10-2025 to 31-12-2025 Quarter-13	2	-
9- Tree Planting	01-01-26	31-03-26	01-01-2026 to 31-03-2026 Quarter-14	2	-
9- Tree Planting	01-04-26	30-06-26	01-04-2026 to 30-06-2026 Quarter-15	2	-
9- Tree Planting	01-07-26	30-09-26	01-07-2026 to 30-09-2026 Quarter-16	2	-
9- Tree Planting	01-10-26	31-12-26	01-10-2026 to 31-12-2026 Quarter-17	2	-
9- Tree Planting	01-01-27	31-03-27	01-01-2027 to 31-03-2027 Quarter-18	2	-
9- Tree Planting	01-04-27	30-06-27	01-04-2027 to 30-06-2027 Quarter-19	2	-
9- Tree Planting	01-07-27	30-09-27	01-07-2027 to 30-09-2027 Quarter-20	2	-
9- Tree Planting	01-10-27	31-12-27	01-10-2027 to 31-12-2027 Quarter-21	2	-
10- Design For Electric Supply Including Street Lighting			<b>Target Name</b>	<b>Target</b>	<b>Achievement</b>
	01-10-22	31-12-27			
10- Design For Electric	01-10-22	31-12-22	01-10-2022 to 31-12-2022 Quarter-1	0	-
10- Design For Electric	01-01-23	31-03-23	01-01-2023 to 31-03-2023 Quarter-2	10	-
10- Design For Electric	01-04-23	30-06-23	01-04-2023 to 30-06-2023 Quarter-3	10	-

10- Design For Electric	01-07-23	30-09-23	01-07-2023 to 30-09-2023 Quarter-4	10	-
10- Design For Electric	01-10-23	31-12-23	01-10-2023 to 31-12-2023 Quarter-5	10	-
10- Design For Electric	01-01-24	31-03-24	01-01-2024 to 31-03-2024 Quarter-6	10	-
10- Design For Electric	01-04-24	30-06-24	01-04-2024 to 30-06-2024 Quarter-7	10	-
10- Design For Electric	01-07-24	30-09-24	01-07-2024 to 30-09-2024 Quarter-8	10	-
10- Design For Electric	01-10-24	31-12-24	01-10-2024 to 31-12-2024 Quarter-9	3	-
10- Design For Electric	01-01-25	31-03-25	01-01-2025 to 31-03-2025 Quarter-10	3	-
10- Design For Electric	01-04-25	30-06-25	01-04-2025 to 30-06-2025 Quarter-11	3	-
10- Design For Electric	01-07-25	30-09-25	01-07-2025 to 30-09-2025 Quarter-12	3	-
10- Design For Electric	01-10-25	31-12-25	01-10-2025 to 31-12-2025 Quarter-13	2	-
10- Design For Electric	01-01-26	31-03-26	01-01-2026 to 31-03-2026 Quarter-14	2	-
10- Design For Electric	01-04-26	30-06-26	01-04-2026 to 30-06-2026 Quarter-15	2	-
10- Design For Electric	01-07-26	30-09-26	01-07-2026 to 30-09-2026 Quarter-16	2	-
10- Design For Electric	01-10-26	31-12-26	01-10-2026 to 31-12-2026 Quarter-17	2	-
10- Design For Electric	01-01-27	31-03-27	01-01-2027 to 31-03-2027 Quarter-18	2	-
10- Design For Electric	01-04-27	30-06-27	01-04-2027 to 30-06-2027 Quarter-19	2	-
10- Design For Electric	01-07-27	30-09-27	01-07-2027 to 30-09-2027 Quarter-20	2	-
10- Design For Electric	01-10-27	31-12-27	01-10-2027 to 31-12-2027 Quarter-21	2	-
<b>11- Treatment and Disposal System of Sewage and Sullage water</b>			<b>Target Name</b>	<b>Target</b>	<b>Achievement</b>
	01-10-22	31-12-27			
11- Treatment and Disposal	01-10-22	31-12-22	01-10-2022 to 31-12-2022 Quarter-1	0	0
11- Treatment and Disposal	01-01-23	31-03-23	01-01-2023 to 31-03-2023 Quarter-2	2	
11- Treatment and Disposal	01-04-23	30-06-23	01-04-2023 to 30-06-2023 Quarter-3	2	
11- Treatment and Disposal	01-07-23	30-09-23	01-07-2023 to 30-09-2023 Quarter-4	2	
11- Treatment and Disposal	01-10-23	31-12-23	01-10-2023 to 31-12-2023 Quarter-5	2	-
11- Treatment and Disposal	01-01-24	31-03-24	01-01-2024 to 31-03-2024 Quarter-6	5	-
11- Treatment and Disposal	01-04-24	30-06-24	01-04-2024 to 30-06-2024 Quarter-7	10	-
11- Treatment and Disposal	01-07-24	30-09-24	01-07-2024 to 30-09-2024 Quarter-8	10	-
11- Treatment and Disposal	01-10-24	31-12-24	01-10-2024 to 31-12-2024 Quarter-9	10	-
11- Treatment and Disposal	01-01-25	31-03-25	01-01-2025 to 31-03-2025 Quarter-10	10	-
11- Treatment and Disposal	01-04-25	30-06-25	01-04-2025 to 30-06-2025 Quarter-11	20	-
11- Treatment and Disposal	01-07-25	30-09-25	01-07-2025 to 30-09-2025 Quarter-12	18	-
11- Treatment and Disposal	01-10-25	31-12-25	01-10-2025 to 31-12-2025 Quarter-13	1	-
11- Treatment and Disposal	01-01-26	31-03-26	01-01-2026 to 31-03-2026 Quarter-14	1	-
11- Treatment and Disposal	01-04-26	30-06-26	01-04-2026 to 30-06-2026 Quarter-15	1	-
11- Treatment and Disposal	01-07-26	30-09-26	01-07-2026 to 30-09-2026 Quarter-16	1	-
11- Treatment and Disposal	01-10-26	31-12-26	01-10-2026 to 31-12-2026 Quarter-17	1	-
11- Treatment and Disposal	01-01-27	31-03-27	01-01-2027 to 31-03-2027 Quarter-18	1	-
11- Treatment and Disposal	01-04-27	30-06-27	01-04-2027 to 30-06-2027 Quarter-19	1	-
11- Treatment and Disposal	01-07-27	30-09-27	01-07-2027 to 30-09-2027 Quarter-20	1	-
11- Treatment and Disposal	01-10-27	31-12-27	01-10-2027 to 31-12-2027 Quarter-21	1	-
<b>12- Solid Waste Management And Disposal System</b>			<b>Target Name</b>	<b>Target</b>	<b>Achievement</b>
	01-10-22	31-12-27			
12- Solid Waste	01-10-22	31-12-22	01-10-2022 to 31-12-2022 Quarter-1	0	0
12- Solid Waste	01-01-23	31-03-23	01-01-2023 to 31-03-2023 Quarter-2	10	
12- Solid Waste	01-04-23	30-06-23	01-04-2023 to 30-06-2023 Quarter-3	10	-
12- Solid Waste	01-07-23	30-09-23	01-07-2023 to 30-09-2023 Quarter-4	10	-
12- Solid Waste	01-10-23	31-12-23	01-10-2023 to 31-12-2023 Quarter-5	10	-
12- Solid Waste	01-01-24	31-03-24	01-01-2024 to 31-03-2024 Quarter-6	10	-
12- Solid Waste	01-04-24	30-06-24	01-04-2024 to 30-06-2024 Quarter-7	10	-
12- Solid Waste	01-07-24	30-09-24	01-07-2024 to 30-09-2024 Quarter-8	10	-

12- Solid Waste	01-10-24	31-12-24	01-10-2024 to 31-12-2024 Quarter-9	3	-
12- Solid Waste	01-01-25	31-03-25	01-01-2025 to 31-03-2025 Quarter-10	3	-
12- Solid Waste	01-04-25	30-06-25	01-04-2025 to 30-06-2025 Quarter-11	3	-
12- Solid Waste	01-07-25	30-09-25	01-07-2025 to 30-09-2025 Quarter-12	3	-
12- Solid Waste	01-10-25	31-12-25	01-10-2025 to 31-12-2025 Quarter-13	2	-
12- Solid Waste	01-01-26	31-03-26	01-01-2026 to 31-03-2026 Quarter-14	2	-
12- Solid Waste	01-04-26	30-06-26	01-04-2026 to 30-06-2026 Quarter-15	2	-
12- Solid Waste	01-07-26	30-09-26	01-07-2026 to 30-09-2026 Quarter-16	2	-
12- Solid Waste	01-10-26	31-12-26	01-10-2026 to 31-12-2026 Quarter-17	2	-
12- Solid Waste	01-01-27	31-03-27	01-01-2027 to 31-03-2027 Quarter-18	2	-
12- Solid Waste	01-04-27	30-06-27	01-04-2027 to 30-06-2027 Quarter-19	2	-
12- Solid Waste	01-07-27	30-09-27	01-07-2027 to 30-09-2027 Quarter-20	2	-
12- Solid Waste	01-10-27	31-12-27	01-10-2027 to 31-12-2027 Quarter-21	2	-
<b>13- Water Conservation System</b>	01-10-22	31-12-27	<b>Target Name</b>	<b>Target</b>	<b>Achievement</b>
13- Water Conservation	01-10-22	31-12-22	01-10-2022 to 31-12-2022 Quarter-1	0	-
13- Water Conservation	01-01-23	31-03-23	01-01-2023 to 31-03-2023 Quarter-2	10	-
13- Water Conservation	01-04-23	30-06-23	01-04-2023 to 30-06-2023 Quarter-3	10	-
13- Water Conservation	01-07-23	30-09-23	01-07-2023 to 30-09-2023 Quarter-4	10	-
13- Water Conservation	01-10-23	31-12-23	01-10-2023 to 31-12-2023 Quarter-5	10	-
13- Water Conservation	01-01-24	31-03-24	01-01-2024 to 31-03-2024 Quarter-6	10	-
13- Water Conservation	01-04-24	30-06-24	01-04-2024 to 30-06-2024 Quarter-7	10	-
13- Water Conservation	01-07-24	30-09-24	01-07-2024 to 30-09-2024 Quarter-8	10	-
13- Water Conservation	01-10-24	31-12-24	01-10-2024 to 31-12-2024 Quarter-9	3	-
13- Water Conservation	01-01-25	31-03-25	01-01-2025 to 31-03-2025 Quarter-10	3	-
13- Water Conservation	01-04-25	30-06-25	01-04-2025 to 30-06-2025 Quarter-11	3	-
13- Water Conservation	01-07-25	30-09-25	01-07-2025 to 30-09-2025 Quarter-12	3	-
13- Water Conservation	01-10-25	31-12-25	01-10-2025 to 31-12-2025 Quarter-13	2	-
13- Water Conservation	01-01-26	31-03-26	01-01-2026 to 31-03-2026 Quarter-14	2	-
13- Water Conservation	01-04-26	30-06-26	01-04-2026 to 30-06-2026 Quarter-15	2	-
13- Water Conservation	01-07-26	30-09-26	01-07-2026 to 30-09-2026 Quarter-16	2	-
13- Water Conservation	01-10-26	31-12-26	01-10-2026 to 31-12-2026 Quarter-17	2	-
13- Water Conservation	01-01-27	31-03-27	01-01-2027 to 31-03-2027 Quarter-18	2	-
13- Water Conservation	01-04-27	30-06-27	01-04-2027 to 30-06-2027 Quarter-19	2	-
13- Water Conservation	01-07-27	30-09-27	01-07-2027 to 30-09-2027 Quarter-20	2	-
13- Water Conservation	01-10-27	31-12-27	01-10-2027 to 31-12-2027 Quarter-21	2	-
<b>14- Energy Management System Including Use of Renewable Energy</b>	01-10-22	31-12-27	<b>Target Name</b>	<b>Target</b>	<b>Achievement</b>
14- Energy Management	01-10-22	31-12-22	01-10-2022 to 31-12-2022 Quarter-1	0	-
14- Energy Management	01-01-23	31-03-23	01-01-2023 to 31-03-2023 Quarter-2	2	-
14- Energy Management	01-04-23	30-06-23	01-04-2023 to 30-06-2023 Quarter-3	2	-
14- Energy Management	01-07-23	30-09-23	01-07-2023 to 30-09-2023 Quarter-4	2	-
14- Energy Management	01-10-23	31-12-23	01-10-2023 to 31-12-2023 Quarter-5	2	-
14- Energy Management	01-01-24	31-03-24	01-01-2024 to 31-03-2024 Quarter-6	2	-
14- Energy Management	01-04-24	30-06-24	01-04-2024 to 30-06-2024 Quarter-7	2	-
14- Energy Management	01-07-24	30-09-24	01-07-2024 to 30-09-2024 Quarter-8	2	-
14- Energy Management	01-10-24	31-12-24	01-10-2024 to 31-12-2024 Quarter-9	2	-
14- Energy Management	01-01-25	31-03-25	01-01-2025 to 31-03-2025 Quarter-10	2	-
14- Energy Management	01-04-25	30-06-25	01-04-2025 to 30-06-2025 Quarter-11	2	-
14- Energy Management	01-07-25	30-09-25	01-07-2025 to 30-09-2025 Quarter-12	2	-
14- Energy Management	01-10-25	31-12-25	01-10-2025 to 31-12-2025 Quarter-13	2	-
14- Energy Management	01-01-26	31-03-26	01-01-2026 to 31-03-2026 Quarter-14	2	-
14- Energy Management	01-04-26	30-06-26	01-04-2026 to 30-06-2026 Quarter-15	2	-

14- Energy Management	01-07-26	30-09-26	01-07-2026 to 30-09-2026 Quarter-16	2	-
14- Energy Management	01-10-26	31-12-26	01-10-2026 to 31-12-2026 Quarter-17	14	-
14- Energy Management	01-01-27	31-03-27	01-01-2027 to 31-03-2027 Quarter-18	14	-
14- Energy Management	01-04-27	30-06-27	01-04-2027 to 30-06-2027 Quarter-19	14	-
14- Energy Management	01-07-27	30-09-27	01-07-2027 to 30-09-2027 Quarter-20	14	-
14- Energy Management	01-10-27	31-12-27	01-10-2027 to 31-12-2027 Quarter-21	14	-
15- Fire Protection And Fire Safety System*	01-10-22	31-12-27	<b>Target Name</b>	<b>Target</b>	<b>Achievement</b>
15- Fire Protection And	01-10-22	31-12-22	01-10-2022 to 31-12-2022 Quarter-1	0	-
15- Fire Protection And	01-01-23	31-03-23	01-01-2023 to 31-03-2023 Quarter-2	10	-
15- Fire Protection And	01-04-23	30-06-23	01-04-2023 to 30-06-2023 Quarter-3	10	-
15- Fire Protection And	01-07-23	30-09-23	01-07-2023 to 30-09-2023 Quarter-4	10	-
15- Fire Protection And	01-10-23	31-12-23	01-10-2023 to 31-12-2023 Quarter-5	10	-
15- Fire Protection And	01-01-24	31-03-24	01-01-2024 to 31-03-2024 Quarter-6	10	-
15- Fire Protection And	01-04-24	30-06-24	01-04-2024 to 30-06-2024 Quarter-7	10	-
15- Fire Protection And	01-07-24	30-09-24	01-07-2024 to 30-09-2024 Quarter-8	10	-
15- Fire Protection And	01-10-24	31-12-24	01-10-2024 to 31-12-2024 Quarter-9	3	-
15- Fire Protection And	01-01-25	31-03-25	01-01-2025 to 31-03-2025 Quarter-10	3	-
15- Fire Protection And	01-04-25	30-06-25	01-04-2025 to 30-06-2025 Quarter-11	3	-
15- Fire Protection And	01-07-25	30-09-25	01-07-2025 to 30-09-2025 Quarter-12	3	-
15- Fire Protection And	01-10-25	31-12-25	01-10-2025 to 31-12-2025 Quarter-13	2	-
15- Fire Protection And	01-01-26	31-03-26	01-01-2026 to 31-03-2026 Quarter-14	2	-
15- Fire Protection And	01-04-26	30-06-26	01-04-2026 to 30-06-2026 Quarter-15	2	-
15- Fire Protection And	01-07-26	30-09-26	01-07-2026 to 30-09-2026 Quarter-16	2	-
15- Fire Protection And	01-10-26	31-12-26	01-10-2026 to 31-12-2026 Quarter-17	2	-
15- Fire Protection And	01-01-27	31-03-27	01-01-2027 to 31-03-2027 Quarter-18	2	-
15- Fire Protection And	01-04-27	30-06-27	01-04-2027 to 30-06-2027 Quarter-19	2	-
15- Fire Protection And	01-07-27	30-09-27	01-07-2027 to 30-09-2027 Quarter-20	2	-
15- Fire Protection And	01-10-27	31-12-27	01-10-2027 to 31-12-2027 Quarter-21	2	-
16- Emergency Evacuation Services*	01-10-22	31-12-27	<b>Target Name</b>	<b>Target</b>	<b>Achievement</b>
16- Emergency Evacuation Services*	01-10-22	31-12-22	01-10-2022 to 31-12-2022 Quarter-1	0	-
16- Emergency Evacuation Services*	01-01-23	31-03-23	01-01-2023 to 31-03-2023 Quarter-2	10	-
16- Emergency Evacuation Services*	01-04-23	30-06-23	01-04-2023 to 30-06-2023 Quarter-3	10	-
16- Emergency Evacuation Services*	01-07-23	30-09-23	01-07-2023 to 30-09-2023 Quarter-4	10	-
16- Emergency Evacuation Services*	01-10-23	31-12-23	01-10-2023 to 31-12-2023 Quarter-5	10	-
16- Emergency Evacuation Services*	01-01-24	31-03-24	01-01-2024 to 31-03-2024 Quarter-6	10	-
16- Emergency Evacuation Services*	01-04-24	30-06-24	01-04-2024 to 30-06-2024 Quarter-7	10	-
16- Emergency Evacuation Services*	01-07-24	30-09-24	01-07-2024 to 30-09-2024 Quarter-8	10	-
16- Emergency Evacuation Services*	01-10-24	31-12-24	01-10-2024 to 31-12-2024 Quarter-9	3	-
16- Emergency Evacuation Services*	01-01-25	31-03-25	01-01-2025 to 31-03-2025 Quarter-10	3	-
16- Emergency Evacuation Services*	01-04-25	30-06-25	01-04-2025 to 30-06-2025 Quarter-11	3	-
16- Emergency Evacuation Services*	01-07-25	30-09-25	01-07-2025 to 30-09-2025 Quarter-12	3	-

16- Emergency Evacuation Services*	01-10-25	31-12-25	01-10-2025 to 31-12-2025 Quarter-13	2	-
16- Emergency Evacuation Services*	01-01-26	31-03-26	01-01-2026 to 31-03-2026 Quarter-14	2	-
16- Emergency Evacuation Services*	01-04-26	30-06-26	01-04-2026 to 30-06-2026 Quarter-15	2	-
16- Emergency Evacuation Services*	01-07-26	30-09-26	01-07-2026 to 30-09-2026 Quarter-16	2	-
16- Emergency Evacuation Services*	01-10-26	31-12-26	01-10-2026 to 31-12-2026 Quarter-17	2	-
16- Emergency Evacuation Services*	01-01-27	31-03-27	01-01-2027 to 31-03-2027 Quarter-18	2	-
16- Emergency Evacuation Services*	01-04-27	30-06-27	01-04-2027 to 30-06-2027 Quarter-19	2	-
16- Emergency Evacuation Services*	01-07-27	30-09-27	01-07-2027 to 30-09-2027 Quarter-20	2	-
16- Emergency Evacuation Services*	01-10-27	31-12-27	01-10-2027 to 31-12-2027 Quarter-21	2	-
17- Other Miscellaneous Work*	01-10-22	31-12-27	<b>Target Name</b>	<b>Target</b>	<b>Achievement</b>
17- Other Miscellaneous Work*	01-10-22	31-12-22	01-10-2022 to 31-12-2022 Quarter-1	0	-
17- Other Miscellaneous Work*	01-01-23	31-03-23	01-01-2023 to 31-03-2023 Quarter-2	5	-
17- Other Miscellaneous Work*	01-04-23	30-06-23	01-04-2023 to 30-06-2023 Quarter-3	5	-
17- Other Miscellaneous Work*	01-07-23	30-09-23	01-07-2023 to 30-09-2023 Quarter-4	5	-
17- Other Miscellaneous Work*	01-10-23	31-12-23	01-10-2023 to 31-12-2023 Quarter-5	5	-
17- Other Miscellaneous Work*	01-01-24	31-03-24	01-01-2024 to 31-03-2024 Quarter-6	5	-
17- Other Miscellaneous Work*	01-04-24	30-06-24	01-04-2024 to 30-06-2024 Quarter-7	5	-
17- Other Miscellaneous Work*	01-07-24	30-09-24	01-07-2024 to 30-09-2024 Quarter-8	5	-
17- Other Miscellaneous Work*	01-10-24	31-12-24	01-10-2024 to 31-12-2024 Quarter-9	5	-
17- Other Miscellaneous Work*	01-01-25	31-03-25	01-01-2025 to 31-03-2025 Quarter-10	5	-
17- Other Miscellaneous Work*	01-04-25	30-06-25	01-04-2025 to 30-06-2025 Quarter-11	5	-
17- Other Miscellaneous Work*	01-07-25	30-09-25	01-07-2025 to 30-09-2025 Quarter-12	5	-
17- Other Miscellaneous Work*	01-10-25	31-12-25	01-10-2025 to 31-12-2025 Quarter-13	5	-
17- Other Miscellaneous Work*	01-01-26	31-03-26	01-01-2026 to 31-03-2026 Quarter-14	5	-
17- Other Miscellaneous Work*	01-04-26	30-06-26	01-04-2026 to 30-06-2026 Quarter-15	5	-
17- Other Miscellaneous Work*	01-07-26	30-09-26	01-07-2026 to 30-09-2026 Quarter-16	5	-
17- Other Miscellaneous Work*	01-10-26	31-12-26	01-10-2026 to 31-12-2026 Quarter-17	5	-
17- Other Miscellaneous Work*	01-01-27	31-03-27	01-01-2027 to 31-03-2027 Quarter-18	5	-

<b>17- Other Miscellaneous Work*</b>	01-04-27	30-06-27	01-04-2027 to 30-06-2027 Quarter-19	5	-
<b>17- Other Miscellaneous Work*</b>	01-07-27	30-09-27	01-07-2027 to 30-09-2027 Quarter-20	5	-
<b>17- Other Miscellaneous Work*</b>	01-10-27	31-12-27	01-10-2027 to 31-12-2027 Quarter-21	5	-