

Waste Disposal Plan

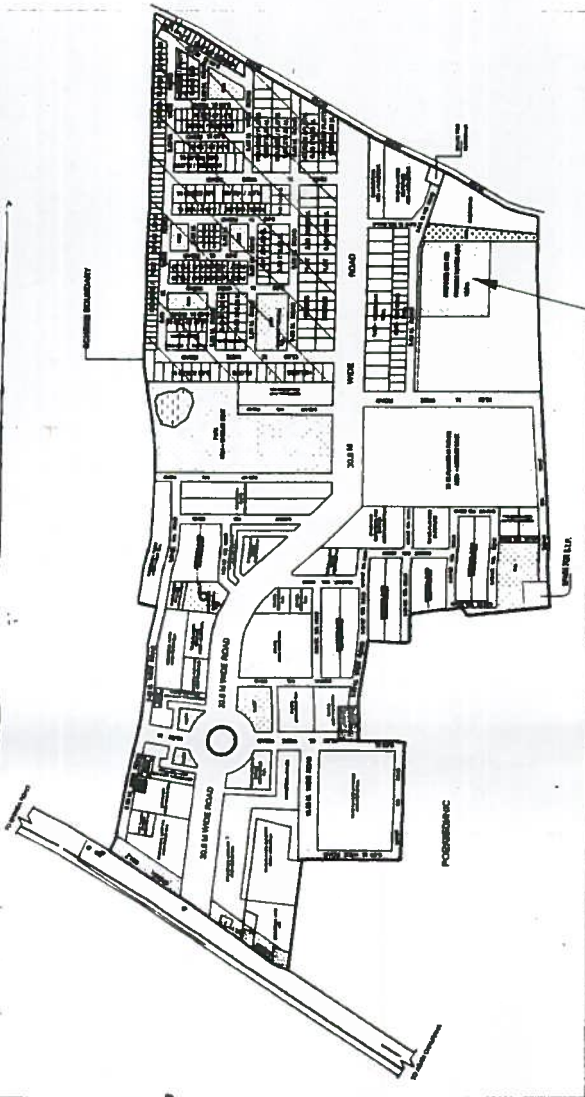

PREVIOUSLY PLANNED 9.00 MT. WIDE ROAD REVISED TO 12.00 MT. WIDE ROAD.

PREVIOUSLY SANCTIONED L.O.P. DTD.07.06.2017

PLOTS - 7.00 X 15.50 MT. 22 Nos.

12.00 MT. WIDE ROAD

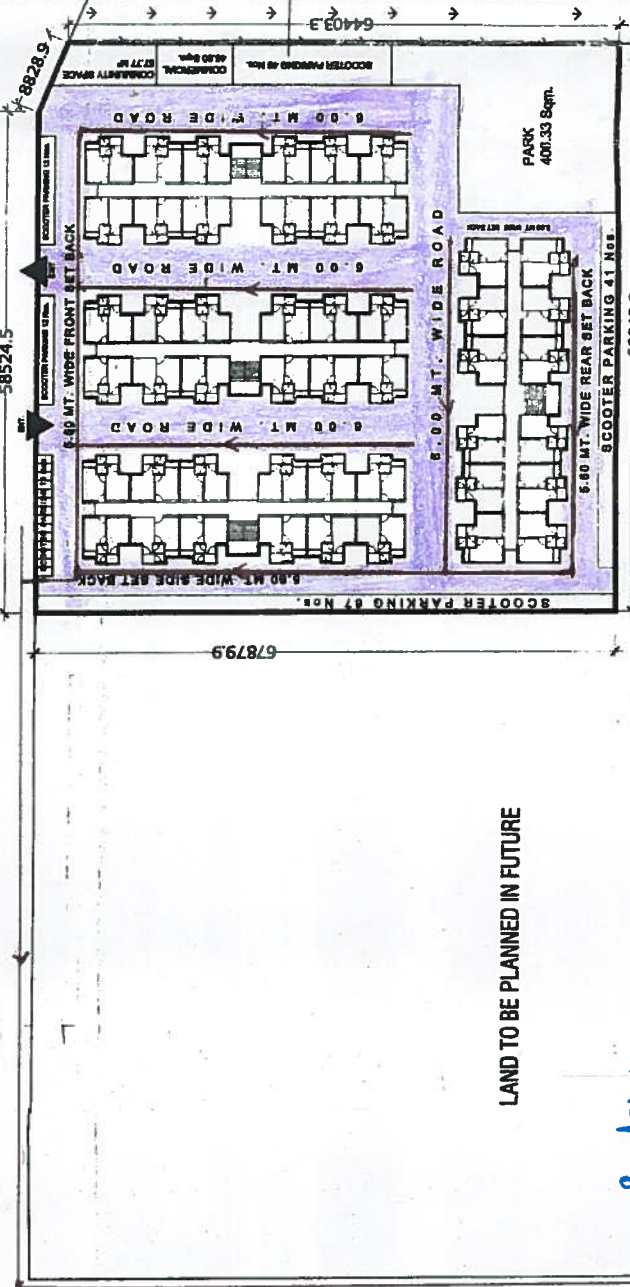

LAND TO BE PLANNED IN FUTURE

Index: -

- 1) Waste disposal line diagram
- Note: - Sewer disposal through the S.T.P. which is proposed in Parishad Scheme.

UPAVP
ARCHITECTURAL AND PLANNING SECTION
NEELGIRI COMPLEX, INDIRA NAGAR
LUCKNOW - 226016
Email: upavp@sancharnet.in

DRG. NO. PROPOSED/PART L.O.P./PRADHAN MANTRI AVAS YOJNA/BAHRAICH/2017-54
FILE NO. AP/UNIT-5/PRADHAN MANTRI AVAS YOJNA/PMAY/BAHRA MARG/BAHRAICH/10(PART-2)
PROCESS NAME/NO. UP/NO/PN/AV/03

NOTE DTD. 13.10.2017
1-THESE PART LAY OUT PLAN OF E.W.S. FLATS FOR PRADHAN MANTRI AVAS YOJNA HAS BEEN PREPARED ON THE BASIS OF INFORMATION FROM PRAMUKH SACHIV VIDE HIS SHASNADESH NO-1855/8-1-17-80 VIVIDH / 2010 DTD.05.09.2017.
2-IN THIS PART LAY OUT PLAN PREVIOUSLY PLANNED 9.00 MT. WIDE ROAD HAS BEEN REVISED TO 12.00 MT. WIDE ROAD.
NOTE DTD. 21.12.2017
1-THESE PART LAY OUT PLAN OF E.W.S. FLATS FOR PRADHAN MANTRI AVAS YOJNA HAS BEEN FINALIZED ON THE BASIS OF FEASIBILITY RECEIVED FROM E.E. C.D-4 VIDE HIS LETTER NO-1519/V-733 DTD.21.12.2017.

PLOT AREA 4509.41 M²
F.A.R. PROPOSED 1.45 (6541.44 M²)
GROUND COVERAGE 36.00% (1635.36 M²)
TOTAL NO. OF FLOORS G+3
TOTAL NO. OF UNITS (E.W.S.) = 192 NOS.
DENSITY = 427 Unit/HECT.
TOTAL POPULATION = NO OF UNITS X 5 PERSONS
192 X 5 = 960 PERSONS

REQUIRED SPACE FOR COMMUNITY CENTER FOR 25000 PERSONS 1500.00 M²
FOR 960 PERSONS 1500 X 960 / 25000 = 57.60 M²
PROP. SPACE FOR COMMUNITY CENTER = 57.77 M²
REQUIREMENT OF CONVENIENT SHOPS FOR 400 PERSONS 01 SHOP @ 15.00 M²
FOR 960 PERSONS 960 / 240 = 4 SAY 3 Shops
REQUIRED AREA = 15X3=45.00 M²
PROP. SPACE FOR CONVENIENT SHOPS = 45.00 M²
PROP. SPACE FOR GREEN / PARK = 408.33 M² OR 9.01%
PROP. SCOOTER PARKING = 192 Nos.

DRG. TITLE LAY OUT PLAN FOR PRADHAN MANTRI AVAS YOJNA
PROJECT BHINGA MARG YOJNA, BAHRAICH.
DATE : 21-12-2017

SCALE:

VIBHA SRIVASTAVA	Arch. ASSTT.	<i>Vibha</i>
PRABHAVATI SURI	ASSTT. ARCH. PLANNER	
JYOTI KATIYAR	ARCHITECT PLANNER	<i>Jyoti</i>
MAHENDRA KUMAR	CHIEF ARCHITECT PLANNER	<i>M.K.</i>
DHEERAJ SAHU	HOUSING COMMISSIONER	<i>D.S.</i>

NOTE
1-AS THIS LAY OUT IS PREPARED WITHOUT PRIOR INFORMATION ABOUT ACTUAL DEMAND OF HOUSES UNDER PRADHAN-MANTRI AVAS YOJNA THEREFORE THE IMPLEMENTATION AND THE EXECUTION OF THE LAY OUT ON THE SITE SHALL BE MADE AS PER ACTUAL DEMAND IN THE BAHRAICH CITY.
2-THESE LAY OUT IS SUBJECT TO REVISION AS PER ACTUAL DEMAND OF HOUSES UNDER PRADHAN-MANTRI AVAS YOJNA.

TO BE PLANNED IN FUTURE
AREA = 16098.00 SQMT.

ROAD WIDE M. 15.00