

Project Title : PROPOSED SERVICE & LAND SHAPE RESIDENTIAL LAY-OUT PLAN OF SHEEL KUNJ Ext. (File No. MDA/LD/25-26/0605) AT PALLAV PURAM ROAD, MEERUT.
 Khasra No. 485 part, 487 part, 490 part, 616 & 617 part, at Village Muqarrabpur Palhera, Meerut.

UNITS IN MAP ARE 35 SINGLE UNITS WHICH ARE UNDER PERMISSIBLE LIMIT DENSITY:-
 TOTAL NO. OF PLOTS / HOUSE:- 35 POPULATION:- (35X5 = 175) = 175 PERSON
 DENSITY:- 175/828693 HA. 211.18 P.P.H. SAY 211 P.P.H.
 NOC Conditions of all Departments shall be complied with
 OWNER'S:- MS INDUS VALLEY PROMOTERS LTD.
 Through Authorised Signatory Mr. Deepak Sharma 2-P.L. Sharma Road Meerut.

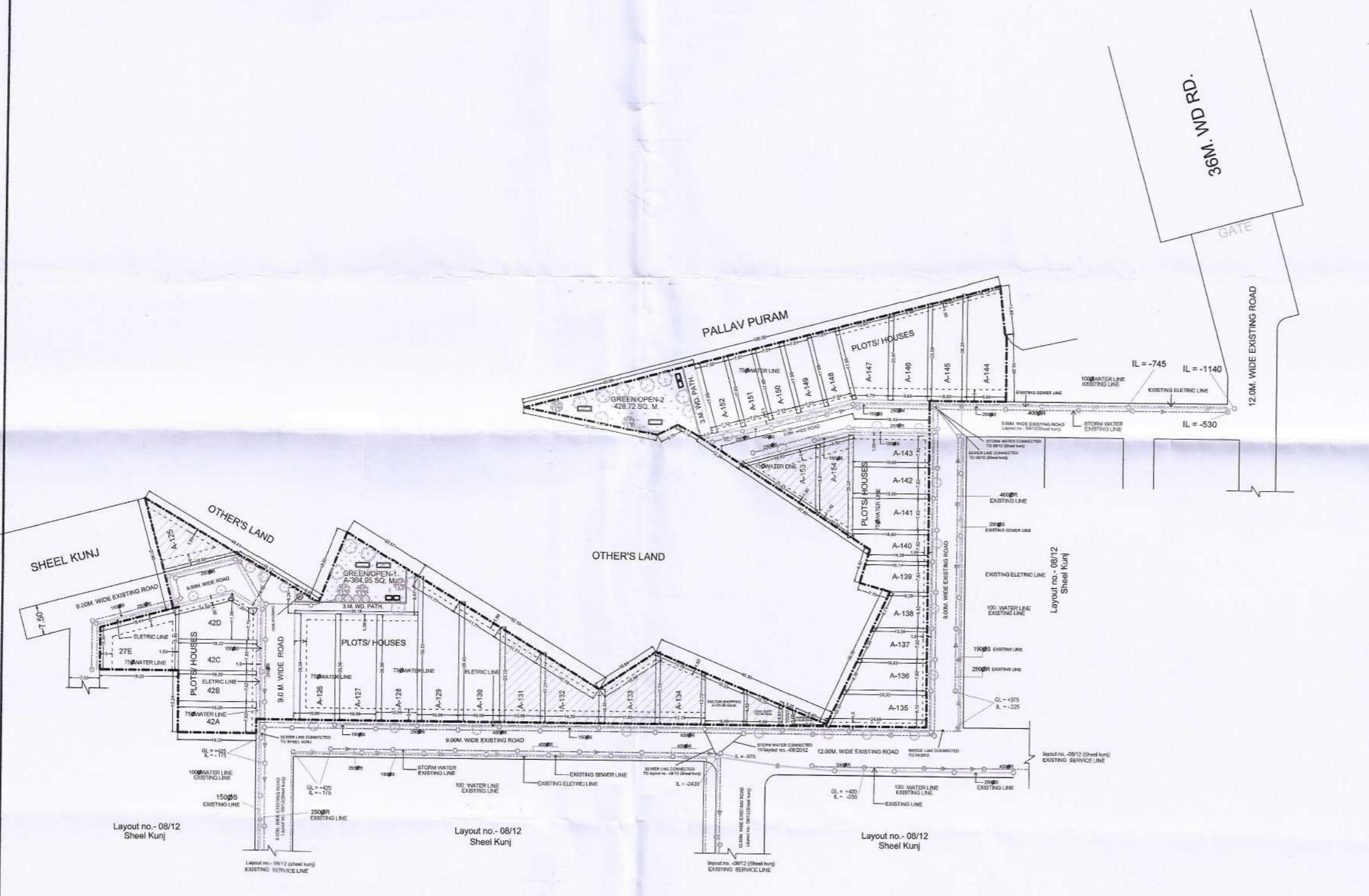

LEGEND :-

	SITE BOUNDARY		RAIN WATER HARVESTING PIT
	STORM WATER LINE		ELECTRIC H.T. LINE
	WATER SUPPLY LINE		TREES
	SEWER LINE		3.0 M PATHWAY LINE IN PARK
	DUSTBINS		FIRE HYDRANT
	BENCH		

OWNER'S NAME AND SIGNATURE

MS Indus Valley Promoters Ltd.
 Through Authorised Signatory Mr. Deepak Sharma

OWNER_SIGN

Deepak Sharma
 सापथकर्ता

ARCH. ENG'S NAME AND SIGN A

Umesh Kumar Kaushik ARCH. / ENG. SIGN
 M-140105426102018

Umesh Kumar Kaushik
 ER. U. K. KAUSHIK
 B.E. (CIVIL) M.T.E. (INDIA)
 M. No. - M-140105-4
 Regd. Engineer (M.D.A.)

