

CONSTRUCTION OF 396 Nos HOUSES UNDER PMAY(U), GONDA

AREA ANALYSIS

S.N.	ITEM	AGREED	REMARKS
1.	PLOT AREA	12130.74 SQM	
2.	GR. COVERAGE (01 BLOCK)	408.84 SQM	
3.	GR. COVERAGE	4497.24 SQM	37.07 %
4.	FAR	1.48	
5.	UNITS IN 01 BLOCK		48 Nos.
6.	NOS. OF BLOCKS		11 (G+3)
7.	NO. OF UNITS	528 Nos.	
8.	PARKING	560 Nos.	@2.0 sq. mt./unit
9.	POPULATION DENSITY	2176 PERSON / HECT.	

LANDUSE ANALYSIS

TOTAL PROJECT AREA = 12130.74 sqm

Landuse	Area in sqm.	%Age.
Residential (ground coverage)	4497.24	37.08
Commercial	370.34	3.05
Park / OPEN	1228.89	10.13
Roads & Parking	6034.27	49.74
Total	12130.74	100.00

PLINTH AREA OF ONE UNIT = 28.15 SQM.
CARPET AREA OF ONE UNIT = 22.77 SQ. M.
CIRCULATION AREA OF ONE FL = 7.06 SQM
SUPER AREA OF ONE UNIT = 34.07 SQM

UPAYI ARCHITECTURE AND PLANNING
HIGRA COMPLEX, BIGNA 104
LUCKNOW.

PMAY

MANDAL	DEVIPATAN
DISTT.	GONDA
GATA NO.	142,144, 135
VILLAGE / MOHALLA	CIVIL LINES
AREA	12130.74 SQM.
RESIDENTIAL UNITS	528 UNITS
DRG. NO.	

NOTE:-

1. THIS LAY OUT PLAN FOR THE HOUSES UNDER PRIME MINISTER AVAS YOJNA HAS BEEN PREPARED ON THE BASIS OF ORDER GIVEN BY CHIEF ENGINEER IN SAMIKSHA BATHAK HELD IN HEAD OFFICE DATED 20.03.2017 AND UNIT DRAWING & SAMPLE L.O.P. PROVIDED BY उत्तर प्रदेश, UTTAR PRADESH SHASAN VIDE HIS LETTER NO. 1853/8-1-17-80VIVDH / 2010 DATED 03.09.2017.

2. THIS LAY OUT PLAN FOR THE HOUSES UNDER PRIME MINISTER AVAS YOJNA HAS BEEN FINALISED ON THE BASIS OF FEASIBILITY RECEIVED BY I.E.C.D.-02 VIDE HIS LETTER NO. 2053/PP-244 DATED: 14.05.2018.

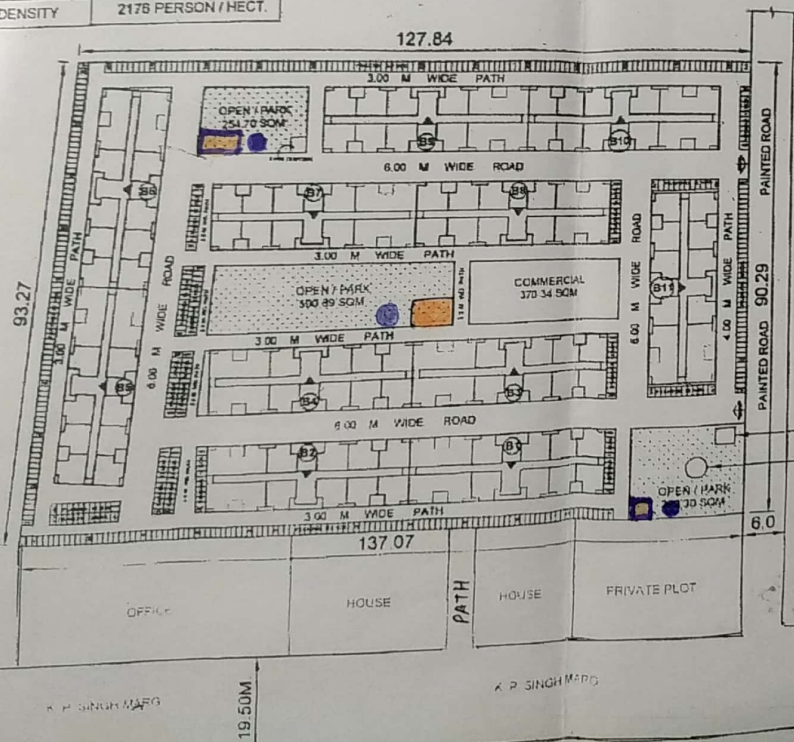

INDEX

- SEPTIC TANK
- SOAK PIT
- TUBE WELL
- OHT

PROPOSED LAYOUT PLAN OF HOUSES UNDER PRADHAN MANTRI AVAS YOJNA AT DISTT.- GONDA, UTTAR PRADESH

DATE :	20.08.2018	NORTH	
SCALE :			
VIKAS SINGH			
D/MAN (CIVIL)			
PRAEHAVATI SURI	Prabhavati SURI 20/08/18		
ASSTT. ARCH. PLANNER			
ARVIND DEO ARYA	Arvind Deo Arya 20/08/18		
ARCHITECT PLANNER			
A.K. SHUKLA	A.K. Shukla 20/08/18		
CHIEF ARCHITECT PLANNER			
AJAY CHAUHAN	Ajay Chauhan 20/08/18		
V.S. ARUNT			