

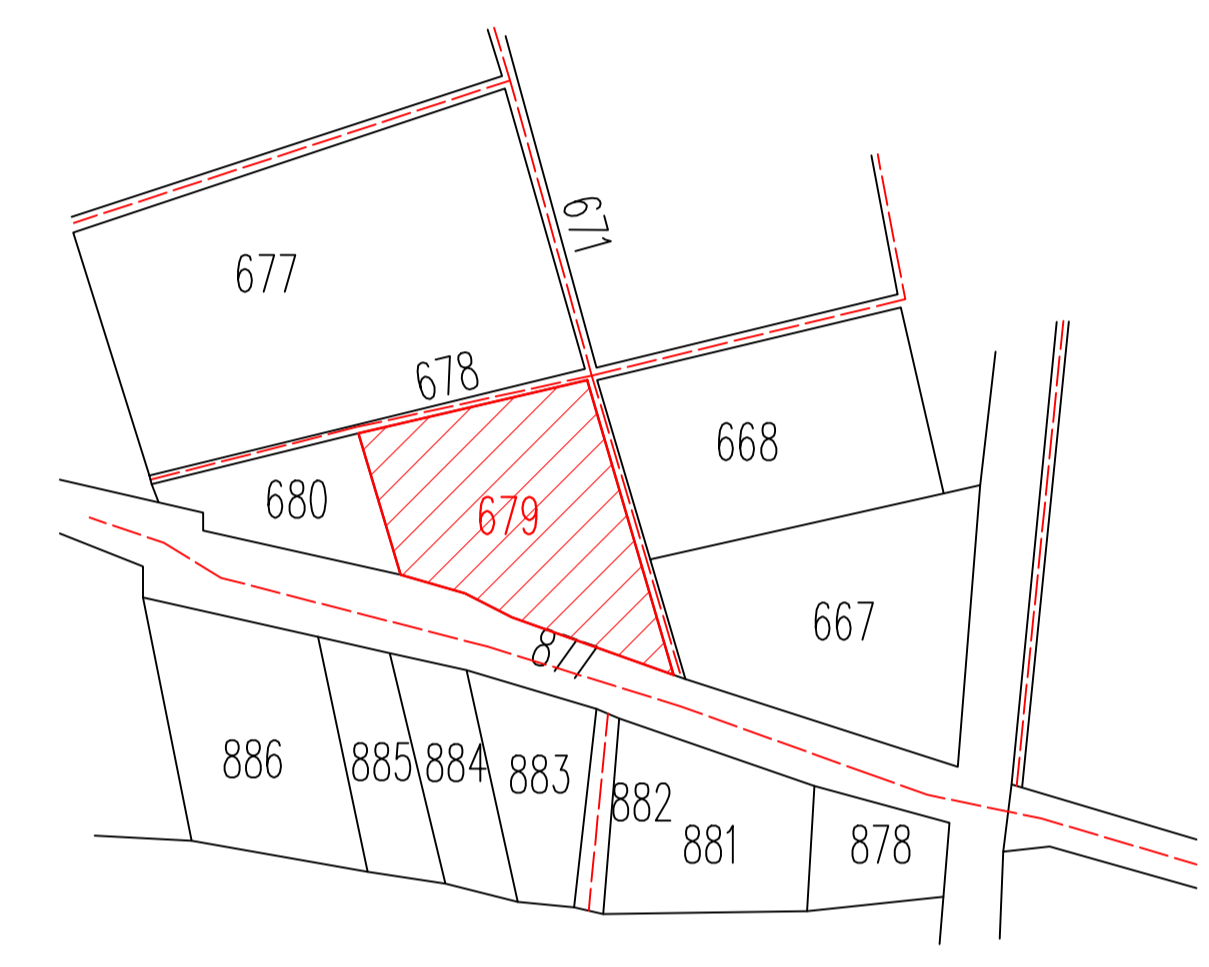

TOTAL LAND AREA IN DEED = 8960.00 SQ.MT.  
 TOTAL LAND AREA ON SITE = 8959.83 SQ.MT.  
 ROAD WIDENING AREA = 629.63 SQ.MT.  
 NET LAND AREA ON SITE = 8330.20 SQ.MT.

REQ. GREEN 15% = 1249.53 SQ.MT.  
 PROVIDED GREEN = 1338.41 SQ.MT.  
 REQ. COMMERCIAL 5% = 354.91 SQ.MT.  
 PROVIDED COMMERCIAL = 302.41 SQ.MT.  
 BAZAR STREET PLOT'S AREA ( B-1 TO B-11 ) = 1231.85 SQ.MT.  
 PLOTTED AREA = 3636.42 SQ.MT.  
 ROAD AREA = 1821.11 SQ.MT.



PART OF SAZRA PLAN

DEVELOPMENT PLAN ( 1:100 )

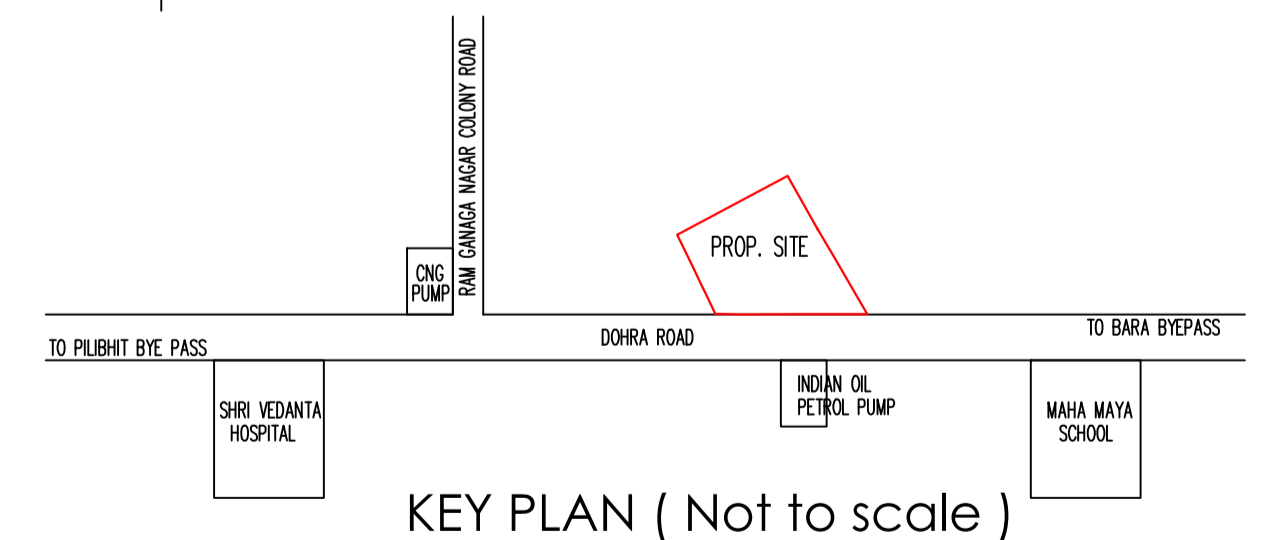

KEY PLAN ( Not to scale )

SERVICES:--	LEGEND:--
<p>LEGEND:</p> <p>TREE </p>	<p>PROP. WORK </p>

LAYOUT PLAN OF ( ROYAL RESIDENCY ) UNDER AFFORDABLE SCHEME AS PER GOVERNMENT ORDER NO. 63/2021/1093/8- 1-21-34 SITTING/2014 T.C. DATED 23 SEPTEMBER 2021, FOR AKASH BUILDTECH PVT. LTD. AKASHPURAM BAREILLY THROUGH ITS DIRECTOR SHRI SHYAM SINGH RATHORE S/O SHRI STYADEV RATHORE OFFICE - 5, AKASH TOWER, PILIBHIT BYE PASS, BAREILLY. SITE AT KHET NO. 679, VILLAGE CHANDPUR BICHPURI, PARGANA, TEHSIL AND DISTT. BAREILLY.

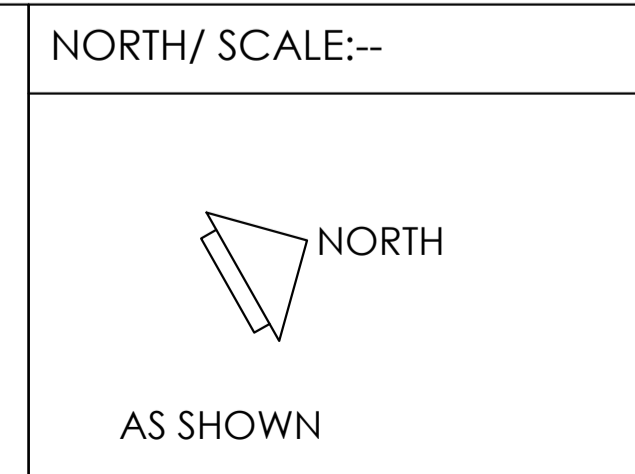

APP. SIGN.:--

ARCHITECT:--

PAWAN BHATT  
 M.Arch.  
 P6-7 BEHIND B.B.L. SCHOOL  
 D.D. PURAM BAREILLY.  
 9837059454 ( M )