

KHASRA WISE AREA DETAIL							
Plot of the land admeasuring 33338.50 square meters of land comprising of Khasara Nos.613,613 M, and 615 at Village Basantpur Satali, Tehsil Modi Nagar. District Ghaziabad							
S.No	Khata No.	Khasra No.	Land Owner	Total Area in(Hectares)	Area in Project (Sq.Mtrs.)	Total Area in Project (Sq.Mtrs.)	% of Share
1	408	613 M	Seema Rani	1.0120	9588.32	13138.32	39.40%
2	407	613 M	Seema Rani	0.3550	3550		
3	15	614 M	Saurabh Gupta	0.8305	6169.595	9391.595	28.17%
4	385	615 M	Saurabh Gupta & Sonu Gupta	0.6444	3222		
					3222		
5	15	614 M	Sonu Gupta	0.8305	7586.59	10808.59	32.43%
			Total Area			33338.50	100%

TOTAL PROPOSED LAND AREA (A)=33338.5 SQMT.  
AREA UNDER NH -58 ROAD WIDENING (B)=124.65 SQMT.  
AREA UNDER GREEN (C)= 1246.5 SQMT.  
AREA UNDER CHAK ROAD WIDENING (D)= 211.0 SQMT.  
NET PLOT AREA (E=A-(B+C+D))= 31756.35 SQMT.

Figure 1-1 Shajra Map of Proposed Group Housing

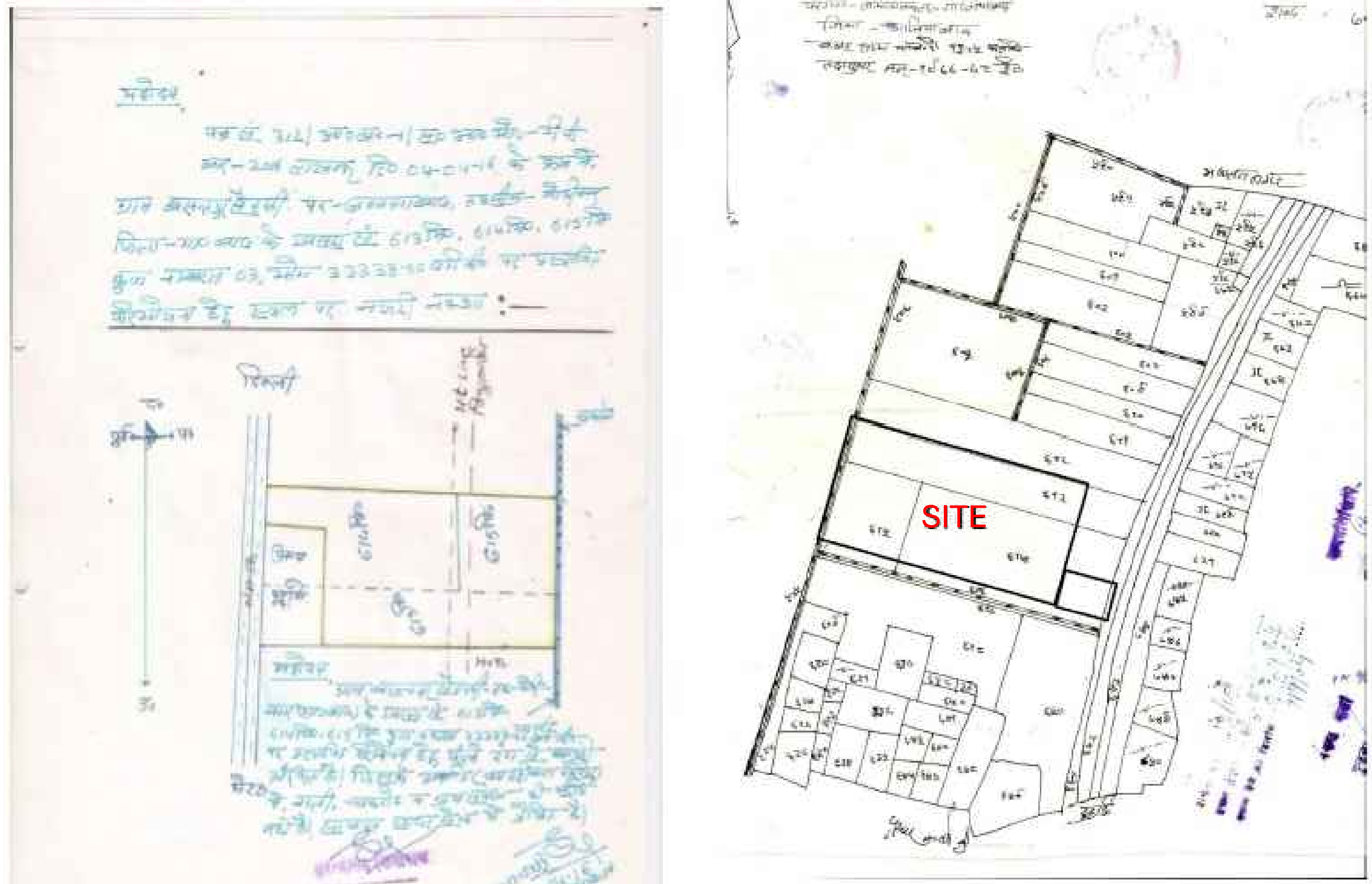

SHEEMA RANI :- KHASRA NO. 613 M :- 8072SQMT  
SH SOURABH :- KHASRA NO. 614 M :- 1106 SQM  
TOTAL AREA OF PHASE -4 :- 9178 SQM

SUBMISSION DRAWING FOR LANDSCAPE ARCHITECTURE PROJECT

PROJECT NAME: SHAJRA MAP OF PROPOSED GROUP HOUSING

CLIENT: SMT. SEEMA RANI

ARCHITECT: Ar. Rachit Sharma

DRAWING TYPE: SHAJRA MAP OVERLAP SITE PLAN

SCALE: 1:500

ARCH. SEAL & SIGNATURE: DEVELOPER SIG.

FOR MR. LANDSCAPE LLP

Rachit Sharma  
B.Arch., MUDP  
COA No.-CA/2002/30415