

- LEGEND:-**
- ⊠ HIGH PRESSURE MERCURY LAMP
 - PATHWAY LIGHTS
 - ⊕ FLOUROCENT STREET LIGHT
 - ⊗ 4 ARMS POLE LIGHT
 - ⊙ GATE LIGHT

TRANSFORMER

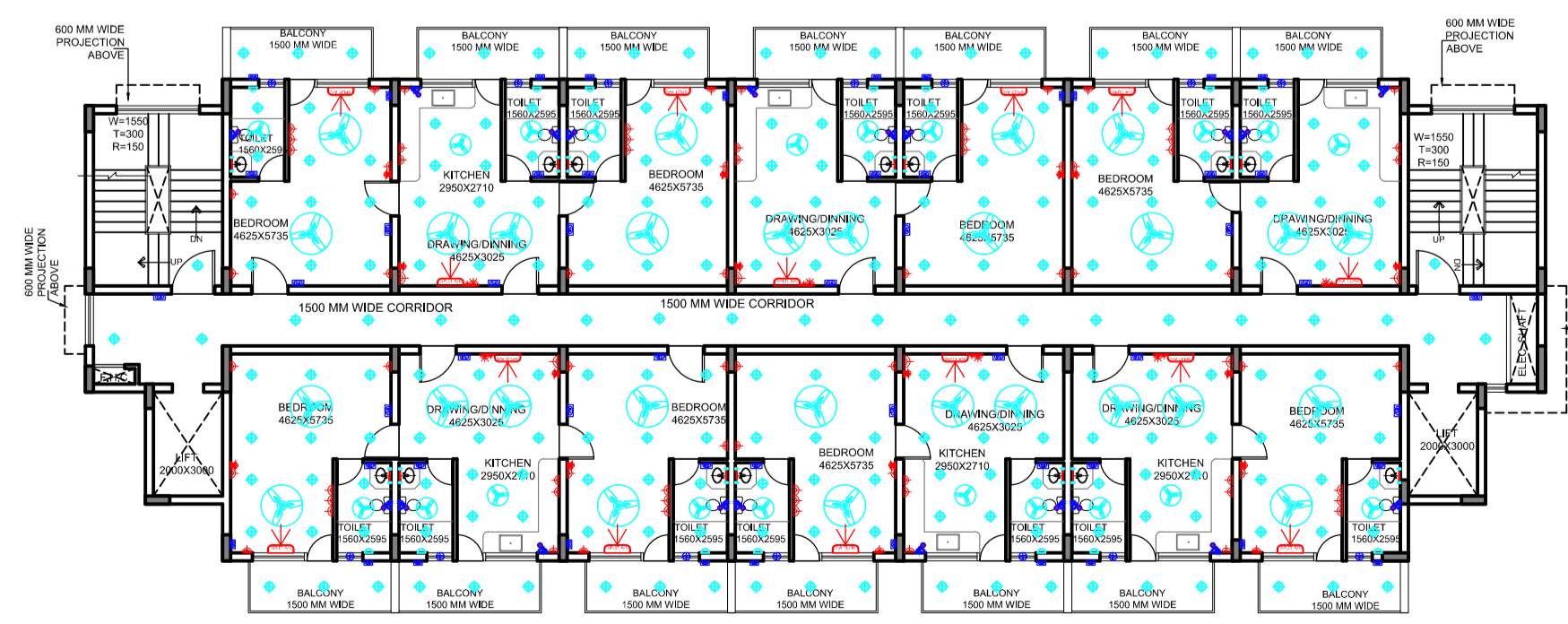

- 6A Socket+Switch Board for Fan/Light & Emergency Switch at Ht. 1200/600mm
- 16A Socket with Switch ht. 1200 mm
- 16A Socket with Switch ht. 300 mm
- 25a, 3pin industrial socket with sp mcb for ac at ht 600mm
- AC at ht 2200 mm
- 1X6A Socket with Switch at ht 600mm
- *Telephone Point
- Socket with Switch FOR R.O. & geyser at ht. 2100mm
- Mirror Light at ht 1900mm
- Exhaust Fan
- Exhaust fan socket at ht. 2100 mm

NOTE:- ALL DIMENSIONS ARE IN MM	
Project Title	ELECTRICAL LAYOUT PLAN
Project	PROPOSED GROUP HOUSING (VRINDA KUNJ) AT MAUZA SUNRAKH BANGAR, KHASRA NO 1196,1194 & 1186, VRINDAVAN, TEH. & DISTT. MATHURA
Client	SHRI ENERGY DEVELOPERS PVT LTD. NEW DELHI
Architects	GAUTAM & GAUTAM ASSOCIATES ARCHITECTURE+URBAN PLANNING+LANDSCAPING+INTERIORS G&G ARCHITECTS
Architect's Signature:-	OWNER SIGNATURE:-
Scale	1:100
Date	MARCH 2022
Orientation	NORTH

ESS

DG SET