





80 श्याम सुन्दर  
 सहायक प्रसन्नक (परियोजना)  
 वर्क सर्किल-1

  
 अनोस  
 प्रसन्नक (परियोजना)  
 वर्क सर्किल-1

  
 के. आदर्श  
 सहायक प्रसन्नक (परियोजना)  
 वर्क सर्किल-1

10

Index

☒ :- Sewer

☑ :- manhole

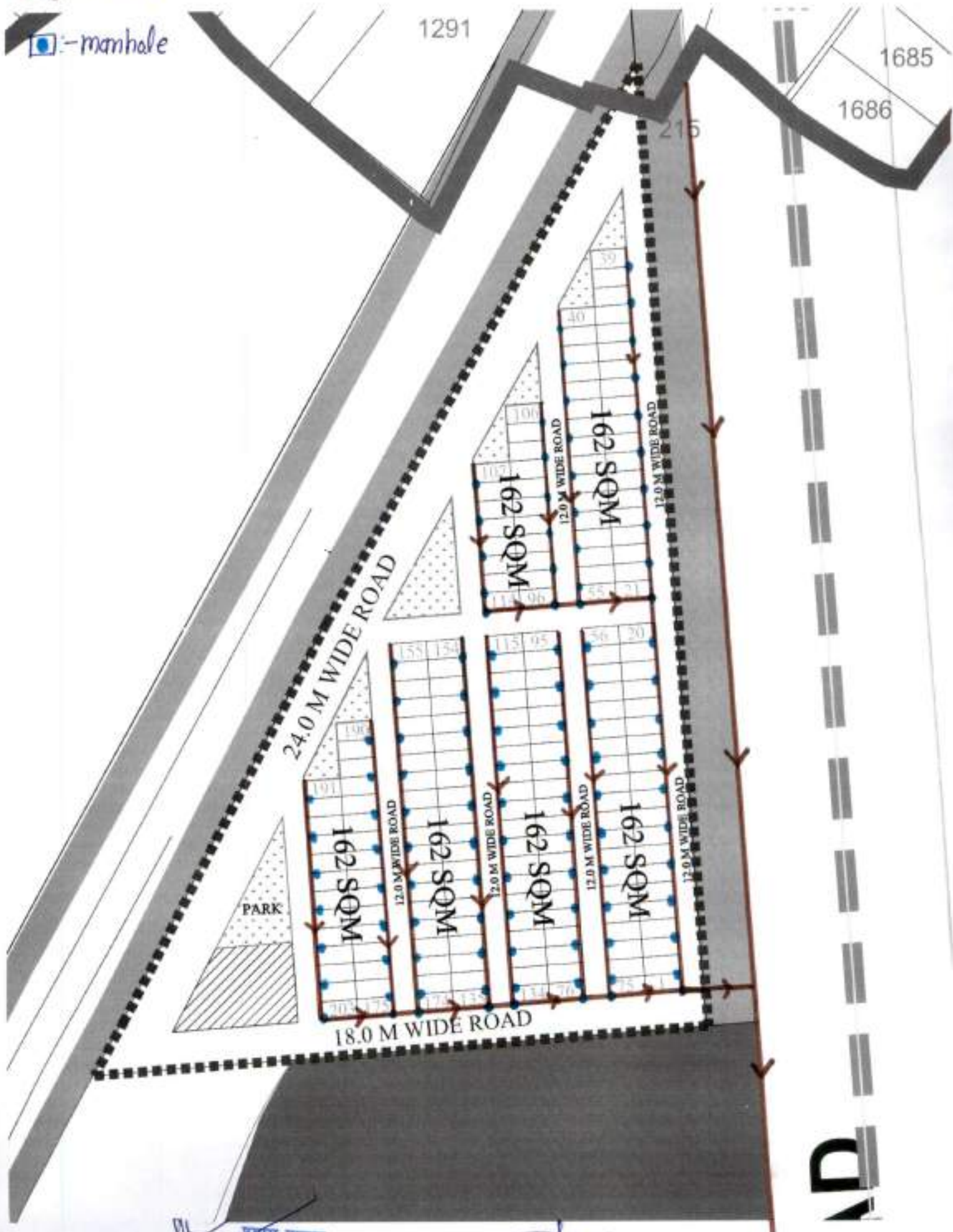

1291

1685

1686

215

24.0 M WIDE ROAD

18.0 M WIDE ROAD

12.0 M WIDE ROAD

12.0 M WIDE ROAD

PARK

162 SQM

162 SQM

162 SQM

162 SQM

162 SQM

162 SQM

श्याम सुन्दर  
 सहायक प्रबंधक (परिचोजना)  
 वर्क सर्किल-1

श्याम सुन्दर  
 सहायक प्रबंधक (परिचोजना)  
 वर्क सर्किल-1

D

Index

☐ :- water supply network

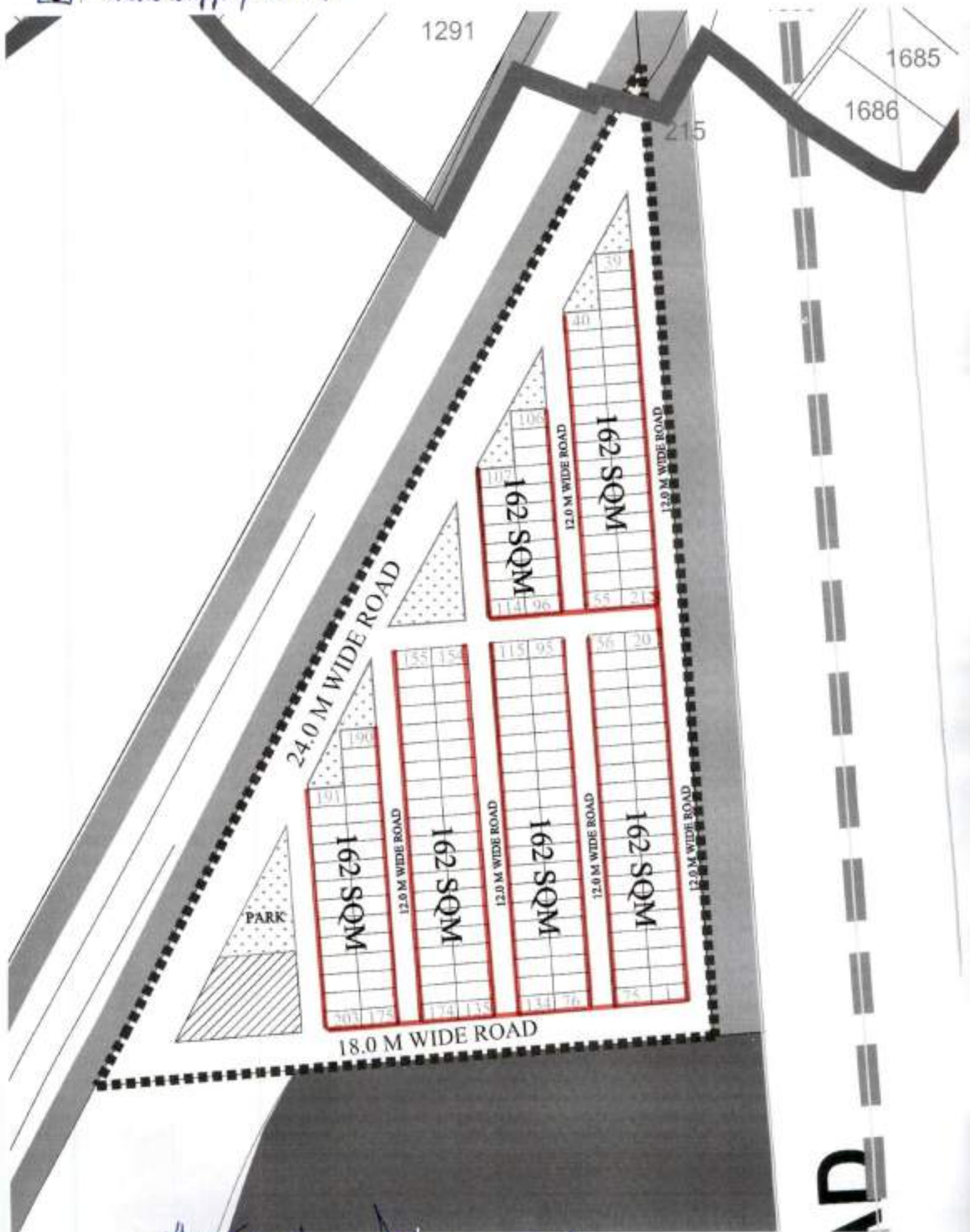

  
 सहायक प्रबंधक (परियोजना)  
 वर्क सर्किल-1

  
 अनील  
 प्रबंधक (परियोजना)  
 वर्क सर्किल-1

  
 एन० सी० आदर्श  
 सहायक प्रबंधक (परियोजना)  
 वर्क सर्किल-1

10

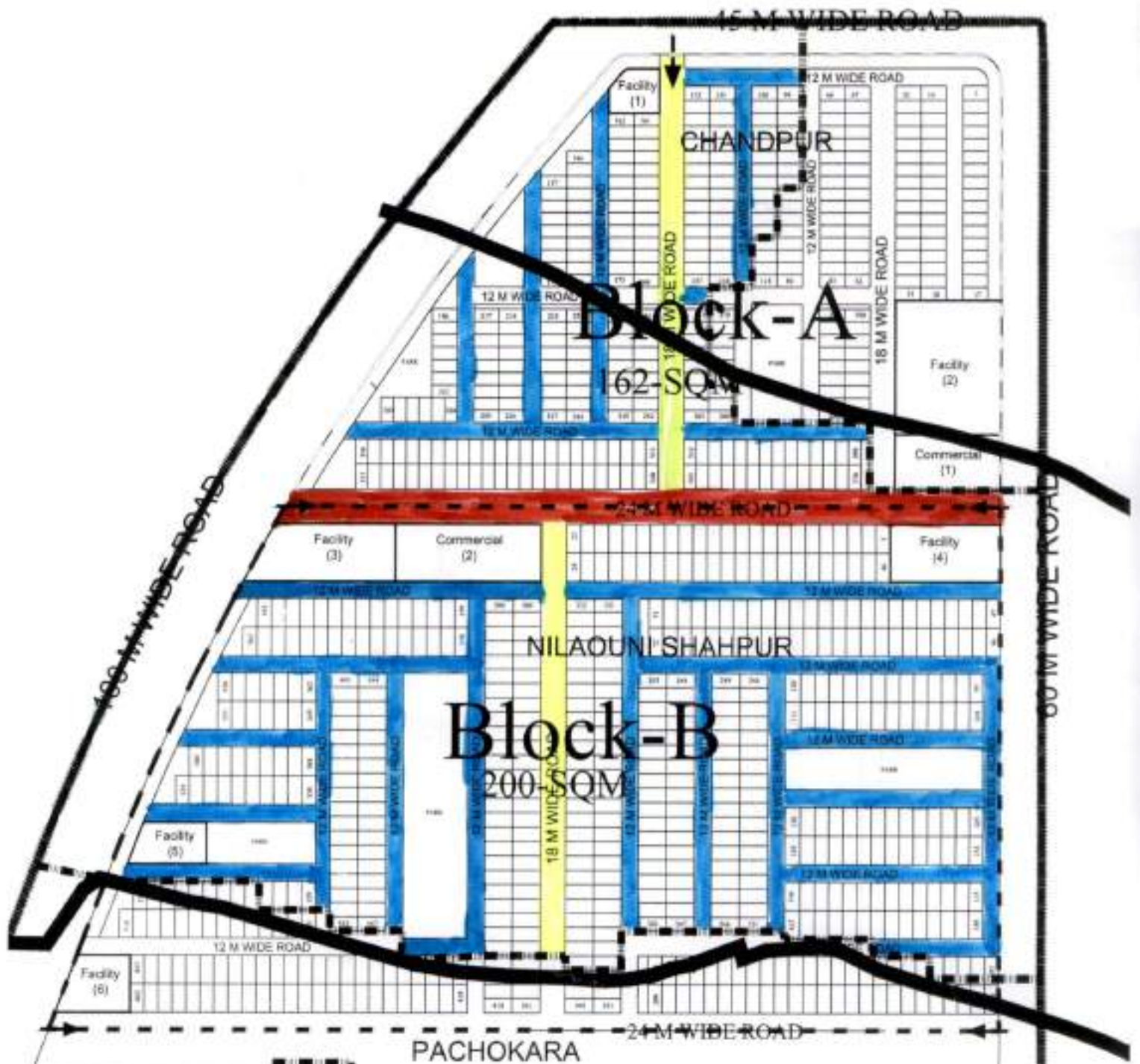

SCHEME BOUNDARY - [Dashed Line]

- 12 mtr. wide road length - 5260.50 mtr.
- 18 mtr. wide road length - 448.00 mtr.
- 24 mtr. wide road length - 517.00 mtr.

*Handwritten signature/initials*

*Handwritten signature/initials*

*Handwritten signature/initials*



SCHEME BOUNDARY - [Dashed Box]

- 450mm Dia Rec Drain length - 10911.65mtr.
- 600mm Dia Rec Drain length - 996mtr.
- 900mm Dia Rec Drain length - 1034mtr.

*[Handwritten Signature]*  
 JH

*[Handwritten Signature]*  
 JH

*[Handwritten Signature]*

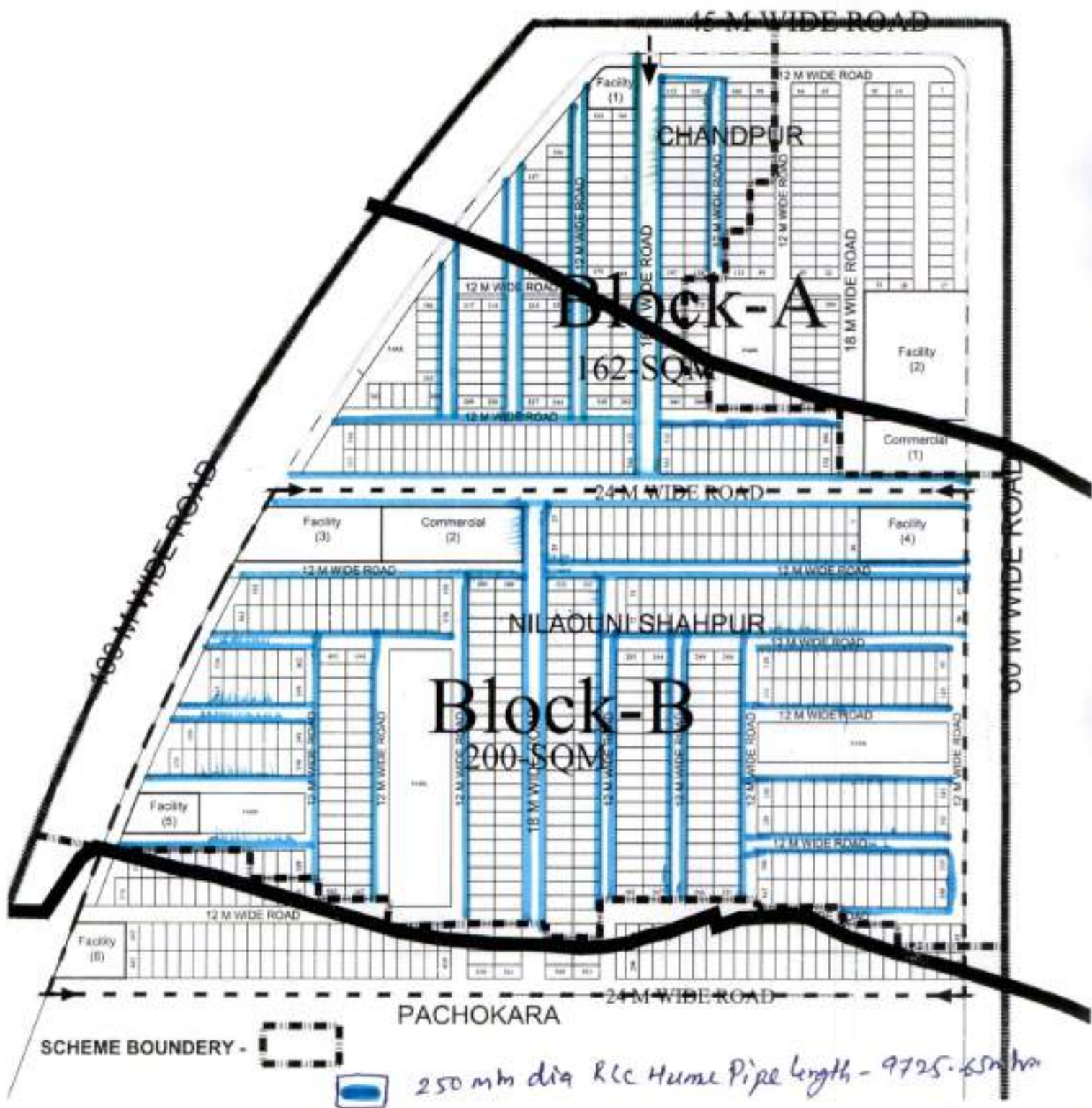

*SA*  
*AN*

*Amir*

*10*

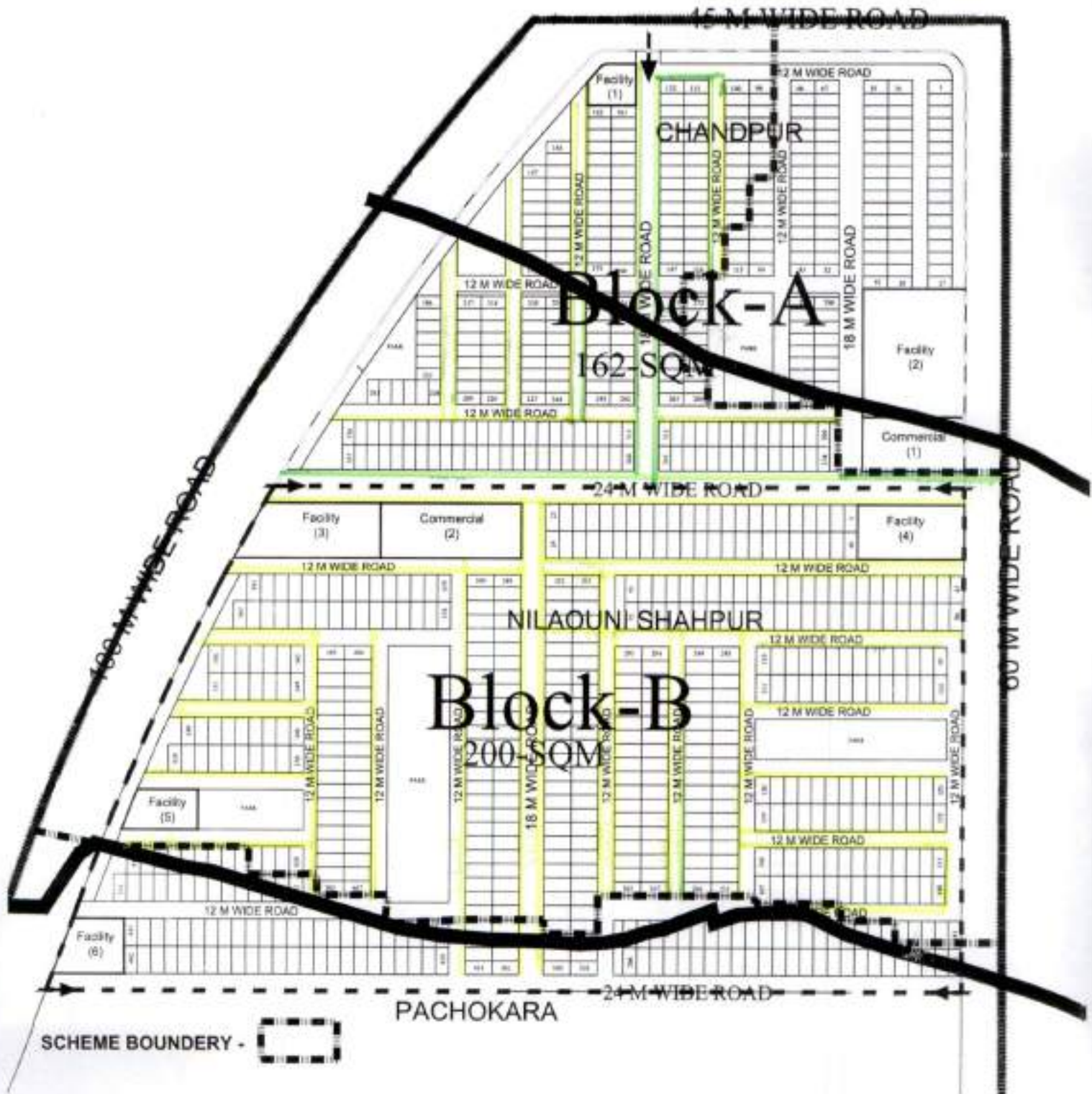

*M*  
AAR

*Am*  
M

*By*

Water Supply Plot no. 4 B Sector. 24A

**SECTOR 24A RESIDENTIAL SCHEME**

**KADARPUR MOJJAMPUR**

SCHEME AREA : 24865.17 SQM

Commercial

**CHAKJALA BANGAR**

Comme

**TAQUIPUR BANGAR**  
Inst. facility  
Comm.

12

Sewerage System Plot no. 4/8 Sector - 24A

SECTOR 24A RESIDENTIAL SCHEME

KADARPUR MOJJAMPUR

SCHEME AREA : 24665.17 SQM

Commercial

CHAKJALAPAD

Comme

TAQUIPUR

Instan facility

BANGAR

Comm.

12

A-11

Handwritten signature and date

Sewerage System Plot no 2B Sector - 24A

SECTOR 24A RESIDENTIAL SCHEME

KADARPUR MOJJAMPUR

SCHEME AREA : 24665.17 SQM

Commercial

CHAKJALAPAD

Comme

TAQUIPUR

Instn facility

BANGAR Comm.

12

Drainage System Plot no-18 Sector-24A

SECTOR 24A RESIDENTIAL SCHEME

KADARPUR MOJJAMPUR

SCHEME AREA : 24665.17 SQM

Commercial

CHAKJALABAD

Comme

TAQUIPUR BANGAR  
Inst. facility  
Comm.

12

Road Plot no: 13 Sector: 24A

**SECTOR 24A RESIDENTIAL SCHEME**

**KADARPUR MOJJAMPUR**

SCHEME AREA : 24665.17 SQM

Commercial

**CHAKJALABAD**

Comme

**TAQUIPUR BANGAR**  
Institutional facility  
Comm.

12

Handwritten signatures and dates: 7-10, 5-10

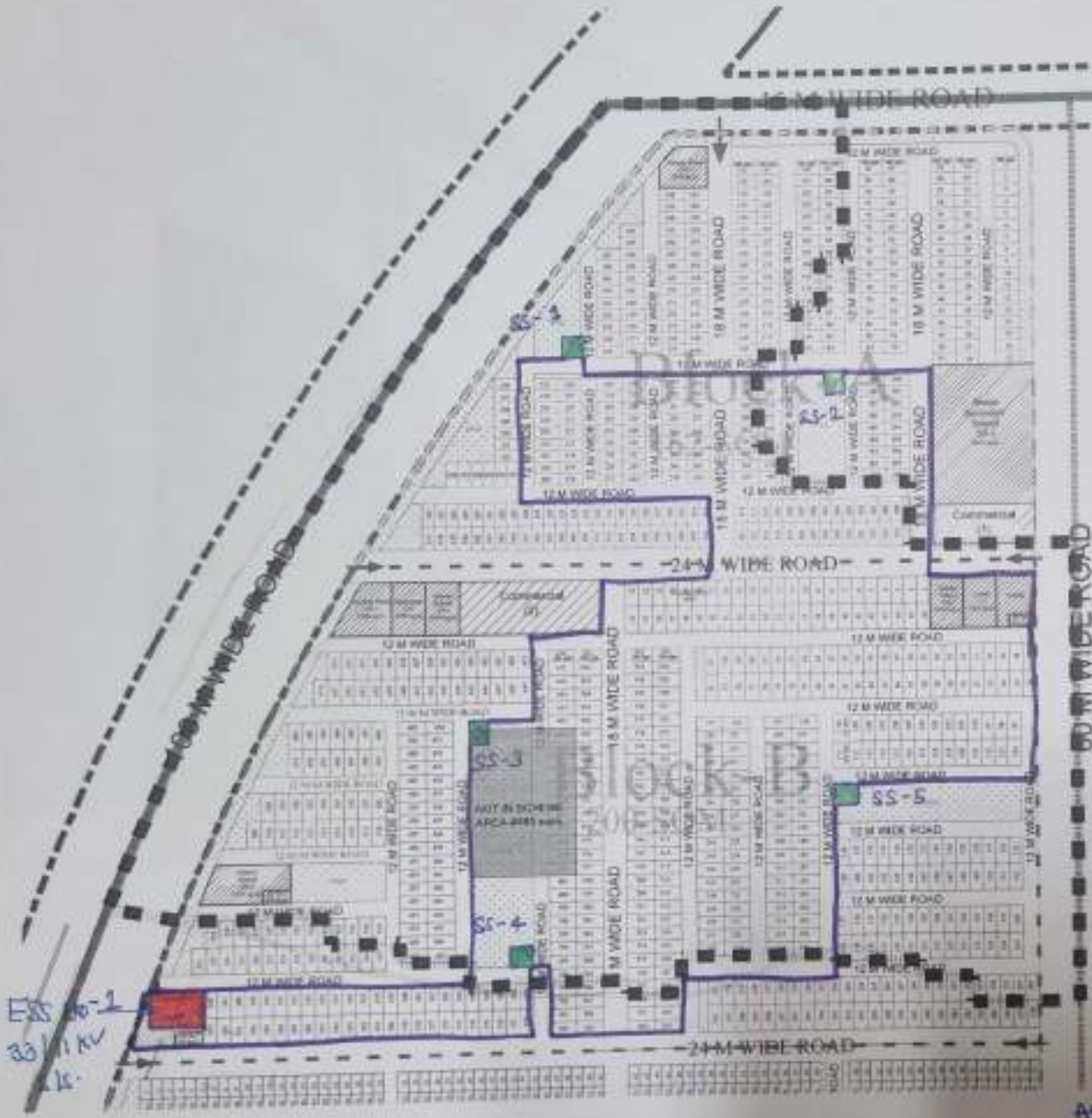

INDEX

◻ - 33/11 KV S/S (ESS-1)  
(Size - 50 X 30 = 1500 Sqm)

SCHEME BOUNDARY - [---]

SECTOR -15C (RESIDENTIAL)  
SCHEME AREA-302339-SQM APP.

◻ - 11/0.415 KV S/S  
(Size - 20 X 15 = 300 Sqm)

— - 11 KV HT Network

ESS-1  
33/11 KV  
16





*inference*  
ASST. MGR (S/INTL)

*[Signature]*  
MGR (S/INTL)

*[Signature]*  
Sr. MGR (S/INTL)

SECTOR-18, POCKET-9A

INDEX

-  110.415 kv SLS - 1 No.
-  Main feeder Pillar - 8 No.
-  Sub-feeder Pillar - 41 No.
-  Street Light - 80 No.
-  L.T. Cables -

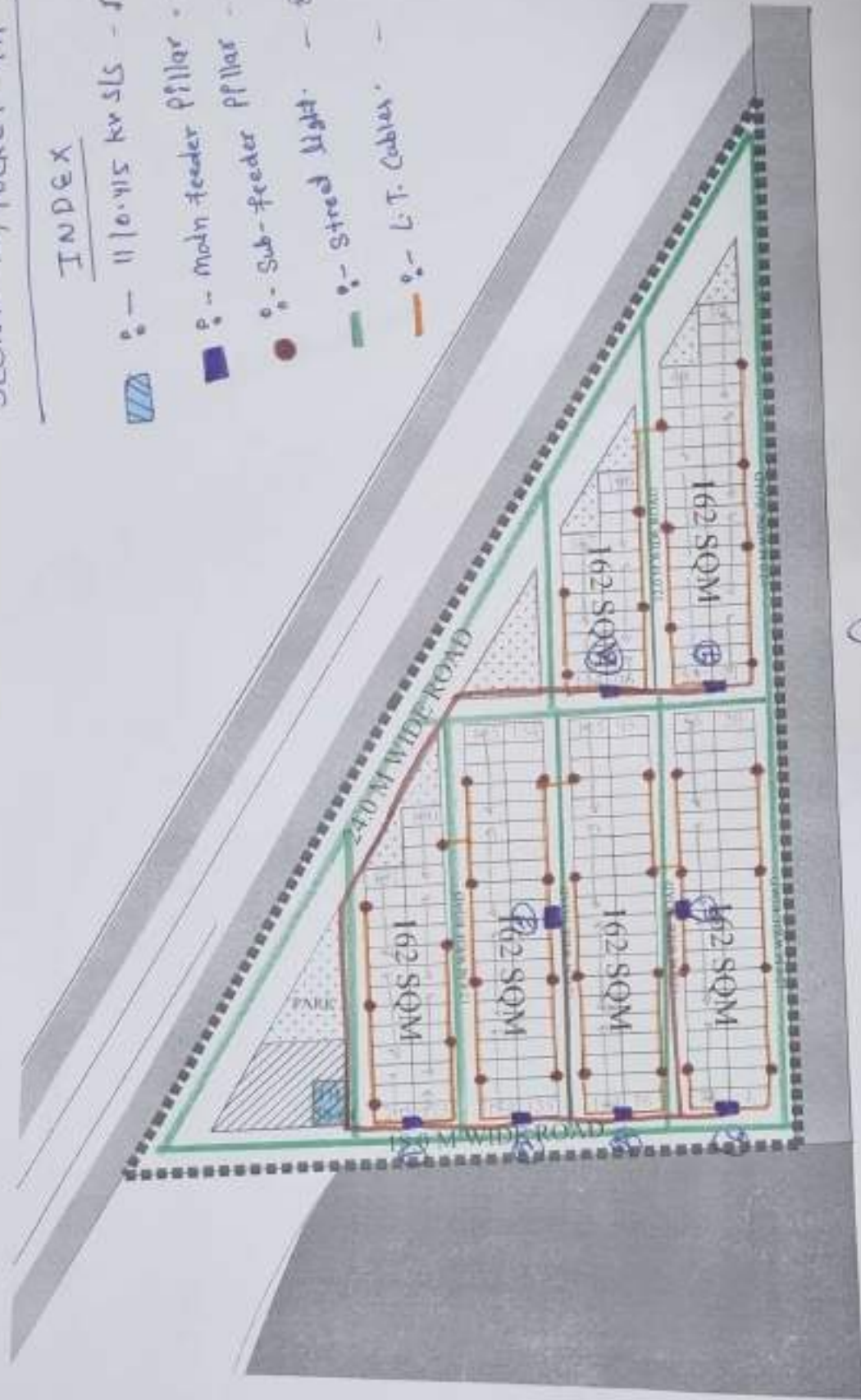

AD

*Ravi*  
10/11/11

SECTOR 24A RESIDENTIAL SCHEME

# KADARPUR MOJJAMPUR

— → LT & Street Light Pole Network

SCHEME AREA 24665.17 SQM

Commercial

# CHAKJALA BANGAR

# TAQUIPUR BANGAR

34 Institutional facility

Comm.

*Handwritten notes and signatures:*  
Date = 20/11/2019  
[Signature]



-  → 83/11 KWSS (21)
-  → 11/0.415 KWSS (5)
-  → Main Feeder Pillar
-  → Sub Feeder Pillar
-  → Street Light (15)