

AREA ANALYSIS

S.N	ITEM	ACHIVED	REMARKS
1.	PLOT AREA	12130.74 SQM.	
2.	GR. COVERAGE (01 BLOCK)	408.84 SQM.	
3.	GR. COVERAGE	4497.24 SQM.	37.07 %
4.	F.A.R.	1.48	
5.	UNITS IN 01 BLOCK	48 Nos.	
6.	NOS. OF BLOCKS	11 (G+3)	
7.	NO. OF UNITS	528 Nos.	
8.	PARKING	560 Nos.	@2.0 sq.m/unit
9.	POPULATION DENSITY	2176 PERSON/HECT.	

LANDUSE ANALYSIS

TOTAL PROJECT AREA = 12130.74sqm.

Landuse	Area in sqm.	%Age.
Residential (ground coverage)	4497.24	37.08
Commercial	370.34	3.05
Park / OPEN	1228.89	10.13
Roads & Parking	6034.27	49.74
Total	12130.74	100.00

TEMP PRJ 18654

PLINTH AREA OF ONE UNIT = 28.15 SQM.
 CARPET AREA OF ONE UNIT = 22.77 SQM.
 CIRCULATION AREA OF ONE FL = 7.108 SQM
 SUPER AREA OF ONE UNIT = 34.07 SQM

PROPOSED SOLID WASTE DISPOSAL POINT IN

PROJECT. PMAY GONDA



UPAVP
 ARCHITECTURE AND PLANNING
 NIGRI COMPLEX, INDRA NAG
 LUCKNOW.

UPAVP

MANDAL	DEVIPATAN
DISTT.	GONDA
GATA NO.	142,144, 135
VILLAGE /MOHALLA	CIVIL LINES
AREA	12130.74 SQM.
RESIDENTIAL UNITS	528 UNITS
DRG. NO.	APP/UN-S/LOP-PMAY/GONDA-04/CIR-36D-2

NOTE:-

1. THIS LAY OUT PLAN FOR THE HOUSES UNDER PRIME MINISTER AVAS YOJNA HAS BEEN PREPARED ON THE BASIS OF ORDER GIVEN BY CHIEF ENGINEER IN SAMIKSHA BATHAK HELD IN HEAD OFFICE DATED 20.03.2017 AND UNIT DRAWING & SAMPLE L.O.P. PROVIDED BY प्रमुख अधिकारी, UTTAR PRADESH SHASAN VIDE HIS LETTER NO.- 18558-1-17-80V/VDH/2010 DATED 05.09.2017.

2. THIS LAY OUT PLAN FOR THE HOUSES UNDER PRIME MINISTER AVAS YOJNA HAS BEEN FINALISED ON THE BASIS OF FEASIBILITY RECEIVED BY E.I.C.D-02 VIDE HIS LETTER NO.-2058P-Y-244 DATED:14.08.2018.

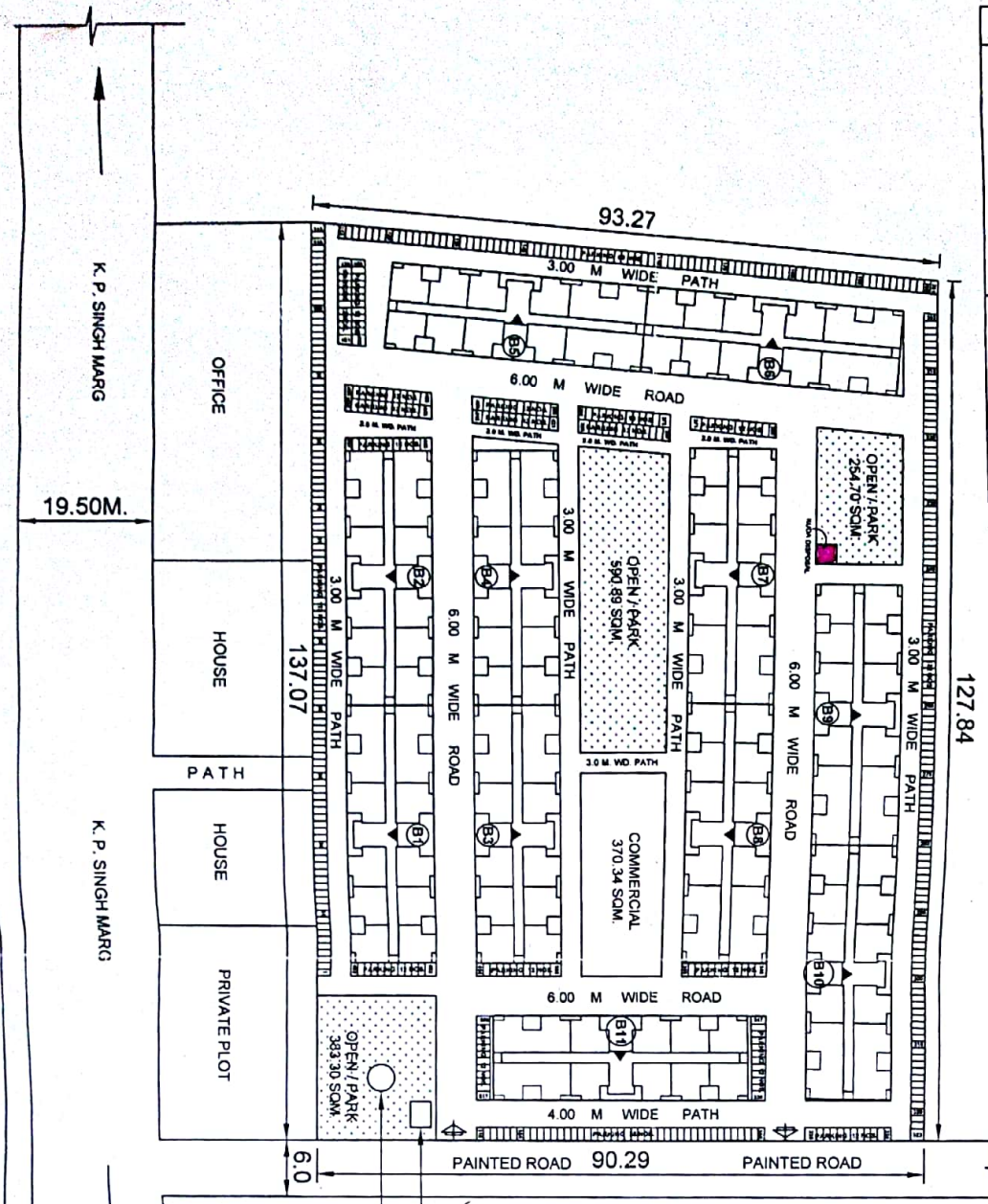

INDEX -

→ Proposed Solid Waste Disposal Point in Proj. PMAY GONDA

TO LUCKNOW - GONDA ROAD

PROPOSED LAYOUT PLAN OF HOUSES UNDER PRADHAN MANTRI AVAS YOJNA AT DISTT.- GONDA, UTTAR PRADESH	
DATE :	20.08.2018
SCALE :	NORTH
VIKAS SINGH	
D/MAN. (CIVIL)	
PRABHAVATI SURI	Prabhuwati Suri
ASSTT. ARCH. PLANNER	20/08/18
ARVIND DEO ARYA	
ARCHITECT PLANNER	
A.K. SHUKLA	
CHIEF ARCHITECT PLANNER	
AJAY CHAUHAN	
LAS AVAS AYUKT	