

LEGEND:-

S.NO.	SYMBOL	DESCRIPTION
1		PENDENT SPRINKLER
2		UPRIGHT SPRINKLER
3		SIDE WALL SPRINKLER
4		BRANCH PIPE
5		MAIN SPRINKLER PIPE
6		800Ø DRAIN PIPE
8		1500Ø SPRINKLER PIPE
9		1500Ø HYDRANT PIPE
10		1500Ø WATER CURTAIN PIPE
11		BUTTERFLY VALVE
12		TEST ASSEMBLY
13		FLOW SWITCH
14		FIRE HOSE CABINET

H A S T I N G S

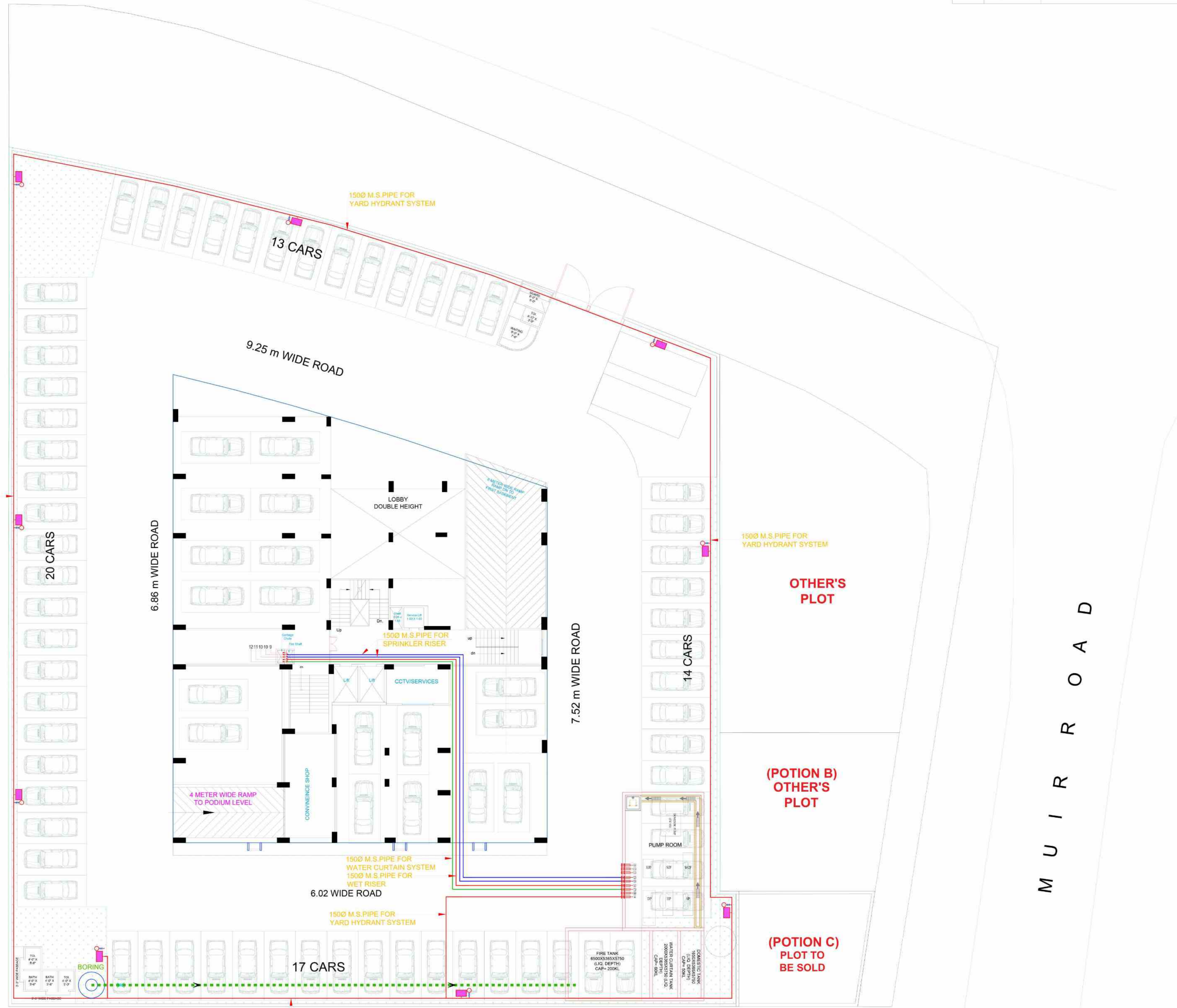

SITE/STILT FLOOR PLAN

SR.N.	UNDERGROUND WATER TANK	DIA	QTY.
1.	PUDDLE FLANGE FOR BORE WELL CONNECTION	150Ø	1 Nos.
2.	PUDDLE FLANGE FOR FIRE BRIGADE CONNECTION	150Ø	1 Nos.
3.	PUDDLE FLANGE FOR FIRE TANK SUCTION PIPE	200Ø	1 Nos.
4.	PUDDLE FLANGE FOR DRAIN OUT	80Ø	3 Nos.
5.	PUDDLE FLANGE FOR OVER FLOW TO PLANT ROOM	150Ø	1 Nos.
6.	PUDDLE FLANGE FOR VENT	80Ø	3 Nos.
7.	PUDDLE FLANGE FOR LEVEL CONTROLLER	50Ø	3 Nos.
8.	PUDDLE FLANGE FOR LEVEL INDICATOR (TOP)	50Ø	3 Nos.
9.	PUDDLE FLANGE FOR LEVEL INDICATOR (BOTTOM)	50Ø	3 Nos.
10.	OVER FLOW PIPE FIRE TANK TO TANK	150Ø	4 Nos.
11.	PUDDLE FLANGE FOR DOMESTIC SUCTION PIPE	100Ø	1 Nos.
12.	PUDDLE FLANGE FOR SUMP DISCHARGE PIPE	100Ø	1 Nos.
13.	PUDDLE FLANGE FOR DOMESTIC PUMP PIPE	100Ø	1 Nos.
14.	PUDDLE FLANGE FOR HYDRANT PIPE	150Ø	2 Nos.
15.	PUDDLE FLANGE FOR SPRINKLER PIPE	150Ø	2 Nos.
16.	PUDDLE FLANGE FOR WATER CURTAIN PUMP SUCTION	200Ø	1 Nos.
17.	PUDDLE FLANGE FOR WATER CURTAIN	150Ø	1 Nos.
18.	PUDDLE FLANGE FOR SPARE	150Ø	1 Nos.

SR.N.	LEGENDS	DESCRIPTION
1.	HJP	HYDRANT JOCKEY PUMP
2.	HP	HYDRANT PUMP
3.	DP	DIESEL DRIVEN PUMP
4.	SJP	SPRINKLER JOCKEY PUMP
5.	SP	SPRINKLER PUMP
6.	WCP	WATER CURTAIN PUMP

FIRE EXTINGUISHERS COMPRISING OF

- a) 4.5 Kg. Co2 type fire extinguishers I.S.I marked.
- b) 6 Kg. A.B.C. type fire extinguishers I.S.I marked.

(Gas pressure) fire extinguishers complete with bracket, Bolts and initial charge as per IS 2190 (2010)

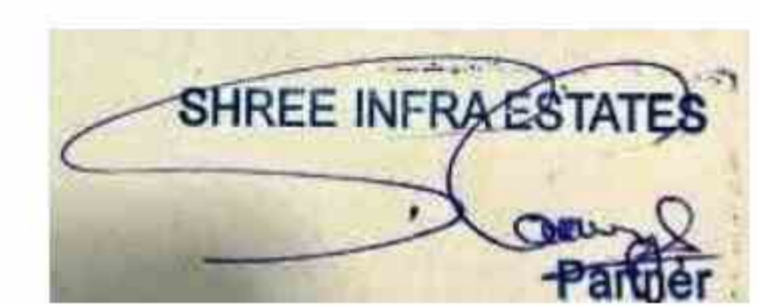

ADVANCE COPY FOR RERA SUBMISSION

PROJECT:- PROPOSED APARTMENT BUILDING AT PRAYAGRAJ	OWNER:- MR. RAJESH AGARWAL	BUILDING:- RESIDENTIAL BUILDING	DRAWING TITLE:- LAY-OUT PLAN (FIRE FIGHTING SYSTEM)	Drg. No. RABPRG/SEP/02	Scale A1-100	ARCHITECTURAL CONSULTANTS:- MANISH GUJRAL (B. Arch, F.I.V.) TARANA NASEER (B.Arch, M.Plan)	Services Consultant: SHAH & PANT CONSULTING ENGINEERS (P) LTD.
				Date DEC./2025		Architects and Interior Designers 52/ 25 B MUIR ROAD, ALLAHABAD	

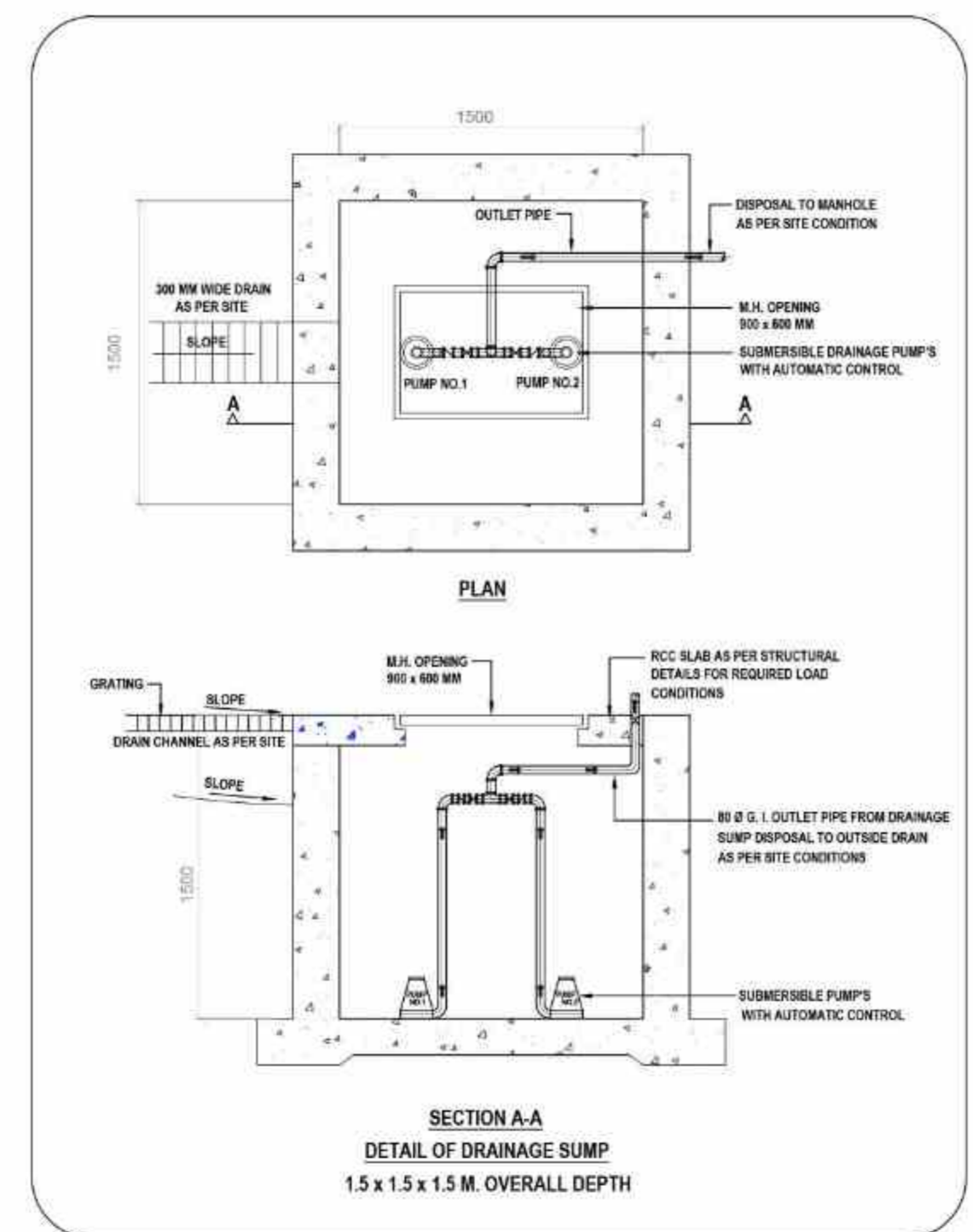
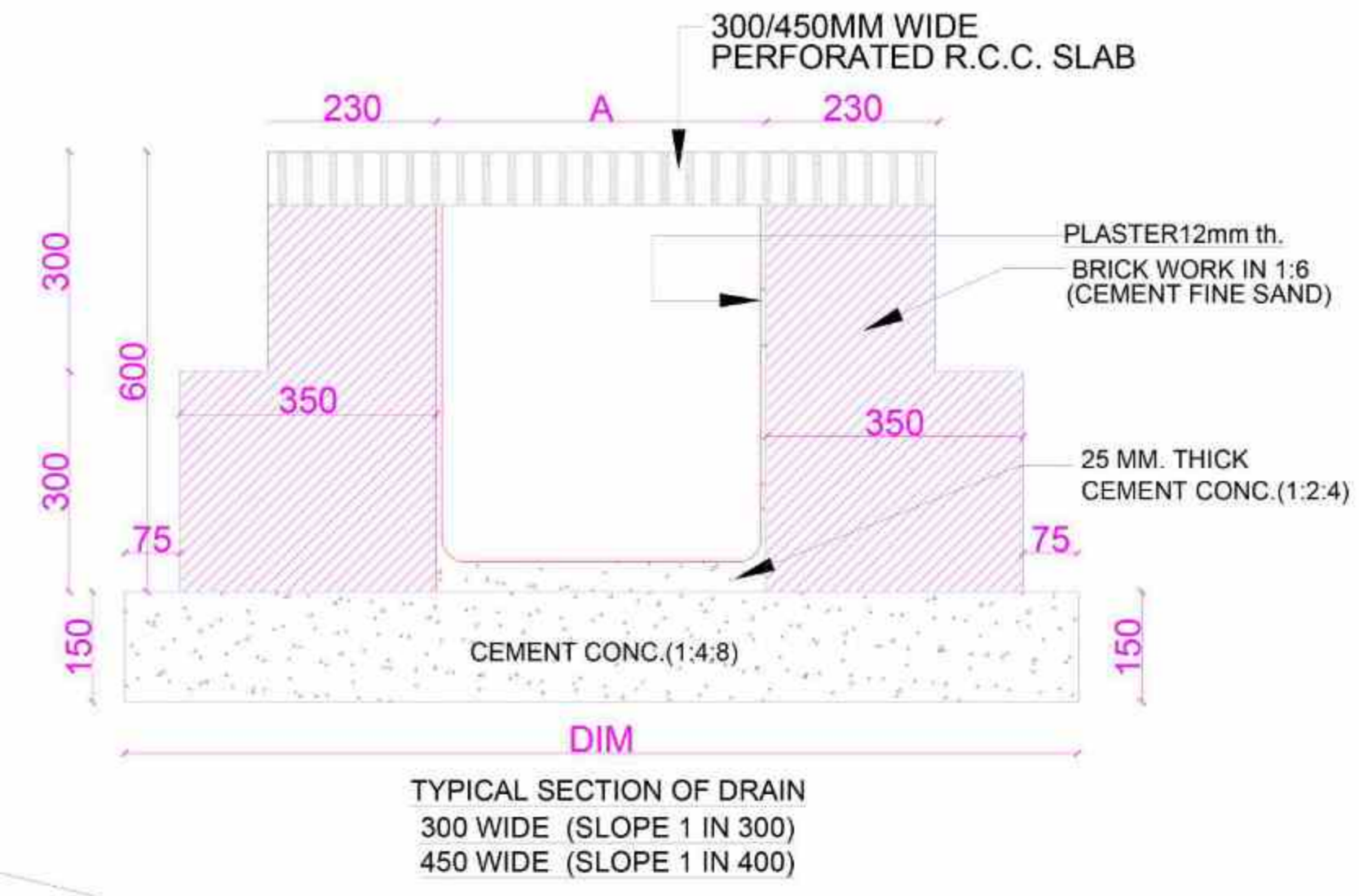

PHE LEGEND	
SYMBOL	DESCRIPTION
(S)	1100 uPVC PIPE FOR SOIL AND VENT
(W)	1100 uPVC PIPE FOR WASTE AND VENT
(R)	1100 uPVC RAIN WATER PIPE
(D)	CPVC PIPE FOR DOMESTIC DOWNTAKE
(F)	CPVC PIPE FOR FLUSHING DOWNTAKE
(Hs)	CPVC PIPE FOR SOLAR DOWNTAKE
(Hr)	CPVC PIPE FOR SOLAR RETURN DOWNTAKE
(Q1)	G.I. PIPE FOR DOMESTIC TANK FILLING
(Q2)	G.I. PIPE FOR FLUSHING TANK FILLING
(M)	MOTORIZED BUTTERFLY VALVES
(H)	HOT WATER SUPPLY (GEYSER)
(R)	HOT WATER RETURN
(D)	DOMESTIC WATER SUPPLY PIPE
(F)	FLUSHING WATER SUPPLY PIPE
(H)	SOLAR HOT WATER SUPPLY PIPE
(W)	320/500 uPVC. WASTE PIPE
(S)	SOIL WATER PIPE
(W)	WASTE WATER PIPE
(R)	RAIN WATER PIPE
(F.T.)	FLOOR TRAP (110X75)
(C.O.P.)	CLEAN OUT PLUG
(S.W.P.)	STONEWARE PIPE (S.W. PIPE)
(KH)	450X450 KHURRA
(GT)	300X300 GULLY TRAP
(M.H. 600)	600X600 MAN HOLE
(M.H. 900)	900X800 MAN HOLE

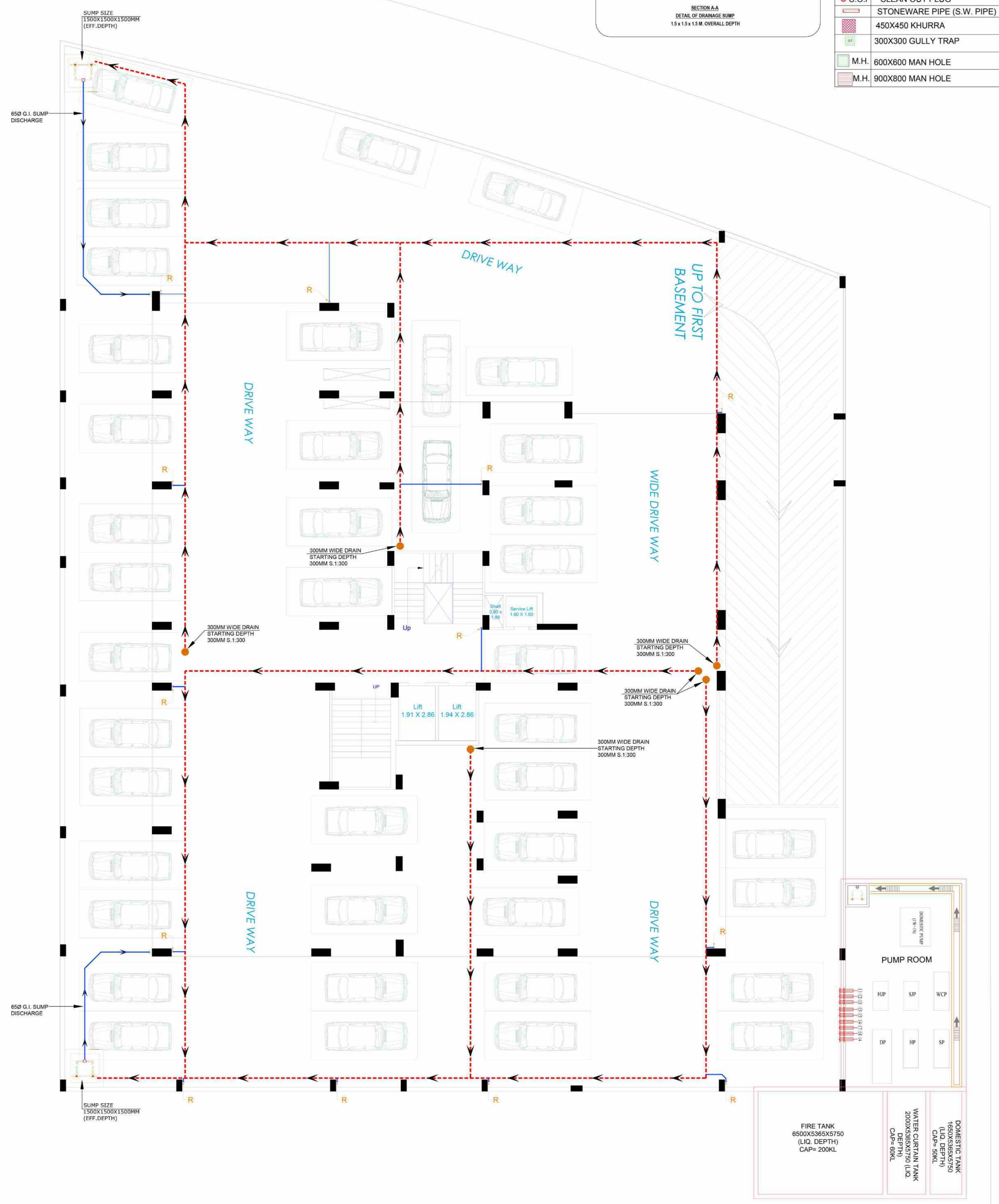

SECOND BASEMENT FLOOR PLAN

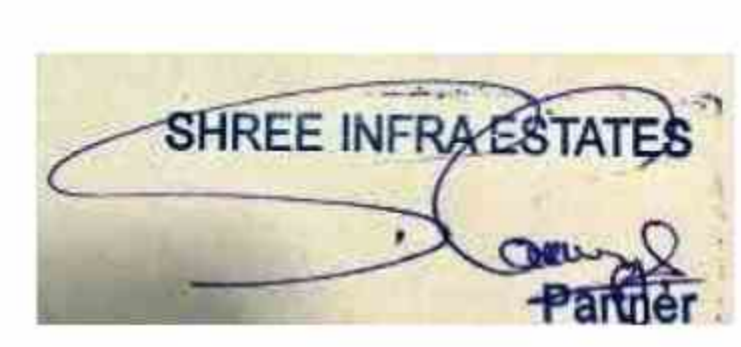

ADVANCE COPY FOR RERA SUBMISSION

PROJECT:- PROPOSED APARTMENT BUILDING AT PRAYAGRAJ	OWNER:- MR. RAJESH AGARWAL	BUILDING:- RESIDENTIAL BUILDING	DRAWING TITLE:- SECOND BASEMENT FLOOR PLAN (DRAINAGE SYSTEM)	Drg. No. RABPRG/SEP/03 Scale A1-100 Date DEC./2025	ARCHITECTURAL CONSULTANTS :- MANISH GUJRAL (B. Arch, F.I.V.) TARANA NASEER (B.Arch, M. Plan) Architects and Interior Designers 52/ 25 B MUIR ROAD, ALLAHABAD	Services Consultant: SHAH & PANT CONSULTING ENGINEERS (P) LTD. 1-48 Floor, BAL WASTYA COURT, BALAPUR, GATE-11, CHANDER NAGAR Tel: No. 0522-229621, 0522-229623, 0522-229624, 0522-229625, 0522-229626 Email: shah_pant@yahoo.co.in, Web: www.shahpantconsultingengineers.com
---	-------------------------------	------------------------------------	---	---	--	--

HASTINGS

SYMBOL	DESCRIPTION
(S)	1100 uPVC PIPE FOR SOIL AND VENT
(W)	1100 uPVC PIPE FOR WASTE AND VENT
(R)	1100 uPVC RAIN WATER PIPE
(D)	CPVC PIPE FOR DOMESTIC DOWNTAKE
(F)	CPVC PIPE FOR FLUSHING DOWNTAKE
(H)	CPVC PIPE FOR SOLAR DOWNTAKE
(H)	CPVC PIPE FOR SOLAR RETURN DOWNTAKE
(G)	G.I PIPE FOR DOMESTIC TANK FILLING
(G)	G.I PIPE FOR FLUSHING TANK FILLING
(M)	MOTORIZED BUTTERFLY VALVES
(H)	HOT WATER SUPPLY (GEYSER)
(H)	HOT WATER RETURN
(D)	DOMESTIC WATER SUPPLY PIPE
(F)	FLUSHING WATER SUPPLY PIPE
(H)	SOLAR HOT WATER SUPPLY PIPE
(W)	320/500 uPVC WASTE PIPE
(S)	SOIL WATER PIPE
(W)	WASTE WATER PIPE
(R)	RAIN WATER PIPE
(F.T.)	FLOOR TRAP (110X75)
(C.O.P.)	CLEAN OUT PLUG
(S.W.P.)	STONEWARE PIPE (S.W. PIPE)
(450X450)	450X450 KHURRA
(300X300)	300X300 GULLY TRAP
(M.H. 600X800)	M.H. 600X800 MAN HOLE
(M.H. 900X800)	M.H. 900X800 MAN HOLE

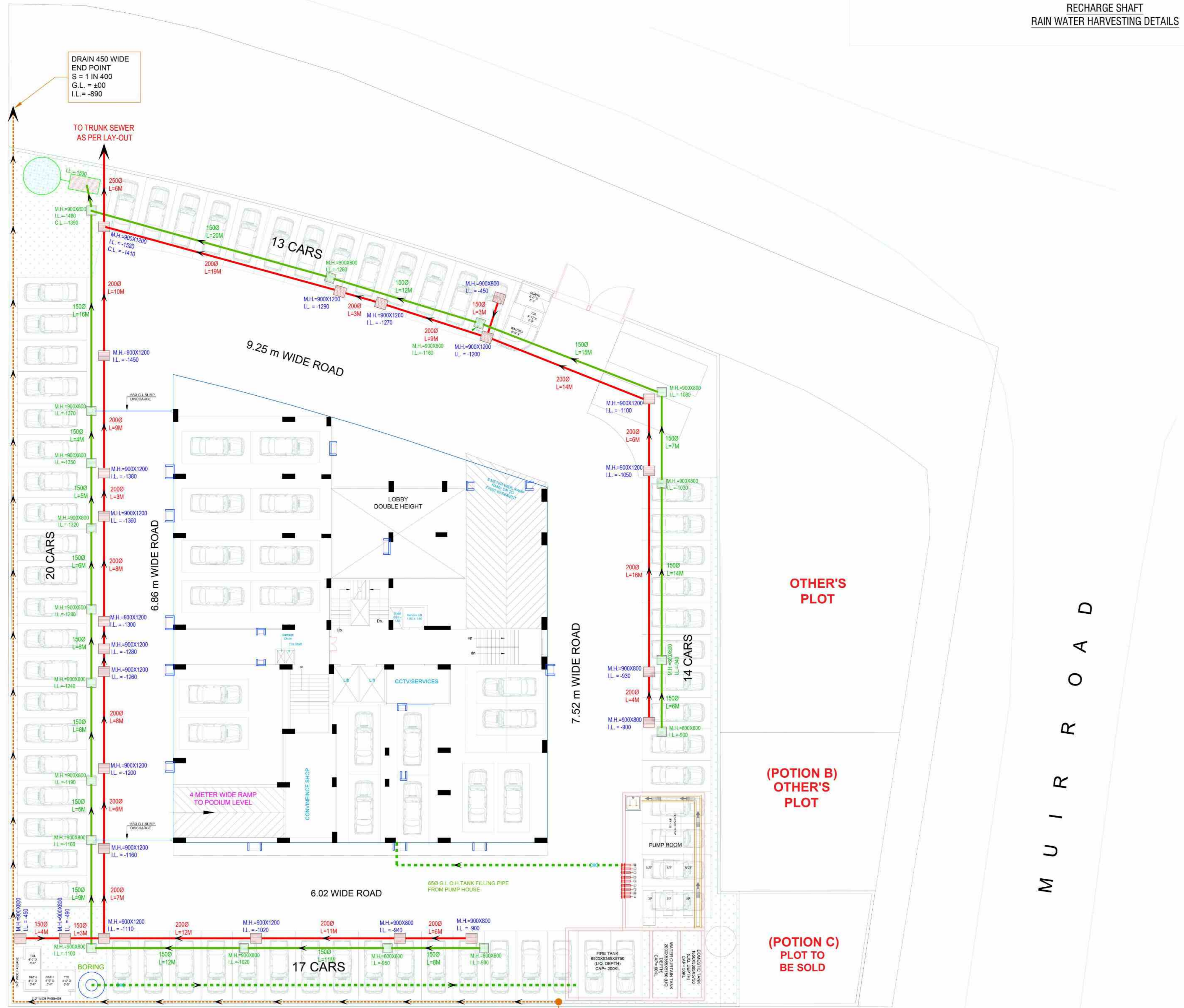
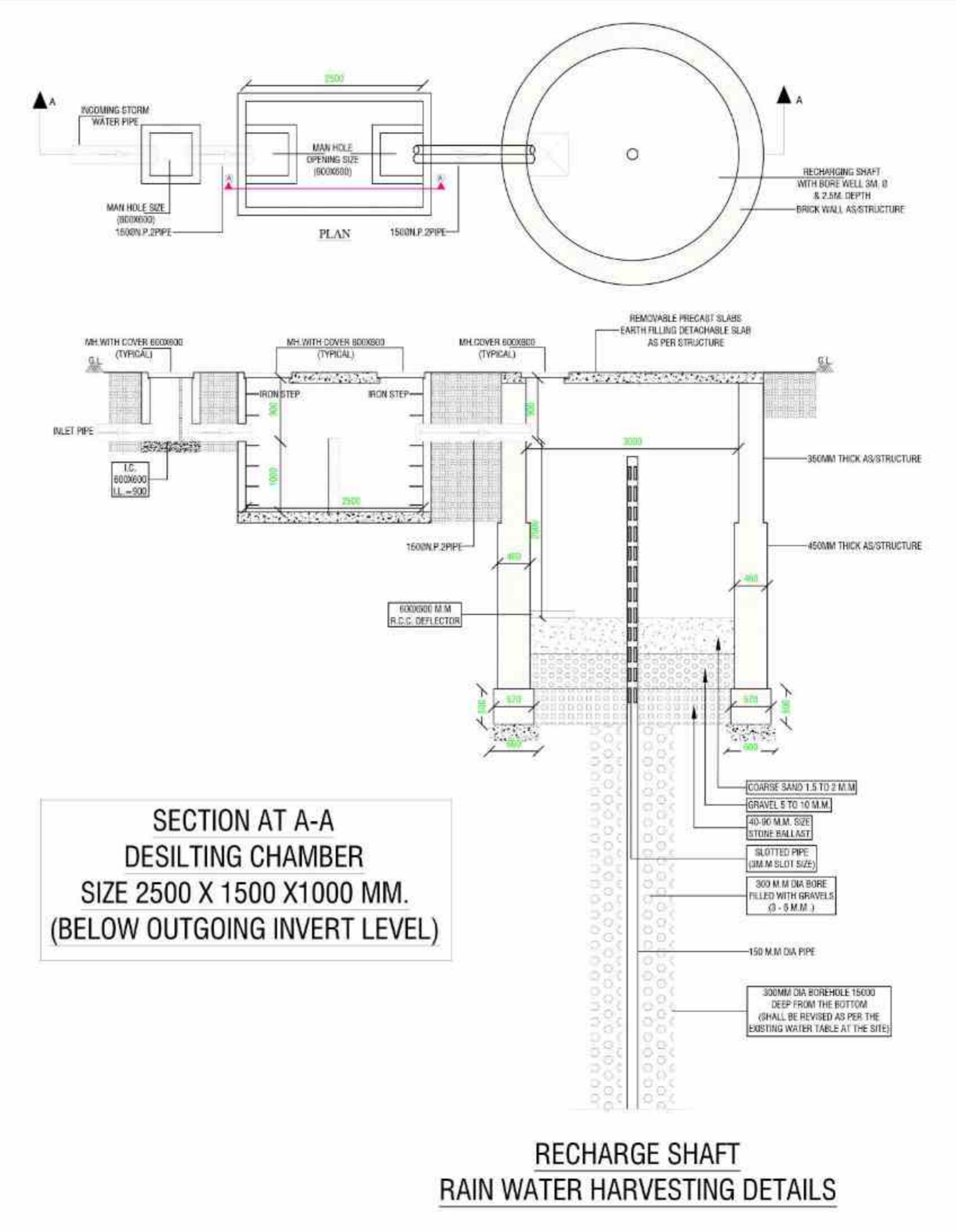

SITE/STILT FLOOR PLAN

- | | | |
|--|---|---|
| <p>NOTES- SEWERAGE</p> <ol style="list-style-type: none"> ALL DIMENSIONS ARE IN MILLIMETER UNLESS NOTED OTHERWISE. FOR PIPES SIZE, SLOPES, LEVELS ETC. REFER DRAWINGS. ANY DISCREPANCY IN THE DRAWING SHALL BE BROUGHT TO THE NOTICE OF THE ARCHITECTS/CONSULTANTS. ALL PIPES SHALL BE N.P.2. PIPES GRADE 'A' JOINED IN PROPORTION OF 1:1 WITH CEMENT CONCRETE BEDDING & CRADLE. SEWER LINE LAYOUT IS INDICATIVE SEWER SHALL BE LAID ALIGNED AS PER ACTUAL ROAD SECTION AND LEVEL. THIS DRAWING SHOULD BE READ IN CONJUNCTION AND OTHER RELEVANT ARCHITECTURAL, STRUCTURAL AND OTHER SERVICES DRAWINGS. SEWER LINE SHALL BE CONSTRUCTED AS PER DETAIL. MAN HOLE SIZE SHALL BE AS FOLLOWS -
 (i) 900X800 UP TO 1.00 M. DEPTH
 (ii) 900X1200 UP TO 2.00 M. DEPTH
 (iii) 1500 DIA UP TO 3.00 M. DEPTH PIPE SHALL BE LAID OF FOLLOWING SLOPES-
 (i) 150 Ø N.P.2 - 1 IN 100
 (ii) 200 Ø N.P.2 - 1 IN 135
 (iii) 250 Ø N.P.2 - 1 IN 190
 (iv) 300 Ø N.P.2 - 1 IN 250 | <p>NOTES- DRAINAGE</p> <ol style="list-style-type: none"> ALL DIMENSIONS ARE IN MILLI METER UNLESS MENTIONED OTHERWISE. FOR PIPES/ DRAINS SIZE, SLOPES, LEVELS LENGTH REFER DRAWINGS. PIPES SHALL BE CONSTRUCTED AS PER DETAIL. DRAINAGE PIPES LAYOUT IS INDICATIVE PIPES SHALL BE LAID AND ALIGNED AS PER ACTUAL ROAD SECTION AND LEVEL. THIS DRAWING SHOULD BE READ IN CONJUNCTION AND OTHER RELEVANT ARCHITECTURAL, STRUCTURAL AND OTHER SERVICES DRAWINGS. ALL CONNECTION LEVELS AND SIZE OF LINES MUST BE CHECKED WITH THE EXISTING LEVELS AND CONFORMED FOR THE FEASIBILITY BEFORE STARTING THE EXECUTION. ALL PIPES SHALL BE N.P.2. PIPES GRADE 'A' JOINED IN PROPORTION OF 1:1 WITH CEMENT CONCRETE BEDDING & CRADLE. THE SIZE OF CHAMBER SHALL BE 600X800 MM. FOR CARRYING RAIN WATER DISCHARGE. ALL RAIN WATER PITS SHALL HAVE OVER FLOW PIPE 150 MM. DIA. WHICH SHALL BE CONNECTED TO THE SURFACE DRAIN. | <p>NOTES- WATER SUPPLY</p> <ol style="list-style-type: none"> ALL DIMENSIONS ARE IN MILLIMETER UNLESS NOTED OTHERWISE. FOR PIPES SIZE, SLOPES, LEVELS ETC. REFER DRAWINGS. ANY DISCREPANCY IN THE DRAWING SHALL BE BROUGHT TO THE NOTICE OF THE ARCHITECTS/CONSULTANTS. PIPES LAYOUT IS INDICATIVE PIPES SHALL BE LAID AND ALIGNED AS PER ACTUAL ROAD SECTION AND LEVEL. WATER SUPPLY MAINS SHALL BE LAID DEEP ENOUGH SO THAT A MINIMUM 750 MM. COVER IS AVAILABLE WHEN LAID UNDER FOOTPATH OR SOFT AREA AND 750 MM. WHEN LAID UNDER ROAD. THIS DRAWING SHOULD BE READ IN CONJUNCTION AND OTHER RELEVANT ARCHITECTURAL, STRUCTURAL AND OTHER SERVICES DRAWINGS. ALL WATER SUPPLY PIPES 80 MM. DIA AND BELOW SHALL BE CARRIED OUT WITH G.I. MEDIUM CLASS PIPE SUITABLE FOR SCREWED JOINTS & CONFORMING TO I.S.: 1259. ALL WATER SUPPLY PIPES ABOVE 80 MM. SHALL BE D.I. CLASS K-7 AS PER I.S. |
|--|---|---|

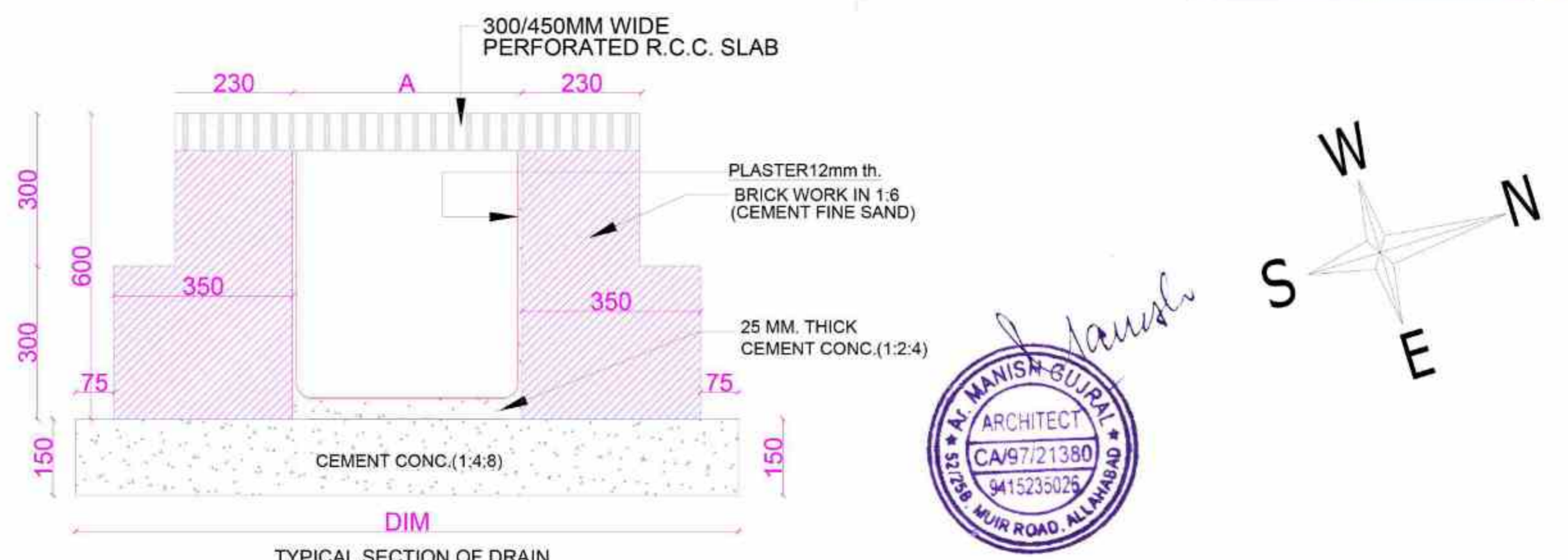

ADVANCE COPY FOR RERA SUBMISSION

PROJECT:- PROPOSED APARTMENT BUILDING AT PRAYAGRAJ	OWNER:- MR. RAJESH AGARWAL	BUILDING:- RESIDENTIAL BUILDING	DRAWING TITLE:- LAY-OUT PLAN (PLUMBING SERVICES)	Drg. No. RABPRG/SEP/01	Scale A1-100	ARCHITECTURAL CONSULTANTS :- MANISH GUJRAL (B. Arch, F.I.V.) TARANA NASEER (B.Arch, M.Plan) Architects and Interior Designers	Services Consultant :- SHAH & PANT CONSULTING ENGINEERS (P) LTD.
				Date DEC/2025		52/ 25 B MUIR ROAD, ALLAHABAD	

SHREE INFRAESTATES Partner

MANISH GUJRAL ARCHITECT CA/97/2/1380 9415230252

