

GROUND FLOOR ELECTRICAL PLAN

ELECTRICAL LEGEND :-

S.NO.	SYMBOL	DESCRIPTION
1		6A ONE WAY 7PIN SWITCH BOARD
2		CEILING LIGHT
3		1x100W EXHAUST FAN
4		6A 5PIN SWITCH & SOCKET
5		16A SWITCH & SOCKET
6		FLOOD LIGHT
7		CEILING LIGHT
8		DISTRIBUTION BOARD (DB)
9		1X18W BRACKET LIGHT

SPECIFICATION :-

- 1:4:8 P.C.C. IN FOUNDATION
- 1:2:4 R.C.C. IN SLAB, BEAM & LINTEL.
- 1st CLASS BRICK WORK IN FOUNDATION AND SUPAR STRUCTURE.
- 12MM THICK PLASTER IN (1:6) CEMENT SAND MORTAR.
- MARBLE CHIPS FLOORING.

AREA CHART :-		
	SQM.	%AGE
TOTAL PLOT AREA	602.00	
ROAD WIDENING AREA	11.5345	
REMAINING PLOT AREA	590.4655	100.00
GROUND FLOOR COVERED AREA	290.18	
PROJECTION COVERED AREA	56.13	

LEGEND :-

- PROPOSED CONSTRUCTION
- DRAINAGE LINE

PROPOSED PLAN FOR "URBAN STREET"
 A COMMERCIAL BUILDING PLOT ON
 KHASRA NO.- 535 & OLD 1321, 1323
 NEW - 534
 MAUZA - MATHURA BANGAR, TEHS. &
 DIST - MATHURA

OWNER :-
 SHUBHAM LAXMI CREATIVE BUILDCON PVT. LTD

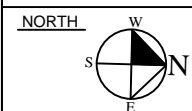

APPLICANT SIGN.

ARCHITECT:-
 Hridayam Design Inc.
 Investor Clinic Building, front of
 Highway Plaza Shopping Mall
 NH-2 Mathura (UP)
 Phone: +918755422111
 vipin.arch@gmail.com

ENGI SIGN.

SCALE :- NTS

DATE:-
 DRG NO.

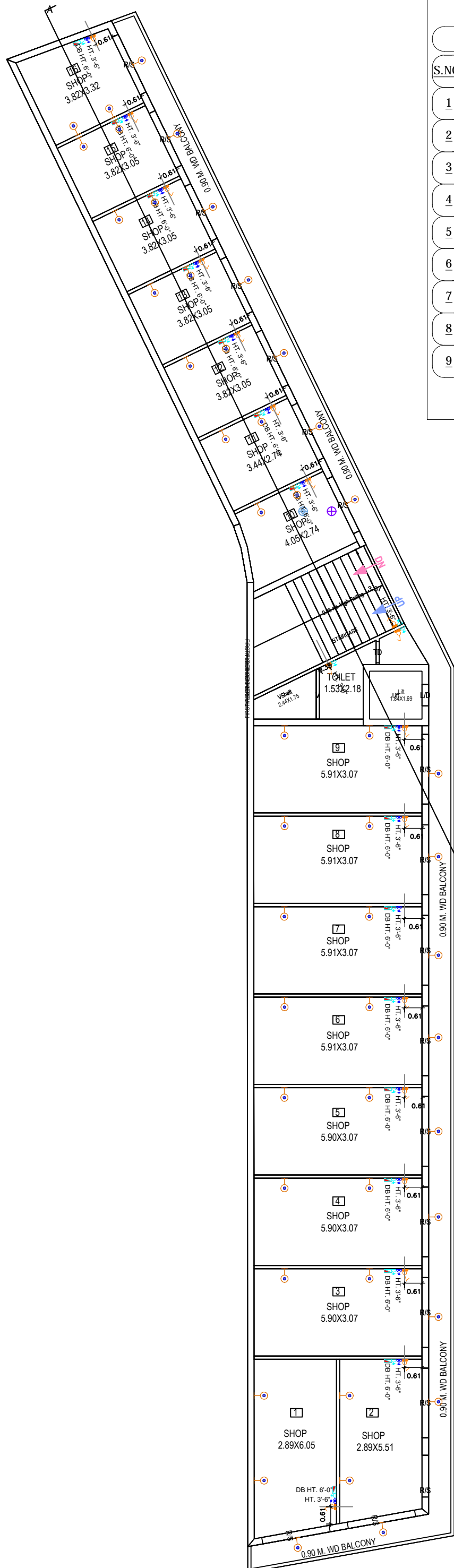

FIRST FLOOR ELECTRICAL PLAN

ELECTRICAL LEGEND :-

S.NO.	SYMBOL	DESCRIPTION
1		6A ONE WAY 7PIN SWITCH BOARD
2		CEILING LIGHT
3		1x100W EXHAUST FAN
4		6A 5PIN SWITCH & SOCKET
5		16A SWITCH & SOCKET
6		FLOOD LIGHT
7		CEILING LIGHT
8		DISTRIBUTION BOARD (DB)
9		1X18W BRACKET LIGHT

SPECIFICATION :-

- 1:4:8 P.C.C. IN FOUNDATION
- 1:2:4 R.C.C. IN SLAB , BEAM & LINTEL .
- 1st CLASS BRICK WORK IN FOUNDATION AND SUPAR STRUCTURE.
- 12MM THICK PLASTER IN (1:6) CEMENT SAND MORTAR.
- MARBLE CHIPS FLOORING.

AREA CHART :-

	SQM.	%AGE
TOTAL PLOT AREA	602.00	
ROAD WIDENING AREA	11.5345	
REMAINING PLOT AREA	590.4655	100.00
FIRST FLOOR COVERED AREA	290.18	
BALCONY AREA	56.13	

LEGEND :-

- PROPOSED CONSTRUCTION
- DRAINAGE LINE

**PROPOSED PLAN FOR "URBAN STREET"
A COMMERCIAL BUILDING PLOT ON
KHASRA NO.- 535 & OLD 1321, 1323
NEW - 534
MAUZA - MATHURA BANGAR, TEHS. &
DISTT - MATHURA**

OWNER :-

SHUBHAM LAXMI CREATIVE BUILDCON PVT. LTD

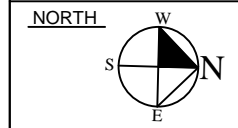

ARCHITECT:-
Hridyam Design Inc.
Investor Clinic Building,Front of
Highway Plaza Shopping Mall
NH-2 Mathura (UP)
Phone: +918755422111
vipin.arch@gmail.com,

APPLICANT SIGN.

ENGI SIGN.

SCALE :- NTS

DATE:-
DRG NO.

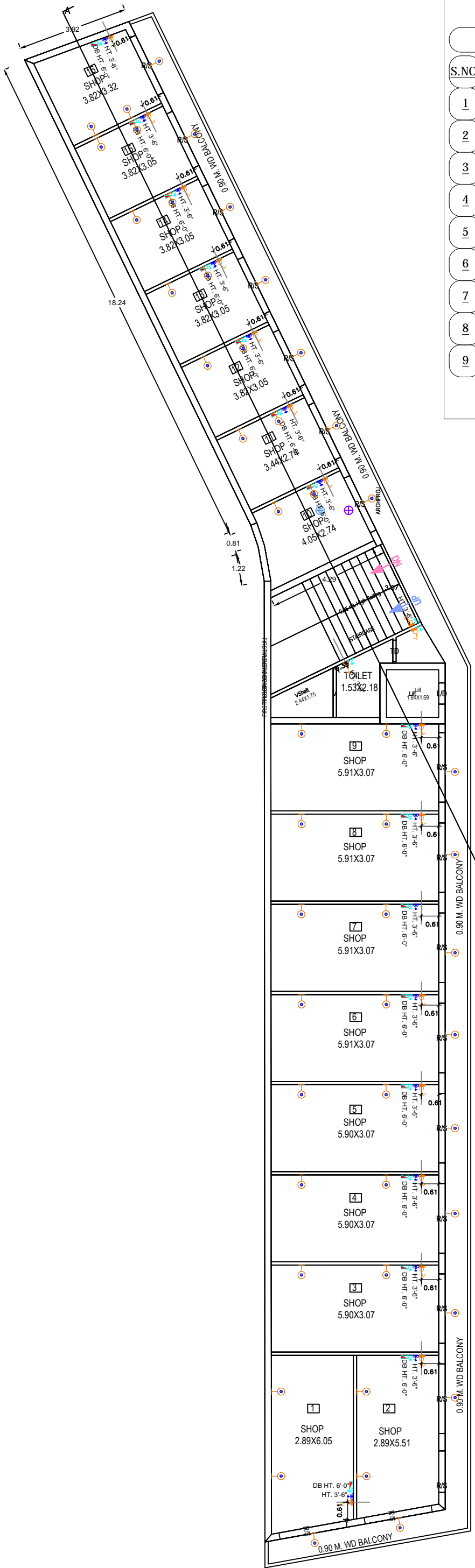

ELECTRICAL LEGEND :-

S.NO.	SYMBOL	DESCRIPTION
1		6A ONE WAY 7PIN SWITCH BOARD
2		CEILING LIGHT
3		1x100W EXHAUST FAN
4		6A 5PIN SWITCH & SOCKET
5		16A SWITCH & SOCKET
6		FLOOD LIGHT
7		CEILING LIGHT
8		DISTRIBUTION BOARD (DB)
9		1X18W BRACKET LIGHT

SPECIFICATION :-

- 1:4:8 P.C.C. IN FOUNDATION
- 1:2:4 R.C.C. IN SLAB , BEAM & LINTEL .
- 1st CLASS BRICK WORK IN FOUNDATION AND SUPAR STRUCTURE.
- 12MM THICK PLASTER IN (1:6) CEMENT SAND MORTAR.
- MARBLE CHIPS FLOORING.

AREA CHART :-	SQM.	%AGE
TOTAL PLOT AREA	602.00	
ROAD WIDENING AREA	11.5345	
REMAINING PLOT AREA	590.4655	100.00
SECOND FLOOR COVERED AREA	290.18	
BALCONY AREA	56.13	

LEGEND :-

- PROPOSED CONSTRUCTION
- DRAINAGE LINE

PROPOSED PLAN FOR "URBAN STREET"
A COMMERCIAL BUILDING PLOT ON
KHASRA NO.- 535 & OLD 1321, 1323
NEW - 534
MAUZA - MATHURA BANGAR, TEHS. &
DISTT - MATHURA

OWNER :-
 SHUBHAM LAXMI CREATIVE BUILDCON PVT. LTD

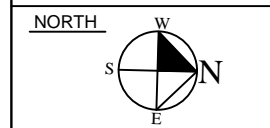

ARCHITECT:-
 Hridyam Design Inc.
 Investor Clinic Building, front of
 Highway Plaza Shopping Mall
 NH-2 Mathura (UP)
 Phone: +918755422111
 vipin.arch@gmail.com.

APPLICANT SIGN.

 ENGI SIGN.

 SCALE :- NTS
 DATE -
 DRG NO.

SECOND FLOOR ELECTRICAL PLAN

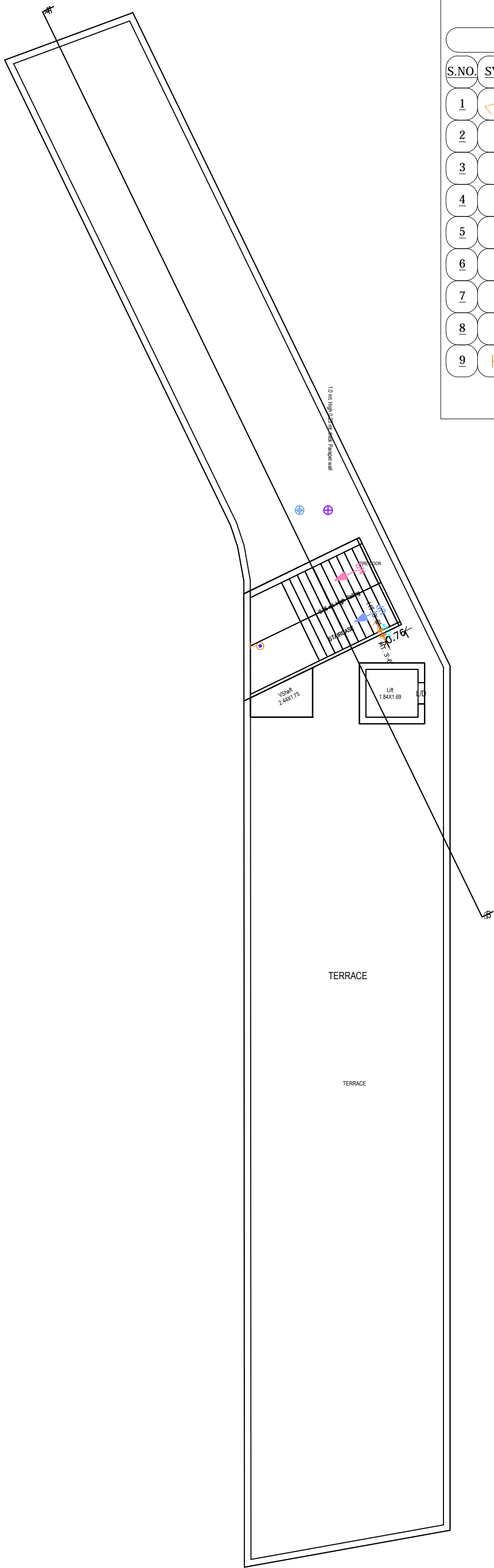

TERRACE FLOOR PLAN

ELECTRICAL LEGEND :-		
S.NO.	SYMBOL	DESCRIPTION
1		6A ONE WAY 7PIN SWITCH BOARD
2		CEILING LIGHT
3		1x100W EXHAUST FAN
4		6A 5PIN SWITCH & SOCKET
5		16A SWITCH & SOCKET
6		FLOOD LIGHT
7		CEILING LIGHT
8		DISTRIBUTION BOARD (DB)
9		1X18W BRACKET LIGHT

SPECIFICATION :-

- 1:4:8 P.C.C. IN FOUNDATION
- 1:2:4 R.C.C. IN SLAB , BEAM & LINTEL .
- 1st CLASS BRICK WORK IN FOUNDATION AND SUPAR STRUCTURE.
- 12MM THICK PLASTER IN (1:6) CEMENT SAND MORTAR.
6. MARBLE CHIPS FLOORING.

AREA CHART :-	SQM.	%AGE
TOTAL PLOT AREA	602.00	
ROAD WIDENING AREA	11.5345	
REMAINING PLOT AREA	590.4655	100.00
TERRACE FLOOR COVERED AREA	23.21	

LEGEND :-

PROPOSED CONSTRUCTION

DRAINAGE LINE

PROPOSED PLAN FOR "URBAN STREET"
A COMMERCIAL BULDING PLOT ON
KHASRA NO.- 535 & OLD 1321, 1323
NEW - 534
MAUZA - MATHURA BANGAR, TEHS. &
DISTT - MATHURA

OWNER :-
 SHUBHAM LAXMI CREATIVE BUILDCON PVT. LTD

<p>NORTH</p>	APPLICANT SIGN.
	<p>ARCHITECT:-</p> <p>Hridyam Design Inc. Investor Clinic Building,front of Highway Plaza Shopping Mall NH-2 Mathura (UP) Phone: +918755422111 vipin.arch@gmail.com,</p>
SCALE :- NTS	DATE- DRG NO.

ENGI SIGN.