

OTHER'S PLOT

38.50

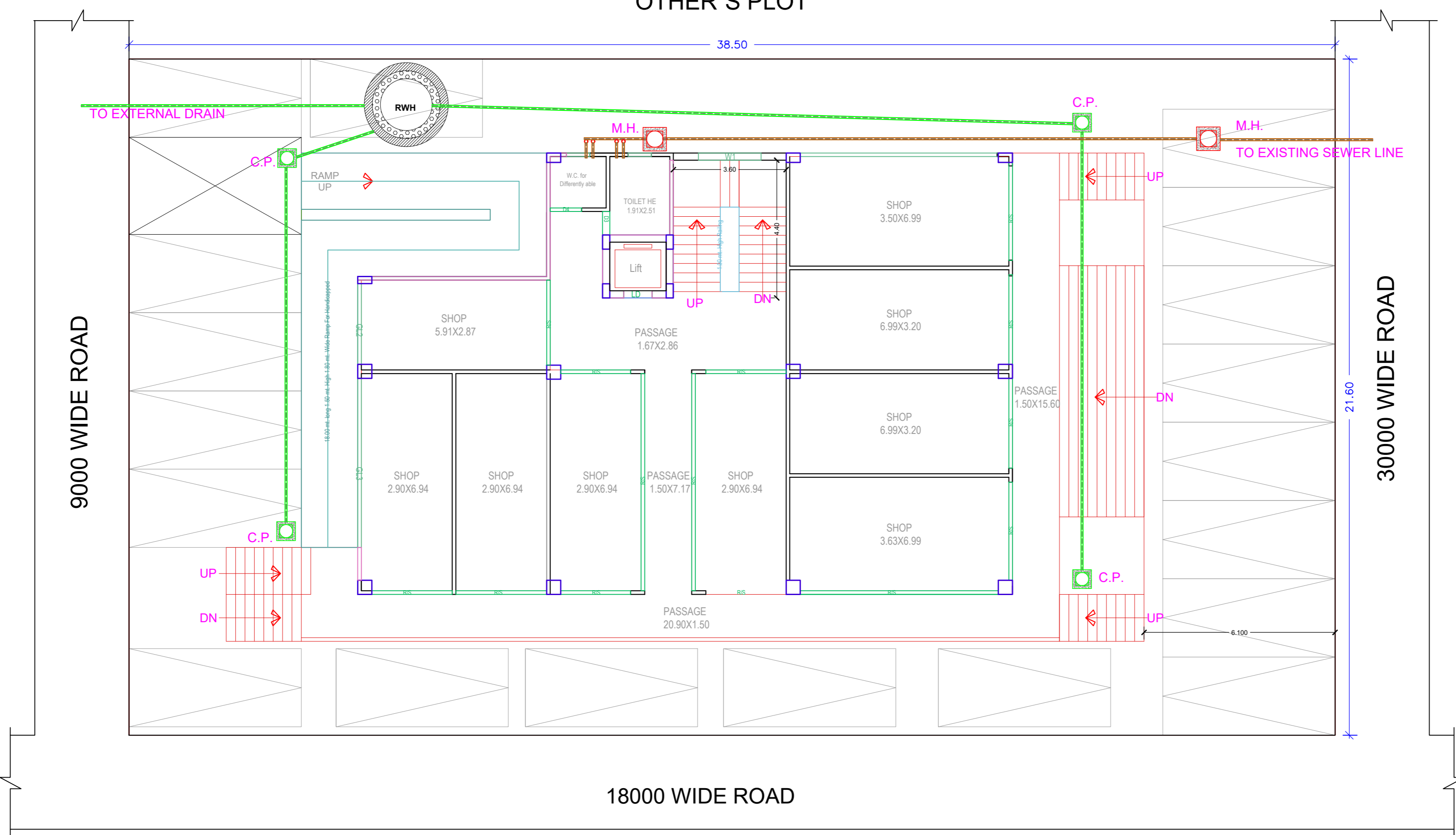

PROJECT
 PROPOSED COMMERCIAL BUILDING
 PLAN FOR Smt. SHAHJAHAN KHATOON &
 AZURE INFRATECH PVT. LTD.
 (DIRECTOR - Mr. BRIJ BEHARI LAL) AT
 PLOT NO.- 11/COM-103, SECTOR -11,
 VRINDAVAN YOJNA -3, LUCKNOW.

EXTERNAL PLUMBING PLAN

DATE	SCALE	REVISION	SHEET NO.
30/05/2024		R0	01
DRAWING NO.		SHEET SIZE	
FIRE-01			

NOTE
 1) ALL DIMENSIONS ARE IN MILLIMETERS
 2) NO DIMENSION TO BE SCALED FROM THE DRAWINGS WRITTEN DIMENSIONS TO BE FOLLOWED
 3) IN CASE OF DISCREPANCIES LARGE SCALE DETAILED DRAWINGS SHALL SUPERSEDE SMALLER SCALE DRAWINGS AND DISCREPANCIES IN THE DRAWINGS ARE TO BE BROUGHT OUT TO THE NOTICE OF THE ARCHITECT. IT IS GOT TO BE RECTIFIED BEFORE TENDERING.
 4) ALL SERVICES OWNS TO BE REFERRED ONLY FOR THE TECHNICAL CONTENTS CO-ORDINATED WORKING DRAWINGS TO BE FOLLOWED FOR ALL WORK AT SITE.
 5) ALL STRUCTURAL SIZES AND STRUCTURAL DETAILS TO BE REFERRED FROM DRAWINGS OF STRUCTURAL CONSULTANTS

THIS IS TO CERTIFY THAT PROPOSED
 BUILDING HAS BEEN PREPARED
 ACCORDING TO THE INFORMATION
 GIVEN BY THE OWNER AND BUILDING BYE LAWS .

architect's avenue
 D-2/122,Sambhav Tower,Vibhuti
 Khand Gomti Nagar,Lucknow,U.P.

ARCHITECT

OWNER

LEGEND:- (Plumbing)

S.No.	SYMBOL	DESCRIPTION
1		SEWER LINE
2		WASTE WATER LINE
3		RAIN WATER LINE
4		600X600 MAIN HOLE (FOR SEWER)
5		450X450 MAIN HOLE (FOR RAIN WATER)