

External Road

PRODUCED BY AN AUTODESK EDUCATIONAL PRODUCT

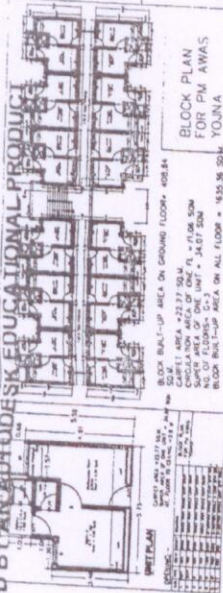

INDEX: - EXTERNAL ROAD PLAN

Scheme Boundary

**UPAVP**  
ARCHITECTURE AND PLANNING SECTION  
NEELGIRI COMPLEX, INDIRA NAGAR  
LUCKNOW - 226016  
Email : upavp@earthnet.in

ISO-9001:2000

LAYOUT PLAN PAVY  
SHEET NO.  
UPH06/APD/JUN-4/PMAY/C.D-11  
KANKAHA/109/2018

**NOTE :-**  
1. THIS LAYOUT PLAN HAS BEEN PREPARED ON THE BASIS OF INFORMATION RECEIVED FROM EX. EN. C.D.-11 VIDE HIS LETTER NO. 1865/M-724 DATED 24.08.2018.  
2. THIS LAY OUT PLAN HAS BEEN FINALIZED ON THE BASIS OF FEASIBILITY RECEIVED FROM EX. EN. C.D.- 11 VIDE HIS LETTER NO. 1982/M-716 DATED - 28.08.2018.  
3. प्रशासकीय आवास योजना के अर्तगत परिषद को दिये गये निश्चित लक्ष्य के सापेक्ष उक्त योजना में भवनों का निर्माण डिमाण्ड सर्वे के आधार पर कराया जाना है।

**AREA STATEMENT:-**  
TOTAL LAND AREA - 42120.95 SQM(4.2 Hect.  
COMMERCIAL AREA - 1839.62 SQ.MT.(4.32%)  
SCHOOL AREA - 1789.00 SQ.MT.(4.25%)  
GREEN AREA - 6391.78 SQ.MT. (15.17%)  
PARKING - 1352 NO.(2704.0 sq.m)  
@2sq.m flat as per norms  
BLOCK AREA - 408.84 Sqm.  
GROUND COVERAGE - 11,447.52 Sqm. 27.17%  
F. A. R. - 1.08

E.W.S. TYPE DESIGN  
UNIT CARPET AREA - 22.77 SQ.MT.  
SUPER AREA OF ONE FLAT - 34.07 SQ.MT.  
3676.00

TOTAL LAND AREA - 42120.95 SQ.MT.  
RESIDENTIAL:- TOTAL UNITS - 4344 432

PARTICULAR	NO. OF BLOCK	NO. OF UNIT IN EACH BLOCK	NO. OF FLOOR	TOTAL UNITS	UNIT AREA (SQ.MT)	SUPER AREA OF UNIT (SQ.MT)
E.W.S.	3	28	G+3	4344	22.77	34.07

ARCHITECTURE & PLANNING UNIT-4  
U.P. AVAS EVAM VIKAS PARISHAD LUCKNOW  
LAY-OUT PLAN OF PMAY  
MILL - KANKAHA, MOHAN LAL GANJ, LUCKNOW.

DATE : 31-08-2018

R. S. MAURYA  
BY ARCHT.  
ARCH. ASSTT.  
ALOK KUMAR VERMA  
B. ARCH. B. PLANNING  
ASSTT. ARCH. PLANNER  
SANJEEV KASHYAP  
B. ARCH. B. PLANNING  
ARCHITECT PLANNER  
A. K. SHUKLA

CHEF ARCHITECT PLANNER  
AJAY CHAUHAN  
I. A. S.

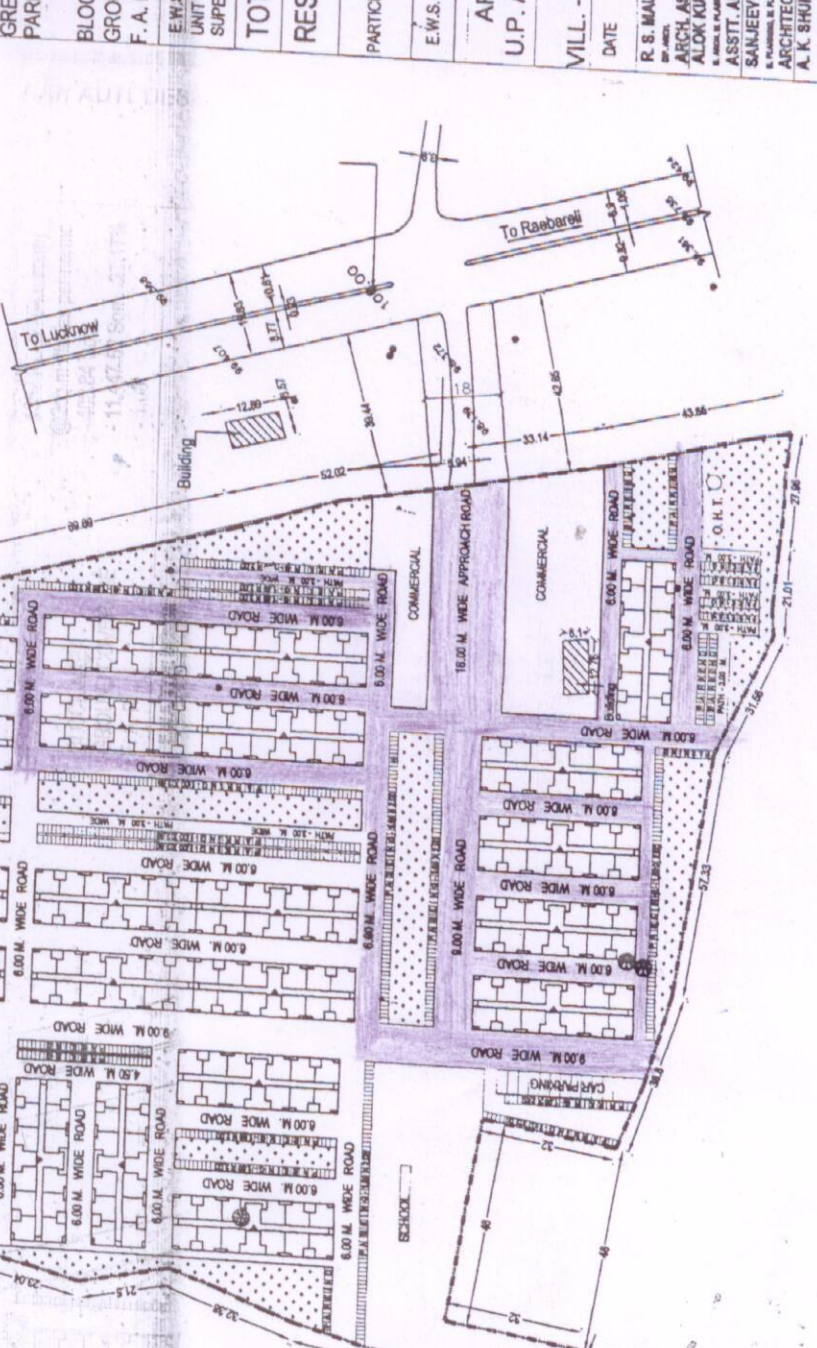

To Raebareilly  
To Lucknow