

PROJECT -IT/ITES project at Plot No. 5A, Sector Techzone, Greater Noida

WATER REQUIREMENT CALCULATIONS (SUBMISSION)

S.No.	Description	Built up Area (Sq.M)	Hortic ulture Water Requir ement per Sq.M Area	Unit Population	Total Popul ation	Domestic Fresh Water Requirement (A)		Recycle Water Requirement (B)		Total Water Requirement (A+B)	Flow to Sewer (80%)
						LPD	LPD	LPD	LPD		
1	IT Block:										
a.	Office Population (Tower-1)	57007.4		10 SqM/person	5710	25	142750	20	114200	256950	205560
b.	Office Population (Tower-2)	52737.2		10 SqM/person	5280	25	132000	20	105600	237600	190080
c.	Tower 2 MLCP area	25401.1		30 SqM/person	850						
c.	Floating Population (Office)			10% of above	1184	5	5920	10	11840	17760	14208
d.	Food Court (Tower-1)	1935		1.8 SqM/person	1080	25	27000	10	10800	37800	30240
2	Commercial Block A & B:										
a.	Population (Ground Floor) (Restaurant)	2377.76		1.8 SqM/person	1330						
b.	Population (Ground Floor) (Shopping)	570		3 SqM/person	190						
c.	Population (Upper Sales Floors) (Shopping)	1673.18		6 SqM/person	280						
d.	Population (Upper Sales Floors) (restaurant)	824.23		1.8 SqM/person	460						
e.	Permanent Population (Shopping and restaurant)			@ 10% of total population of Shopping	230	25	5750	20	4600	10350	8280
f.	Transient Population (Shopping and restaurant)			@ 90% of total population of Shopping	2030	5	10150	10	20300	30450	24360
3	AC Makeup Water								400000	400000	
4	Horticulture	16055	6						96330	96330	
		142526									
Total							3,23,570		7,63,670	10,87,240	4,72,728

SUMMARY OF WATER REQUIREMENT / UGT & STP CAPACITY CALCULATION

Description	Water Requirement (KLD)
Domestic Fresh Water Requirement (incl additional water requirement)	615
Recycle Water Requirement	764
Flow to Sewer	473
STP Capacity required	473
STP Capacity provided (by adding 20% as per MOEF)	567
STP Capacity rounded off	600 (to be provided in 2 moduels of 300 KLD each)
Additional fresh water required	291
UGT Capacity	
For Domestic Use (24 hrs storage)	610 KL
For Fire Fighting	400 KL
For Water Curtain	170 KL
Total UGT Capacity	1180 KL

LEGEND :

S.No.	SYMBOL	DESCRIPTION
1.		RECYCLED WATER SUPPLY PIPE LINE.
2.		RISING MAIN WATER PIPE LINE.
3.		MUNICIPAL WATER SUPPLY PIPE LINE.
4.		ISOLATING VALVE
5.		MASONRY CHAMBER FOR ISOLATING VALVE
6.		PROPOSED TUBE WELL / TANKER
7.		BASEMENT LINE
8.		GARDEN HYDRANT

LEGEND : FIRE SYSTEM

S. No.	SYMBOL	DESCRIPTION
1.		FIRE LINE
2.		YARD HYDRANT 63 M.M. DIA. SINGLE HEADED HYDRANT VALVE WITH 2 NOS. 15 M. LONG, 63 M.M. DIA. FIRE HOSE PIPE & 1 NO. BRANCH PIPE WITH NOZZLE
3.		FIRE BRIGADE CONNECTION
4.		BUTTERFLY VALVE
5.		NONRETURN VALVE (CHECK VALVE)
6.		ISOLATING VALVE WITH MASONRY CHAMBER

NOTE:
HT Meter Room size (4.5 x 4.5 Meter for 33 KV Supply) has been considered as required by the concerned Electrical Department.

OWNER
M/S. STAR LANDCRAFT PVT. LTD.

RELEASED FOR
SUBMISSION DRAWING

KEY PLAN :



PROJECT
PROPOSED IT/ITES BUILDING AT Plot No-5A, Sector-Techzone, Greater Noida

DATE
29.09.2025

DEALT BY
Ramesh Kumar

SCALE
1:600

CHECKED BY
Anand Havella

SITE PLAN
PLUMBING DRAWING

DRAWING TITLE
SITE PLAN
EXTERNAL WATER SUPPLY SYSTEM
ARCHITECT SIGN

architects
AEON DESIGN & DEVELOPMENT LLP
41, BLOCK A, FIRST FLOOR, INDUSTRIAL AREA, SECTOR-62, NOIDA, U.P. - 201301

services consultant
Cespl Consultants Pvt. Ltd.
B-67, Sector - 67, Noida - 201 301
Tel : (0120) 3225400 / 3225401
e mail : mail@cespl.in, website : www.cespl.in

DRAWING NO.
SITE/A/001/M.U. / EX / S-03

REVISION
R1

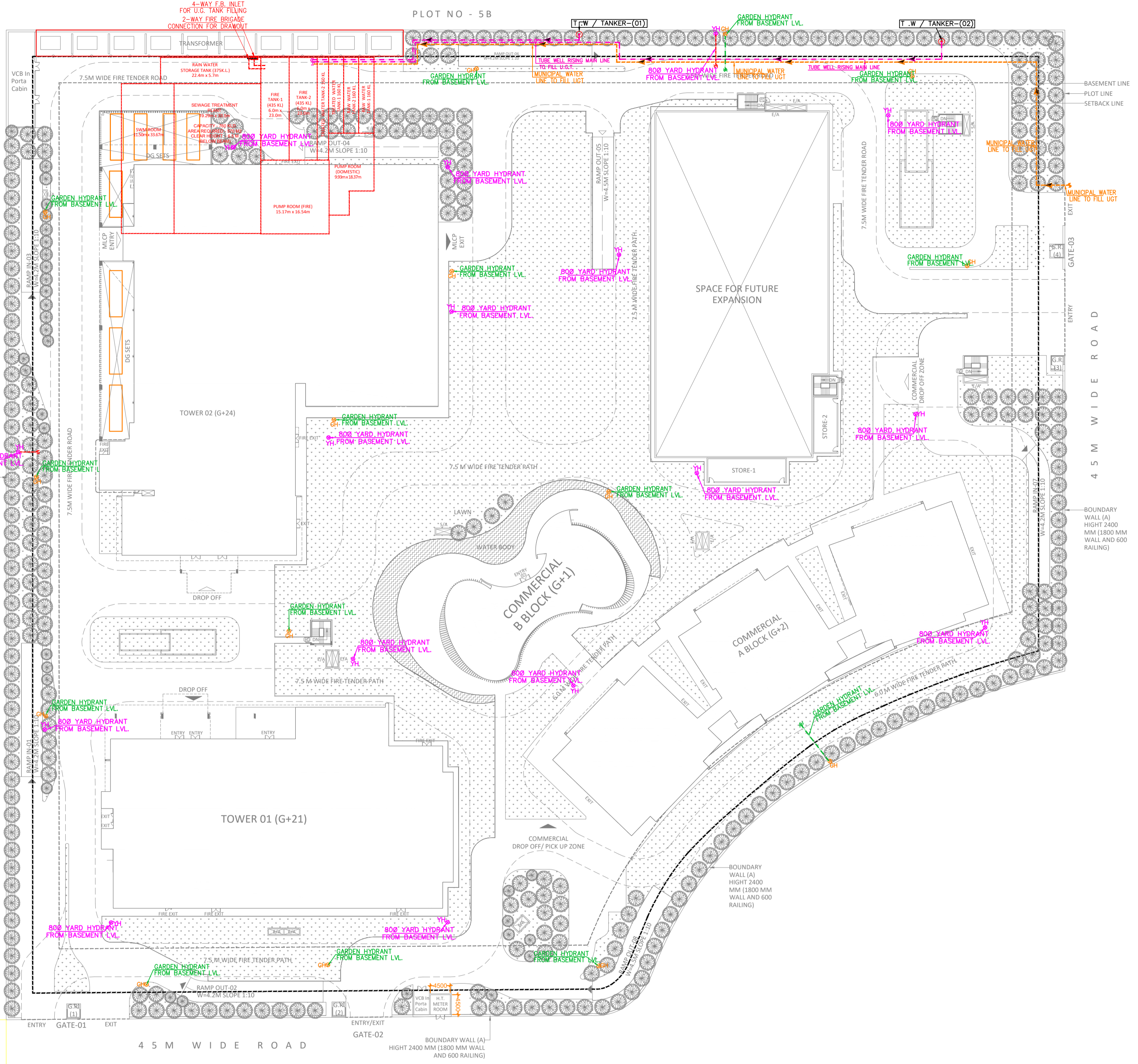

PLOT NO. - 5B

PLOT NO. - 5C

