

INDEX

FOR EXECUTION

SYMBOL	PARTICULAR.
	ROADS.
	PARKS

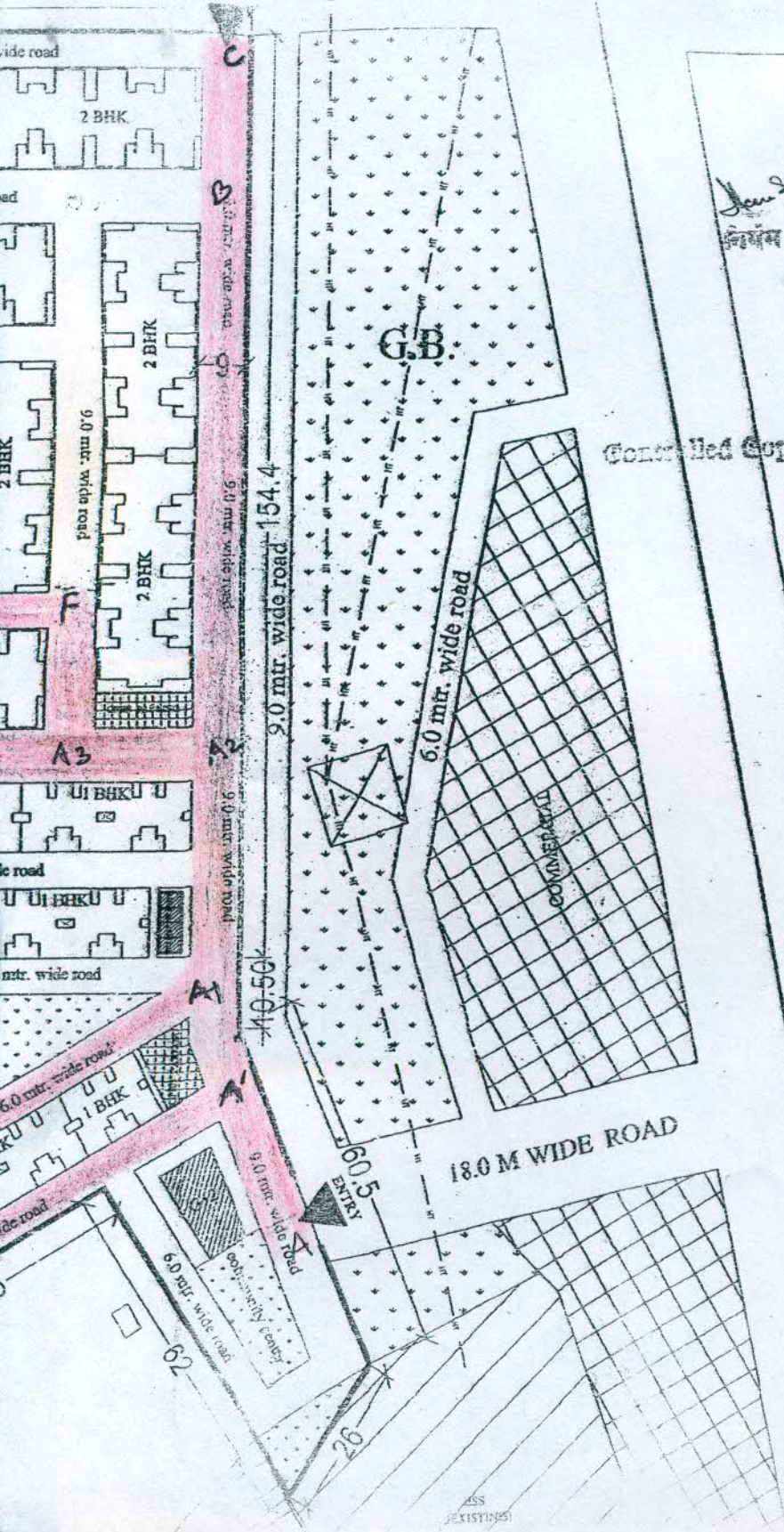

DATE: 30.11.2015
 FILE NO: DRG. NO. - APD/UN-2/MBD/Y-4/P2/SV5/01/50
 E-MAIL: apunit2@rediffmail.com

DATED: 30.11.2015
 FILE NO: DRG. NO. - APD/UN-2/MBD/Y-4/P2/SV5/01/50

NOTE:-
 1. ALL DIMENSIONS ARE IN METER.
 2. FIGURED DIMENSIONS SHALL BE FOLLOWED.
 3. ANY DISCREPANCY, IF FOUND IN THE DRAWING SHALL BE BROUGHT TO THE NOTICE OF A.P.UNIT-2, BEFORE EXECUTION OF WORK.
 4. THIS PART LAYOUT PLAN HAS BEEN PREPARED ON THE BASIS OF INFORMATION RECEIVED FROM E.E.CD.-25, MORADABAD, WIDE HIS LETTER 4660/25, DATED - 14.08.2015.
 5. DESIGN OF ONE BED ROOM FLAT DRG.NO.-MANDOLA VIHAR YOUNA, GZB (1BHK).
 6. DESIGN OF TWO BED ROOM FLAT DRG.NO.-MANDOLA VIHAR YOUNA, GZB (2BHK) UNDER CONSTRUCTION MANDOLA YOUNA IS USED AS SUGGESTED BY S.E./E.E.-25, MORADABAD.
 7. THIS PART LAYOUT PLAN HAS BEEN PREPARED ON THE BASIS OF FEASIBILITY RECEIVED FROM S.E.-CIR.-V, MORADABAD, WIDE HIS LETTER 1794/W-17/37, DATED - 16.10.2015 AND E.E.-CD.-25, WIDE HIS LETTER NO.2109/Y-M-2/28, DATED-23-11-15.

8+4 HOUSES
 HEIGHT = 14.85 METRS approx.
 AREA OF PLOT = 2760.48 M² = 6.82 ACRE
 F.A.R. = 1.25 approx.
 G.C.O.V. = 34.72 % approx.
 SET BACKS = 6 M, 6 M, 9 M, 9 M.

NO. OF UNITS	1 BHK	2BHK
1. ON FIRST FLOOR	72	112
2. ON SECOND FLOOR	72	112
3. ON THIRD FLOOR	72	112
4. ON FOURTH FLOOR	72	112
TOTAL NO. OF UNITS	288	448
TOTAL NO. OF UNITS ON ALL FLOORS (1BHK+2BHK)	736	

TOTAL GREEN / OPEN AREA = 9.8 % approx
 FACILITIES (sizes as per detail):
 COMMERCIAL SHOPS = 04 nos.
 COMMUNITY CENTER (G+2) = 01 no.
 PARKING :-
 REQUIRED STILT CAR PARKING = 224 nos.
 ACHIEVED STILT CAR PARKING = 2242 ECS
 REQUIRED 1 BHK PARKING AREA = 608 sqm.
 ACHIEVED 1 BHK PARKING AREA = 2595.87 sqm.

PART LAYOUT PLAN OF L.I.G. & E.W.S. FLATS AT PLOT NO. 9A/ GH-4 & 9A/ GH-3, BAUDDH VIHAR YOUNA NO.-4, PART-II (MANDOLA), MORADABAD.

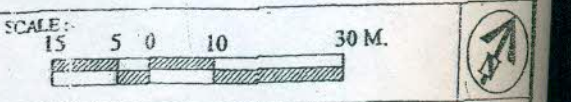

DEEP MALA
 ARCH ASST-1
 HEMA SHAH
 ASST. ARCHITECT PLAN 3/F
 GOPAL BARG
 ARCHITECT PLANNER
 R. P. SINGH

Handwritten notes: *How side 11/15*, *CC*, *01/11/15*

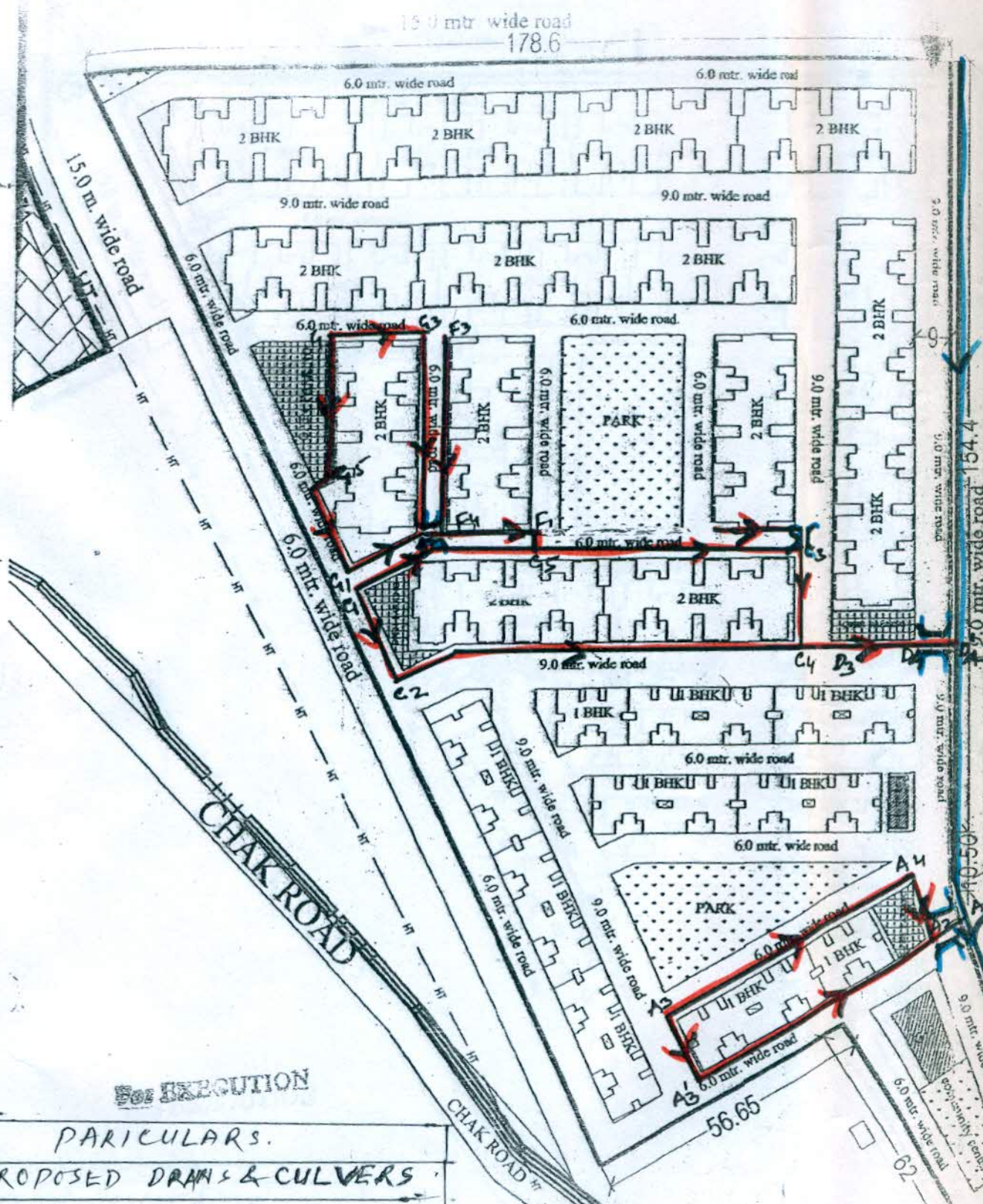

INDEX

FOR EXECUTION

SYMBOL	PARTICULARS.
	PROPOSED DRAINS & CULVERS
	OLD DRAINS

JE

AE

EE

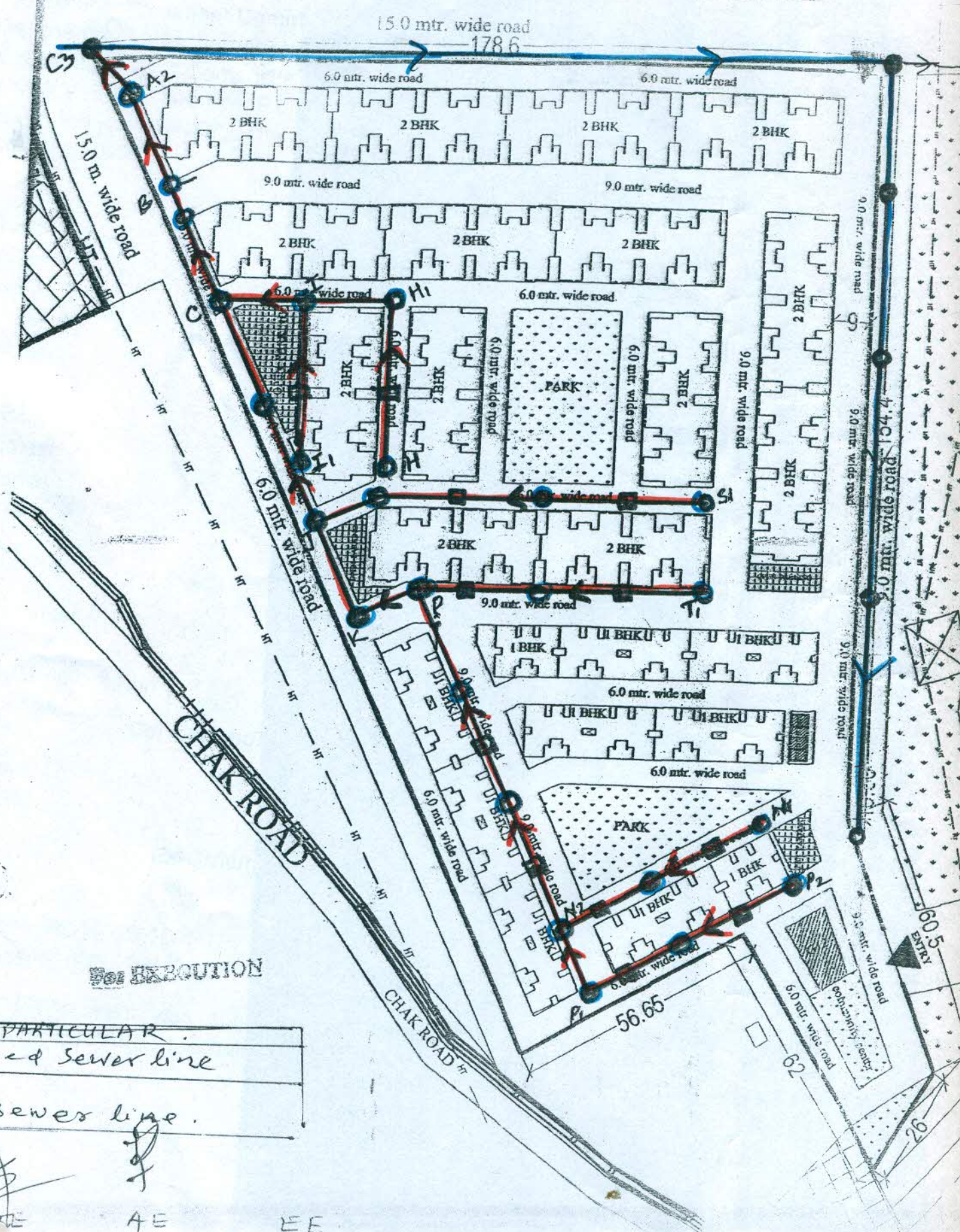

FOR EXECUTION

INDEX	PARTICULAR
	Proposed sewer line
	old sewer line

AE AE EE

1684
169

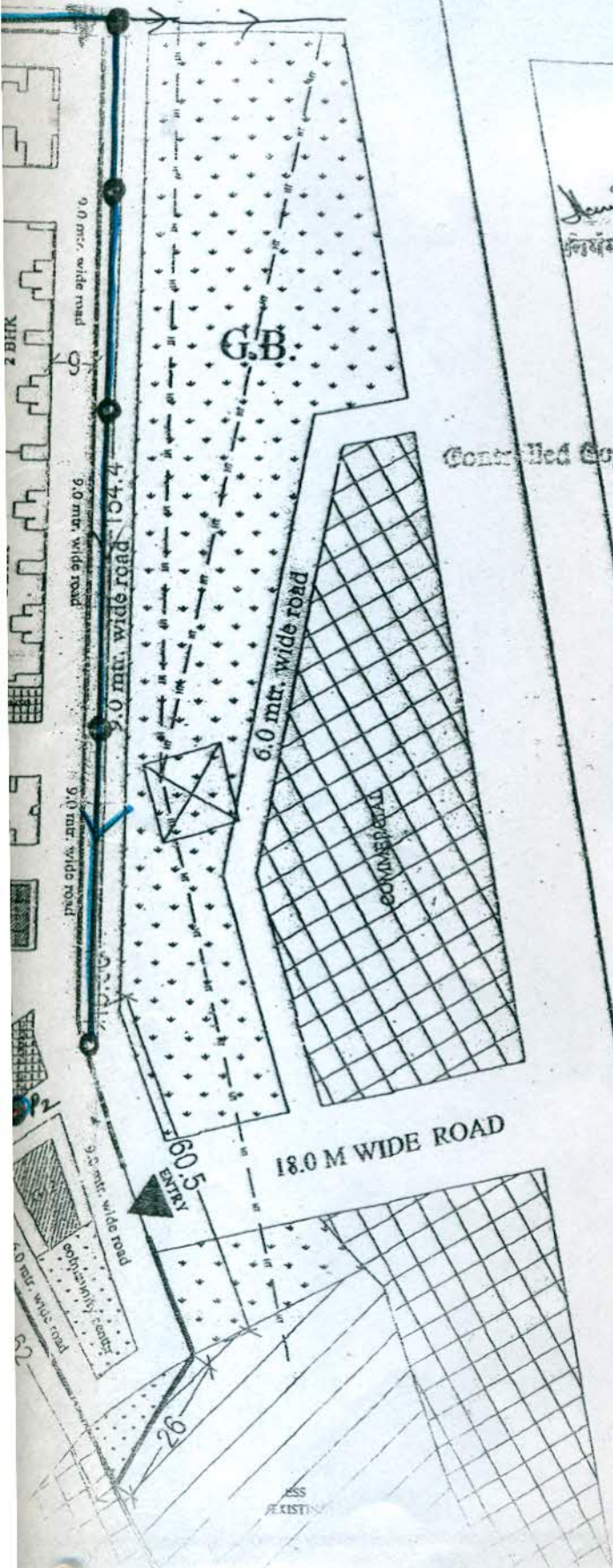

Controlled Copy No. 01

Handwritten signature
निधम हेतु प्रमाणित
हुक ई-2

ISO: 9001: 2008
E-MAIL: apuni2@rediffmail.com

DATED 30.11.2015
PART LAYOUT PLAN OF I.G. & E.W.S. FLATS AT PLOT NO. 9A/GH-4 & 9A/GH-3, BAUDDH VIHAR YOJNA NO. 4, PART-II (MAJHOLA), MORADABAD
FILE NO. DRG. NO. - APD/UN-2/MBD/Y-4/p3/srj/01/sec 9A/01/23

NOTE:-
1. ALL DIMENSIONS ARE IN METER.
2. FIGURED DIMENSIONS SHALL BE FOLLOWED.
3. ANY DISCREPANCY, IF FOUND IN THE DRAWING SHALL BE BROUGHT TO THE NOTICE OF A.P. UNIT-2, BEFORE EXECUTION OF WORK.
4. THIS PART LAYOUT PLAN HAS BEEN PREPARED ON THE BASIS OF INFORMATION RECEIVED FROM E.E. CD.-25, MORADABAD, VIDE HIS LETTER 1460/25, DATED - 14.08.2015.
5. DESIGN OF ONE BED ROOM FLAT DRG. NO. - MANDOLA VIHAR YOJNA/GZ/2/18/10.
6. DESIGN OF TWO BED ROOM FLAT DRG. NO. - MANDOLA VIHAR YOJNA/GZ/2/25/10 UNDER CONSTRUCTION MANDOLA YOJNA IS USED AS SUGGESTED BY S.E./E.-25, MORADABAD.
7. THIS PART LAYOUT PLAN HAS BEEN PREPARED ON THE BASIS OF FEASIBILITY RECEIVED FROM S.E.-CIR.-V, MORADABAD, VIDE HIS LETTER 1794/Y-17/37, DATED - 16.10.2015 AND E.E.-CD.-25, VIDE HIS LETTER NO. 2109/Y-M-228, DATED-23-11-15.

E+4 HOUSES
HEIGHT = 14.15 METRS. approx.
AREA OF PLOT = 27601.46 M² = 6.82 ACRE
F.A.R. = 1.38 approx.
COV. = 34.72 % approx.
SETBACKS = 6 M, 6 M, 6 M, 9.0 M

FLR.	NO. OF UNITS	1 BHK	2BHK
1.	ON FIRST FLOOR	72	112
2.	ON SECOND FLOOR	72	112
3.	ON THIRD FLOOR	72	112
4.	ON FOURTH FLOOR	72	112
TOTAL NO. OF UNITS		288	448
TOTAL NO. OF UNITS ON ALL FLOORS (1BHK+2BHK)		736	

TOTAL GREEN / OPEN AREA = 9.8 % approx.
FACILITIES (as per details):
CONVENIENT CHOPS = 04 nos.
COMMUNITY CENTER (G+2) = 01 no.
PARKING :-
REQUIRED STILT CAR PARKING = 224 nos.
ACHIEVED STILT CAR PARKING = 2242 ECS
REQUIRED 1 BHK PARKING AREA = 608 sqm.
ACHIEVED 1 BHK PARKING AREA = 2595.87 sqm

PART LAYOUT PLAN OF I.G. & E.W.S. FLATS AT PLOT NO. 9A / GH-4 & 9A / GH-3, BAUDDH VIHAR YOJNA NO. 4, PART-II (MAJHOLA), MORADABAD.

SCALE:-
15 5 0 10 30 M.

DEEP MALA
ARCH. ASSTT.
HEMA SHAH
AS-IT ARCHITECT PLANNER
GOPAL GARG
PROJECT PLANNER
R. P. SINGH

Handwritten signatures and dates:
11/21/15
10/11/2015