

| Sl. No. | Particulars | Value | Unit |
|---------|---|-----------|-------|
| 1 | Plot Area | 310315.54 | Sq.m. |
| 2 | Area for Mortgages (10% of Saleable Area) | 31031.55 | Sq.m. |
| 3 | Net Usable Area | 279273.99 | Sq.m. |
| 4 | Area for Mortgages (10% of Net Usable Area) | 27927.40 | Sq.m. |
| 5 | Net Usable Area after Mortgages | 251346.59 | Sq.m. |
| 6 | Area for Mortgages (10% of Net Usable Area after Mortgages) | 25134.66 | Sq.m. |
| 7 | Net Usable Area after Mortgages | 226211.93 | Sq.m. |
| 8 | Area for Mortgages (10% of Net Usable Area after Mortgages) | 22621.19 | Sq.m. |
| 9 | Net Usable Area after Mortgages | 203590.74 | Sq.m. |
| 10 | Area for Mortgages (10% of Net Usable Area after Mortgages) | 20359.07 | Sq.m. |
| 11 | Net Usable Area after Mortgages | 183231.67 | Sq.m. |
| 12 | Area for Mortgages (10% of Net Usable Area after Mortgages) | 18323.17 | Sq.m. |
| 13 | Net Usable Area after Mortgages | 164908.50 | Sq.m. |
| 14 | Area for Mortgages (10% of Net Usable Area after Mortgages) | 16490.85 | Sq.m. |
| 15 | Net Usable Area after Mortgages | 148417.65 | Sq.m. |
| 16 | Area for Mortgages (10% of Net Usable Area after Mortgages) | 14841.77 | Sq.m. |
| 17 | Net Usable Area after Mortgages | 133575.88 | Sq.m. |
| 18 | Area for Mortgages (10% of Net Usable Area after Mortgages) | 13357.59 | Sq.m. |
| 19 | Net Usable Area after Mortgages | 120218.29 | Sq.m. |
| 20 | Area for Mortgages (10% of Net Usable Area after Mortgages) | 12021.83 | Sq.m. |
| 21 | Net Usable Area after Mortgages | 108196.46 | Sq.m. |
| 22 | Area for Mortgages (10% of Net Usable Area after Mortgages) | 10819.65 | Sq.m. |
| 23 | Net Usable Area after Mortgages | 97376.81 | Sq.m. |
| 24 | Area for Mortgages (10% of Net Usable Area after Mortgages) | 9737.68 | Sq.m. |
| 25 | Net Usable Area after Mortgages | 87639.13 | Sq.m. |
| 26 | Area for Mortgages (10% of Net Usable Area after Mortgages) | 8763.91 | Sq.m. |
| 27 | Net Usable Area after Mortgages | 78875.22 | Sq.m. |
| 28 | Area for Mortgages (10% of Net Usable Area after Mortgages) | 7887.52 | Sq.m. |
| 29 | Net Usable Area after Mortgages | 70987.70 | Sq.m. |
| 30 | Area for Mortgages (10% of Net Usable Area after Mortgages) | 7098.77 | Sq.m. |
| 31 | Net Usable Area after Mortgages | 63888.93 | Sq.m. |
| 32 | Area for Mortgages (10% of Net Usable Area after Mortgages) | 6388.89 | Sq.m. |
| 33 | Net Usable Area after Mortgages | 57500.04 | Sq.m. |
| 34 | Area for Mortgages (10% of Net Usable Area after Mortgages) | 5750.00 | Sq.m. |
| 35 | Net Usable Area after Mortgages | 51750.04 | Sq.m. |
| 36 | Area for Mortgages (10% of Net Usable Area after Mortgages) | 5175.00 | Sq.m. |
| 37 | Net Usable Area after Mortgages | 46575.04 | Sq.m. |
| 38 | Area for Mortgages (10% of Net Usable Area after Mortgages) | 4657.50 | Sq.m. |
| 39 | Net Usable Area after Mortgages | 41917.54 | Sq.m. |
| 40 | Area for Mortgages (10% of Net Usable Area after Mortgages) | 4191.75 | Sq.m. |
| 41 | Net Usable Area after Mortgages | 37725.79 | Sq.m. |
| 42 | Area for Mortgages (10% of Net Usable Area after Mortgages) | 3772.58 | Sq.m. |
| 43 | Net Usable Area after Mortgages | 33953.21 | Sq.m. |
| 44 | Area for Mortgages (10% of Net Usable Area after Mortgages) | 3395.32 | Sq.m. |
| 45 | Net Usable Area after Mortgages | 30557.89 | Sq.m. |
| 46 | Area for Mortgages (10% of Net Usable Area after Mortgages) | 3055.79 | Sq.m. |
| 47 | Net Usable Area after Mortgages | 27502.10 | Sq.m. |
| 48 | Area for Mortgages (10% of Net Usable Area after Mortgages) | 2750.21 | Sq.m. |
| 49 | Net Usable Area after Mortgages | 24751.89 | Sq.m. |
| 50 | Area for Mortgages (10% of Net Usable Area after Mortgages) | 2475.19 | Sq.m. |
| 51 | Net Usable Area after Mortgages | 22276.70 | Sq.m. |
| 52 | Area for Mortgages (10% of Net Usable Area after Mortgages) | 2227.67 | Sq.m. |
| 53 | Net Usable Area after Mortgages | 20049.03 | Sq.m. |
| 54 | Area for Mortgages (10% of Net Usable Area after Mortgages) | 2004.90 | Sq.m. |
| 55 | Net Usable Area after Mortgages | 18044.13 | Sq.m. |
| 56 | Area for Mortgages (10% of Net Usable Area after Mortgages) | 1804.41 | Sq.m. |
| 57 | Net Usable Area after Mortgages | 16239.72 | Sq.m. |
| 58 | Area for Mortgages (10% of Net Usable Area after Mortgages) | 1623.97 | Sq.m. |
| 59 | Net Usable Area after Mortgages | 14615.75 | Sq.m. |
| 60 | Area for Mortgages (10% of Net Usable Area after Mortgages) | 1461.58 | Sq.m. |
| 61 | Net Usable Area after Mortgages | 13154.17 | Sq.m. |
| 62 | Area for Mortgages (10% of Net Usable Area after Mortgages) | 1315.42 | Sq.m. |
| 63 | Net Usable Area after Mortgages | 11838.75 | Sq.m. |
| 64 | Area for Mortgages (10% of Net Usable Area after Mortgages) | 1183.88 | Sq.m. |
| 65 | Net Usable Area after Mortgages | 10654.87 | Sq.m. |
| 66 | Area for Mortgages (10% of Net Usable Area after Mortgages) | 1065.49 | Sq.m. |
| 67 | Net Usable Area after Mortgages | 9589.38 | Sq.m. |
| 68 | Area for Mortgages (10% of Net Usable Area after Mortgages) | 958.94 | Sq.m. |
| 69 | Net Usable Area after Mortgages | 8630.44 | Sq.m. |
| 70 | Area for Mortgages (10% of Net Usable Area after Mortgages) | 863.04 | Sq.m. |
| 71 | Net Usable Area after Mortgages | 7767.40 | Sq.m. |
| 72 | Area for Mortgages (10% of Net Usable Area after Mortgages) | 776.74 | Sq.m. |
| 73 | Net Usable Area after Mortgages | 6990.66 | Sq.m. |
| 74 | Area for Mortgages (10% of Net Usable Area after Mortgages) | 699.07 | Sq.m. |
| 75 | Net Usable Area after Mortgages | 6291.59 | Sq.m. |
| 76 | Area for Mortgages (10% of Net Usable Area after Mortgages) | 629.16 | Sq.m. |
| 77 | Net Usable Area after Mortgages | 5662.43 | Sq.m. |
| 78 | Area for Mortgages (10% of Net Usable Area after Mortgages) | 566.24 | Sq.m. |
| 79 | Net Usable Area after Mortgages | 5096.19 | Sq.m. |
| 80 | Area for Mortgages (10% of Net Usable Area after Mortgages) | 509.62 | Sq.m. |
| 81 | Net Usable Area after Mortgages | 4586.57 | Sq.m. |
| 82 | Area for Mortgages (10% of Net Usable Area after Mortgages) | 458.66 | Sq.m. |
| 83 | Net Usable Area after Mortgages | 4127.91 | Sq.m. |
| 84 | Area for Mortgages (10% of Net Usable Area after Mortgages) | 412.79 | Sq.m. |
| 85 | Net Usable Area after Mortgages | 3715.12 | Sq.m. |
| 86 | Area for Mortgages (10% of Net Usable Area after Mortgages) | 371.51 | Sq.m. |
| 87 | Net Usable Area after Mortgages | 3338.61 | Sq.m. |
| 88 | Area for Mortgages (10% of Net Usable Area after Mortgages) | 333.86 | Sq.m. |
| 89 | Net Usable Area after Mortgages | 2998.75 | Sq.m. |
| 90 | Area for Mortgages (10% of Net Usable Area after Mortgages) | 299.88 | Sq.m. |
| 91 | Net Usable Area after Mortgages | 2694.87 | Sq.m. |
| 92 | Area for Mortgages (10% of Net Usable Area after Mortgages) | 269.49 | Sq.m. |
| 93 | Net Usable Area after Mortgages | 2415.38 | Sq.m. |
| 94 | Area for Mortgages (10% of Net Usable Area after Mortgages) | 241.54 | Sq.m. |
| 95 | Net Usable Area after Mortgages | 2159.84 | Sq.m. |
| 96 | Area for Mortgages (10% of Net Usable Area after Mortgages) | 215.98 | Sq.m. |
| 97 | Net Usable Area after Mortgages | 1927.86 | Sq.m. |
| 98 | Area for Mortgages (10% of Net Usable Area after Mortgages) | 192.79 | Sq.m. |
| 99 | Net Usable Area after Mortgages | 1710.07 | Sq.m. |
| 100 | Area for Mortgages (10% of Net Usable Area after Mortgages) | 171.01 | Sq.m. |
| 101 | Net Usable Area after Mortgages | 1507.06 | Sq.m. |
| 102 | Area for Mortgages (10% of Net Usable Area after Mortgages) | 150.71 | Sq.m. |
| 103 | Net Usable Area after Mortgages | 1318.35 | Sq.m. |
| 104 | Area for Mortgages (10% of Net Usable Area after Mortgages) | 131.83 | Sq.m. |
| 105 | Net Usable Area after Mortgages | 1143.52 | Sq.m. |
| 106 | Area for Mortgages (10% of Net Usable Area after Mortgages) | 114.35 | Sq.m. |
| 107 | Net Usable Area after Mortgages | 981.67 | Sq.m. |
| 108 | Area for Mortgages (10% of Net Usable Area after Mortgages) | 98.17 | Sq.m. |
| 109 | Net Usable Area after Mortgages | 832.80 | Sq.m. |
| 110 | Area for Mortgages (10% of Net Usable Area after Mortgages) | 83.28 | Sq.m. |
| 111 | Net Usable Area after Mortgages | 697.91 | Sq.m. |
| 112 | Area for Mortgages (10% of Net Usable Area after Mortgages) | 69.79 | Sq.m. |
| 113 | Net Usable Area after Mortgages | 576.00 | Sq.m. |
| 114 | Area for Mortgages (10% of Net Usable Area after Mortgages) | 57.60 | Sq.m. |
| 115 | Net Usable Area after Mortgages | 467.10 | Sq.m. |
| 116 | Area for Mortgages (10% of Net Usable Area after Mortgages) | 46.71 | Sq.m. |
| 117 | Net Usable Area after Mortgages | 369.20 | Sq.m. |
| 118 | Area for Mortgages (10% of Net Usable Area after Mortgages) | 36.92 | Sq.m. |
| 119 | Net Usable Area after Mortgages | 282.30 | Sq.m. |
| 120 | Area for Mortgages (10% of Net Usable Area after Mortgages) | 28.23 | Sq.m. |
| 121 | Net Usable Area after Mortgages | 205.40 | Sq.m. |
| 122 | Area for Mortgages (10% of Net Usable Area after Mortgages) | 20.54 | Sq.m. |
| 123 | Net Usable Area after Mortgages | 138.50 | Sq.m. |
| 124 | Area for Mortgages (10% of Net Usable Area after Mortgages) | 13.85 | Sq.m. |
| 125 | Net Usable Area after Mortgages | 71.60 | Sq.m. |
| 126 | Area for Mortgages (10% of Net Usable Area after Mortgages) | 7.16 | Sq.m. |
| 127 | Net Usable Area after Mortgages | 5.00 | Sq.m. |
| 128 | Area for Mortgages (10% of Net Usable Area after Mortgages) | 0.50 | Sq.m. |
| 129 | Net Usable Area after Mortgages | 2.50 | Sq.m. |
| 130 | Area for Mortgages (10% of Net Usable Area after Mortgages) | 0.25 | Sq.m. |
| 131 | Net Usable Area after Mortgages | 0.00 | Sq.m. |
| 132 | Area for Mortgages (10% of Net Usable Area after Mortgages) | 0.00 | Sq.m. |
| 133 | Net Usable Area after Mortgages | 0.00 | Sq.m. |
| 134 | Area for Mortgages (10% of Net Usable Area after Mortgages) | 0.00 | Sq.m. |
| 135 | Net Usable Area after Mortgages | 0.00 | Sq.m. |
| 136 | Area for Mortgages (10% of Net Usable Area after Mortgages) | 0.00 | Sq.m. |
| 137 | Net Usable Area after Mortgages | 0.00 | Sq.m. |
| 138 | Area for Mortgages (10% of Net Usable Area after Mortgages) | 0.00 | Sq.m. |
| 139 | Net Usable Area after Mortgages | 0.00 | Sq.m. |
| 140 | Area for Mortgages (10% of Net Usable Area after Mortgages) | 0.00 | Sq.m. |
| 141 | Net Usable Area after Mortgages | 0.00 | Sq.m. |
| 142 | Area for Mortgages (10% of Net Usable Area after Mortgages) | 0.00 | Sq.m. |
| 143 | Net Usable Area after Mortgages | 0.00 | Sq.m. |
| 144 | Area for Mortgages (10% of Net Usable Area after Mortgages) | 0.00 | Sq.m. |
| 145 | Net Usable Area after Mortgages | 0.00 | Sq.m. |
| 146 | Area for Mortgages (10% of Net Usable Area after Mortgages) | 0.00 | Sq.m. |
| 147 | Net Usable Area after Mortgages | 0.00 | Sq.m. |
| 148 | Area for Mortgages (10% of Net Usable Area after Mortgages) | 0.00 | Sq.m. |
| 149 | Net Usable Area after Mortgages | 0.00 | Sq.m. |
| 150 | Area for Mortgages (10% of Net Usable Area after Mortgages) | 0.00 | Sq.m. |

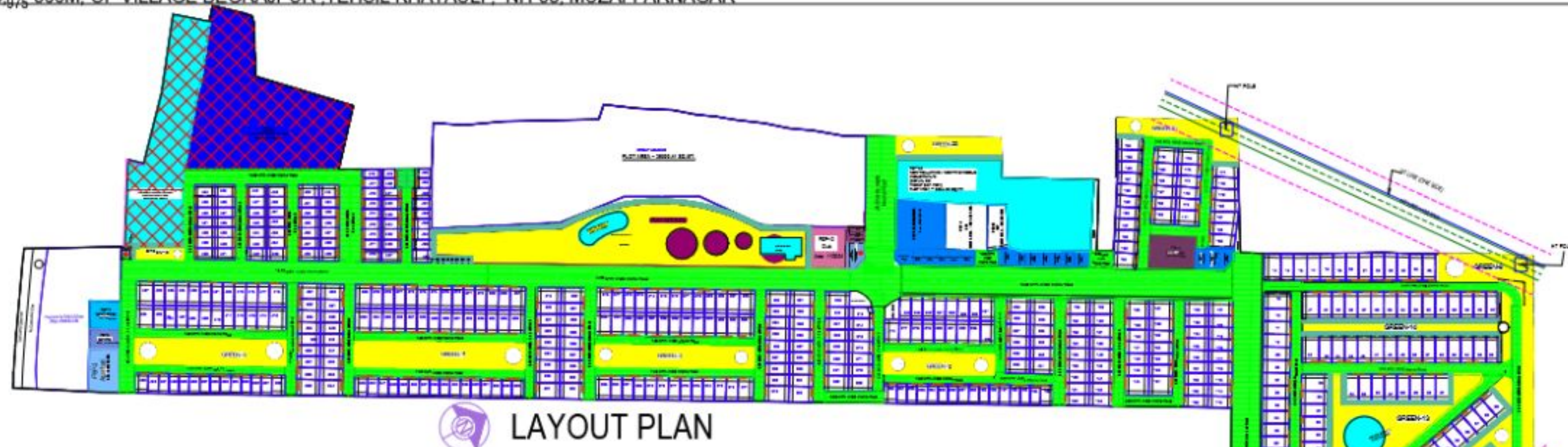

LAYOUT PLAN

| LANDUSE | MIN. / MAX. | PERMISSIBLE PERCENTAGE | PERMISSIBLE AREA (SQ.M) | PROPOSED AREA (SQ.M) | PROPOSED PERCENTAGE |
|---|-------------|------------------------|-------------------------|----------------------|---------------------|
| 1 Residential | MAX. | 50% | 155304.97 | 122362.05 | 39.40% |
| 2 Commercial | MAX. | 10% | 31060.99 | 12753.89 | 4.13% |
| 3 Institutional & Public (Semi public facility) | MIN. | 10% | 31060.99 | 3126.16 | 10.07% |
| 4 Green | MIN. | 15% | 46591.49 | 46840.81 | 15.08% |
| 5 Public Road & Parking & open spaces | MIN. | 15% | 46591.49 | 97363.89 | 31.37% |

| Sr.No | DESCRIPTION | % ACHIEVED | AREA (SQ.M) | AREA (ACRE) | AREA (HAC.) |
|-------|---------------------------------|------------|-------------|-------------|-------------|
| a | LAND BOUNDARY AREA | 100% | 310315.54 | 76.95 | 31.141 |
| b | 30-MT. WIDE ROAD WIDENING AREA | 0.09% | 295.05 | 0.07 | 0.030 |
| c | 30-MT. WIDE GREENBELT AREA | 0.26% | 799.05 | 0.20 | 0.080 |
| | NET LICENCE BOUNDARY AREA (a+b) | 99.65% | 310315.54 | 76.68 | 31.032 |

| Sr. No. | Description | % Achieved | Area (sq.m.) | Area (acre) | Area (Hac.) |
|--|-------------------------|---------------|------------------|--------------|---------------|
| RESIDENTIAL | | | | | |
| 1 | Plotted | 28.97% | 89981.83 | 22.23 | 9.030 |
| | Group Housing Plot Area | 8.37% | 26000.41 | 6.42 | 2.600 |
| | EWS & LIG | 2.06% | 6399.95 | 1.58 | 0.640 |
| | Sub Total | 39.40% | 122362.19 | 30.24 | 12.234 |
| COMMERCIAL | | | | | |
| 2 | Commercial plot | 2.39% | 7432.76 | 1.84 | 0.740 |
| | Plotted commercial | 1.71% | 5321.13 | 1.31 | 0.530 |
| | Sub Total | 4.11% | 12753.89 | 3.15 | 1.280 |
| Institutional & Public - Semi public Facility | | | | | |
| 3 | Plotted | 5.95% | 18466.71 | 4.56 | 1.850 |
| | Sub Total | 5.95% | 18466.71 | 4.56 | 1.850 |
| Industrial (non-polluting / non-hazardous) | | | | | |
| 4 | Plotted | 1.17% | 3603.45 | 0.89 | 0.350 |
| | Sub Total | 1.17% | 3603.45 | 0.89 | 0.350 |
| Green | | | | | |
| 5 | Plotted | 15.08% | 46840.81 | 11.57 | 4.680 |
| | Sub Total | 15.08% | 46840.81 | 11.57 | 4.680 |
| Public Road & Parking & open spaces | | | | | |
| 6 | Plotted | 31.35% | 97363.89 | 24.01 | 9.740 |
| | Sub Total | 31.35% | 97363.89 | 24.01 | 9.740 |
| | GRAND TOTAL | 100% | 310609.94 | 76.75 | 31.06 |

| Sr.No | DESCRIPTION | % ACHIEVED | AREA (SQ.M) | AREA (ACRE) | AREA (HAC.) |
|--|-------------------------|-------------|------------------|--------------|---------------|
| RESIDENTIAL | | | | | |
| a1 | Plotted | 28.97% | 89981.83 | 22.23 | 9.030 |
| | Group Housing Plot Area | 8.37% | 26000.41 | 6.42 | 2.600 |
| | EWS & LIG | 2.06% | 6399.95 | 1.58 | 0.640 |
| COMMERCIAL | | | | | |
| a2 | Commercial plot | 2.39% | 7432.76 | 1.84 | 0.740 |
| | Plotted commercial | 1.71% | 5321.13 | 1.31 | 0.530 |
| Institutional & Public - Semi public Facility | | | | | |
| a3 | Plotted | 5.95% | 18466.71 | 4.56 | 1.850 |
| Industrial (non-polluting / non-hazardous) | | | | | |
| a4 | Plotted | 1.17% | 3603.45 | 0.89 | 0.350 |
| Green | | | | | |
| a5 | Plotted | 15.08% | 46840.81 | 11.57 | 4.680 |
| Public Road & Parking & open spaces | | | | | |
| a6 | Plotted | 31.35% | 97363.89 | 24.01 | 9.740 |
| | TOTAL | 100% | 310315.54 | 76.68 | 31.032 |

| S.No | INSTITUTIONAL & PUBLIC - SEMI PUBLIC FACILITY (PSP) | AREA (SQ.M) |
|------|---|-------------|
| 1 | PSP - 01 GUARD ROOM, PUBLIC CORRIDOR & LIFT | 228.02 |
| 2 | PSP - 02 AMBULANCE | 88.13 |
| 3 | PSP - 03 HEALTH CENTER | 90.34 |
| 4 | PSP - 04 | 403.12 |
| 5 | PSP - 05 | 375.07 |
| 6 | PSP - 06 | 1480.17 |
| 7 | PSP - 07 | 105.89 |
| 8 | PSP - 08 | 102.0 |

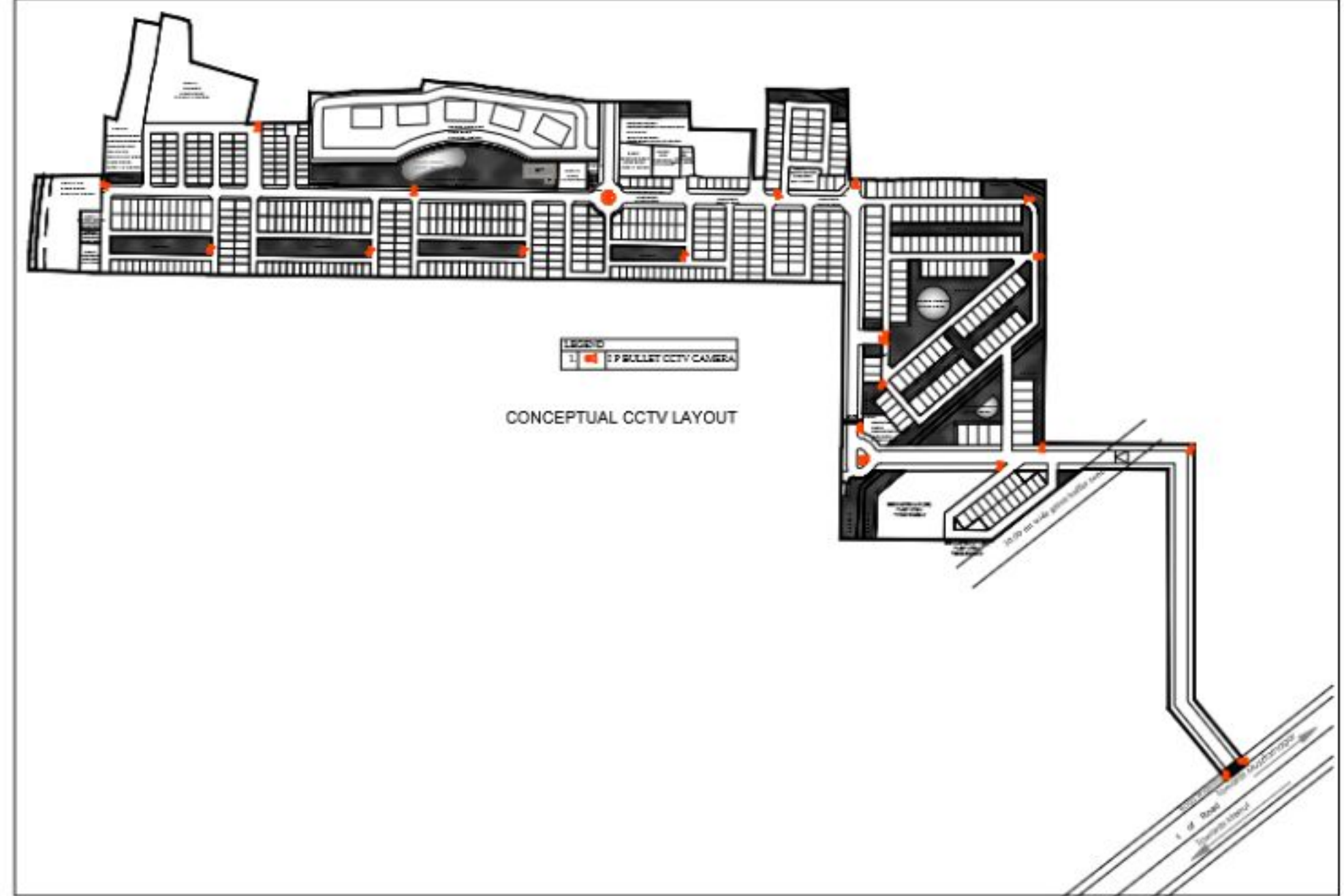
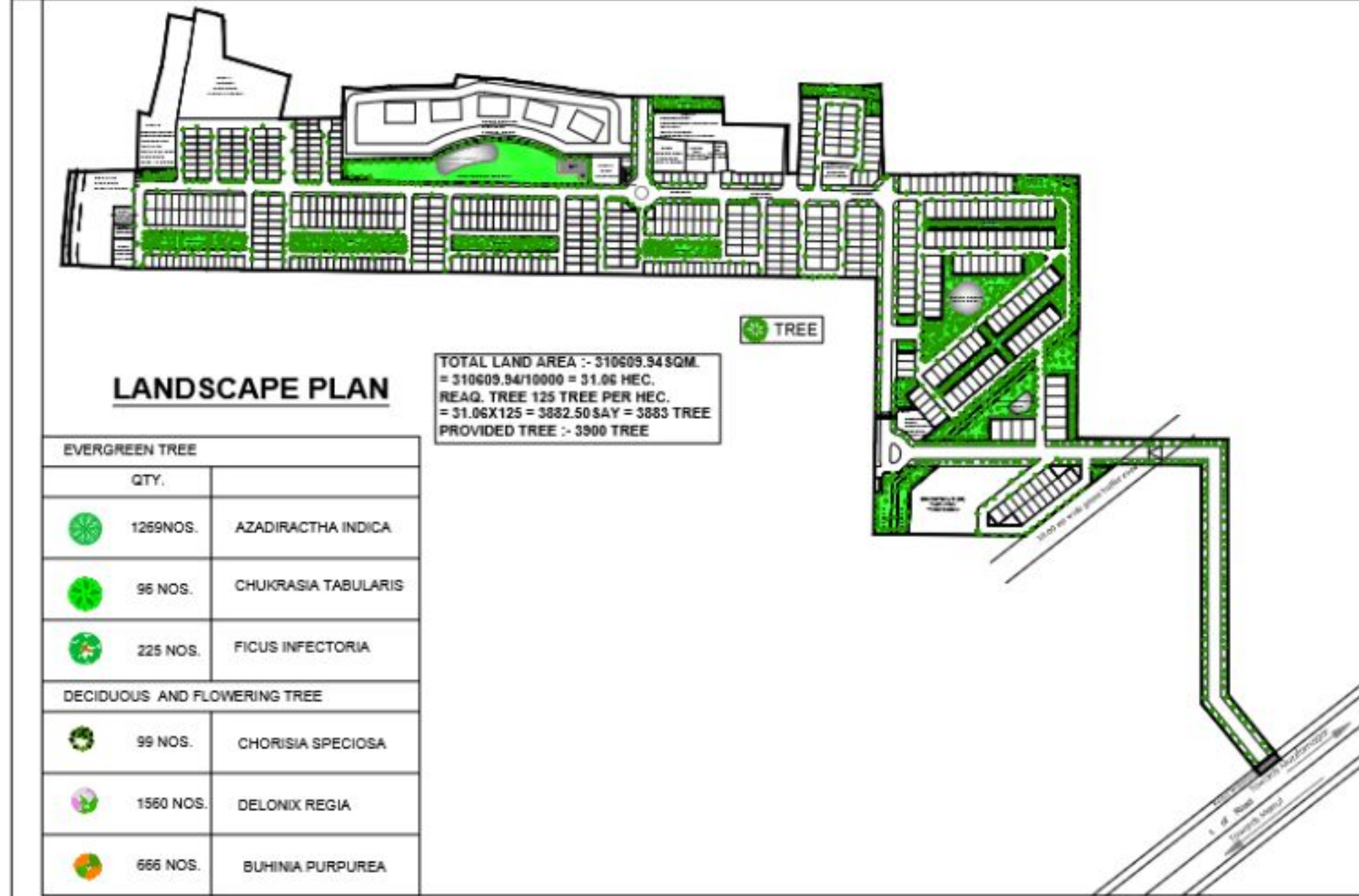
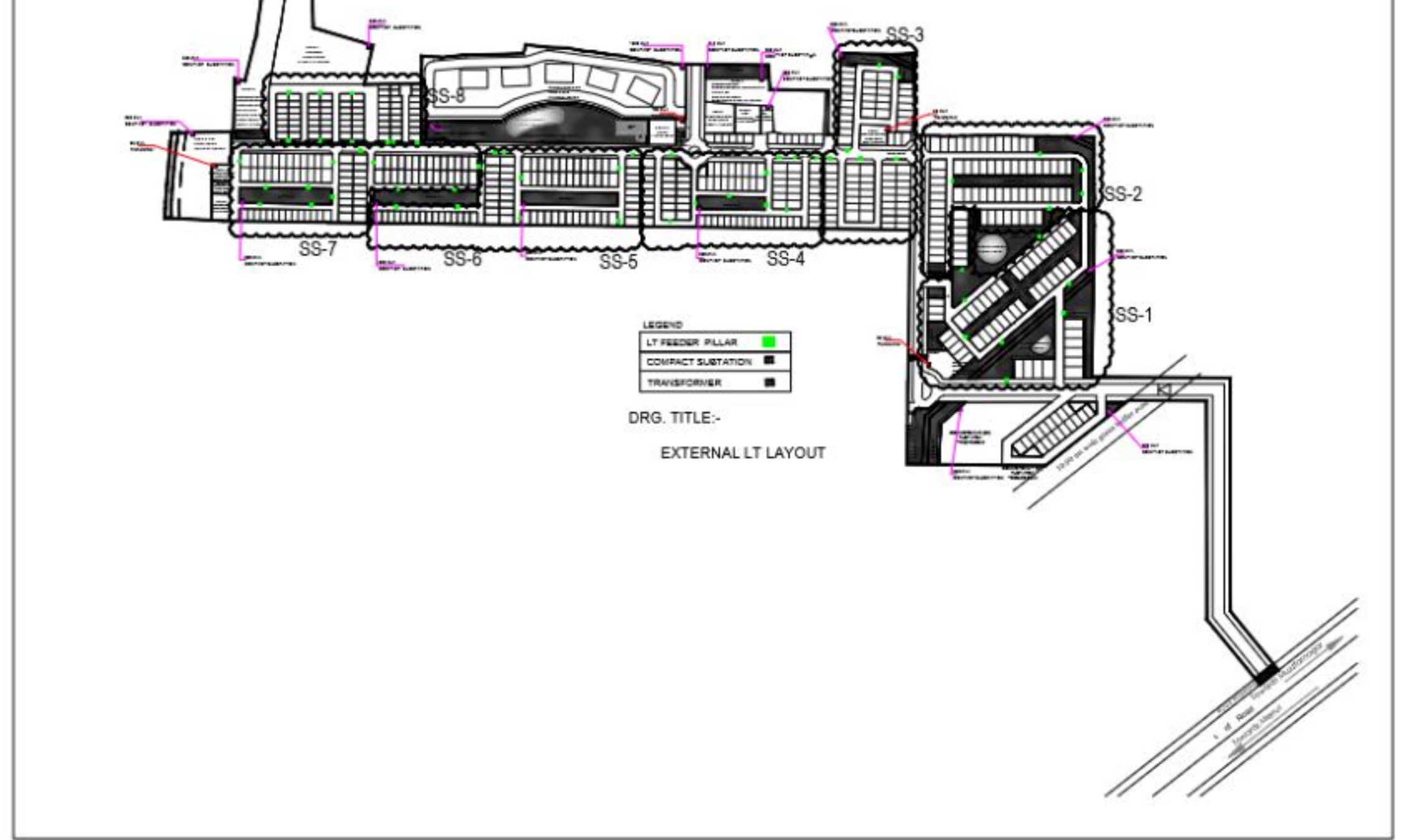
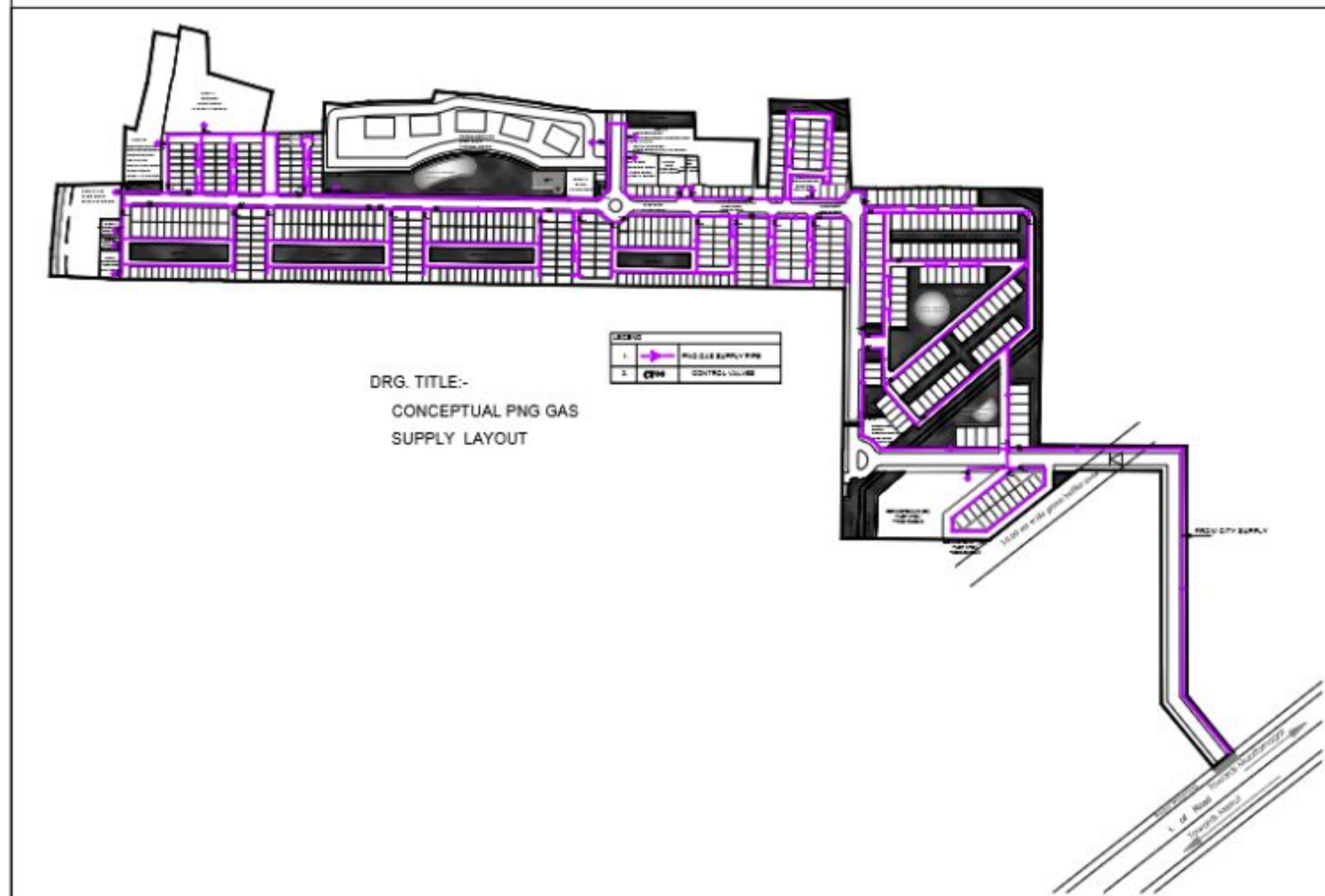

DRAWER'S NAME AND SIGNATURE
NUMAX REALCON CONSORTIUM
(AUTHORIZED SIGNATORY MRS. SHIKHA GARG)
sgh@numaxrealcon.com, 9896935528

DRAWING NAME AND NO
RASHMI SANGH
C/30/1 WEST

REVISIONS

QR CODE

Building Plan Application Number
MCD/23/24-25/041

Sanctioned On
21 Nov 2023

Valid Till
21 Nov 2026

Approved By
Kavita Mahto (Vice Chairman)

Examined By
Jitendra Singh (Senior Engineer)
Bharat Pal (Assistant Engineer)
Mukesh Prasad Singh (Assistant Town Planner)
Vinit Agarwal (Executive Engineer)
Kamlesh Babbar Singh (Secretary)
Kavita Mahto (Vice Chairman)

Note: - 1) This drawing is prepared as per the current prevailing Building Bye Laws.
2) If Map sanctioned is used for purpose anything other than stated in application will lead to rejection of Map.

| | | | |
|------------------------|-----------|-------------------|------|
| Total Plot Area :- | 310215.54 | Total FAR Area :- | 0.00 |
| Total Coverage Area :- | 0.00 | Total BUA Area :- | 0.00 |

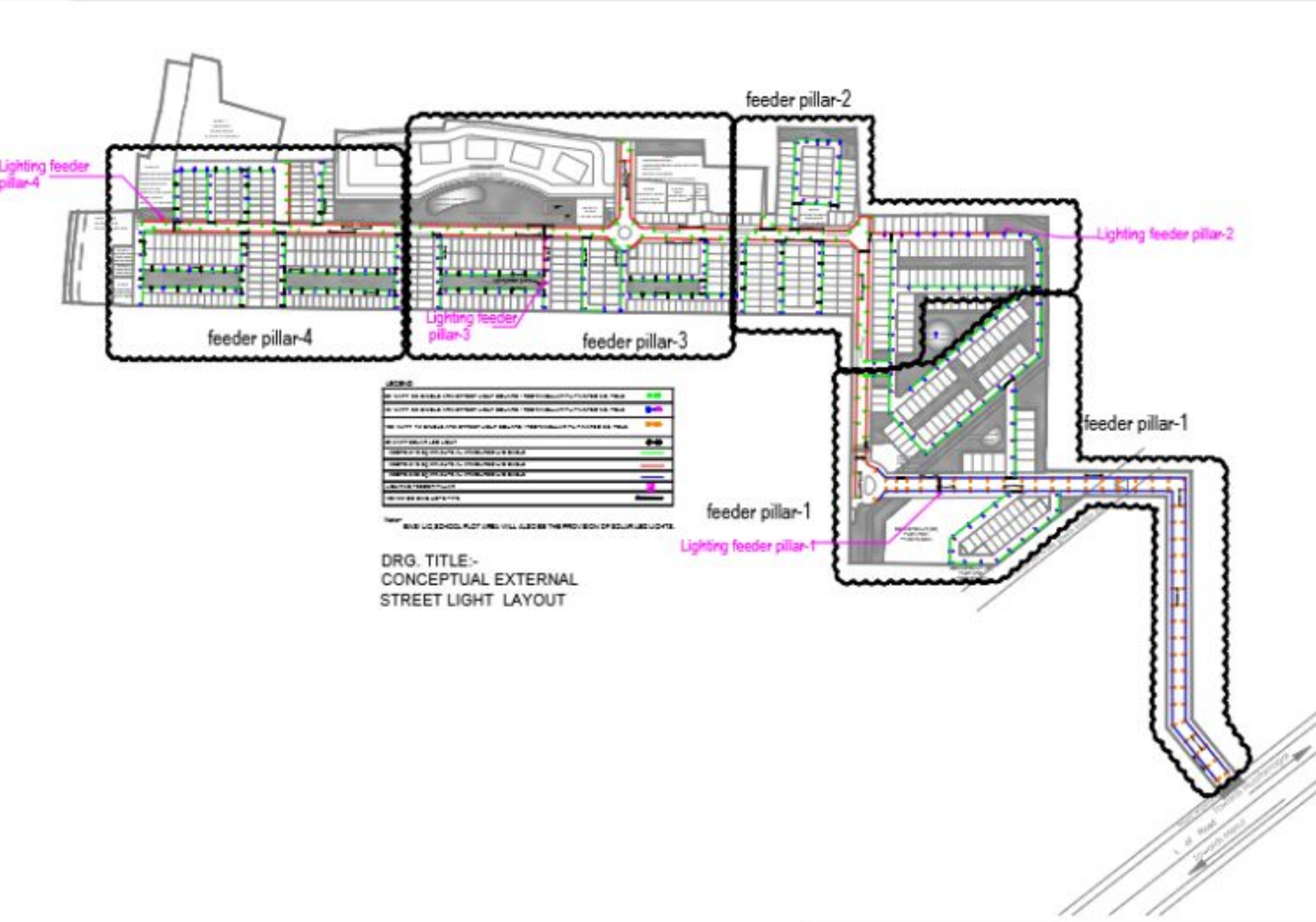
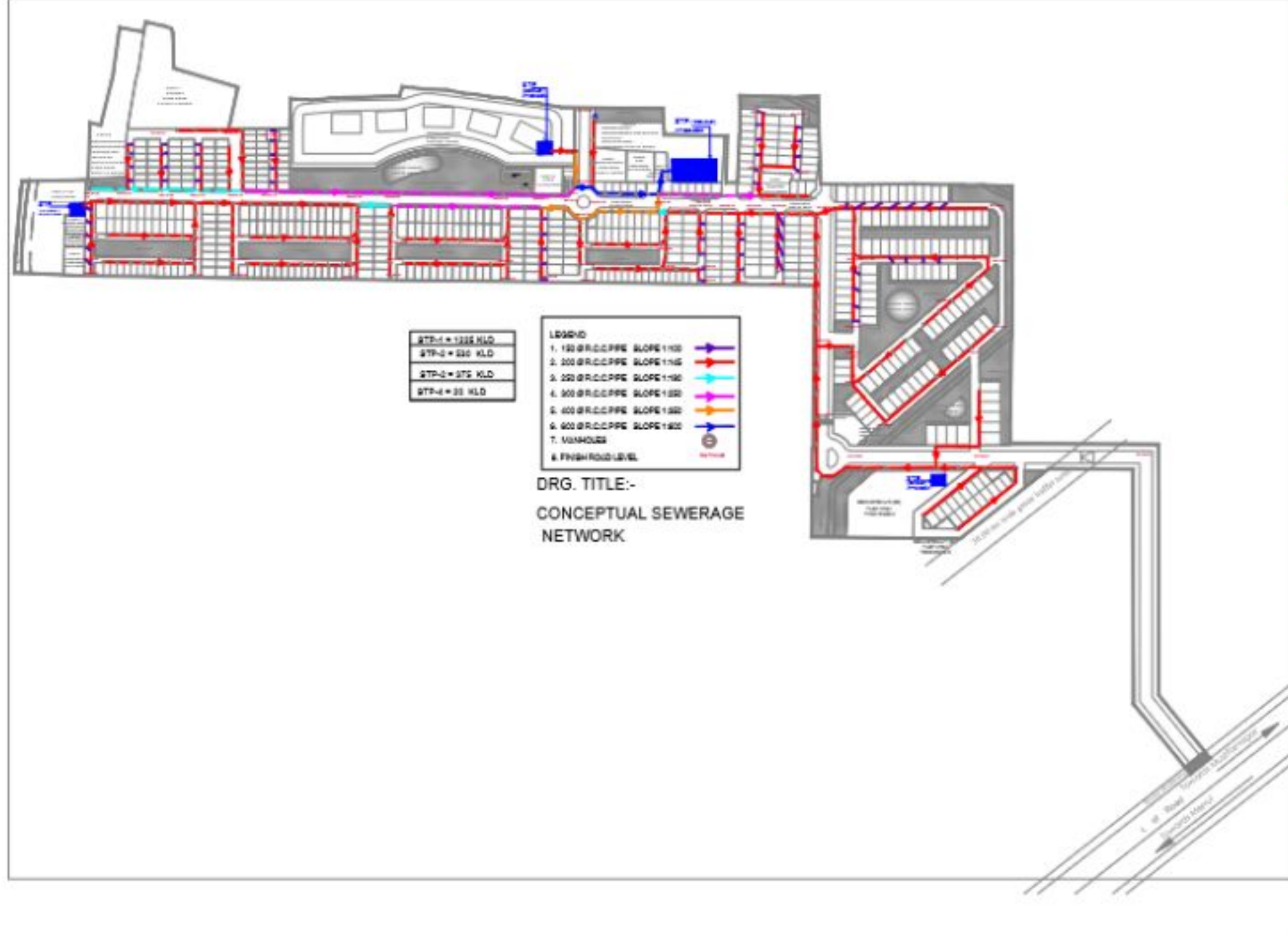
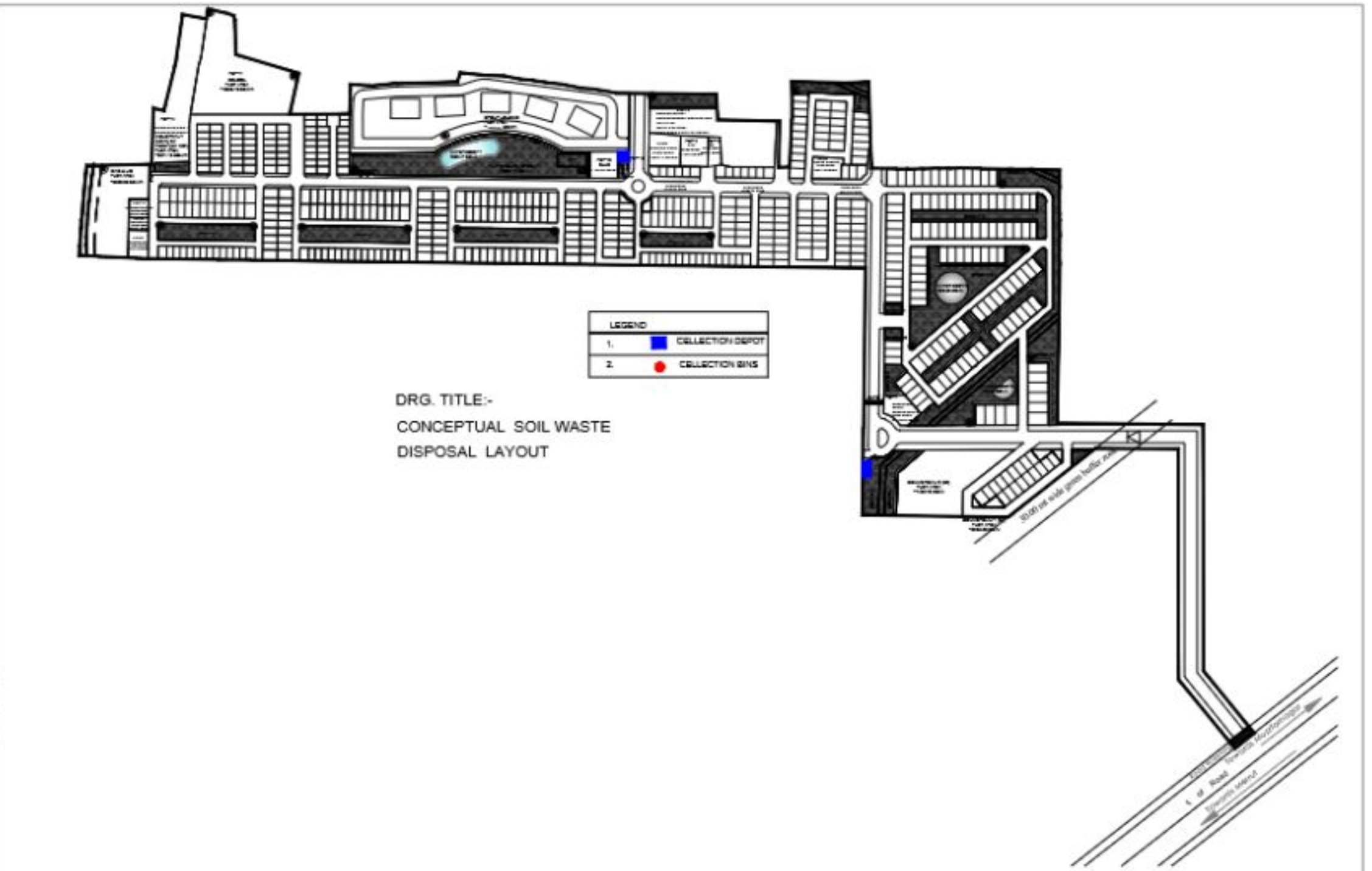
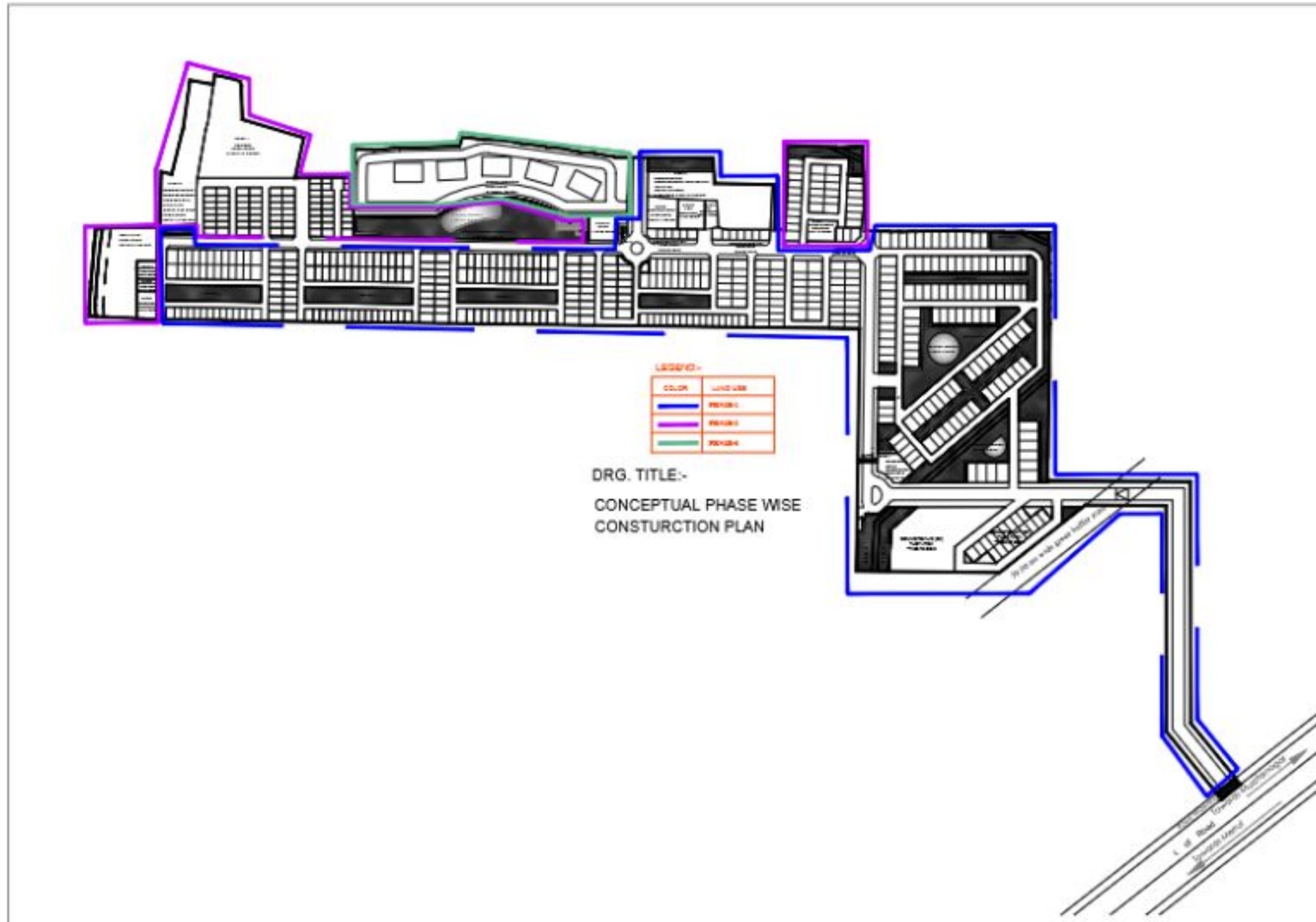

DRAWER'S NAME AND SIGNATURE
MRS. SHIKHA GARG

DESIGNER'S NAME AND SIGNATURE
[Signature]

DATE
21 Nov 2022

SCALE
AS SHOWN

PROJECT NAME
NUMAX REALCON CONSORTIUM

PROJECT ADDRESS
KHASRA NO. 1406, 1410M, 1421, 1422, 1408M, 1407, 1383, 1381M, 1380, 1390, 1392, 1379, 1409, 1394, 1396, 1388, 1397M, 1389, 1093, 1469M, 1425, 1454, 1439, 1424M, 1467, 1436, 1394M, 1393, 1382M, 1375, 1384, 1376M, 1385M, 1376M, 1426, 1427, 1420, 1409M, 1452M, 1462, 1386, OF VILLAGE JARODA, TEHSIL SADAR AND KHASRA NO_01_04_1K/975_1/366M, OF VILLAGE BEGRAJPUR, TEHSIL KHATAULI, NH-58, MUZAFFARNAGAR

APPROVED BY
Kavita Mahto (Vice Chairman)

EXAMINED BY
Jitendra Singh (Senior Engineer)
Bharat Pal (Assistant Engineer)
Mukesh Prasad Singh (Assistant Town Planner)
Vijay Agarwal (Executive Engineer)

DATE
21 Nov 2022

PROJECT NO.
M22/AS/24-25/041

Note: - 1) This drawing is prepared as per the current prevailing Building Bye Laws.
2) If Map sanctioned is used for purpose anything other than stated in application will lead to rejection of Map.

| | | | |
|------------------------|-----------|-------------------|------|
| Total Plot Area :- | 310215.54 | Total FAR Area :- | 0.00 |
| Total Coverage Area :- | 0.00 | Total BUA Area :- | 0.00 |

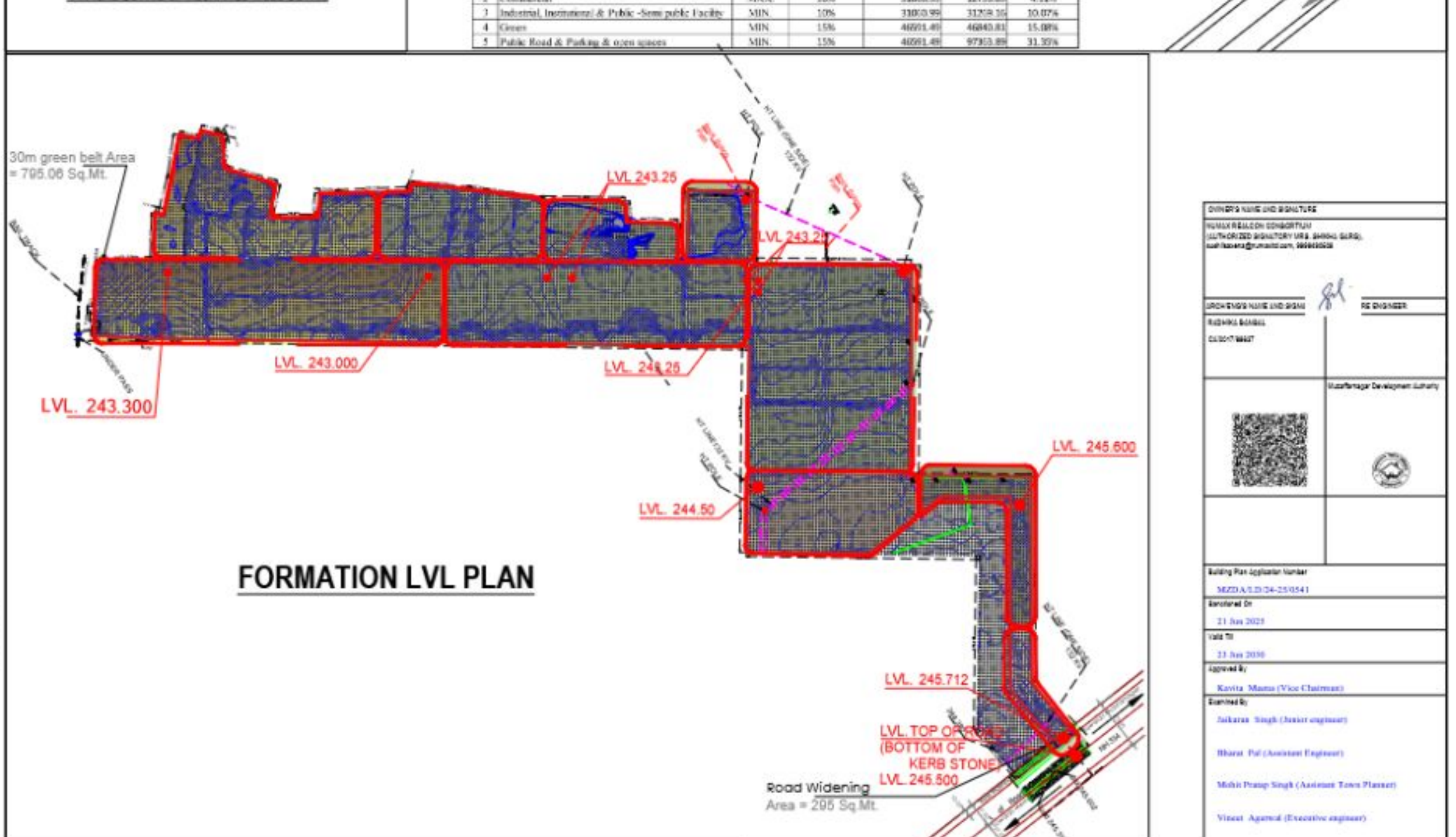
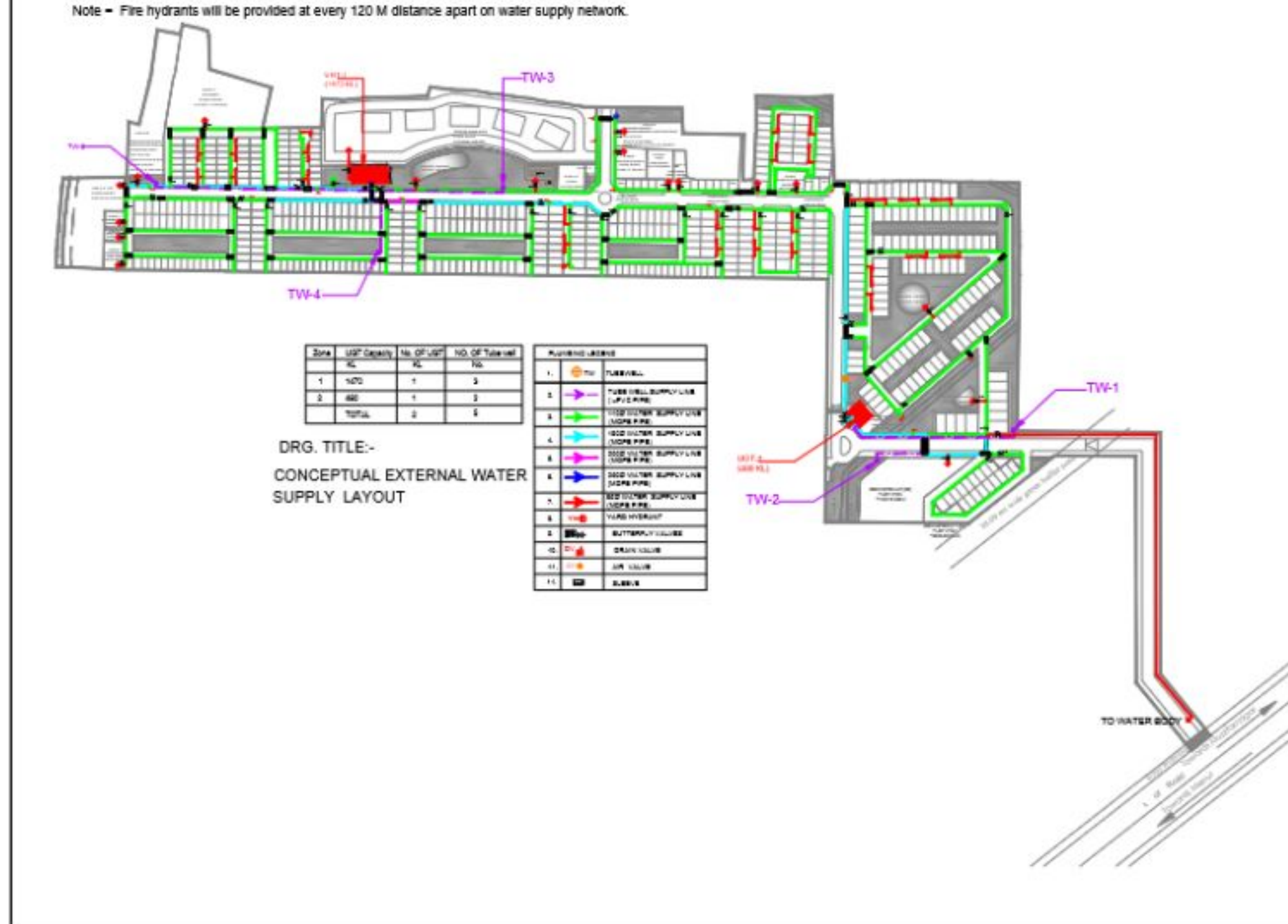
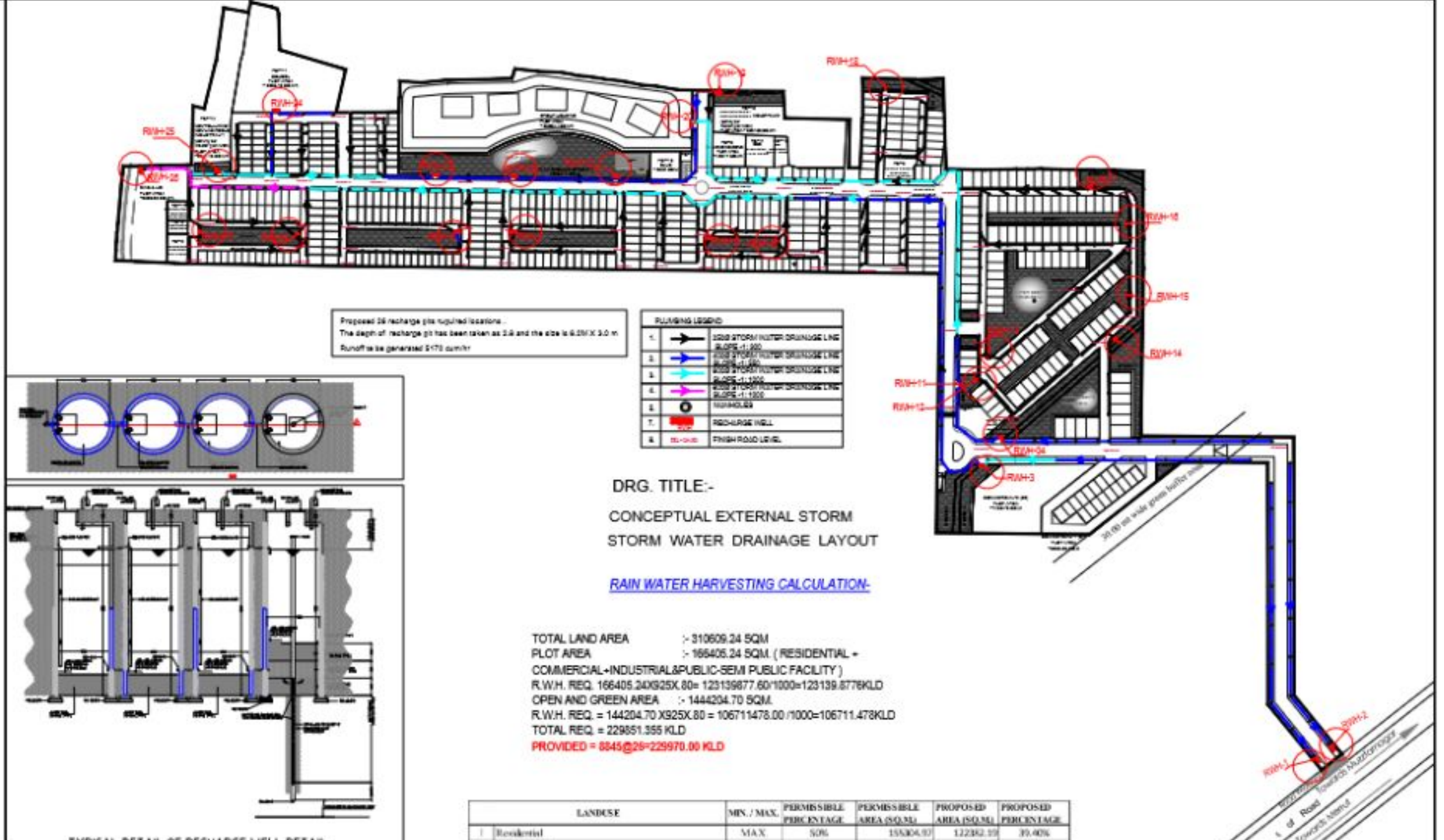
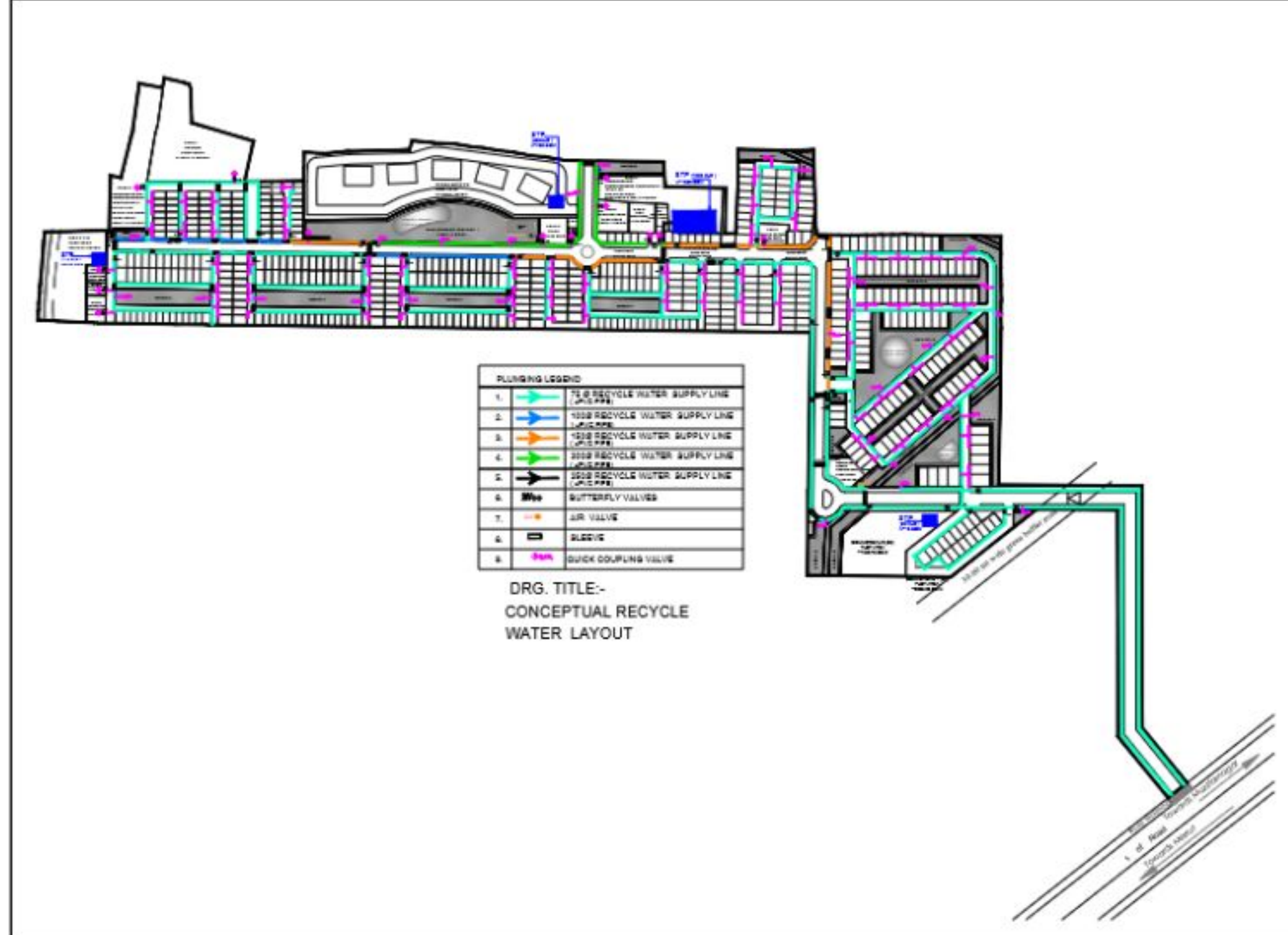

OWNER'S NAME AND SIGNATURE
 NUMAX REALCON CONSORTIUM
 AUTHORIZED SIGNATORY MRS. SHIKHA GARG
 09876543210@numax.com, 9876543210

DESIGNER'S NAME AND SIGNATURE
 SHIKHA GARG
 09876543210@numax.com, 9876543210

Building Plan Application Number
 MZ/AS/24-25/041

Sanctioned On
 21 Nov 2023

Valid Till
 21 Nov 2026

Approved By
 Kavita Mahto (Vice Chairman)

Examined By
 Sakara Singh (Senior engineer)
 Bharat Pal (Assistant Engineer)
 Mohit Prasad Singh (Assistant Town Planner)
 Vinay Agarwal (Executive engineer)

Inspector
 Kamesh Babbar Singh (Inspector)
 Kavita Mahto (Vice Chairman)



R.O.W 30.0M
SECTIONS AA



SECTION NN
R.O.W 7.5M

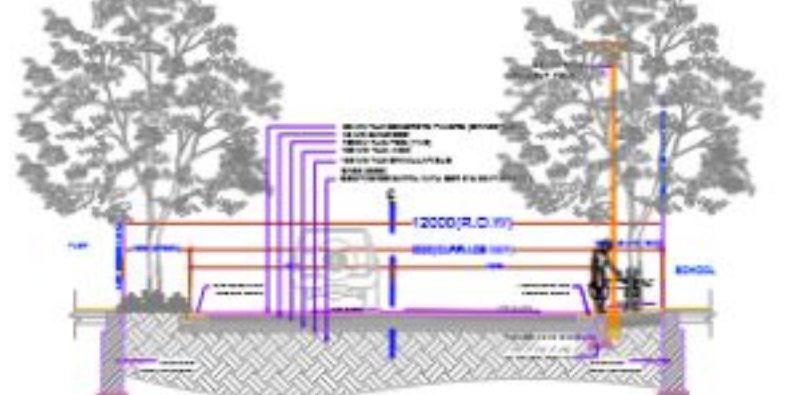

SECTION JJ
R.O.W 12.0M



SECTION FF
R.O.W 18.0M



SECTIONS CC
R.O.W 24.0M



SECTION LL
R.O.W 9.0M

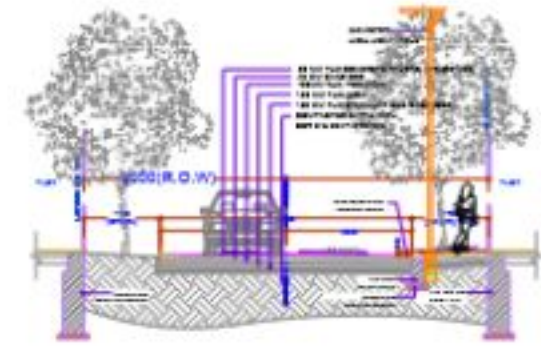

Note: - 1) This drawing is prepared as per the current prevailing Building Bye Laws.
2) If Map sanctioned is used for purpose anything other than stated in application will lead to rejection of Map.

| | | | |
|-----------------------|-----------|------------------|------|
| Total Plot Area - | 310215.54 | Total FAR Area - | 0.00 |
| Total Coverage Area - | 0.00 | Total SUA Area - | 0.00 |

OWNER'S NAME AND SIGNATURE
 NUMAX REALCON CONSORTIUM
 AUTHORIZED SIGNATORY MRS. SHIKHA GARG
 09876543210@numax.com, 9876543210

DESIGNER'S NAME AND SIGNATURE
 RASHMI SINGH
 09876543210

Stamp/Signature Development Authority

Building Plan Application Number
 MZD/AS/2024-25/0541

Sanctioned On
 21 Nov 2023

Valid Till
 21 Nov 2030

Approved By
 Kavita Mehta (Vice Chairman)

Examined By
 Sakar Singh (Senior Engineer)
 Bharat Pal (Assistant Engineer)
 Mohit Prasad Singh (Assistant Town Planner)
 Vinay Agarwal (Executive Engineer)

Reviewed By
 Kunal Bahadur Singh (Secretary)

Approved By
 Kavita Mehta (Vice Chairman)

