

**Project**

Proposed Affordable Housing Project on ARAZI No 282, 276Mi, 276, 276/3Mi, 275/2, and ARAZI No 283, 282, 276 Mi, 276/3Mi, 275/2Mi, 275/2 situated at VILLAGE- MAHEBA PURAB PATTI, UPARHAR, PARGANA-ARAIL, TEHSIL - KARCHHANA, PRAYAGRAJ OF SHER AFGAN S/O SHRI SHER ALI & Smt. SHAH BANO w/o SHRI ALI SHER

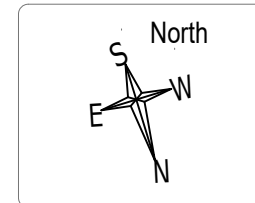

Ayansh Credit Services LLP

Authorized Signatory

PROPERTY OF  
MR. SHER ALI FATHER OF MR. SHER AFGAN &  
MR. ALI SHER HUSBAND OF MRS. SHAH BANO

OTHERS PROPERTY

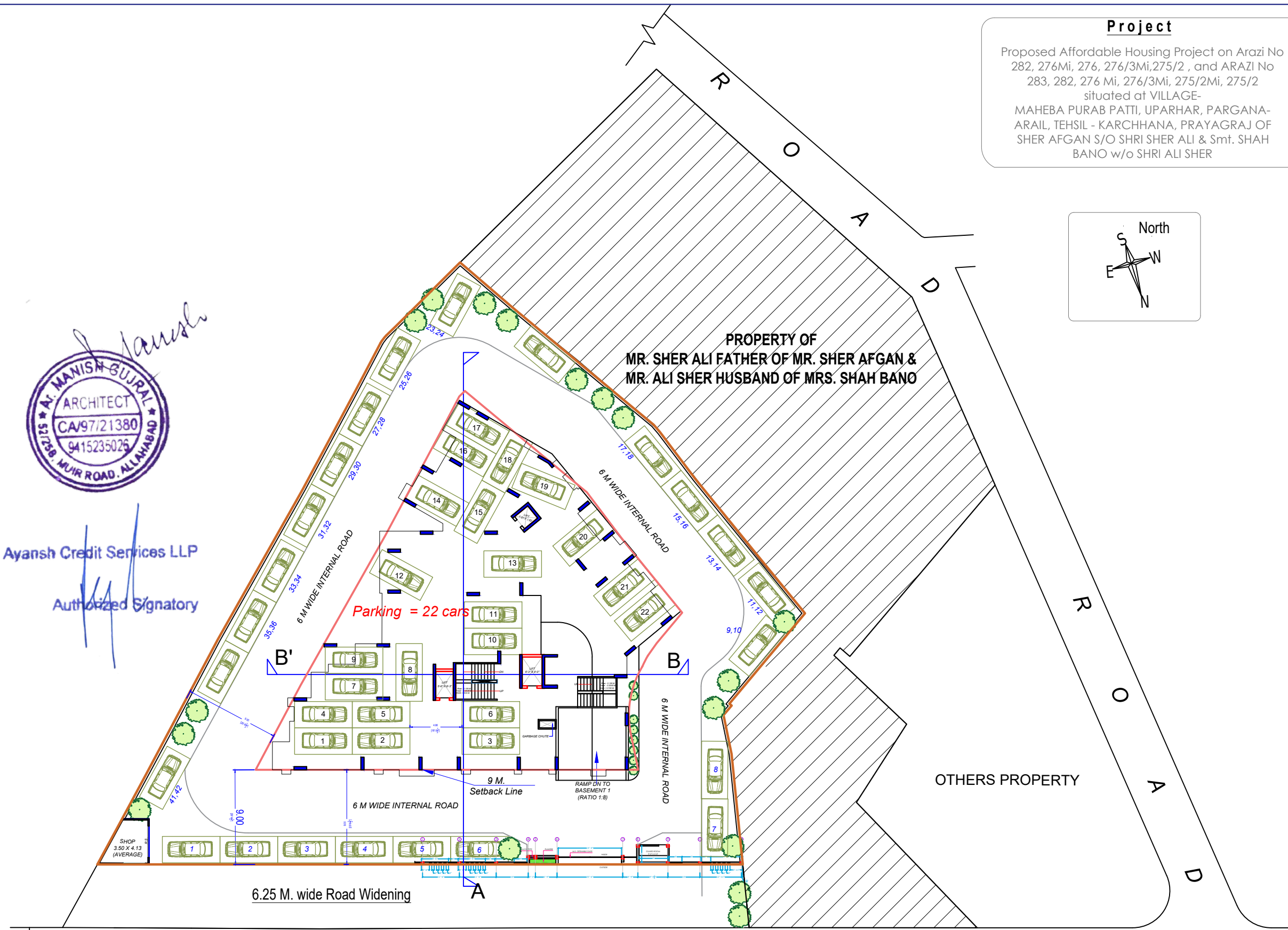

TO NAINI STATION

14.00 to 17.50 METER WIDE INDALPUR ROAD

TO MAHEWA REWA

**DEVELOPMENT WORK PLAN**