

60 MT. WIDE ROAD

GATE NO-2

GATE NO-1

FUTURE DEVELOPMENT

STELLAR ONE PHASE II

SUBMISSION DRAWING FOR
M/S STELLAR SPRINGS PROJECT PVT. LTD.
AT PLOT NO. 9 SECTOR-1, GREATER NOIDA WEST (UP)

DESIGN OF WATER CALCULATION			
Population			
Total No. of Flats	Phase-1 and Phase-2	=	1,540 Nos.
Total Permanent Population	@ 4.5	=	6,966 Persons
Club & Floating Population	@ 10% of total	=	697 Persons
Staff	@ 5% of total	=	348 Persons
Total Water Demand			8,011
Persons - 6966 Nos.			
Club & Floating - 697 Nos.	@ 15 lpcd	=	10,449 Liters
Staff - 348 nos	@ 45 lpcd	=	15,674 Liters
Swimming Pool Makeup water			10,000 Liters
Filter Backwash			10,000 Liters
Gardening	Area 23880 Sqm @ 3.5 ltr/sqm	=	76,335 Liters
Total Water Demand			721,534 Liters

SYMBOLS	DESCRIPTION
	COLD WATER SUPPLY
	300X300 VALVE WITH CHAMBER
	IRRIGATION PIPE
	GARDEN HYDRANT

PROJECT : GROUP HOUSING FOR
M/S STELLAR SPRING PROJECTS PVT. LTD.
PLOT NO-GH-09, SECTOR-01, GREATER NOIDA (UP)

SHEET TITLE : SITE PLAN
WATER SUPPLY LAYOUT
SUBMISSION DRAWING PHASE-II

ARCHITECT'S SIGN : _____ OWNER'S SIGN : _____

SCALE : _____ SITE PLAN NORTH

CODE : _____ DWG NO. PL-1C

DEALT : _____ REVISION SUFFIX

CHKD : _____

DATE : _____

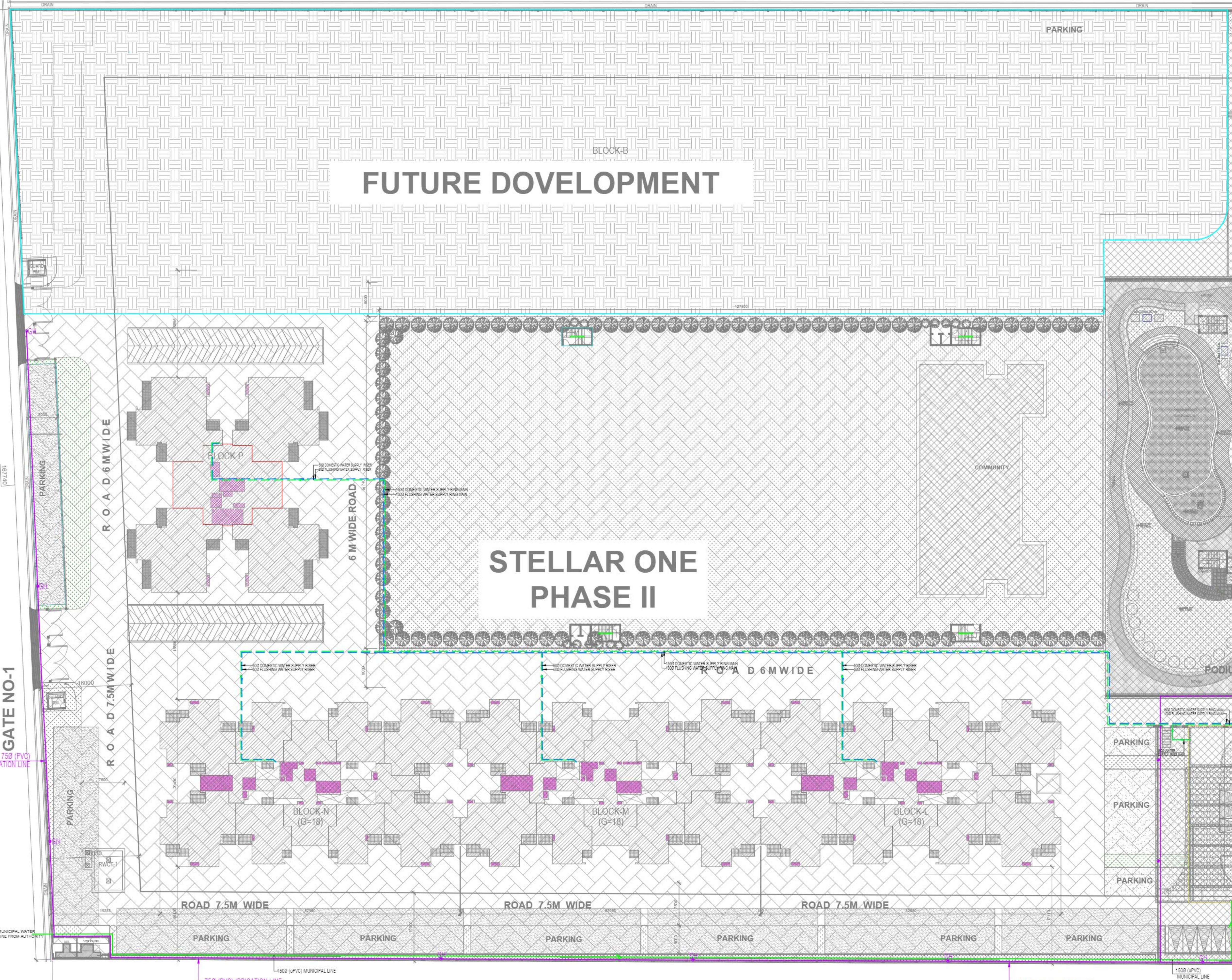

PLOT NO. GH-10

390430